

F.A. RTE.	SECTION	COUNTY	TOTAL SHEETS	SHEET NO.
*	**	***	310	150
STA. TO STA.				
CONTRACT NO. 74155				
<ul style="list-style-type: none"> * PARK ROADS ** SFWA PARK ROADS 2003-1 *** MOULTRIE AND SHELBY 				

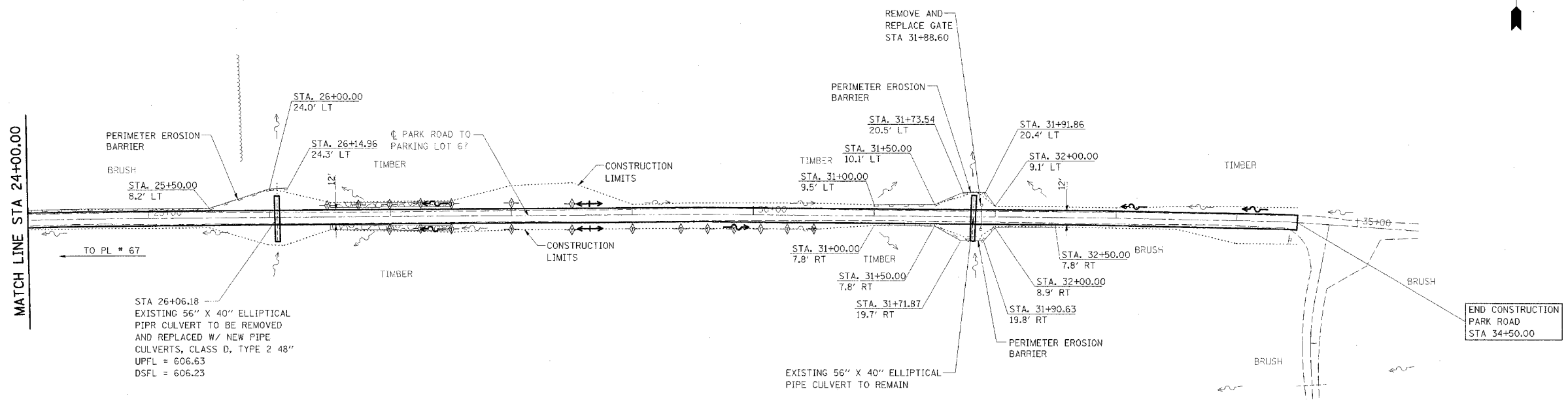

PLAN	DATE
REVISIONS	
PLOTTED	
NOTED	
NO.	

PROFILE	DATE
REVISIONS	
PLOTTED	
NOTED	
NO.	



NOTE:
 PARK ROAD
 STA 2+24.95 TO STA 34+50.00
 SURFACE IMPROVEMENTS,
 ADD 3" AGGREGATE

REVISIONS TO PARK ROADS AND PARKING LOTS
 SHOWN ON PREVIOUS PLAN SHEETS THAT DO NOT
 IMPACT EROSION CONTROL ARE NOT BALLOONED
 OR NOTED AS REVISIONS TO ELIMINATE CLUTTER
 AND CROWDING ON THE EROSION CONTROL SHEETS

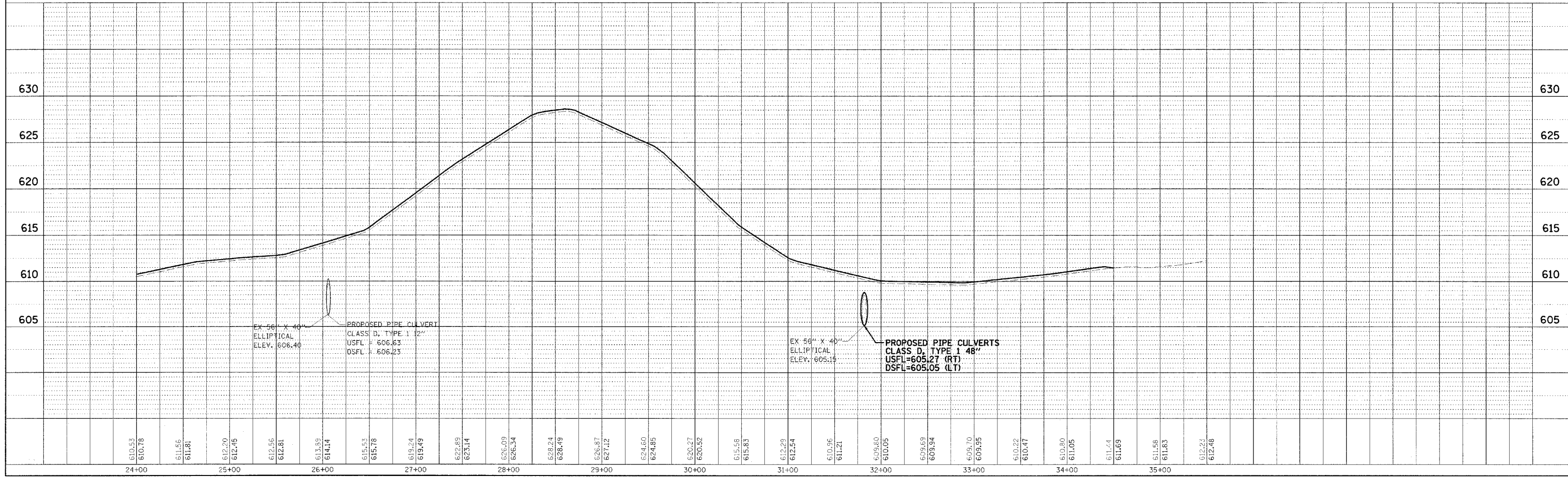

KASKASKIA FISH & WILDLIFE UNIT EROSION CONTROL PLAN AND PROFILE, PARK ROAD TO PARKING LOT 67