

REVIEWED	DATE
SURVEY	BY
NOTE BOOK	NO.
AREAS	AREAS CHECKED

REVIEWED	DATE
TEMPLATE	BY
NOTE BOOK	NO.
AREAS	AREAS CHECKED

\* PARK ROADS  
 \*\* SFWA PARK ROADS 2003-1  
 \*\*\* MOULTRIE AND SHELBY

F.A. RTE.	SECTION	COUNTY	TOTAL SHEETS	SHEET NO.
*	**	***	310	264
STA.		TO STA.		
CONTRACT NO. 74155				

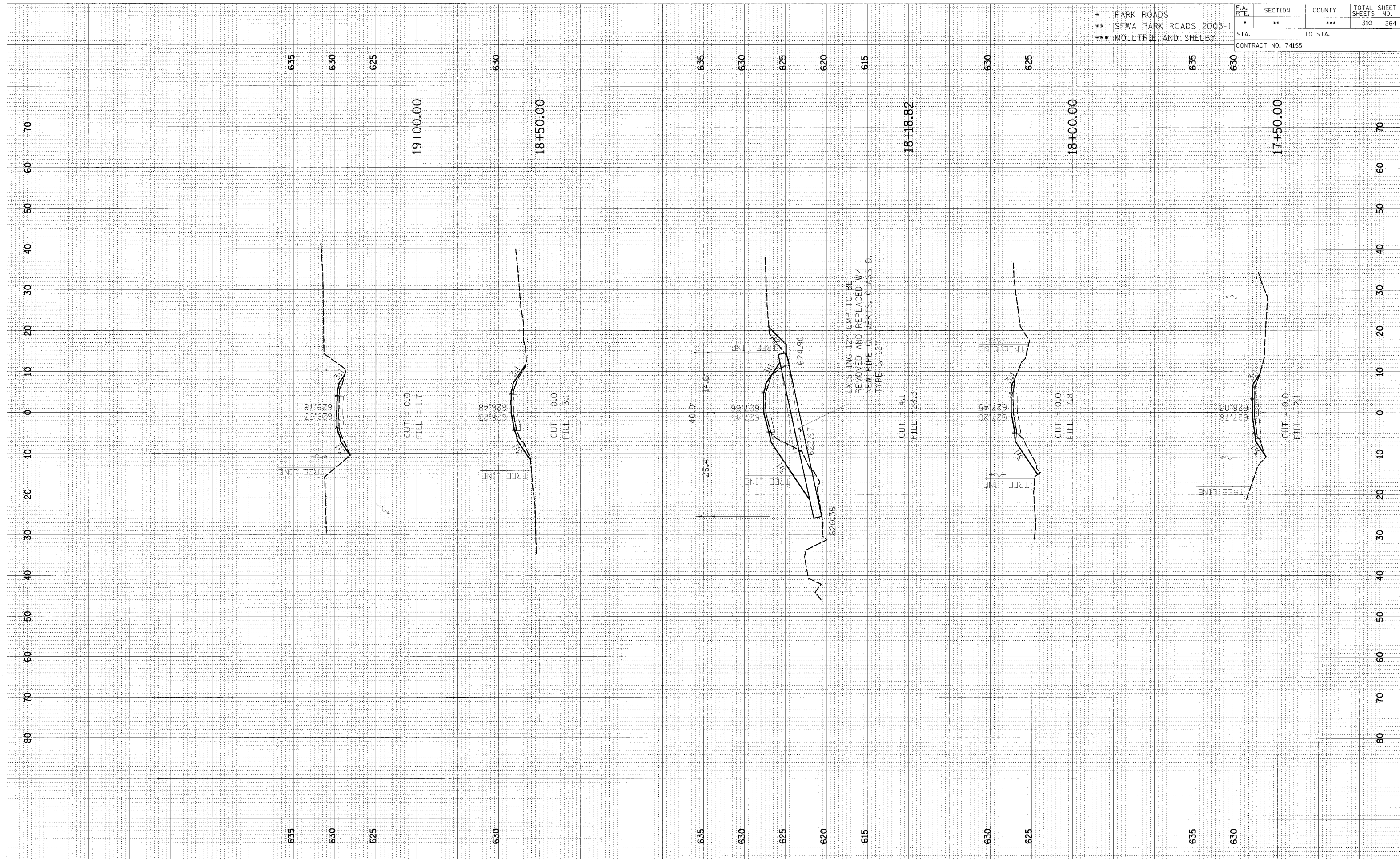

CROSS SECTION, KASKASKIA, TOWNSHIP ROAD 131A TO PARKING LOT 66, STA 17+50.00 TO STA 19+00.00