

5/19/2006  
c:\projc\_1s\74161d\03406pa.dgn

CONTRACT NO. 74161

F.A.P. RTE.	SECTION	COUNTY	TOTAL SHEETS	SHEET NO.
116		RICHLAND	43	33
STA.		TO STA.		
FED. ROAD DIST. NO.		ILLINOIS FED. AID PROJECT		
• (123Z, 124Z)TS-2,RS-3				

CITY OF OLNEY PARK

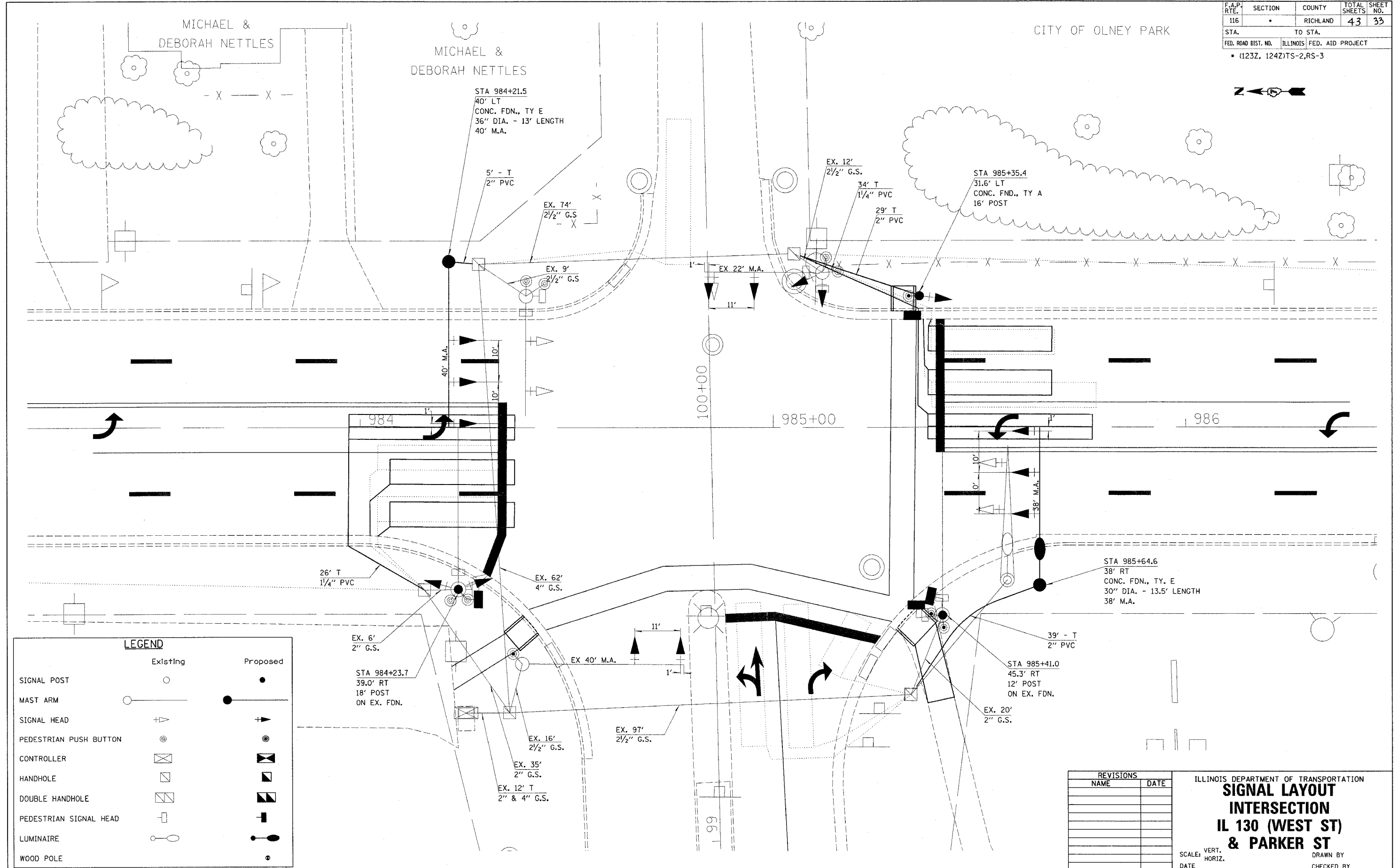
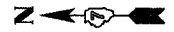

LEGEND		
	Existing	Proposed
SIGNAL POST	○	●
MAST ARM	○—	●—
SIGNAL HEAD	▽	▽
PEDESTRIAN PUSH BUTTON	⊙	⊙
CONTROLLER	⊠	⊠
HANDHOLE	◻	◻
DOUBLE HANDHOLE	◻	◻
PEDESTRIAN SIGNAL HEAD	⊞	⊞
LUMINAIRE	⊙	⊙
WOOD POLE	○	○

REVISIONS	
NAME	DATE

ILLINOIS DEPARTMENT OF TRANSPORTATION  
**SIGNAL LAYOUT  
 INTERSECTION  
 IL 130 (WEST ST)  
 & PARKER ST**

SCALE: VERT. \_\_\_\_\_  
 HORIZ. \_\_\_\_\_

DATE \_\_\_\_\_

DRAWN BY \_\_\_\_\_  
 CHECKED BY \_\_\_\_\_

5/19/2006  
 FILE NAME = 03406pa.dgn  
 PLOT SCALE = 1/4" = 1'-0"  
 USER NAME = dstrout