

ROUTE NO.	SECTION	COUNTY	TOTAL SHEETS	SHEET NO.
F.A.P. 42	2BR	WASHINGTON	33	18
FED. ROAD DIST. NO. 8	ILLINOIS	PROJECT		

Sheet 4 of 16 CONTRACT #76389

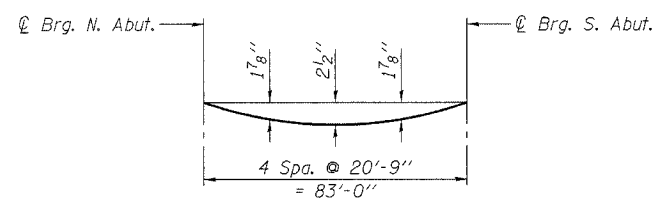

DEAD LOAD DEFLECTION DIAGRAM

(Includes weight of concrete only.)
 Note: The above deflections are not to be used in the field if the engineer is working from the grade elevations adjusted for dead load deflections as shown on sheet 5 of 16.

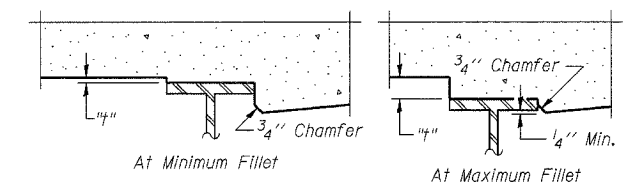

To determine "t": After all structural steel has been erected, elevations of the top flanges of the beams shall be taken at intervals shown below. These elevations subtracted from the "Theoretical Grade Elevations Adjusted for Dead Load Deflection" shown on sheet 5 of 16, minus slab thickness, equals the fillet heights "t" above top flange of beams.

FILLET HEIGHTS

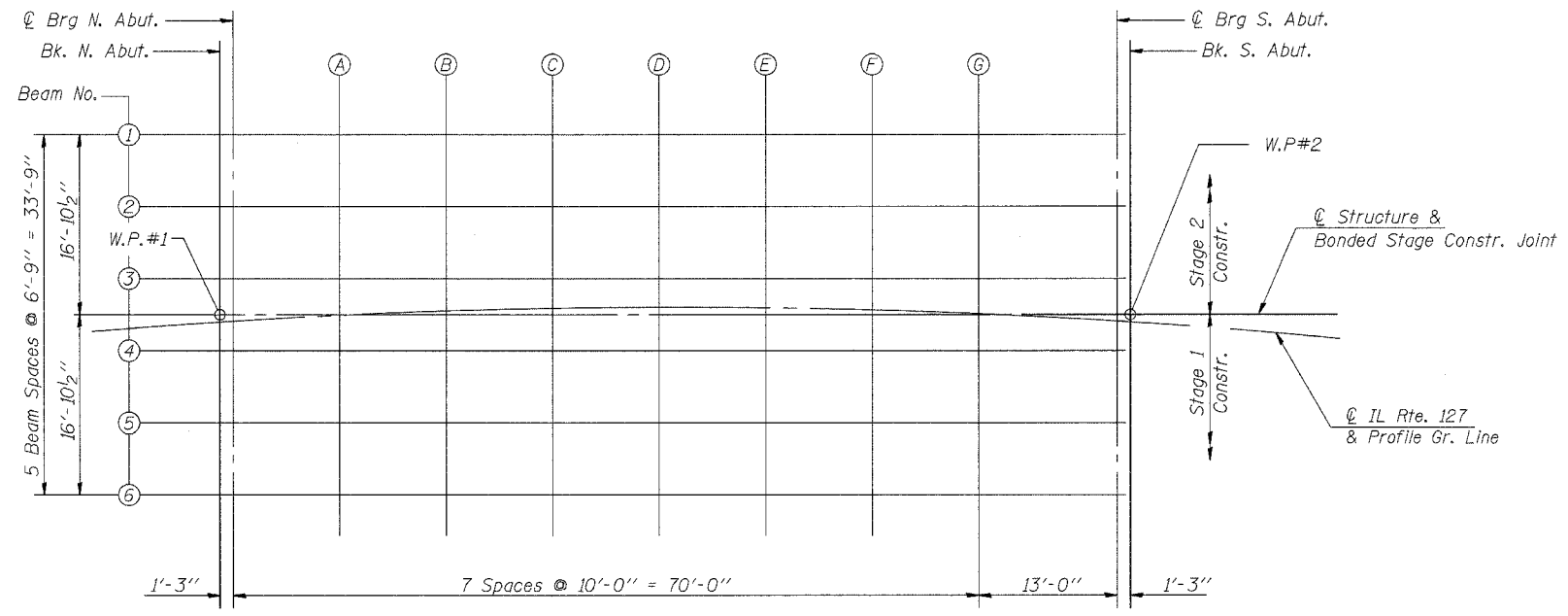
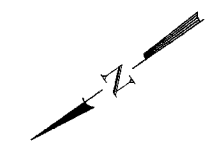

PLAN

DESIGNED	Ruben V. Boehler
CHECKED	Tim S. Howard
DRAWN	Nicole L. Darling
CHECKED	Michael D. Cummins

E-S 4-30-97

Work this sheet with sheet 5 of 16.

TOP OF SLAB ELEVATIONS	
IL ROUTE 127 OVER TRIBUTARY TO CROOKED CREEK F.A.P. ROUTE 42 SECTION 2BR WASHINGTON COUNTY STA. 487+25 S.N. 095-0076	
CUMMINS ENGINEERING CORPORATION	JOB #: 2158 FILE: 2158SLAB DATE: 2/10/05