

F.A.P. RTE.	SECTION	COUNTY	TOTAL SHEETS	SHEET NO.
600	34RS-2	ST. CLAIR	39	12
STA. 983+50.00		TO STA. 989+00.00		
FED. ROAD DIST. NO.		ILLINOIS FED. AID PROJECT		

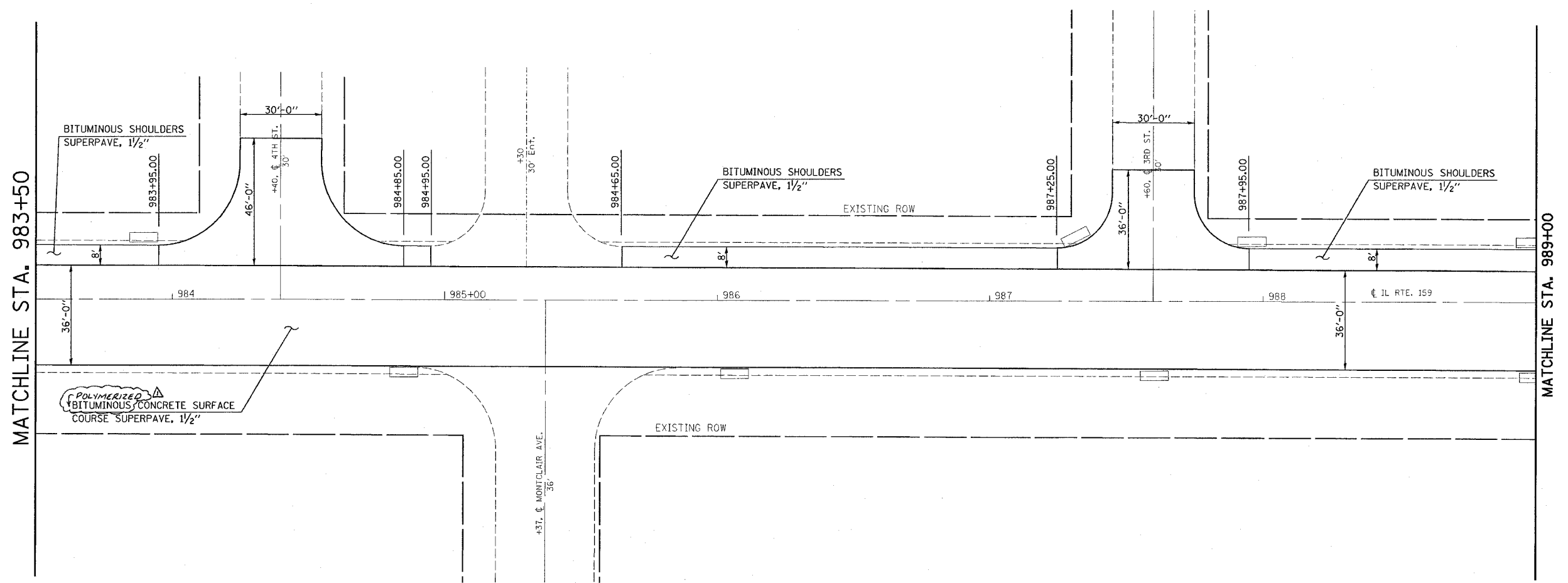

MATCHLINE STA. 983+50

MATCHLINE STA. 989+00

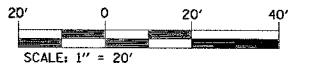

REVISIONS	
NAME	DATE

ILLINOIS DEPARTMENT OF TRANSPORTATION

**PLAN VIEW**

FAP ROUTE 600  
SECTION 34RS-2  
MADISON COUNTY

SCALE: VERT. \_\_\_\_\_  
HORIZ. \_\_\_\_\_

DATE \_\_\_\_\_ DRAWN BY \_\_\_\_\_  
CHECKED BY \_\_\_\_\_

PLOT DATE = 5/15/2006  
 PLOT SCALE = 20' = 1" (AS SHOWN)  
 USER NAME = dntalman.jr

Rev. 7-18-06