

F.A.P. RTE.	SECTION	COUNTY	TOTAL SHEETS	SHEET NO.
600	34RS-2	ST. CLAIR	39	13
STA. 989+00.00		TO STA. 995+00.00		
FED. ROAD DIST. NO. ILLINOIS FED. AID PROJECT				

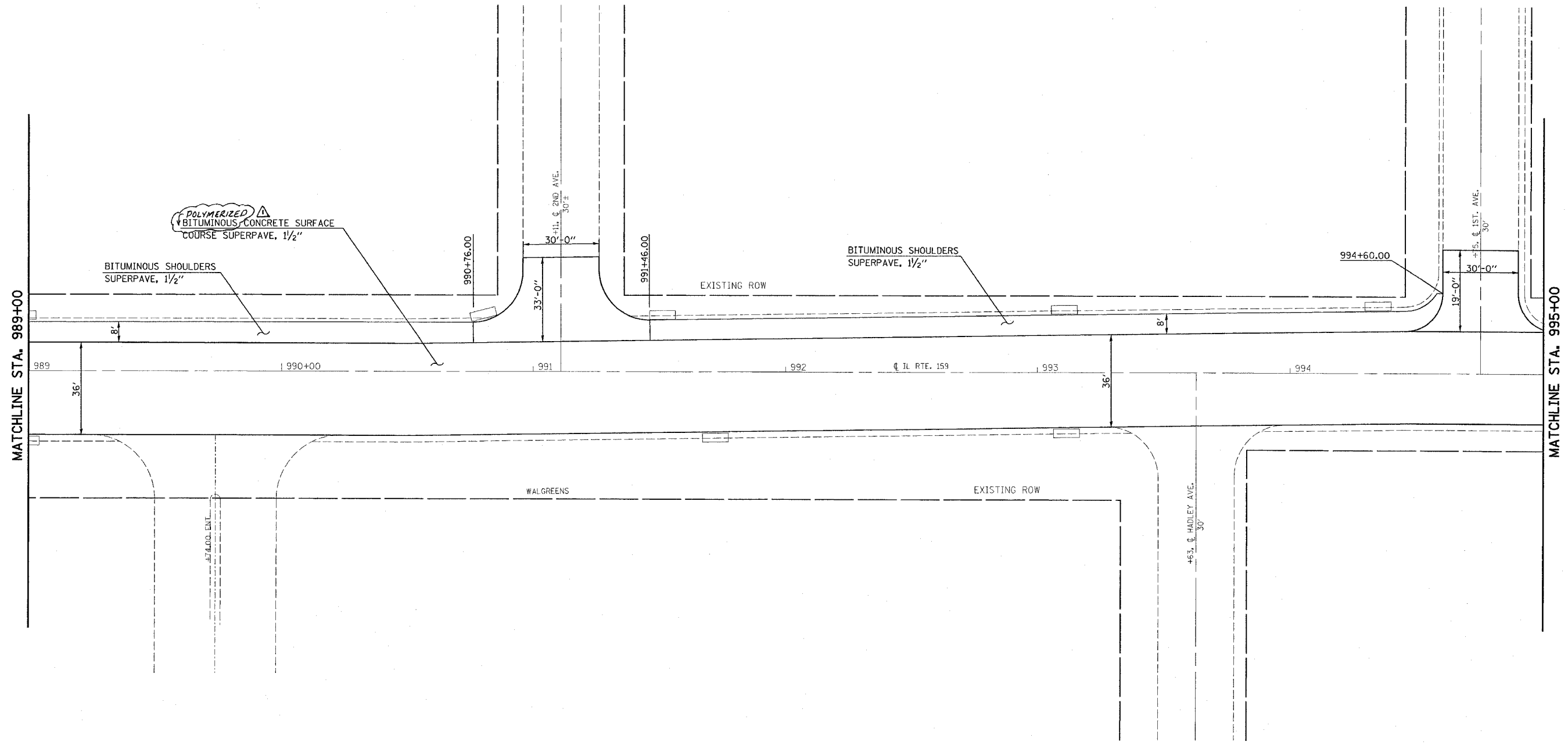

MATCHLINE STA. 989+00

MATCHLINE STA. 995+00

POLYMERIZED BITUMINOUS CONCRETE SURFACE COURSE SUPERPAVE, 1 1/2"

BITUMINOUS SHOULDERS SUPERPAVE, 1 1/2"

BITUMINOUS SHOULDERS SUPERPAVE, 1 1/2"

EXISTING ROW

WALGREENS

EXISTING ROW

63' ± HADLEY AVE.

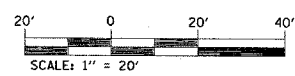

REVISIONS	
NAME	DATE

ILLINOIS DEPARTMENT OF TRANSPORTATION

PLAN VIEW

FAP ROUTE 600
SECTION 34RS-2
MADISON COUNTY

SCALE: VERT. HORIZ.
DATE

DRAWN BY
CHECKED BY

PLOT DATE = 5/15/2006
FILE NAME = c:\projects\fed\7188\plan\plan1809a.dgn
PLOT SCALE = 20,000 / 1 IN.
USER NAME = dunnahany

Rev. 7-18-06