

F.A.P. RTE.	SECTION	COUNTY	TOTAL SHEETS	SHEET NO.
600	34RS-2	ST. CLAIR	39	18
STA. 1028+60.00		TO STA. 86+50.00		
FED. ROAD DIST. NO.		ILLINOIS FED. AID PROJECT		

MATCHLINE STA. 1028+50

MATCHLINE STA. 81+00

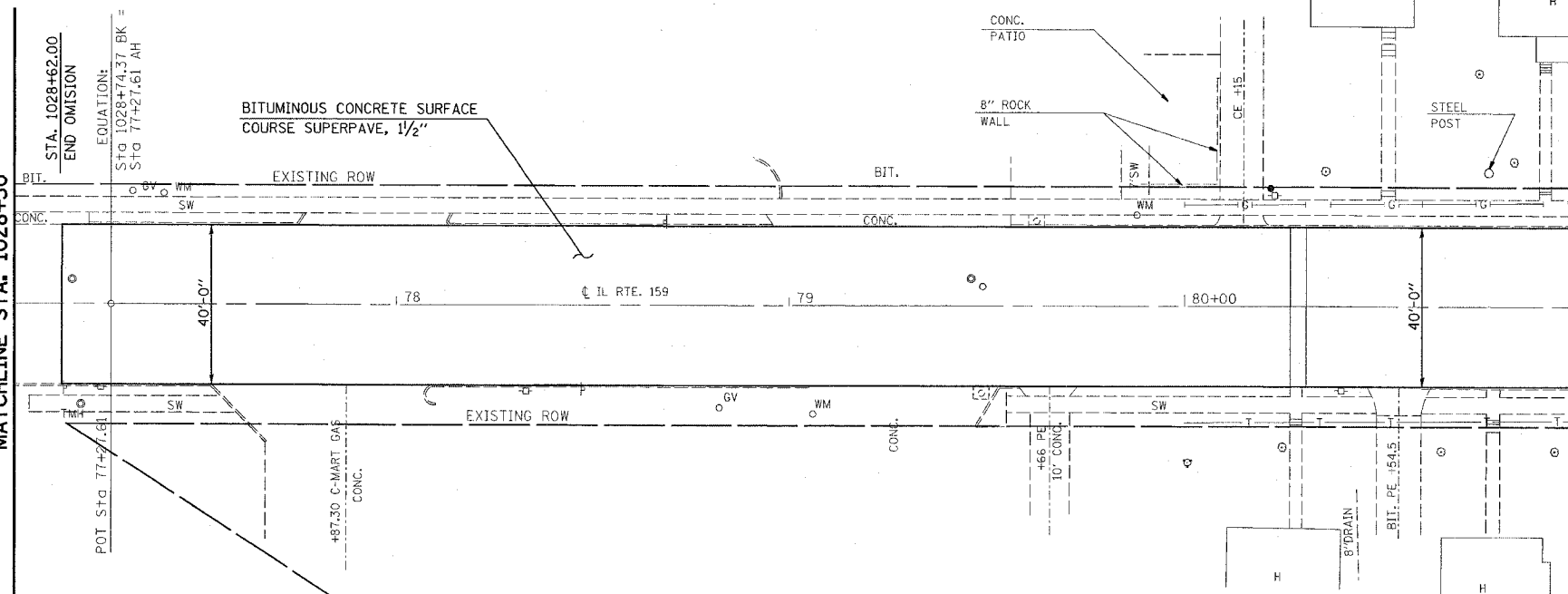

MATCHLINE STA. 81+00

MATCHLINE STA. 86+50

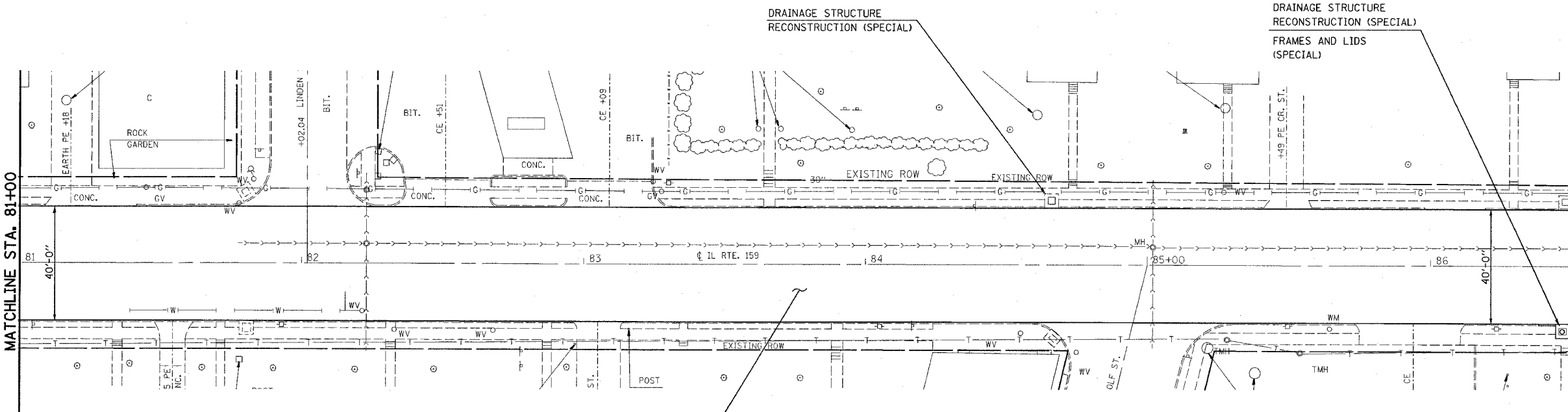

BITUMINOUS CONCRETE SURFACE COURSE SUPERPAVE, 1 1/2"

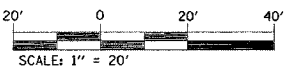

REVISIONS	
NAME	DATE

ILLINOIS DEPARTMENT OF TRANSPORTATION  
**PLAN VIEW**  
 FAP ROUTE 600  
 SECTION 34RS-2  
 MADISON COUNTY

SCALE: VERT. \_\_\_\_\_  
 HORIZ. \_\_\_\_\_  
 DATE \_\_\_\_\_

DRAWN BY \_\_\_\_\_  
 CHECKED BY \_\_\_\_\_

PLOT DATE = 5/15/2006  
 PLOT SCALE = 20.0000 / IN.  
 USER NAME = dmsalmanj