

F.A.S. RTE.	SECTION	COUNTY	TOTAL SHEETS	SHEET NO.
1780	24-BR-2	CLINTON	63	6
STA.		TO STA.		
FED. ROAD DIST. NO.	ILLINOIS	FED. AID PROJECT		

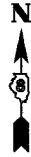

NOTE:  
GUARDRAIL POSTS WERE  
COUNTED FROM EAST TO  
WEST - STARTING WEST OF  
CHOPPER ROAD (SOUTHERN  
GUARDRAIL)

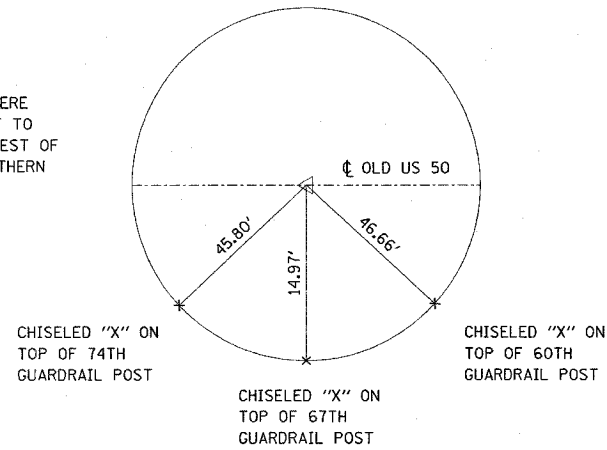

TIE POINT  
MAG NAIL  
P.C. STA 96+13.45

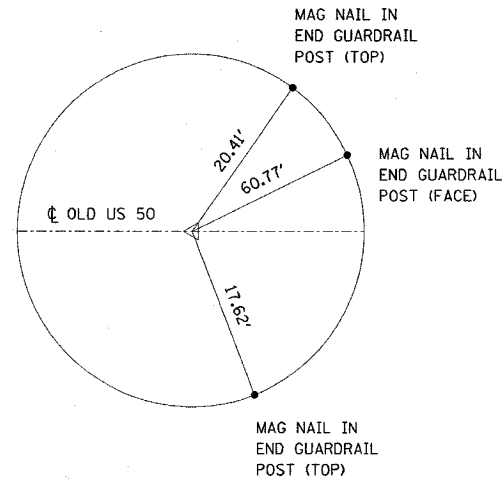

TIE POINT  
MAG NAIL  
P.T. STA 100+22.71

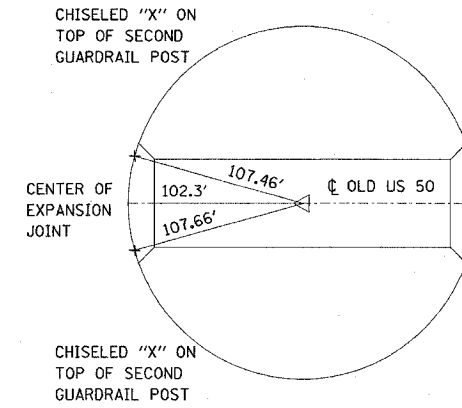

TIE POINT  
MAG NAIL  
STA 102+51.47

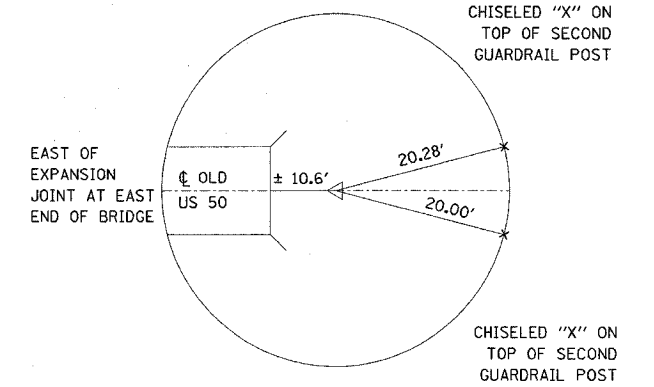

TIE POINT  
MAG NAIL  
P.O.L. STA 110+00

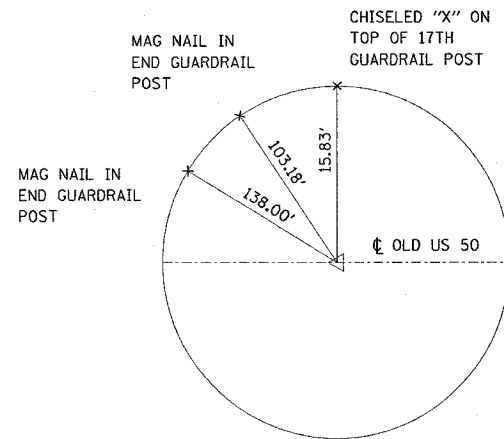

TIE POINT  
MAG NAIL  
P.O.L. STA 115+43.00

NOTE:  
GUARDRAIL POSTS WERE  
COUNTED FROM WEST TO  
EAST- STARTING AT NW  
FIELD ENTRANCE  
(NORTHERN GUARDRAIL)

BENCHMARK

NGS BM K-152 - BRASS DISK SET IN THE TOP OF NORTH END OF EAST ABUTMENT OF STEEL RR BRIDGE OVER SHOAL CREEK NEAR MILEPOLE 297-19, APPROX 0.4 MILES SOUTH OF BRIDGE SN 014-0062 ON OLD US RTE 50  
ELEV = 439.110

TEMPORARY BENCHMARKS

TBM-1 - RR SPIKE IN W. SIDE OF 1ST POWERPOLE IN ROW OF 7 ON EAST SIDE OF DRIVEWAY TO NEW WATER TREATMENT PLANT, APPROX. 200' SOUTH OF WEST END OF BRIDGE SN 014-0062  
STA 101+86 OFFSET = 124' RT  
ELEV = 437.930

TBM-2 - CENTER OF BRASS DISK FOUND ON SW WINGWALL OF SN 014-0062  
STA 101+45.2 OFFSET = 19.6' RT  
ELEV = 442.723

TBM-3 - SQUARE CUT IN TOP OF EAST END OF SE CONCRETE RAILWALL FOR BRIDGE SN 014-0062  
STA 110+10.1 OFFSET = 16.2' RT  
ELEV = 444.140

NOTE: ALL TIES PULLED DIRECT

PLOT DATE = #DAYS\*  
FILE NAME = #FILE#\*  
PLOT SCALE = #SCALE\*  
REFERENCE = #REF#

REVISIONS	
NAME	DATE

ILLINOIS DEPARTMENT OF TRANSPORTATION

**TIE POINTS AND BENCHMARKS**

FAS ROUTE 1780  
SECTION 24-BR-2  
CLINTON COUNTY