

F.A. RTE.	SECTION	COUNTY	TOTAL SHEETS	SHEET NO.
	05-00194-00-RP	COOK	58	22
STA.		TO STA.		
FED. ROAD DIST. NO.		ILLINOIS FED. AID PROJECT		

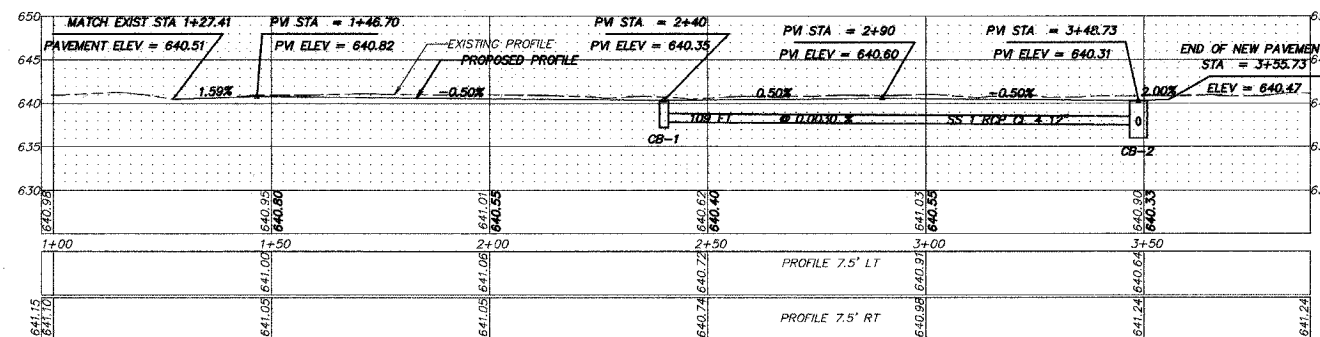
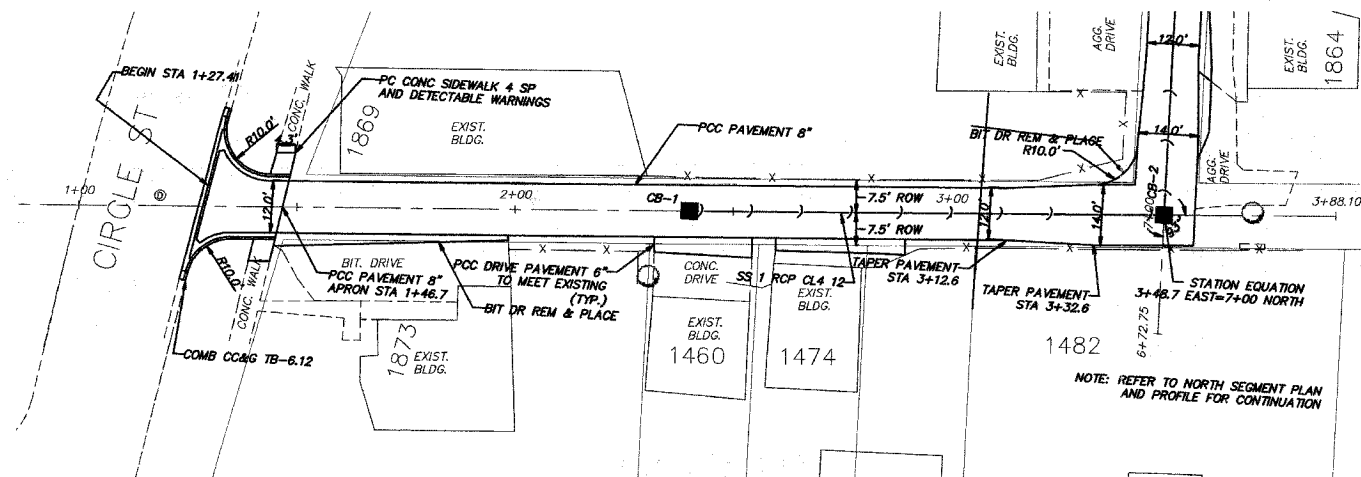
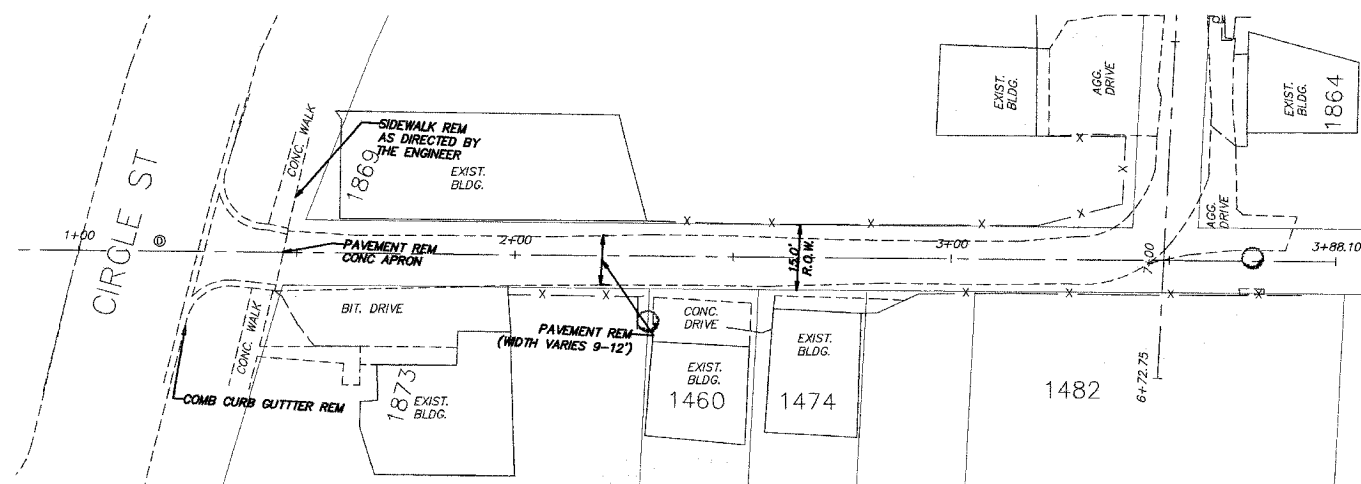

PROPOSED STRUCTURE DATA:  
 CB-1 CB TY C 4 FT DIA  
 ROUND FRAME OPEN LID  
 STA-2+40.0' R  
 RM-640.33  
 INV.-637.85 (E)

CB-2 CB TY A 4 FT DIA  
 ROUND FRAME OPEN LID  
 STA-3+49.0' R  
 RM-640.31  
 INV.-637.52 (W)  
 INV.-637.42 (N)

REVISIONS	
NAME	DATE

ILLINOIS DEPARTMENT OF TRANSPORTATION  
 CITY OF DES PLAINES - ALLEY IMPROVEMENTS  
 CIRCLE - ILLINOIS ALLEY  
 CIRCLE TO CIRCLE

PLAN AND PROFILE (EAST SEGMENT)

STA 1+27.41 TO 3+55.73  
 SCALE: VERT. 1" = 5'  
 HORIZ. 1" = 20'  
 DATE 2-17-06  
 DRAWN BY BLS  
 CHECKED BY AJD