

### STAGE 1A

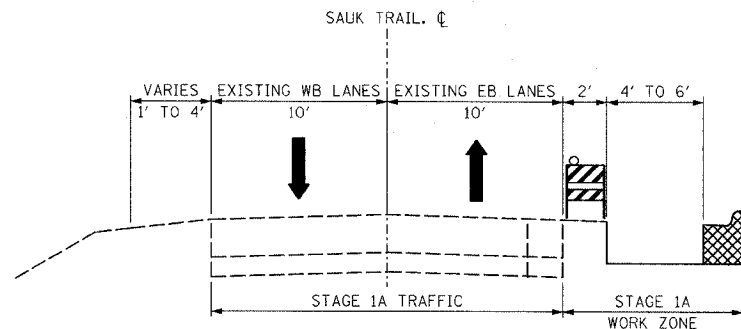

DURING STAGE 1A, BOTH EASTBOUND (EB) AND WESTBOUND (WB) LANES SHALL REMAIN OPEN TO TRAFFIC. THE CONTRACTOR WILL BE ABLE TO INSTALL CURB AND GUTTER, SIDEWALK, DRAINAGE STRUCTURES AND SEWER LATERALS.

HIGHWAY STANDARDS: 701001-01, 701006-02, 701011-01, 701301-02, 701801-03, 702001-06

### STAGE 2A

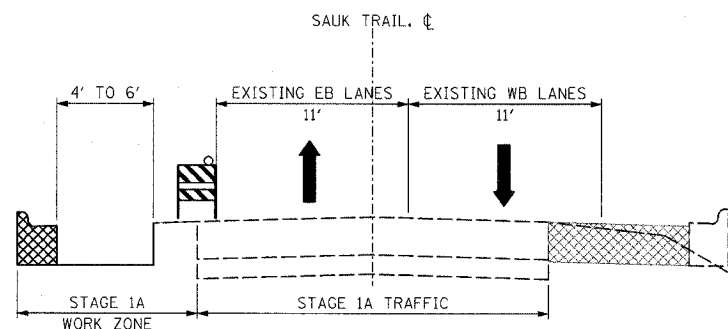

DURING STAGE 2A, BOTH EASTBOUND (EB) AND WESTBOUND (WB) LANES SHALL REMAIN OPEN TO TRAFFIC. THE CONTRACTOR WILL BE ABLE TO INSTALL CURB AND GUTTER, SIDEWALK, DRAINAGE STRUCTURES AND SEWER LATERALS.

HIGHWAY STANDARDS: 701001-01, 701006-02, 701011-01, 701301-02, 701801-03, 702001-06

### STAGE 1B

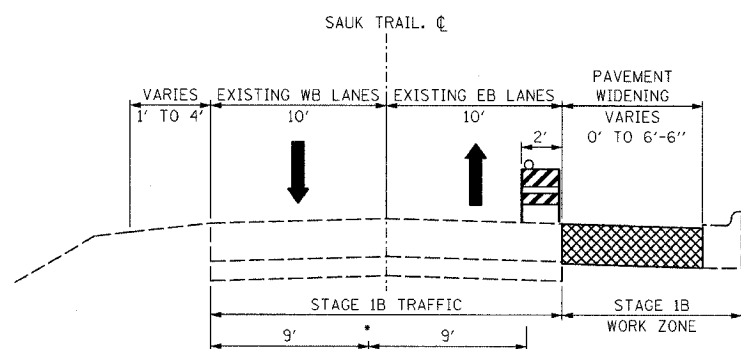

DURING STAGE 1B, THE EASTBOUND AND WESTBOUND TRAFFIC LANES WIDTH SHALL BE REDUCED TO 9 FEET. THE CONTRACTOR WILL BE ABLE TO EXCAVATE AND PLACE THE SUBBASE, BASE, AND BINDER COURSES FOR THE PAVEMENT WIDENING AND GRADE THE PARKWAYS AS REQUIRED. THE CONTRACTOR SHALL CLOSE THE EB TRAVEL LANES, AS APPROVED BY THE ENGINEER, TO GRIND THE EXISTING PAVEMENT AND PATCH TO THE REQUIRED DEPTH AS NECESSARY. THE REQUIRED GRINDING DEPTH WILL BE ACHIEVED BY BITUMINOUS SURFACE REMOVAL - VARIABLE DEPTH. DURING DAY TIME OPERATIONS FLAGGERS SHALL BE USED TO CONTROL TRAFFIC IN LOCATIONS WHERE THE TRAFFIC WIDTH IS LESS THAN 18 FEET AT ANY TIME. THE CONTRACTOR SHALL ENSURE THAT TWO LANES SHALL BE PROVIDED AT ALL TIMES AT NIGHT.

HIGHWAY STANDARDS: 701001-01, 7001006-02, 701011-02, 701201-02, 701301-02, 701306-01, 701326-02, 701501-03, 701801-03, 702001-06

### STAGE 2B

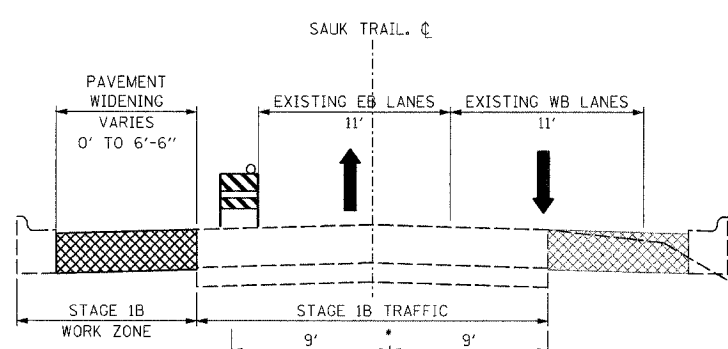

DURING STAGE 2B, THE EASTBOUND AND WESTBOUND TRAFFIC LANES WIDTH SHALL BE REDUCED TO 9 FEET. THE CONTRACTOR WILL BE ABLE TO EXCAVATE AND PLACE THE SUBBASE, BASE, AND BINDER COURSES FOR THE PAVEMENT WIDENING AND GRADE THE PARKWAYS AS REQUIRED. THE CONTRACTOR SHALL CLOSE THE EB TRAVEL LANES, AS APPROVED BY THE ENGINEER, TO GRIND THE EXISTING PAVEMENT AND PATCH TO THE REQUIRED DEPTH AS NECESSARY. THE REQUIRED GRINDING DEPTH WILL BE ACHIEVED BY BITUMINOUS SURFACE REMOVAL - VARIABLE DEPTH. DURING DAY TIME OPERATIONS FLAGGERS SHALL BE USED TO CONTROL TRAFFIC IN LOCATIONS WHERE THE TRAFFIC WIDTH IS LESS THAN 18 FEET AT ANY TIME. THE CONTRACTOR SHALL ENSURE THAT TWO LANES SHALL BE PROVIDED AT ALL TIMES AT NIGHT.

HIGHWAY STANDARDS: 701001-01, 7001006-02, 701011-02, 701201-02, 701301-02, 701306-01, 701326-02, 701501-03, 701801-03, 702001-06

### GENERAL NOTES

- ONE LANE OF TRAFFIC IN EACH DIRECTION SHALL BE MAINTAINED AT ALL TIMES.
- THE MAXIMUM ALLOWABLE LANE DROP DIFFERENTIAL ALLOWED WILL BE 2-1/4".
- DETOURS ARE NOT ANTICIPATED BUT WILL BE ALLOWED IF APPROVED BY THE ENGINEER. THEIR COST WILL BE INCLUDED IN THE TRAFFIC CONTROL AND PROTECTION PAY ITEM. SAUK TRAIL DETOURS WILL BE REQUIRED TO DIRECT TRAFFIC TO NEBRASKA STREET AND SHALL BE INSTALLED ACCORDING TO THE LATEST MANUAL ON UNIFORM TRAFFIC CONTROL DEVICES MANUAL AND APPLICABLE IDOT HIGHWAY STANDARDS.
- SIDE ROAD ACCESS MUST BE MAINTAINED DURING CONSTRUCTION. TEMPORARY PAVEMENT QUANTITY IS INCLUDED TO RE-ESTABLISH CROSS TRAFFIC FOLLOWING THE GRINDING OPERATION. TEMPORARY RAMPS AND A SUITABLE DRIVING SURFACE SHALL BE PROVIDED FOR CROSS TRAFFIC IMMEDIATELY FOLLOWING GRINDING ACROSS AN INTERSECTION.
- ANY SIDEWALK CLOSURES REQUIRED ALONG THE PROJECT CORRIDOR SHALL BE DONE ACCORDING TO HIGHWAY STANDARD 701801-03.
- THE CONTRACTOR WILL BE REQUIRED TO SUBMIT DETAILED WORK SCHEDULES FOR EACH LOCATION ALONG THE PROJECT CORRIDOR. THE SCHEDULES SHALL BE APPROVED BY THE VILLAGE OF FRANKFORT AND THE ENGINEER PRIOR TO THE CONTRACTOR STARTING WORK IN ANY AREA.
- WEEKLY PROGRESS MEETINGS SHALL BE HELD BY THE CONTRACTOR TO UPDATE THE VILLAGE AND RESIDENTS.

### STAGE 3

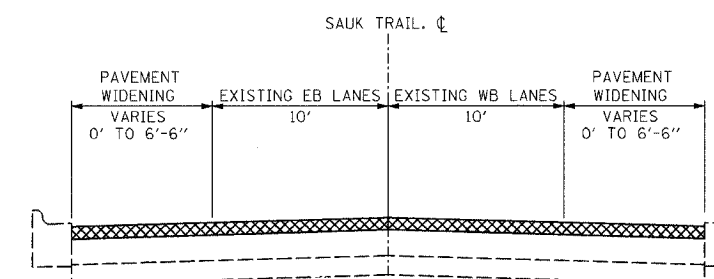

DURING STAGE 3, ONE LANE OF TRAFFIC SHALL BE MAINTAINED IN EACH DIRECTION. THE CONTRACTOR WILL BE ABLE TO PLACE THE SURFACE COURSE, AND PERMANENT PAVEMENT MARKINGS

HIGHWAY STANDARDS: 701306-01, 701311-02, 701502-01, 701801-03, 702001-06

	REVISIONS		ILLINOIS DEPARTMENT OF TRANSPORTATION FAU 3735 SAUK TRAIL SUGGESTED STAGES OF CONSTRUCTION	
	NAME	DATE		
			SCALE: VERT. NTS HORIZ. NTS DATE 04/21/2006	DRAWN BY JBH CHECKED BY JRM

DATE: 02/27/12 PM

DATE: 04/23/06

DATE: 04/23/06