

F.A. RTE.	SECTION	COUNTY	TOTAL SHEETS	SHEET NO.
	05-00001-01-PV	DEKALB	38	24
STA. 18+65		TO STA. 24+50		
ILLINOIS FED. AID PROJECT				

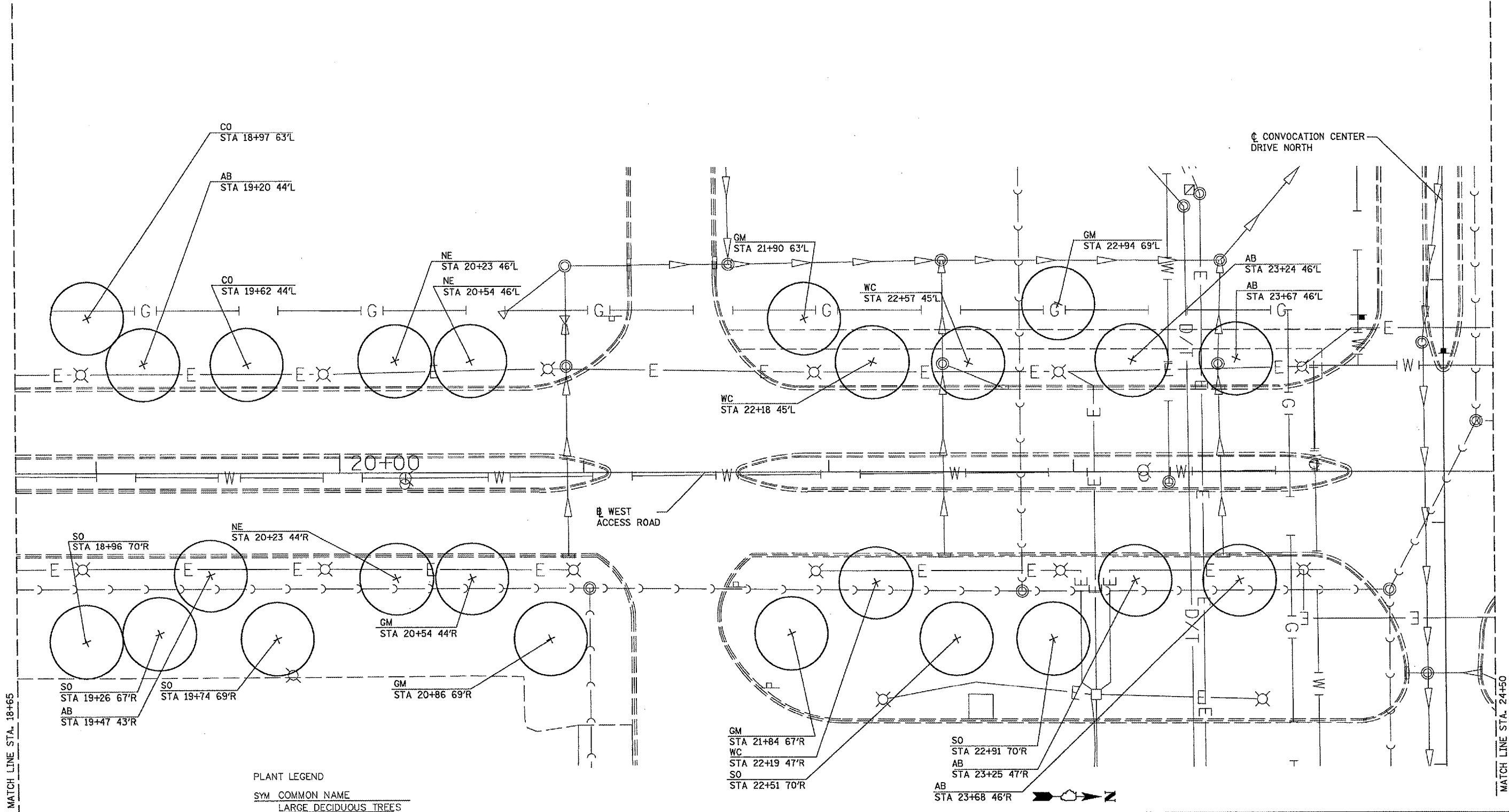

PLANT LEGEND

SYM	COMMON NAME
	LARGE DECIDUOUS TREES
AB	AUTUMN BLAZE MAPLE
CO	CHINQUAPIN OAK
GM	MAGYAR GINKGO
NE	NEW HOMESTEAD ELM
SH	SHADEMASTER HONEYLOCUST
SL	STERLING SILVER LINDEN
SO	SWAMP WHITE OAK
TT	TULIP TREE
WC	WINDY CITY HACKBERRY

NOTES:
 1. MAKE MINOR FIELD ADJUSTMENTS IN TREE LOCATIONS TO AVOID OBSTRUCTIONS AS DIRECTED BY ENGINEER.
 2. TREES NOT IN THE PARKWAY SHOULD BE A MINIMUM OF PLUS OR MINUS 10' FROM BACK EDGE OF THE SIDEWALK.
 3. SEE LANDSCAPE DETAIL SHEET FOR TREE PLANTING DETAIL.

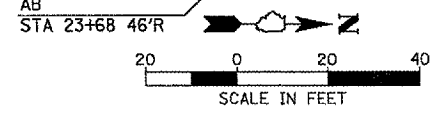

SAA SCHREIBER / ANDERSON ASSOCIATES, INC.
 717 John Nolen Drive
 Madison, WI 53713 608-255-0800

REVISIONS	
NAME	DATE

ILLINOIS DEPARTMENT OF TRANSPORTATION
 SECTION 05-00001-01-PV
 DEKALB COUNTY
 NORTHERN ILLINOIS UNIVERSITY WEST ACCESS ROAD
 LANDSCAPE PLANS
 SCALE: AS SHOWN
 DATE: 05/18/06
 DRAWN BY SA
 CHECKED BY SA

HANSON Professional Services Inc. 2006
 Copyright Hanson Professional Services Inc. 2006
 LAYOUT SA 02/21/06 rwh
 DRAWN SA 02/21/06 09/09/2006 11:35 AM
 REVIEWED SA 02/21/06 10:05:00 05/18/06 C:\DDV\scopel\LS3.dwg