

STATE OF ILLINOIS
 DEPARTMENT OF TRANSPORTATION
 DIVISION OF HIGHWAYS
 PLANS FOR PROPOSED
 FEDERAL-AID LAPP PROJECT
 LAWRENCE COUNTY
 SECTION 03-00101-00-RS
 F.A.S. ROUTE 801 (C.H. 10)
 PROJECT NO. RS-801(229)
 JOB NO. C-97-069-06

INDEX OF SHEETS

- 1 COVER SHEET
- 2 SUMMARY OF QUANTITIES
- 2-3 TYPICAL SECTIONS AND DETAILS
- 4-5 CROSS SECTIONS AT A.R. PIPES

- STANDARDS:
- 280001-02 - EROSION CONTROL
 - 442201-01 - PATCHING
 - 630001-06 - SPBGR
 - 630301-03 - SHOULDER WIDENING
 - 701306-01 - TRAFFIC
 - 701336-04 - TRAFFIC
 - 702001-06 - TRAFFIC
 - BLR 21-6 - TRAFFIC
 - BLR 22-4 - TRAFFIC
 - 780001-01 - TYPICAL PAVEMENT MARKINGS
 - 701006-02 - TRAFFIC
 - 701301-02 - TRAFFIC
 - 701311-02 - TRAFFIC
 - 630101-06 - GUARDRAIL MOUNTED ON EXIST. CULVERT

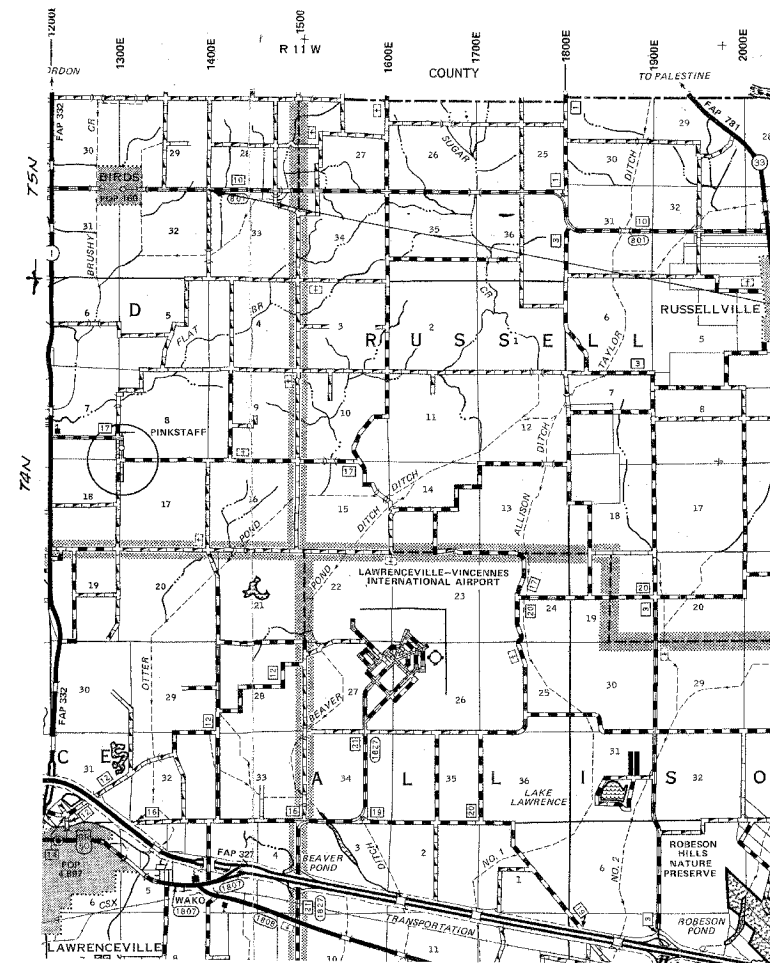

SECTION 03-00101-00-RS
 BEGINS STA. 0+00 AND ENDS STA. 349+70.80
 BUILT AS SECTION 62Q IN 1958

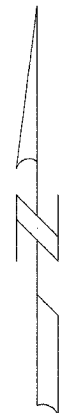

FUNCTIONAL CLASS: RURAL MAJOR COLLECTOR
 ADT = 375
 DESIGN SPEED : 50 MPH

CONTRACT NO. 95418

LOCATION MAP

APPROXIMATE SCALE: 1 INCH = 1 MILE
 NET LENGTH = 34,970.8 L.F. = 6.623 MILES

TOLL FREE JOINT UTILITY LOCATING
 INFORMATION FOR EXCAVATORS (A.U.L.I.E.)
 TELEPHONE NO. 1-800-892-0123

PROFESSIONAL DESIGN FIRM #184-000832

Michael Ross
 ILLINOIS REGISTERED PROFESSIONAL ENGINEER # 31350
 LICENSE EXPIRES FEBRUARY 30, 2007

| |
|--|
| APPROVED <u>1-30</u> , 2006 <i>[Signature]</i> LOCAL AGENCY REPRESENTATIVE |
| PASSED <u>5/24</u> , 2006 <i>Manuel E. Kavel</i> DISTRICT SEVEN ENGINEER OF LOCAL ROADS & STREETS |
| RELEASING FOR BID BASED ON LIMITED REVIEW <u>5/24</u> , 2006 <i>Christina Ross</i> DEPUTY DIRECTOR OF HIGHWAYS REGION FOUR ENGINEER STATE OF ILLINOIS DEPARTMENT OF TRANSPORTATION |