

STATE OF ILLINOIS
DEPARTMENT OF TRANSPORTATION
DIVISION OF HIGHWAYS
PLANS FOR PROPOSED
FEDERAL-AID LAPP PROJECT
LAWRENCE COUNTY
SECTION 03-00101-00-RS
F.A.S. ROUTE 801 (C.H. 10)
PROJECT NO. RS-801(229)
JOB NO. C-97-069-06

INDEX OF SHEETS

- 1 COVER SHEET
- 2 SUMMARY OF QUANTITIES
- 2-3 TYPICAL SECTIONS AND DETAILS
- 4-5 CROSS SECTIONS AT A.R. PIPES

- STANDARDS:
- 280001-02 - EROSION CONTROL
 - 442201-01 - PATCHING
 - 630001-06 - SPBGR
 - 630301-03 - SHOULDER WIDENING
 - 701306-01 - TRAFFIC
 - 701336-04 - TRAFFIC
 - 702001-06 - TRAFFIC
 - BLR 21-6 - TRAFFIC
 - BLR 22-4 - TRAFFIC
 - 780001-01 - TYPICAL PAVEMENT MARKINGS
 - 701006-02 - TRAFFIC
 - 701301-02 - TRAFFIC
 - 701311-02 - TRAFFIC
 - 630101-06 - GUARDRAIL MOUNTED ON EXIST. CULVERT

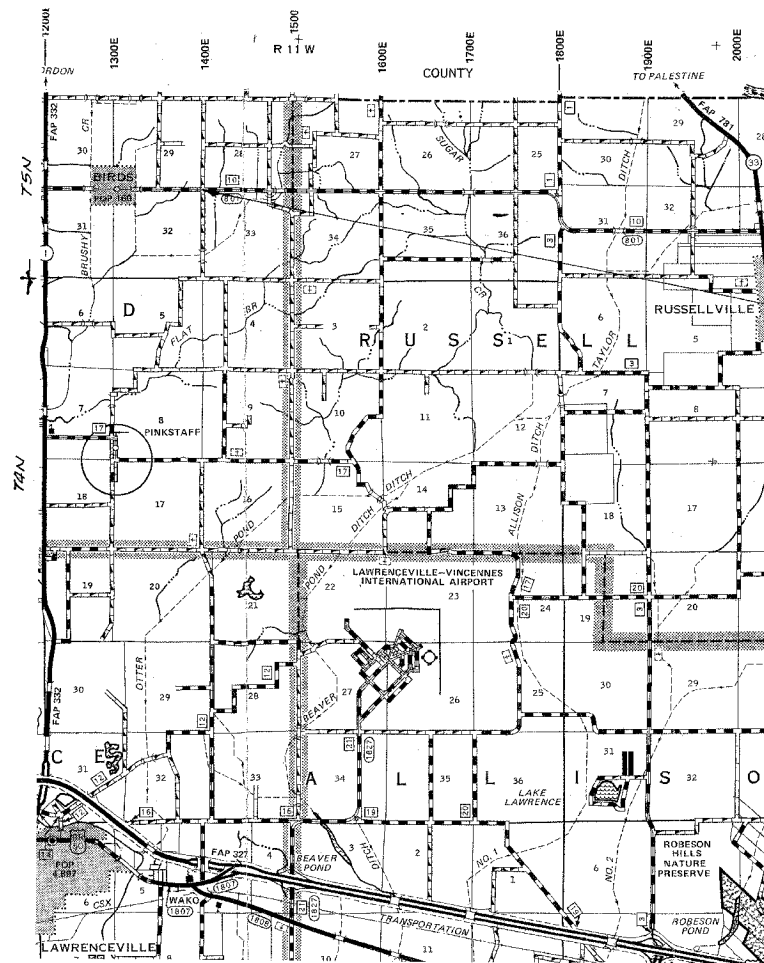

SECTION 03-00101-00-RS
BEGINS STA. 0+00 AND ENDS STA. 349+70.80
BUILT AS SECTION 62Q IN 1958

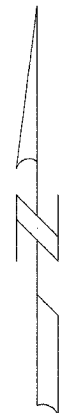

FUNCTIONAL CLASS: RURAL MAJOR COLLECTOR
ADT = 375
DESIGN SPEED : 50 MPH

CONTRACT NO. 95418

LOCATION MAP
APPROXIMATE SCALE: 1 INCH = 1 MILE
NET LENGTH = 34,970.8 L.F. = 6.623 MILES

TOLL FREE JOINT UTILITY LOCATING
INFORMATION FOR EXCAVATORS (A.U.L.I.E.)
TELEPHONE NO. 1-800-892-0123

PROFESSIONAL DESIGN FIRM #184-000832

Michael Ross
MICHAEL ROSS ENGINEER
ILLINOIS REGISTERED PROFESSIONAL ENGINEER # 31350
LICENSE EXPIRES MARCH 30, 2007
1/27/2006

APPROVED <u>1-30</u> , 2006 <i>[Signature]</i> LOCAL AGENCY REPRESENTATIVE
PASSED <u>5/24</u> , 2006 <i>Maureen Kavel</i> DISTRICT SEVEN ENGINEER OF LOCAL ROADS & STREETS
RELEASING FOR BID BASED ON LIMITED REVIEW <u>5/24</u> , 2006 <i>Christina Ross</i> DEPUTY DIRECTOR OF HIGHWAYS REGION FOUR ENGINEER STATE OF ILLINOIS DEPARTMENT OF TRANSPORTATION

F.A.S. ROUTE NO.	SECTION	COUNTY	TOTAL SHEETS	SHEET
801	03-00101-00-RS	LAWRENCE	5	2
STA. CONT. # 95418		TO STA.		
FED. ROAD DIST. NO.	ILLINOIS	PROJECT		

SUMMARY OF QUANTITIES

QTY	UNIT	ITEM	I000 CODE NO
6,360	FOOT	SHORT-TERM PAVEMENT MARKING REMOVAL	XX003140
4,468	TON	LEVELING BINDER (MACHINE METHOD), SUPERPAVE N50	X4066765
11,432	TON	BITUMINOUS CONCRETE SURFACE COURSE, SUPERPAVE, MIX "C", N50	X4066414
279	CU YD	FURNISHED EXCAVATION	20400800
296	CU YD	TRENCH BACKFILL	20800150
0.3	ACRE	SEEDING, CLASS 2 (SPECIAL)	25001000
50	TON	STONE DUMPED RIPRAP, CLASS A4	28100807
100	TON	AGGREGATE SURFACE COURSE, TYPE B	40200800
7,771	GALLON	BITUMINOUS MATERIALS (PRIME COAT)	40600100
155	TON	AGGREGATE (PRIME COAT)	40600300
767	SQ YD	BITUMINOUS SURFACE REMOVAL 1 1/4"	44000005
511	SQ YD	BITUMINOUS SURFACE REMOVAL 2"	44000007
50	SQ YD	CLASS D PATCHES, TYPE I, 8 INCH	44201737
100	SQ YD	CLASS D PATCHES, TYPE II, 8 INCH	44201741
100	SQ YD	CLASS D PATCHES, TYPE III, 8 INCH	44201745
100	SQ YD	CLASS D PATCHES, TYPE IV, 8 INCH	44201747
77,711	SQ YD	AREA REFLECTIVE CRACK CONTROL TREATMENT, SYSTEM A	44300300
4,200	TON	AGGREGATE SHOULDERS, TYPE B	48101200
48	FOOT	PIPE CULVERTS, CLASS C, TYPE 1 24"	542C0229
134	FOOT	PIPE CULVERTS, CLASS C, TYPE 2 24"	542C1069
112	FOOT	PIPE CULVERTS, CLASS C, TYPE 2 30"	542C1075
62	FOOT	PIPE CULVERTS, CLASS C, TYPE 2 36"	542C1081
116	FOOT	PIPE CULVERTS, CLASS C, TYPE 2 60"	542C1105
48	FOOT	PIPE CULVERTS, CLASS C, TYPE 1 EQUIVALENT ROUND-SIZE 48"	542C5503
146	FOOT	PIPE CULVERTS, CLASS D, TYPE 1 15"	542D0220
50	FOOT	PIPE CULVERTS, CLASS D, TYPE 1 24"	542D0229
44	FOOT	STEEL PLATE BEAM GUARD RAIL, TYPE B	63000005 *
32	FOOT	STEEL PLATE BEAM GUARD RAIL, ATTACHED TO STRUCTURES	63000025 *
4	EACH	TRAFFIC BARRIER TERMINAL TYPE 1, SPECIAL (TANGENT)	63100167 *
3	CAL MO	ENGINEER'S FIELD LABORATORY	67000600
1	L SUM	TRAFFIC CONTROL AND PROTECTION, STANDARD 701306	70100460
1	L SUM	TRAFFIC CONTROL AND PROTECTION, STANDARD 701336	70100600
1	L SUM	TRAFFIC CONTROL AND PROTECTION	70101700
6,360	FOOT	SHORT-TERM PAVEMENT MARKING	70300100
36,693	FOOT	PAINT PAVEMENT MARKING-LINE 4"	78001110 *
4	EACH	TERMINAL MARKER - DIRECT APPLIED	78201000
100	SQ FT	SIGN PANEL - TYPE 1	72000100
504	FOOT	METAL POST - TYPE A	72900100
1	L SUM	MOBILIZATION	67100100

* SPECIALTY ITEMS

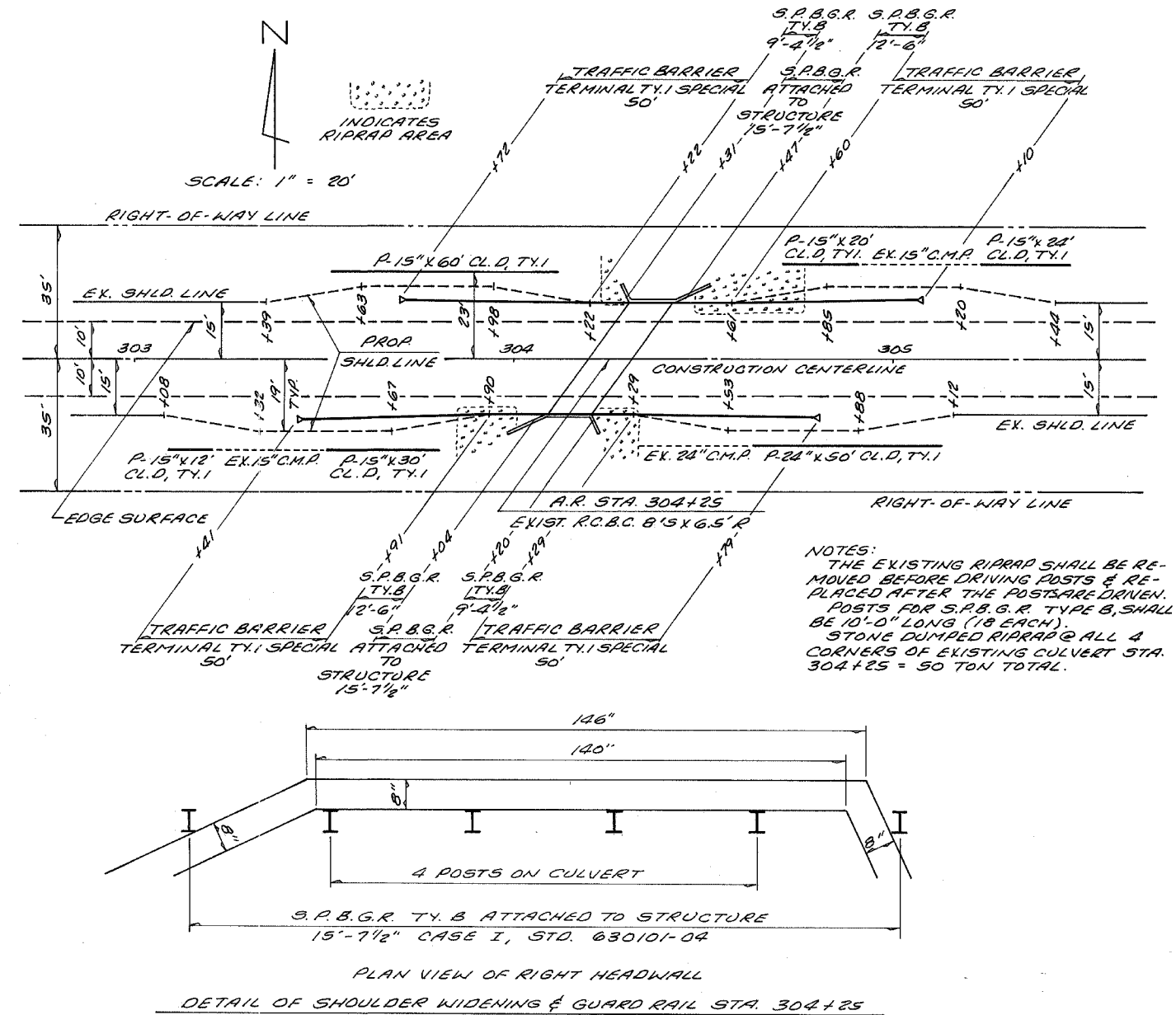

BITUMINOUS SURFACE REMOVAL

BRIDGE STA. 42+29	1 1/4" DEPTH	FROM WEST END BRIDGE TO 100' WEST & FROM EAST END BRIDGE TO 100' EAST (DO NOT REMOVE ON BRIDGE)
445 S.Y.		
BRIDGE STA. 161+99	2" DEPTH	FROM 100' WEST OF WEST END OF BRIDGE TO 100' EAST OF EAST END OF BRIDGE. (INCLUDES ACROSS BRIDGE)
511 S.Y.		
INTERSECTION @ RT. 33	1 1/4" DEPTH	FROM WEST EDGE OF RT. 33 PAVEMENT TO 100' WEST
322 S.Y.		

BITUMINOUS SURFACE REMOVAL 1 1/4" TOTAL = 767 S.Y.
 BITUMINOUS SURFACE REMOVAL 2" TOTAL = 511 S.Y.

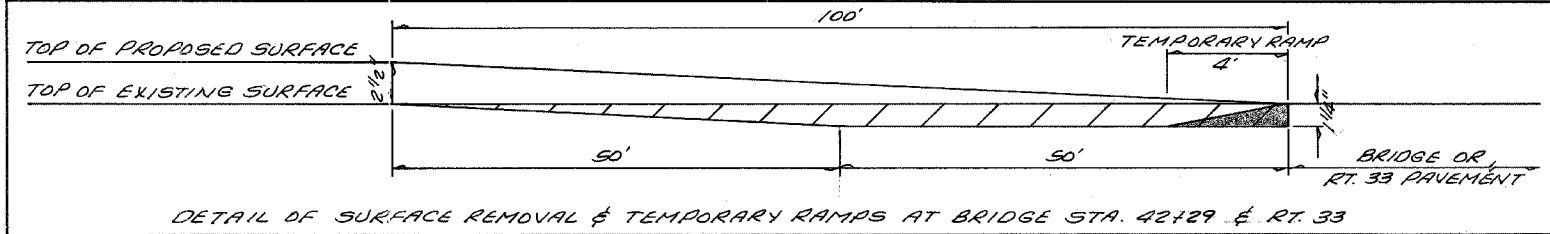

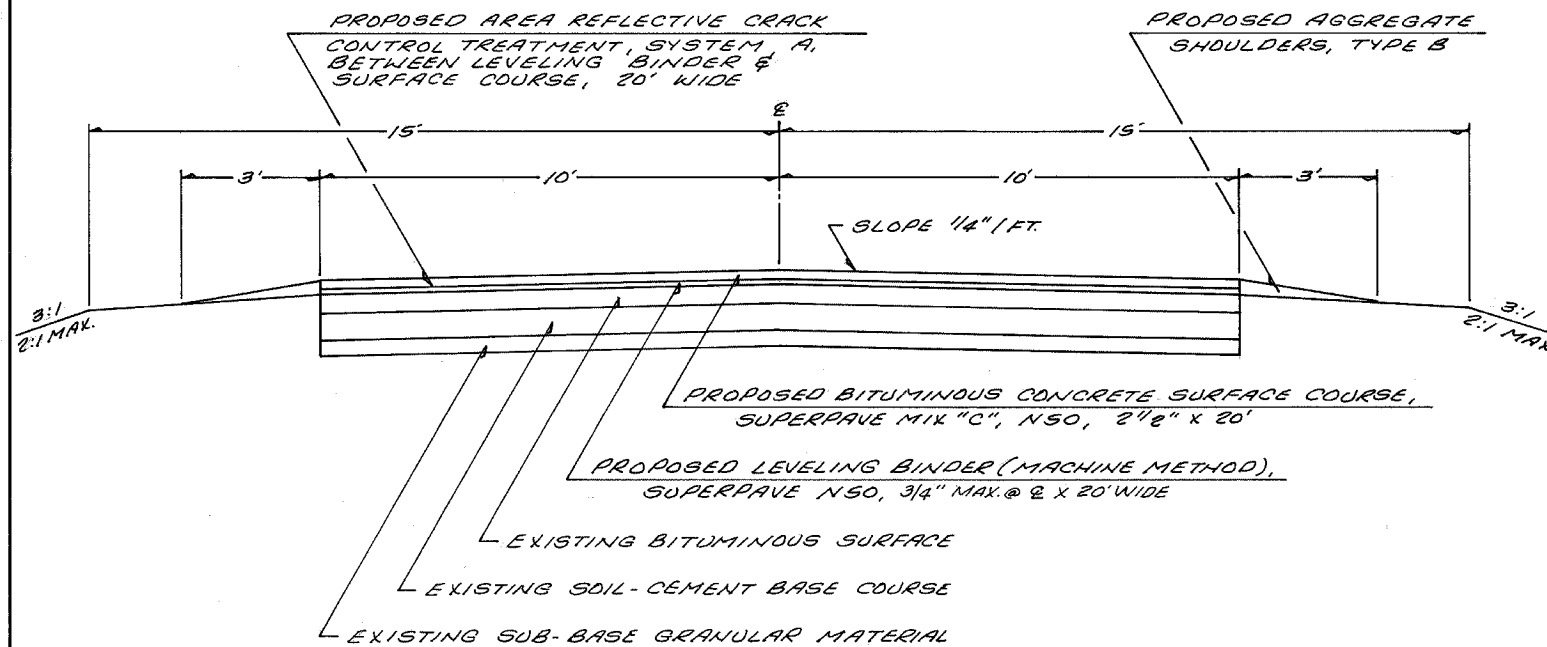

PAVEMENT DESIGN DATA

S.D.T. = YEAR 2010, P.V. = 362 S.U. = 29 M.U. = 21 CLASS III ROAD
 MINIMUM SOIL SUPPORT: I.B.R. = 2 (ASSUMED) D_f = 2.76

PAVEMENT STRUCTURE MATERIALS:

EXISTING PAVEMENT:	SUB-BASE GRANULAR MATERIAL	4"	4 x 0.07 = 0.28
	SOIL-CEMENT BASE COURSE	7"	7 x 0.11 = 0.77
	BITUMINOUS SURFACE ROAD MIX	2"	2 x 0.11 = 0.22
	BITUMINOUS CONCRETE CLASS I	1 1/2"	1 1/2 x 0.30 = 0.45
	SEAL COAT BUILD UP		
PROPOSED PAVEMENT:	BITUMINOUS CONCRETE SURFACE COURSE, SUPERPAVE, MIX "C", N50	2 1/2"	2 1/2 x 0.40 = 1.00
			TOTAL = 2.87

TYPICAL SECTION OF PROPOSED IMPROVEMENT
 STA. 0+00 TO STA. 349+70.80

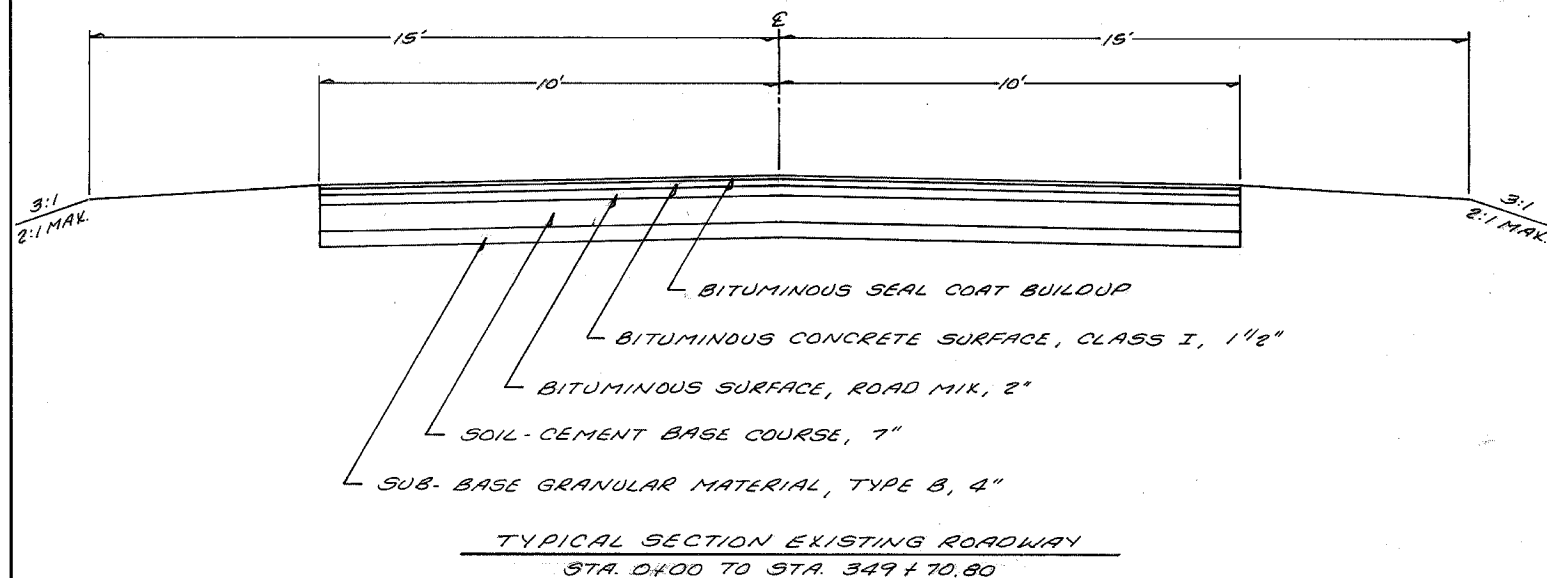

TYPICAL SECTION EXISTING ROADWAY
 STA. 0+00 TO STA. 349+70.80

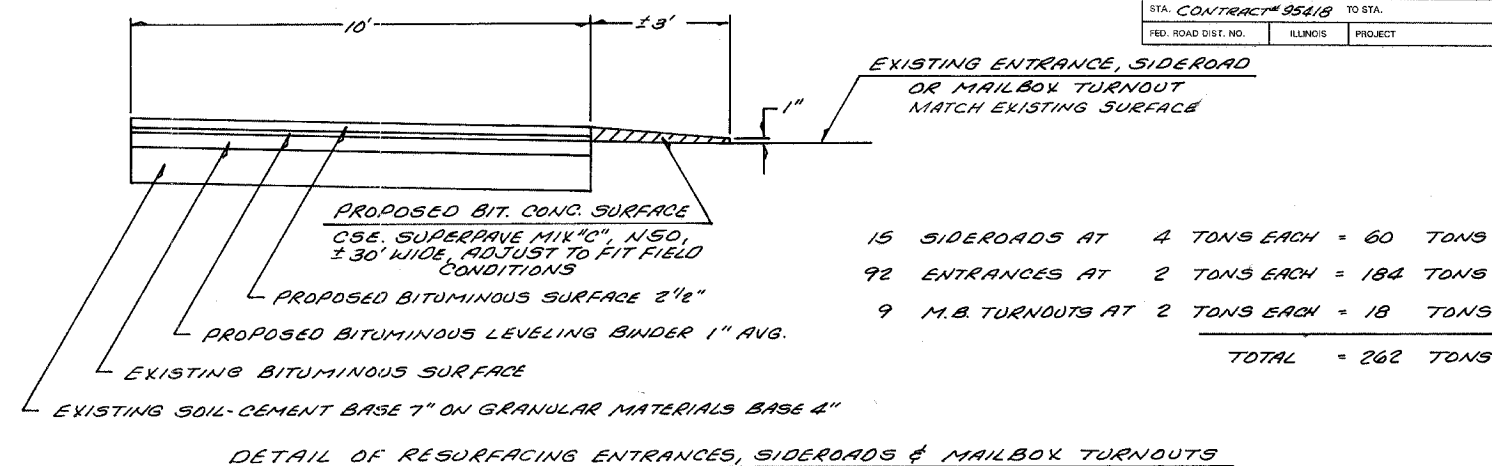

15 SIDEROADS AT 4 TONS EACH	= 60 TONS
92 ENTRANCES AT 2 TONS EACH	= 184 TONS
9 M.B. TURNOUTS AT 2 TONS EACH	= 18 TONS
TOTAL	= 262 TONS

DETAIL OF RESURFACING ENTRANCES, SIDEROADS & MAILBOX TURNOUTS

PROPOSED PIPE CULVERTS

STATION	PROPOSED PIPE	EXISTING PIPE TO BE REMOVED	U.S.F.L.	D.S.F.L.	D.A.	TRENCH BACKFILL	CLASS D PATCH	AGG. SURF. CSE. TY. B
A.R. STA. 33+62	TWIN P-60" x 58", CL.C, TY. 2	TWIN 60" C.M.P.	91.15	90.57	400 AC.	70 C.Y.	37 S.Y., TY. 4	25 TON
A.R. STA. 82+76	P-36" x 62", CL.C, TY. 2	36" C.M.P.	91.53	89.47	50 AC.	51 C.Y.	17 S.Y., TY. 3	11 TON
A.R. STA. 134+94	P-24" x 48", CL.C, TY. 1	18" C.M.P.	96.14	93.81	8 AC.	15 C.Y.	13 S.Y., TY. 2	9 TON
A.R. STA. 216+00	P-30" x 54", CL.C, TY. 2	30" C.M.P.	93.43	91.16	30 AC.	54 C.Y.	15 S.Y., TY. 2	11 TON
A.R. STA. 228+39	P-24" x 54", CL.C, TY. 2	24" C.M.P.	94.41	92.70	15 AC.	23 C.Y.	13 S.Y., TY. 2	9 TON
A.R. STA. 236+00	P-30" x 58", CL.C, TY. 2	30" C.M.P.	93.46	93.19	25 AC.	25 C.Y.	15 S.Y., TY. 2	11 TON
A.R. STA. 245+43	P-24" x 60", CL.C, TY. 2	24" C.M.P.	93.70	88.50	15 AC.	39 C.Y.	19 S.Y., TY. 2	9 TON
A.R. STA. 283+74	P-48" x 48", CL.C, TY. 1 EQUIV. ROUND SIZE	48" EQRS C.M.P.	94.90	94.40	100 AC.	19 C.Y.	20 S.Y., TY. 3	15 TON
TOTALS						296 C.Y.		100 TON

PAINT PAVEMENT MARKING LINE 4" (TOTAL = 36,693 FT.)

CENTERLINE STRIPE

STA. 0+00 TO STA. 349+70.80 = 6693 FT.

NO PASSING ZONE

LEFT SIDE (WEST BOUND)

STA. 21+00 - STA. 28+00 = 700'
STA. 62+00 - STA. 70+00 = 800'
STA. 82+00 - STA. 107+00 = 2500'
STA. 118+00 - STA. 153+00 = 3500'
STA. 190+00 - STA. 198+00 = 800'
STA. 208+00 - STA. 252+00 = 4400'
STA. 273+00 - STA. 284+00 = 1100'
STA. 297+00 - STA. 303+00 = 600'
STA. 343+00 - STA. 348+00 = 500'

RIGHT SIDE (EAST BOUND)

STA. 12+00 - STA. 18+00 = 600'
STA. 53+00 - STA. 62+00 = 900'
STA. 73+00 - STA. 98+00 = 2500'
STA. 109+00 - STA. 144+00 = 3500'
STA. 182+00 - STA. 189+00 = 700'
STA. 199+00 - STA. 245+00 = 4600'
STA. 264+00 - STA. 276+00 = 1200'
STA. 288+00 - STA. 294+00 = 600'
STA. 334+00 - STA. 339+00 = 500'

TOTAL = 30,000 FT.

NO PASSING ZONE SIGNS (W 1/2-3)

STA.	SIGN PANEL-TY. 1	METAL POST-TY. A	STA.	SIGN PANEL-TY. 1	METAL POST-TY. A
LT. 12+00	1 @ 5.56 S.F.	2 EA. @ 14 FT. = 28 FT.	LT. 199+00	1 @ 5.56 S.F.	2 EA. @ 14 FT. = 28 FT.
RT. 28+00	" 5.56 "	" " 28 "	RT. 252+00	" 5.56 "	" " 28 "
LT. 53+00	" 5.56 "	" " 28 "	LT. 264+00	" 5.56 "	" " 28 "
RT. 70+00	" 5.56 "	" " 28 "	RT. 284+00	" 5.56 "	" " 28 "
LT. 73+00	" 5.56 "	" " 28 "	LT. 288+00	" 5.56 "	" " 28 "
RT. 107+00	" 5.56 "	" " 28 "	RT. 303+00	" 5.56 "	" " 28 "
LT. 109+00	" 5.56 "	" " 28 "	LT. 334+00	" 5.56 "	" " 28 "
RT. 153+00	" 5.56 "	" " 28 "	RT. 348+00	" 5.56 "	" " 28 "
LT. 182+00	" 5.56 "	" " 28 "	TOTALS = 100.00 S.F.		504 FT.
RT. 198+00	" 5.56 "	" " 28 "			

STATE ROUTE NO.	SECTION	COUNTY	TOTAL SHEETS	SHEET
801	03-00101-00-RS	LAWRENCE	5	4
STA.	CONT. # 95418	TO STA.		
FED. ROAD DIST. NO.	ILLINOIS	PROJECT		

100
216
09
A.R. 216+00 RT.

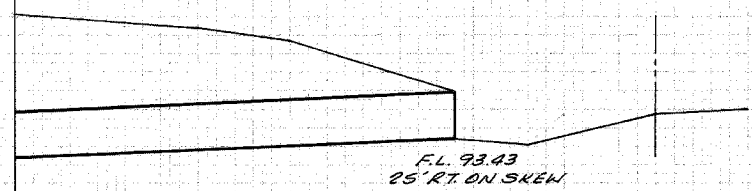

100
215
92
A.R. 216+00 LT.
PROPOSED P-30" x 54', CL.C, TY. 2

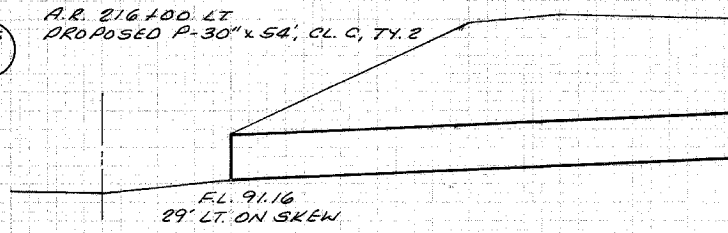

100
283
74
A.R.

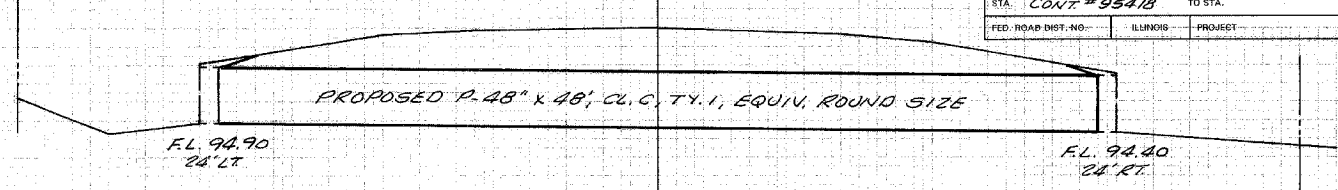

100
134
98
A.R.

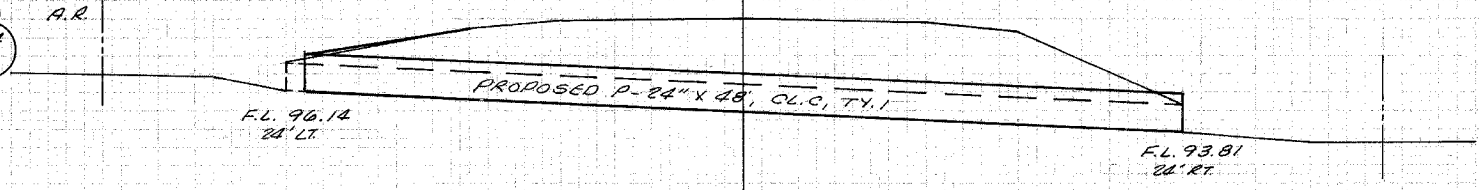

95
245
70
A.R. 245+43 LT.

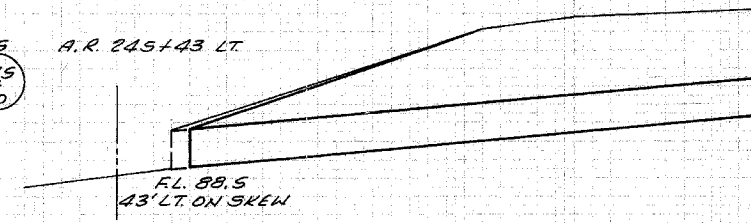

95
245
17
A.R. 245+43 RT.
PROPOSED P-24" x 80', CL.C, TY. 2



100
82
87
A.R. 82+76 RT.

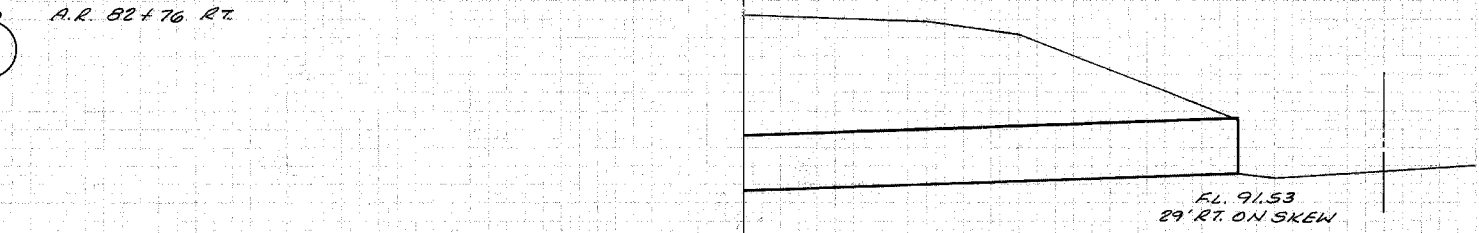

100
236
96
A.R. 236+00 LT.

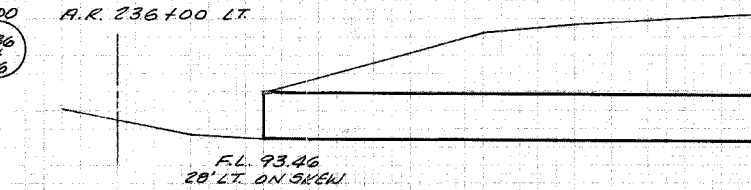

100
82
66
A.R. 82+76 LT.
PROPOSED P-36" x 62', CL.C, TY. 2

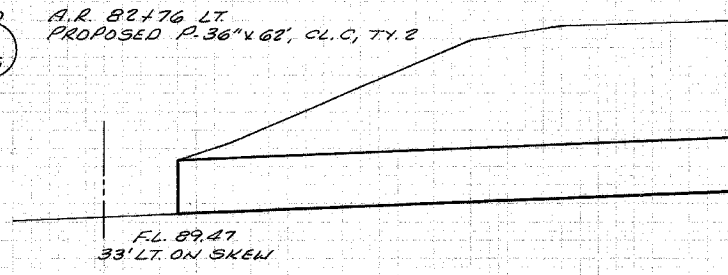

100
235
94
A.R. 236+00 RT.
PROPOSED P-30" x 58', CL.C, TY. 2

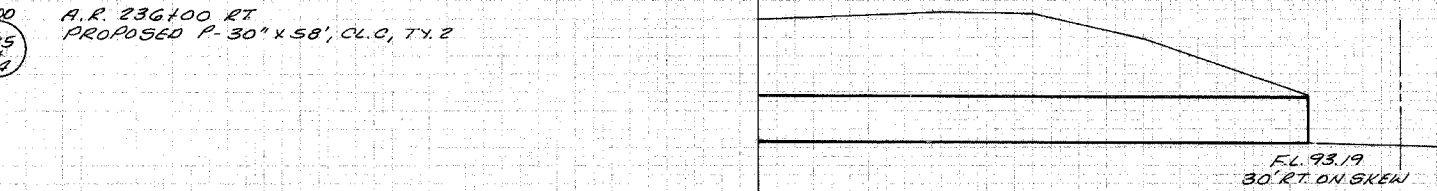

100
33
62
A.R.

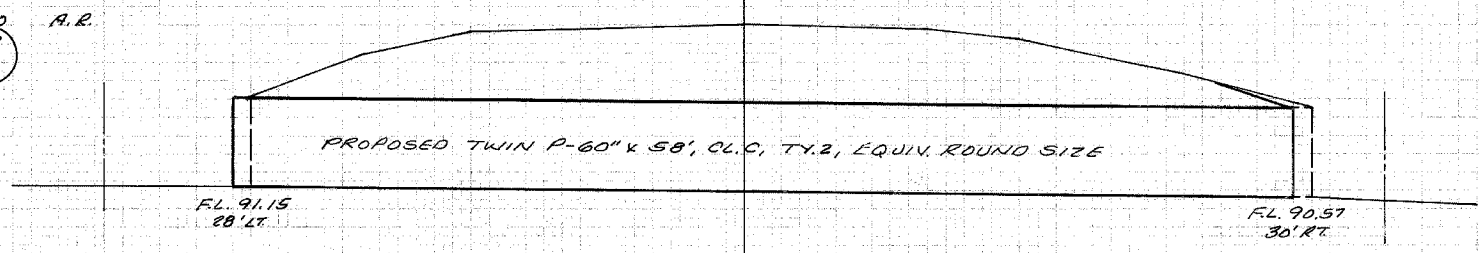

100
228
97
A.R.

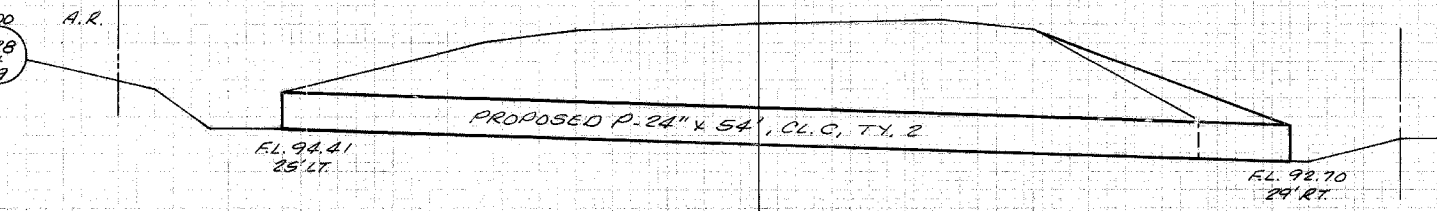

STATE ROUTE NO.	SECTION	COUNTY	TOTAL SHEETS	SHEET
801	03-00101-00-R3	LAWRENCE	5	5
STA. CONT. # 954.18	TO STA.			
FED. ROAD DIST. NO.	ILLINOIS	PROJECT		

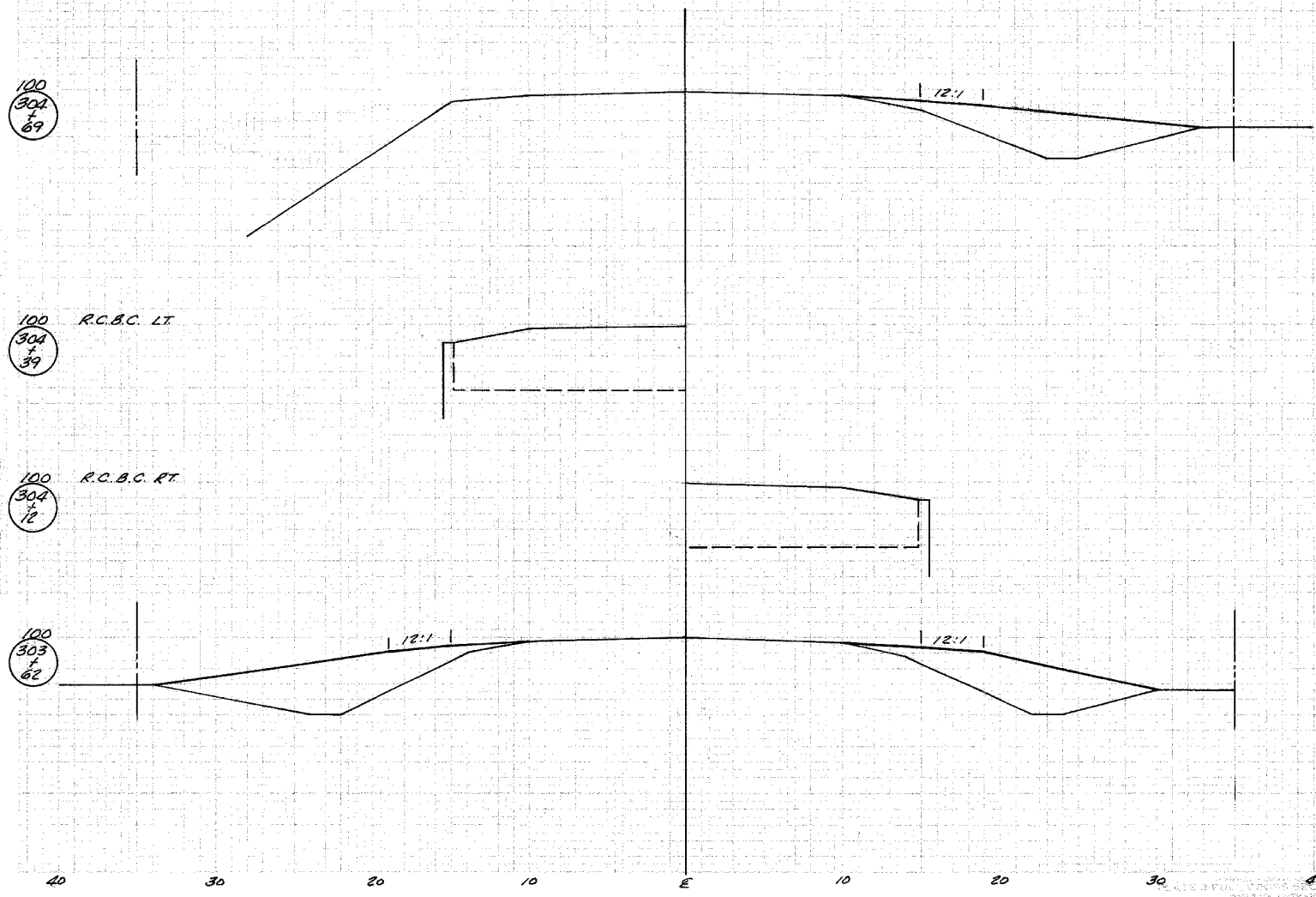

PROJECT: LAWRENCE COUNTY
 SECTION: 03-00101-00-R3
 COUNTY: LAWRENCE
 SHEET: 5 OF 5

DATE: 10/1/03
 DRAWN BY: [unclear]
 CHECKED BY: [unclear]