

F.A.U. RTE.	SECTION	COUNTY	TOTAL SHEETS	SHEET NO.
8435	06-00054-00-PV	FAYETTE	21	9
STA.	TO STA.			
FED. ROAD DIST. NO.	ILLINOIS	FED. AID PROJECT		
CONTRACT NO. 95483				

LEGEND

- SAWED CONTRACTION JOINT
- ~ LONGITUDINAL CONSTRUCTION JOINT OR KEYED LONGITUDINAL CONSTRUCTION JOINT WITH TIE BARS
- EXPANSION JOINT
- AGGREGATE SURFACE COURSE, TY. B
- EROSION CONTROL BLANKET

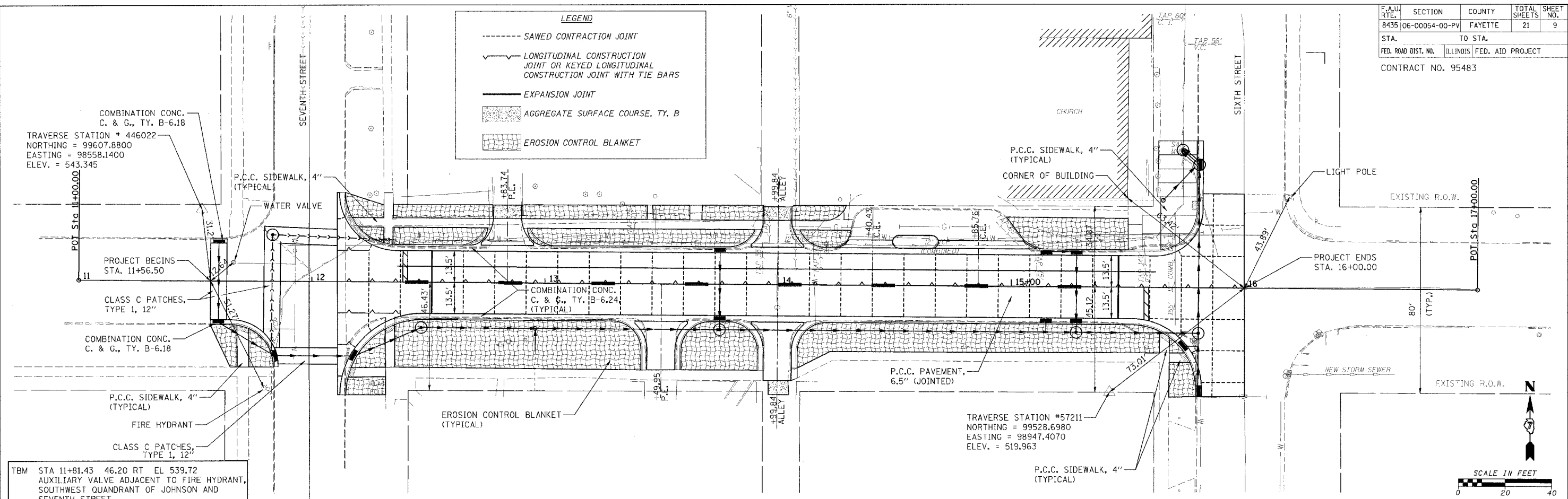

TRaverse Station # 446022
 NORTHING = 99607.8800
 EASTING = 98558.1400
 ELEV. = 543.345

POT Sta 11+00.00

PROJECT BEGINS STA. 11+56.50

CLASS C PATCHES, TYPE 1, 12"

COMBINATION CONC. C. & G., TY. B-6.18

P.C.C. SIDEWALK, 4" (TYPICAL)

WATER VALVE

P.C.C. SIDEWALK, 4" (TYPICAL)

FIRE HYDRANT

CLASS C PATCHES, TYPE 1, 12"

TBM STA 11+81.43 46.20 RT EL 539.72
 AUXILIARY VALVE ADJACENT TO FIRE HYDRANT, SOUTHWEST QUADRANT OF JOHNSON AND SEVENTH STREET

TRaverse Station #57211
 NORTHING = 99528.6980
 EASTING = 98947.4070
 ELEV. = 519.963

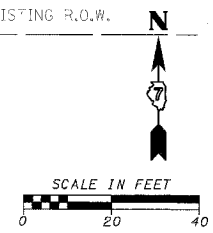

DATE	BY

DATE	BY

CADD FILE: /MB12/5721/PLAN.dgn
 PLOTTED: 5/11/2006

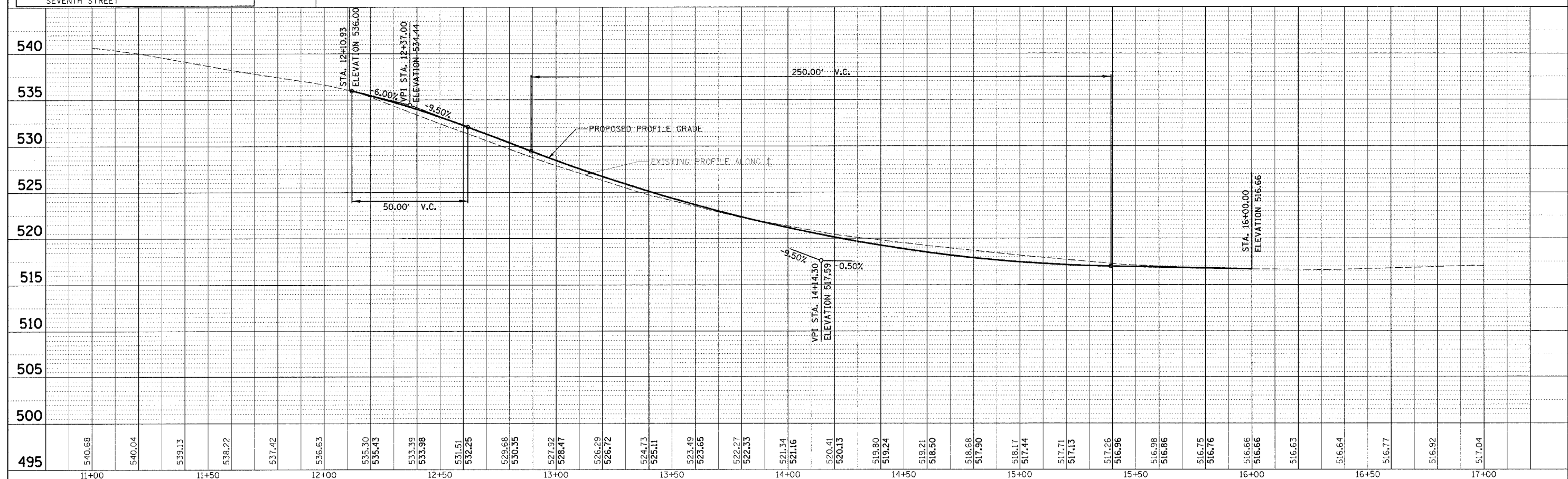

PLAN & PROFILE - STA. 11+56.50 - STA. 16+00.00 - F.A.U. 8435 (JOHNSON ST.)