

SE. 1/4, SW. 1/4, SEC. 34, T. 12 N. R. 3 E., 3RD P.M.

ROUTE	SECTION	COUNTY	TOTAL SHEETS	SHEET NO.
T.R. 133	05-17117	SHELBY	21	4
STA. 50+00		70 STA. 51+99.91		
ROAD DISTRICT		ILLINOIS		RIDGE
CONTRACT NO. 95484				

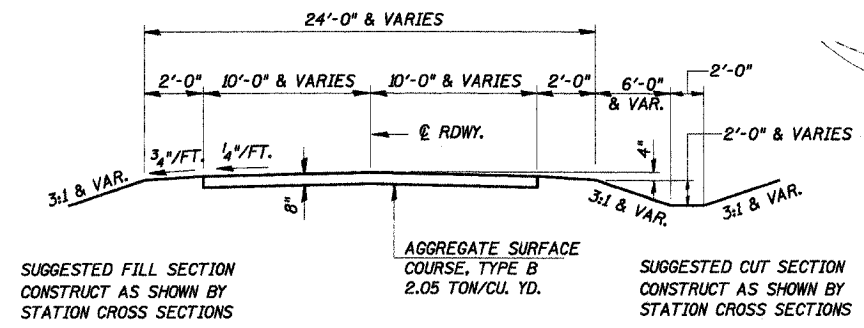

TRANSITION FROM EXISTING ROADWAY TO PROPOSED ROADWAY TO BE CONSTRUCTED FROM STA. 51+00 TO STA. 51+50

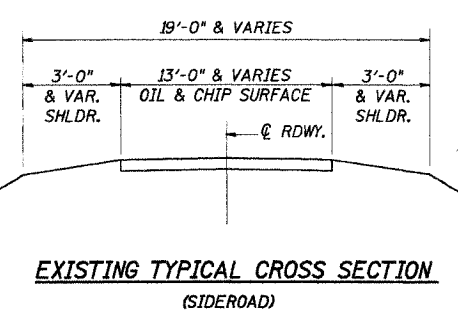

CURVE DATA
 P.I. STA. 17+39.80
 D = 05°43'46"
 Δ = 7°45' (RT)
 T = 67.73'
 R = 1000.00'
 L = 135.26'
 E = 2.29'
 P.C. STA. 16+72.07
 P.T. STA. 18+07.33
 S.E. = 0.04 FT./FT.

TRANSITION FROM STA. 16+08 TO 17+00 AND STA. 17+43 TO STA. 18+35.

LINDA KARL

STA. 18+87 (T.R. 133) = STA. 50+00 (SIDEROAD)

IMPROVEMENT ENDS STA. 19+50

SE. 1/4, SW. 1/4, SEC. 34, T. 12 N. R. 3 E., 3RD P.M.

LINDA KARL

SIDEROAD IMPROVEMENT BEGINS STA. 50+10

SIDEROAD IMPROVEMENT ENDS STA. 51+50

EXISTING R.O.W.

EXISTING R.O.W.

EXISTING R.O.W.

EXISTING R.O.W.

EXISTING R.O.W.

EXISTING R.O.W.

EXISTING R.O.W.

EXISTING R.O.W.

EXISTING R.O.W.

EXISTING R.O.W.

EXISTING R.O.W.

EXISTING R.O.W.

EXISTING R.O.W.

EXISTING R.O.W.

EXISTING R.O.W.

EXISTING R.O.W.

EXISTING R.O.W.

EXISTING R.O.W.

EXISTING R.O.W.

EXISTING R.O.W.

EXISTING R.O.W.

EXISTING R.O.W.

EXISTING R.O.W.

EXISTING R.O.W.

EXISTING R.O.W.

EXISTING R.O.W.

EXISTING R.O.W.

EXISTING R.O.W.

EXISTING R.O.W.

CARL KIRCHER

B.M. #3 - SPIKE NAIL IN POWER POLE
 31' RT. STA. 16+66
 EL. 597.47

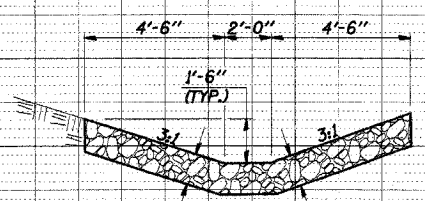
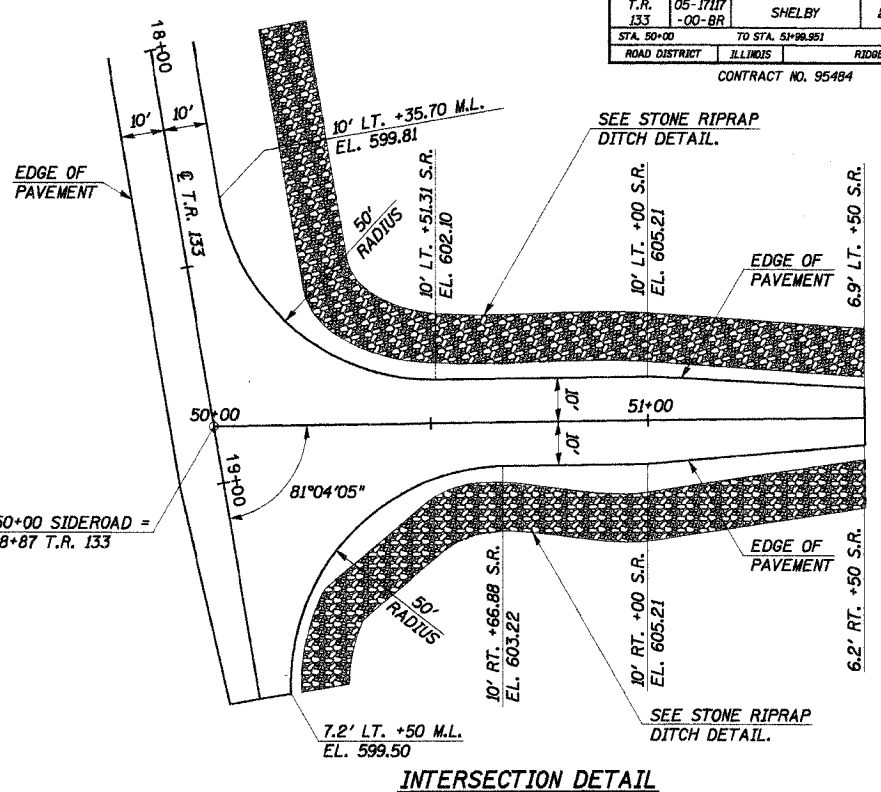

STONE RIPRAP, CLASS A4 (1.5 TON/CU YD)
 NO BEDDING & NO FILTER FABRIC

LT. STA. 12+00 M.L. TO STA. 13+00 M.L. = 85 TON
 LT. STA. 18+00 M.L. TO STA. 51+50 S.R. = 153 TON
 LT. STA. 19+50 M.L. TO STA. 51+50 S.R. = 128 TON
 TOTAL = 366 TON

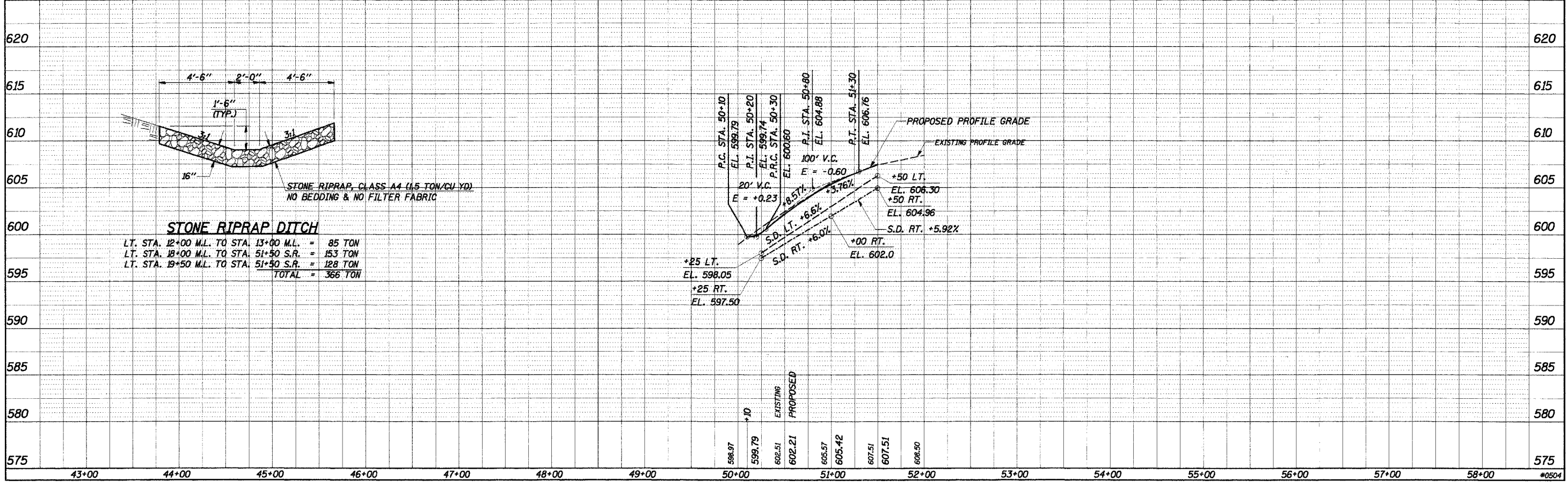
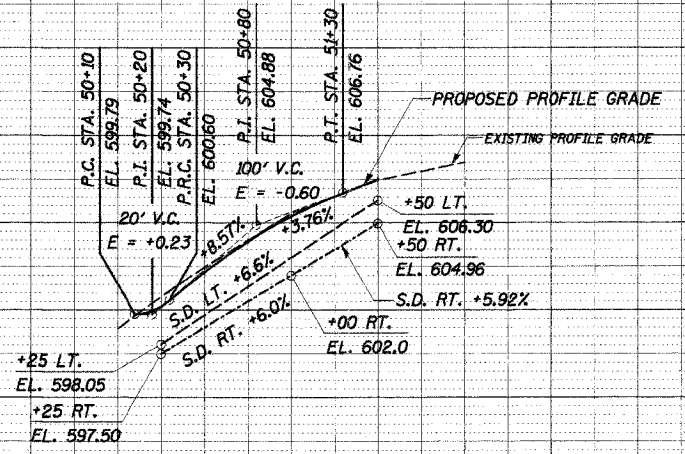

DATE: 09/20/06
 BY: S.A.C.
 DRAWN: S.A.C.
 CHECKED: S.A.C.
 PLAN & PROFILE