

ROUTE NO.	SECTION	COUNTY	TOTAL SHEETS	SHEET NO.
T.R. 133	05-17117-00-BR	SHELBY	21	21
ROAD DIST.	ILLINOIS		RIDGE	
CONTRACT NO. 95484				

**DESCRIPTION OF INTENDED SEQUENCE OF MAJOR CONSTRUCTION ACTIVITIES WHICH WILL DISTURB EARTH AND LEAD TO POSSIBLE EROSION FOR MAJOR PORTIONS OF THE CONSTRUCTION SITE:**

1. PLACEMENT OF PERIMETER EROSION CONTROL FENCE PRIOR TO THE COMMENCEMENT OF ANY ROAD OR BRIDGE WORK. SEE STD. 280001.
2. REMOVAL OF EXISTING STRUCTURE.
3. CONSTRUCTION OF THE REPLACEMENT STRUCTURE.
4. PLACEMENT OF ROADWAY EMBANKMENT TO RAISE THE ROADWAY TO THE PROPOSED GRADE.
5. DRAINAGE STRUCTURES, INCLUDING DITCHES, WILL BE INSTALLED BEFORE AND/OR DURING THE COMPLETION OF THE EMBANKMENT.
6. PLACEMENT AND MAINTENANCE OF TEMPORARY EROSION CONTROL.
7. PLACEMENT OF PERMANENT EROSION CONTROL.
8. REMOVAL AND PROPER CLEAN UP OF TEMPORARY EROSION CONTROL.
9. FINAL GRADING, PLACING AGGREGATE AND OTHER MISCELLANEOUS ITEMS.

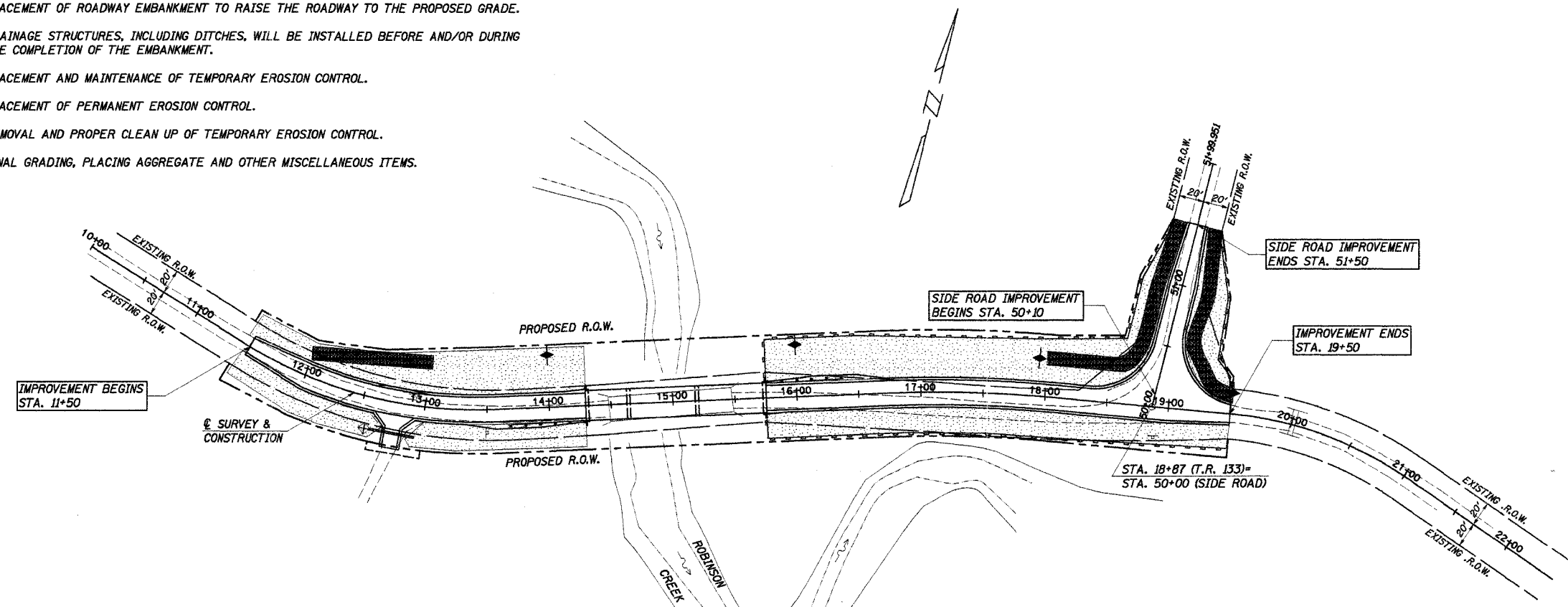

TEMPORARY EROSION CONTROL:	
	PERIMETER EROSION BARRIER
	TEMPORARY DITCH CHECK
	INLET AND PIPE PROTECTION
PERMANENT EROSION CONTROL:	
	SEEDING CLASS 2, FERTILIZERS, & MULCH, METHOD 2
	STONE RIPRAP DITCH

**TEMPORARY DITCH CHECKS**

LT. STA. 14+00	= 1 EACH
LT. STA. 16+00	= 1 EACH
LT. STA. 17+90	= 1 EACH
LT. STA. 19+50	= 1 EACH
<b>TOTAL</b>	<b>= 4 EACH</b>

**PERIMETER EROSION BARRIER**

LT. STA. 15+75.25 TO LT. STA. 50+50	= 324 FOOT
RT. STA. 15+75.25 TO RT. STA. 19+50	= 394 FOOT
LT. STA. 50+50 TO LT. STA. 51+50	= 100 FOOT
RT. STA. 51+50 TO LT. STA. 19+50	= 115 FOOT
<b>TOTAL</b>	<b>= 933 FOOT</b>

**INLET AND PIPE PROTECTION**

RT. STA. 12+59	= 1 EACH
<b>TOTAL</b>	<b>= 1 EACH</b>

**BILL OF MATERIAL**

ITEM	UNIT	QUANTITY
TEMPORARY EROSION CONTROL SEEDING	POUND	90
TEMPORARY DITCH CHECKS	EACH	4
PERIMETER EROSION BARRIER	FOOT	933
INLET AND PIPE PROTECTION	EACH	1

THE ABOVE QUANTITIES ARE ESTIMATES ONLY. ACTUAL QUANTITIES FOR EROSION CONTROL WILL BE DETERMINED BY THE ENGINEER IN THE FIELD AND THERE WILL BE NO ADJUSTMENT IN ANY UNIT PRICE DUE TO A CHANGE IN PLAN QUANTITY.

**EROSION CONTROL PLAN**  
SECTION 05-17117-00-BR  
RIDGE ROAD DISTRICT  
SHELBY COUNTY  
STA. 15+02.38

4440 ASH GROVE  
SPRINGFIELD, IL 62711  
(217) 793-8600  
oasinc@insightbb.com

**OZYURT AND STONE, INC.**  
CONSULTING ENGINEERS

DRAWN: S.A.P.  
DATE: 09/13/05

CHECKED: F.J.S.  
DATE: 10/26/05

JOB NO.: 0504  
FILE: 0504EROSION.DGN  
DATE: 02/14/06