

F.A.S. ROUTE NO.	SECTION	COUNTY	TOTAL SHEETS	SHEET
03-07118-00-BR	WAYNE		11	2
STA.	TO STA.			
0+00	8+00			
FED. ROAD DIST. NO.	ILLINOIS	PROJECT	BR05-191(51)	

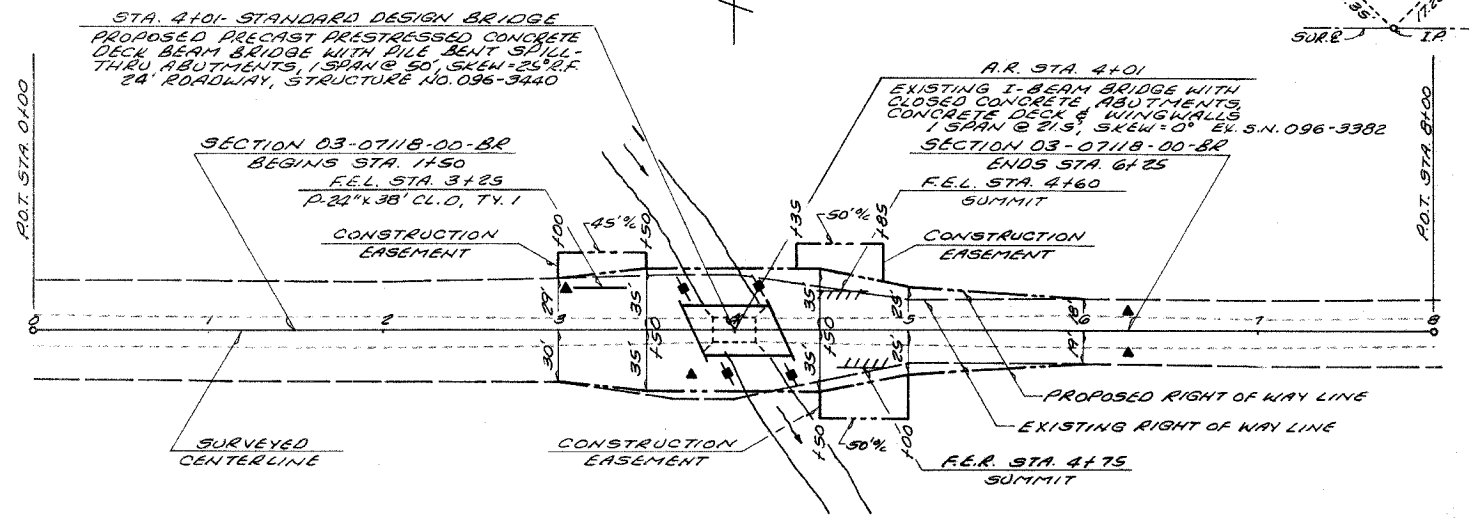
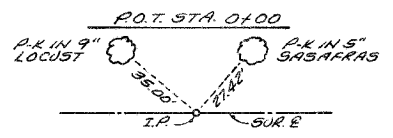
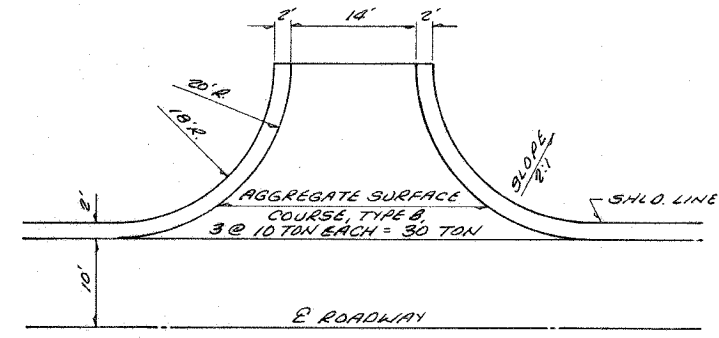
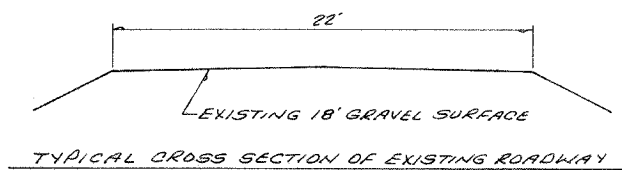
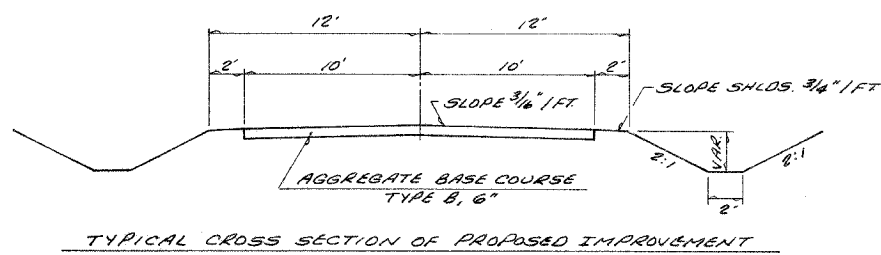

PLAN
 SHEET NO.
 DATE
 BY
 CHECKED
 IN CHARGE
 NO. OF SHEETS
 NO. OF THIS SHEET

PROFILE
 SHEET NO.
 DATE
 BY
 CHECKED
 IN CHARGE
 NO. OF SHEETS
 NO. OF THIS SHEET

EARTHWORK SCHEDULE		SEEDING CLASS 2 SPECIAL		CONSTRUCT TRANSITIONS	
EARTH EXCAVATION =	133 C.Y.	STA. 1+00 TO STA. 6+25 = 0.5 ACRE		FROM EXISTING ROADWAY TO PROPOSED 24' ROADWAY	
EARTH EXCAVATION ADJUSTED 25% =	100 C.Y.	▲ TEMPORARY DITCH CHECKS		STA. 1+00 TO STA. 1+50	
CHANNEL EXCAVATION =	83 C.Y.	LT. STA. 3+05 = 1 EACH		STA. 6+25 TO STA. 6+75	
CHANNEL EXCAVATION ADJUSTED 25% =	62 C.Y.	RT. STA. 3+75 = 1 EACH			
EMBANKMENT =	165 C.Y.	LT. & RT. STA. 6+25 = 2 EACH		PERIMETER EROSION BARRIER	
FURNISHED EXCAVATION =	603 C.Y.	TOTAL = 4 EACH		LT. STA. 3+70 = 17 FEET	
				RT. STA. 3+75 = 17 FEET	
				LT. STA. 4+75 = 17 FEET	
				RT. STA. 4+30 = 17 FEET	
				TOTAL = 68 FEET	

