

RTE.	SECTION	COUNTY	TOTAL SHEETS	SHEET NO.
T.R. 137	*	JERSEY	9	2
FEDERAL AID PROJECT BROS-083(038)				

* 04-07118-00-BR
CONTRACT NO. 97277

SUMMARY OF QUANTITIES

X081-2A

CODE NO.	ITEM	UNIT	QUANTITY
20100500	Tree Removal, Acres	Acres	0.2
20200100	Earth Excavation	Cu. Yd.	258
20300100	Channel Excavation	Cu. Yd.	51
20400800	Furnished Excavation	Cu. Yd.	1125
25001000	Seeding, Class 2 (Special)	Acres	0.60
28100807	Stone Dumped Riprap, Class A4	Ton	314
28200200	Filter Fabric	Sq. Yd.	544
**** 40200800	Aggregate Surface Course, Type B	Ton	531
50100100	Removal of Existing Structures	Each	1
50200100	Structure Excavation	Cu. Yd.	67
50300225	Concrete Structures	Cu. Yd.	45.5
50400505	Precast Prestressed Concrete Deck Beams (27" Depth)	Sq. Ft.	1312
50800105	Reinforcement Bars	Pound	3970
50900205	Steel Railing, Type S1	Foot	112
51201400	Furnishing Steel Piles HP10x42	Foot	222
51202700	Driving Steel Piles	Foot	222
51203400	Test Pile, Steel HP10x42	Each	1
51500100	Name Plates	Each	1
67100100	Mobilization	L. Sum	1
63100075	Traffic Barrier Terminal, Type 5A	Each	2
63100167	Traffic Barrier Terminal, Type 1 Special (Tangent)	Each	2
70101630	Traffic Control & Protection Standard BLR 21	L. Sum	1
78201000	Terminal Marker - Direct Applied	Each	2

**** - Indicates work to be performed by County Forces

GENERAL NOTES

Where section or subsection markers are encountered, the Engineer shall be notified before such markers are removed. The contractor shall protect and preserve all property markers and monuments until the owner, authorized surveyor, or agent has witnessed or referenced their location.

Seeding: Fertilizer nutrients shall be applied at a ratio of 1:1:1 and at a rate of 270 pounds per acre. Mulch and Agricultural Ground Limestone shall be applied at the rate of 2 tons per acre. See Special Provisions.

Areas to be seeded shall consist of all disturbed earth surfaces within the right-of-way as directed by the Engineer.

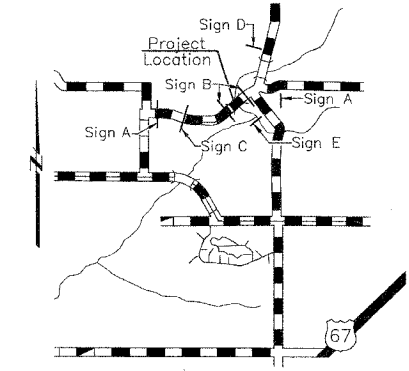

BARRICADE LOCATION PLAN
(Refer to Highway Standards 702001 & BLR 21)

- Legend**
- Sign A - "Road Closed Ahead" W20-3(0) 4848
 - Sign B - BLR Standard 21
 - Sign C - "Road Closed 500 Feet" W20-3(0) 4848
 - Sign D - "Road Closed Ahead" W20-3(0) 4848 with M4-9R 3024
 - Sign E - "Road Closed Ahead" W20-3(0) 4848 with M4-9L 3024

SUMMARY OF QUANTITIES, DETAILS & TYPICAL SECTIONS
T.R. 137 OVER PIASA CREEK
SECTION 04-07118-00-BR
JERSEY COUNTY

EARTHWORK SCHEDULE

Location	Earth Excavation	Earth Excavation Adjusted For Shrinkage	Embankment	Earthwork Balance Waste (+) or Shortage (-)
	Cubic Yard	Cubic Yard	Cubic Yard	Cubic Yard
Sta. 0+80 to Sta. 1+00	4	3	0	+3
Sta. 1+00 to Sta. 1+90	23	17	35	-18
Sta. 1+90 to Sta. 3+00	31	23	179	-156
Sta. 3+00 to Sta. 3+50	25	19	147	-128
Sta. 3+50 to Sta. 3+73	13	10	78	-68
Bridge Omission - Sta. 3+73 to Sta. 4+29	-	-	-	-
Sta. 4+29 to Sta. 4+40	31	23	87	-64
Sta. 4+40 to Sta. 5+00	101	76	402	-326
Sta. 5+00 to Sta. 6+00	30	23	357	-335
Sta. 6+00 to Sta. 6+40	0	0	33	-33
Total	258	194	1328	-1125

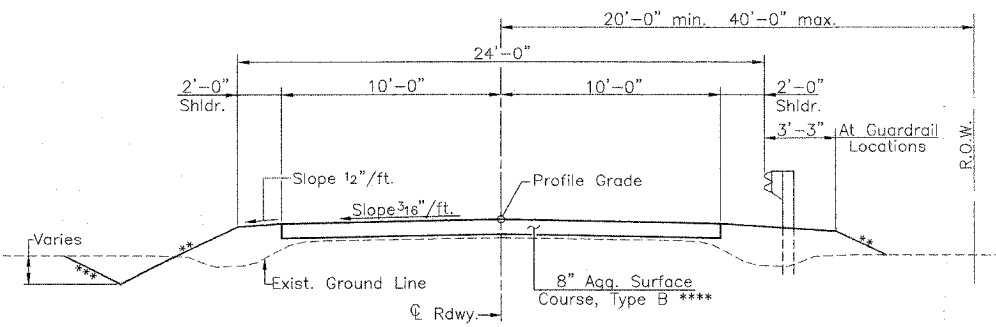
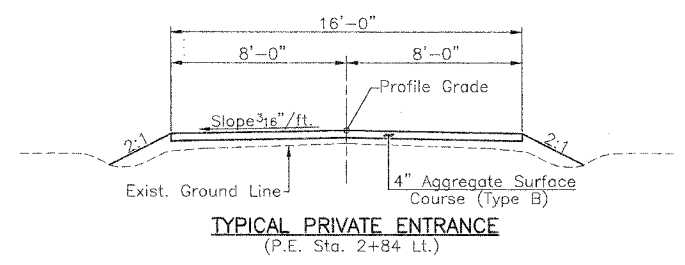

PROPOSED CROSS SECTION
(Sta. 0+80 to Sta. 1+31 & Sta. 3+58.81 to Sta. 6+40)

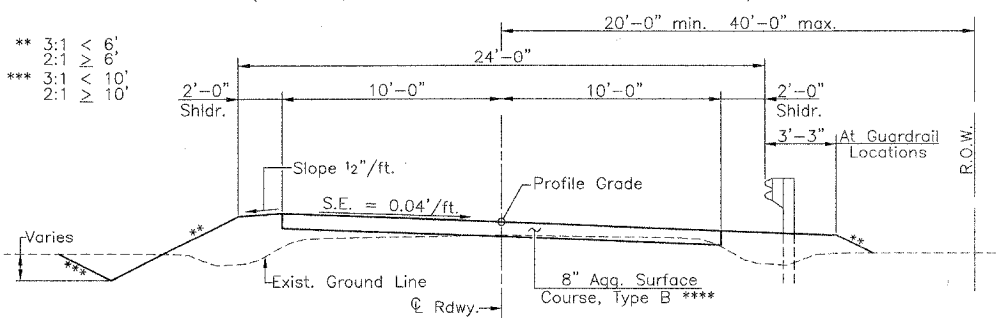

PROPOSED CROSS SECTION
(Sta. 1+31 to Sta. 3+58.81)

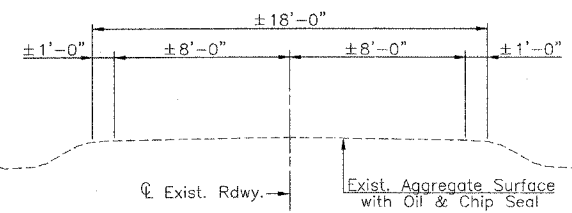

EXISTING CROSS SECTION

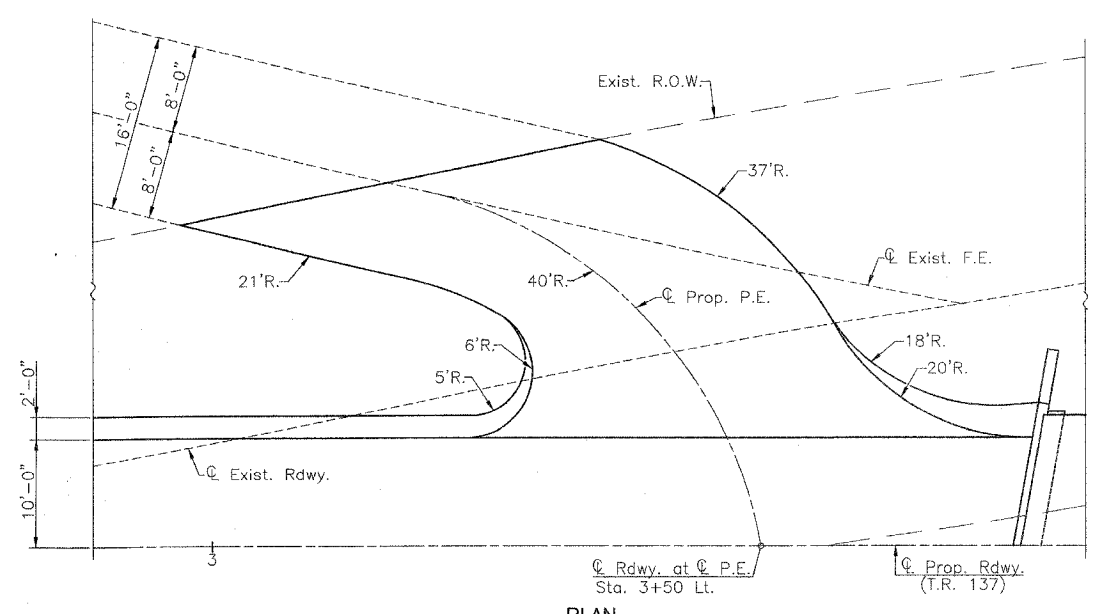

PLAN

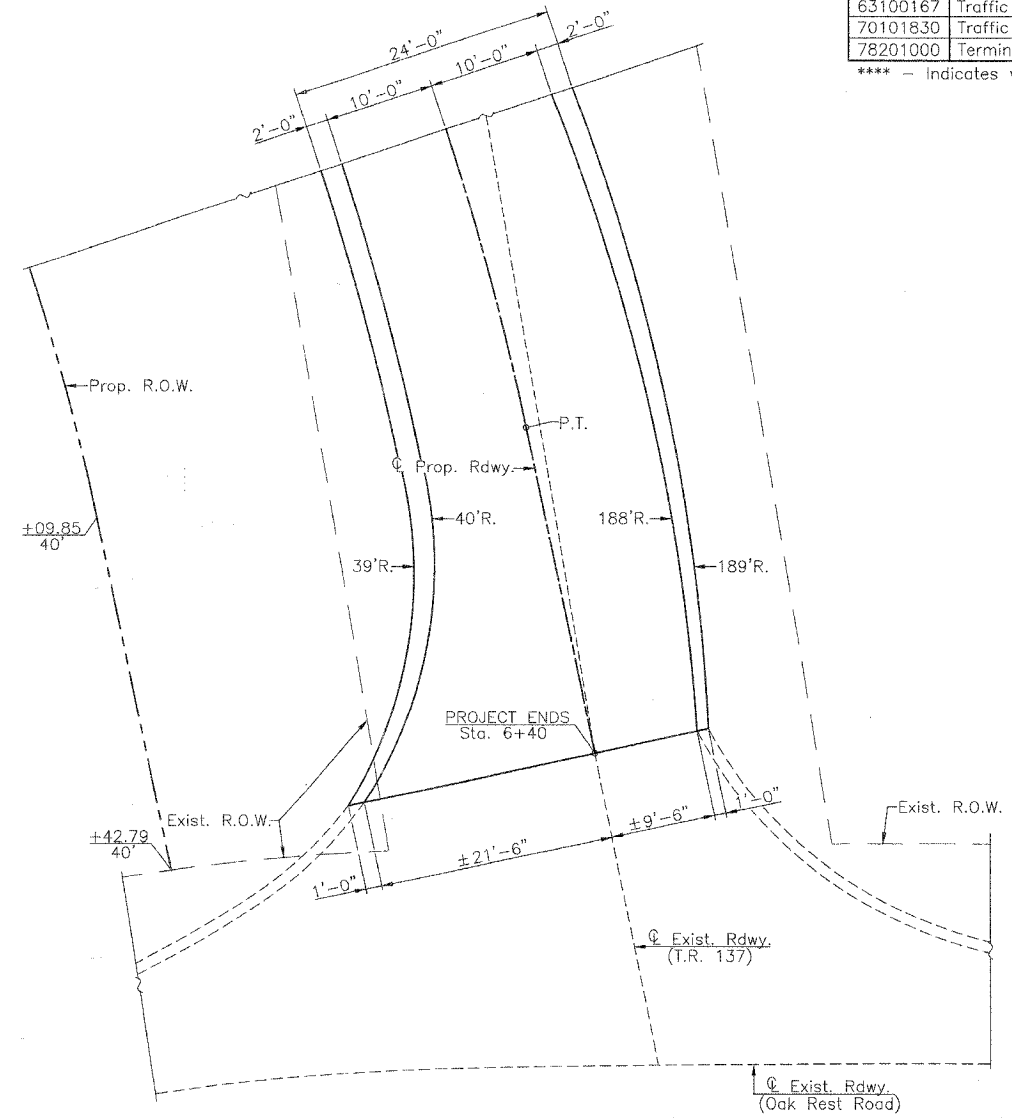

PLAN