

F.A.S.	SECTION	COUNTY	TOTAL SHEETS	SHEET NO.
1816	06-00099-00-RS	WHITE	4	1
FED. ROAD DIST. NO. 3		ILLINOIS	NORRIS CITY RESERVOIR	
LEC JOB # H051013WH				

STATE OF ILLINOIS  
DEPARTMENT OF TRANSPORTATION  
DIVISION OF HIGHWAYS  
**PLANS FOR PROPOSED  
STR**

**F.A.S. 1816(CH 16) SECTION 06-00099-00-RS WHITE COUNTY  
JOB# C-99-536-06 PROJECT NO. RS-1816(102)**

**INDEX OF SHEETS**

SHEET NO.	DESCRIPTION
1	TITLE SHEET
2	TYPICAL SECTIONS, SUMMARY OF QUANTITIES, GENERAL NOTES, MISCELLANEOUS DETAILS
3	DETAILS OF INTERSECTIONS, AND SIDEROADS
4	SCHEDULES

**THE FOLLOWING STANDARDS ARE A PART OF THESE PLANS AND ARE INCLUDED AFTER SHEET NO. 4**

000001-04	STANDARD SYMBOLS, ABBREVIATIONS & PATTERNS
406201	MAILBOX TURNOUT
701006-02	OFF-RD OPERATIONS, 2-L, 2-W, 4.5 m (15') TO PAVEMENT EDGE FOR SPEEDS ≥ 45 MPH
701301-02	LANE CLOSURE, 2L, 2W, SHORT TIME OPERATIONS
701306-01	LANE CLOSURE, 2L, 2W, SLOW MOVING OPERATIONS DAY ONLY FOR SPEEDS ≥ 45 MPH
701311-02	LANE CLOSURE, 2L, 2W, MOVING DAY OPERATIONS
701336-04	LANE CLOSURE 2L, 2W, WORK AREAS IN SERIES FOR SPEEDS ≥ 45 MPH
702001-06	TRAFFIC CONTROL DEVICES
780001-01	TYPICAL PAVEMENT MARKINGS
781001-02	TYPICAL APPLICATIONS RAISED REFLECTIVE PAVEMENT MARKERS

**SUMMARY OF QUANTITIES**

CODE NUMBER	ITEM	UNIT	QUANTITY
*XX003140	SHORT TERM PAVEMENT MARKING REMOVAL	FOOT	1326.00
*XX127400	PAVEMENT REMOVAL AND REPLACEMENT (SPECIAL)	TON	79.00
*X4066414	BITUMINOUS CONCRETE SURFACE COURSE, SUPERPAVE, MIX "C", N50	TON	2352.00
*X4066770	LEVELING BINDER (MACHINE METHOD), SUPERPAVE N70	TON	5414.00
28100807	STONE DUMPED RIPRAP, CLASS A4	TON	29.30
40600100	BITUMINOUS MATERIALS (PRIME COAT)	GALLON	4731.00
40600300	AGGREGATE (PRIME COAT)	TON	95.00
48101200	AGGREGATE SHOULDERS, TYPE B	TON	1577.00
*54223477	REMOVE & RELAY PIPE CULVERTS 42"	FOOT	36.00
54390250	INSERTION CULVERT LINER 42"	FOOT	70.00
67100100	MOBILIZATION	L SUM	1.00
70100460	TRAFFIC CONTROL AND PROTECTION STANDARD 701306	L SUM	1.00
70100600	TRAFFIC CONTROL AND PROTECTION STANDARD 701336	L SUM	1.00
70300100	SHORT-TERM PAVEMENT MARKING	FOOT	3977.00
Δ 78001110	PAINT PAVEMENT MARKING-LINE 4"	FOOT	48599.00
Δ 78100100	RAISED REFLECTIVE PAVEMENT MARKER	EACH	166.00

Δ SPECIALTY ITEMS

CONTRACT# 99270  
DESIGN CLASS - MAJOR COLLECTOR  
CURRENT A.D.T. = 770  
DESIGN SPEED = 50 MPH

**J.U.L.I.E.  
JOINT UTILITY LOCATION INFORMATION FOR EXCAVATION  
1-800-892-0123**

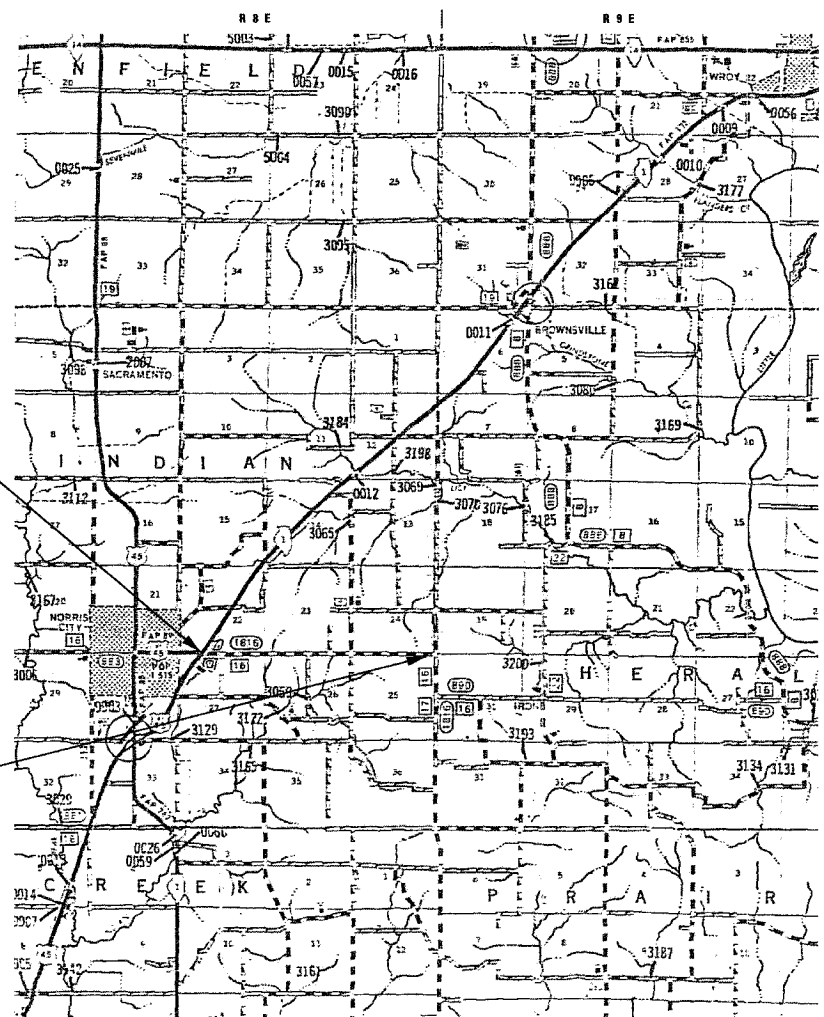

SECTION 06-00099-00-RS  
BEGINS STATION 0+00

SECTION 06-00099-00-RS  
ENDS STATION 132+56

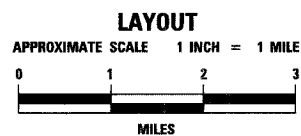

GROSS LENGTH	13,256 FT	2.5106 MILES
OMISSION	0 FT	0 MILES
NET LENGTH	13,256 FT	2.5106 MILES

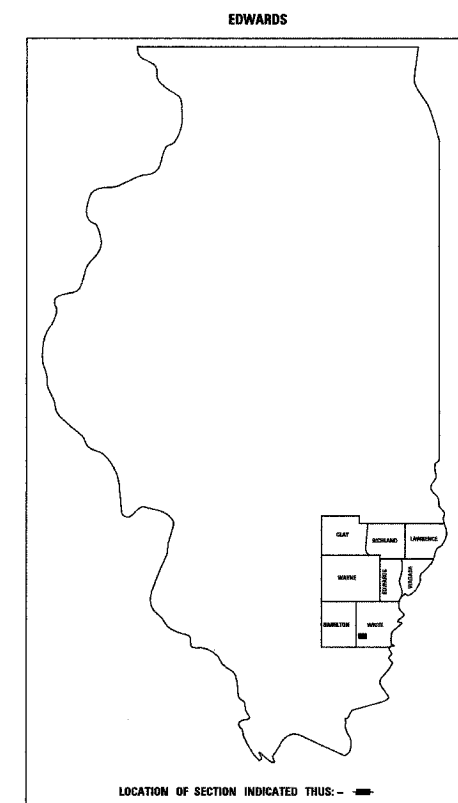

323 W. 3RD ST.  
P.O. BOX 160  
MT. CARMEL, IL  
62863  
PHONE:  
(618)-262-8651  
FAX:  
(618)-263-3327

405 W. STATE ST.  
SUITE 1  
PRINCETON, IN  
47670  
PHONE:  
(812)-386-7611  
FAX:  
(812)-385-2812



PROFESSIONAL DESIGN FIRM  
LAND SURVEY & PROFESSIONAL ENGINEERING CORPORATION  
184-000887  
(62-032435)(35-002769)

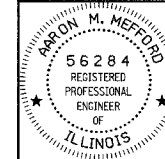

AARON M. MEFFORD  
NAME  
*Aaron Mefford*  
SIGNATURE  
5-09-06  
DATE  
11-30-07  
EXPIRES

APPROVED May 09 2006  
*Josh Basaw*  
COUNTY ENGINEER

PASSED MAY 15 2006  
*Dean W. Hill*  
DISTRICT NINE ENGINEER OF  
LOCAL ROADS & STREETS

APPROVED May 10 2006  
*Mark J. ...*  
DEPUTY DIRECTOR OF HIGHWAYS,  
REGION FIVE ENGINEER

STATE OF ILLINOIS  
DEPARTMENT OF TRANSPORTATION