

SCHEDULE OF PAVEMENT MARKINGS

STATION	TO	STATION	LOCATION	LENGTH - FOOT
CENTERLINE				
0+00		132+56	☉	1415
EDGE LINE				
0+00		65+55	RT.	6555
65+93		91+95	RT.	2602
92+34		132+56	RT.	4022
EDGE LINE				
0+00		78+85	LT.	7885
79+07		92+00	LT.	1293
92+33		132+56	LT.	4023
NO. PASSING				
0+00		21+82	RT.	2182
15+65		36+59	LT.	2094
37+09		122+40	RT.	8531
52+59		132+56	LT.	7997
				TOTAL 48,599

THE ABOVE QUANTITY IS SHOW IN THE PAVEMENT MARKING-LINE 4" IN THE SUMMARY OF QUANTITIES.

SCHEDULE OF MAILBOX TURNOUTS

STATION	LOCATION	EST. QUANTITY ALLOWED TONS
12+32	LT.	7.0
28+99	LT.	3.9
37+41	LT.	4.7
57+81	RT.	2.8
60+22	LT.	8.0
63+30	RT.	3.4
79+14	LT.	2.4
87+06 & 87+08	LT.	4.9
101+32	LT.	4.6
115+06	LT.	4.5
128+65	LT.	5.2
		51.4

THE ABOVE QUANTITY IS INCLUDED IN THE BITUMINOUS CONCRETE SURFACE COURSE, SUPERPAVE, MIX "C", N50 IN THE SUMMARY OF QUANTITIES.

SCHEDULE OF PRIVATE AND FIELD ENTRANCES

STATION	LOCATION	BC SC SUPER "C" N50 (IN TONS)
0+31	RT	5.1
1+71	RT	2.4
8+89	RT	3.0
9+86	LT	2.8
12+47	RT	2.1
12+90	RT	2.7
13+33	LT	2.0
13+52	RT	1.7
14+76	LT	1.3
21+00	RT	2.3
21+24	LT	2.2
29+19	LT	2.4
31+79	LT	1.4
37+36	RT	1.5
37+59	LT	4.1
39+26	RT	2.8
40+83	RT	1.4
41+33	RT	2.2
42+49	RT	1.9
43+21	LT	2.0
48+77	RT	3.0
52+52	LT	2.4
53+33	RT	1.7
57+69	RT	2.0

SCHEDULE OF PRIVATE AND FIELD ENTRANCES

STATION	LOCATION	BC SC SUPER "C" N50 (IN TONS)
60+78	LT	3.0
62+42	LT	1.1
63+13	RT	2.3
64+54	LT	1.9
68+52	LT	2.3
71+01	RT	2.7
71+03	LT	2.2
79+16	RT	1.4
79+31	LT	1.7
86+98	RT	2.3
87+32	LT	2.5
95+20	RT	1.8
101+53	LT	3.7
102+27	RT	1.5
109+92	RT	1.7
111+52	LT	3.3
113+75	RT	2.0
115+26	RT	3.7
122+28	LT	1.6
122+46	RT	5.7
128+43	LT	2.2
128+54	RT	5.0
131+88	LT	2.2
TOTAL		114.2

THE ABOVE QUANTITY IS INCLUDED IN THE BITUMINOUS CONCRETE SURFACE COURSE, SUPERPAVE, MIX "C", N50 IN THE SUMMARY OF QUANTITIES.

STONE DUMPED RIPRAP, CLASS A4

STATION	SIDE	LENGTH	WIDTH	TON
77+76	RT.	15'	20'	20.0 T
77+76	LT.	14'	10'	9.3 T
TOTAL				29.3 T

STONE DUMPED RIPRAP DETAIL

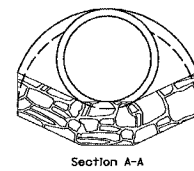
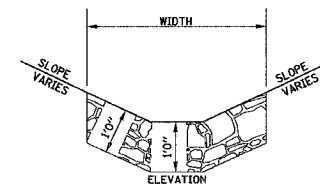
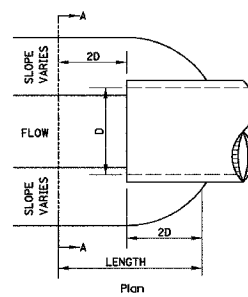

NOTE: FOR PLACEMENT, QUALITY GRADATION AND OTHER MISCELLANEOUS REQUIREMENTS FOR STONE RIPRAP DITCH-SEE SPECIAL PROVISIONS.

SCHEDULE OF PAV'T REMOVAL AND REPLACEMENT SPECIAL

STATION	TO	STATION	LOCATION	WIDTH (FEET)	SQ. YD.	TON
18+46		18+80	RT. EDGE	10.0	37.8	19.0
18+68		18+96	LT. EDGE	2.5	7.8	3.9
192+10		193+10	RT. EDGE	5.0	55.6	28.0
192+10		193+10	LT. EDGE	5.0	55.6	28.0
TOTALS					156.7	78.9

THE SCHEDULE ABOVE REFLECTS APPROXIMATE LOCATION AND ESTIMATED QUANTITIES. THE ACTUAL AREAS SHALL BE LOCATED AND MARKED BY THE ENGINEER PRIOR TO CONSTRUCTION. THE ABOVE QUANTITY IS INCLUDED IN PAVEMENT REMOVAL AND REPLACEMENT SPECIAL IN THE SUMMARY OF QUANTITIES.

SCHEDULE OF AGGREGATE SHOULDER STONE IN TANGENT

STATION	TO	STATION	LOCATION	ALLOWED TONS EST. QUANTITY
0+00		131+36	LT.	670.3
0+00		131+36	RT	906.8
TOTAL				1577.1

THE ABOVE QUANTITY IS FOR THE ENTIRE SECTION AND IS INCLUDED IN THE QUANTITY FOR AGGREGATE SHOULDERS, TYPE B IN THE SUMMARY OF QUANTITIES.

323 W. 3RD ST.
P.O. BOX 160
MT. CARMEL, IL
62863
PHONE:
(618)-262-8651
FAX:
(618)-263-3327

405 W. STATE ST.
SUITE 1
PRINCETON, IN
47670
PHONE:
(812)-386-7611
FAX:
(812)-385-2812



PROFESSIONAL DESIGN FIRM
LAND SURVEY &
PROFESSIONAL
ENGINEERING
CORPORATION
184-00887
(62-032433)(95-002769)



AARON M. MEFFORD
NAME
Aaron Mefford
SIGNATURE
5-09-07
DATE
11-30-07
EXPIRES