

--- = DRAINAGE PATH

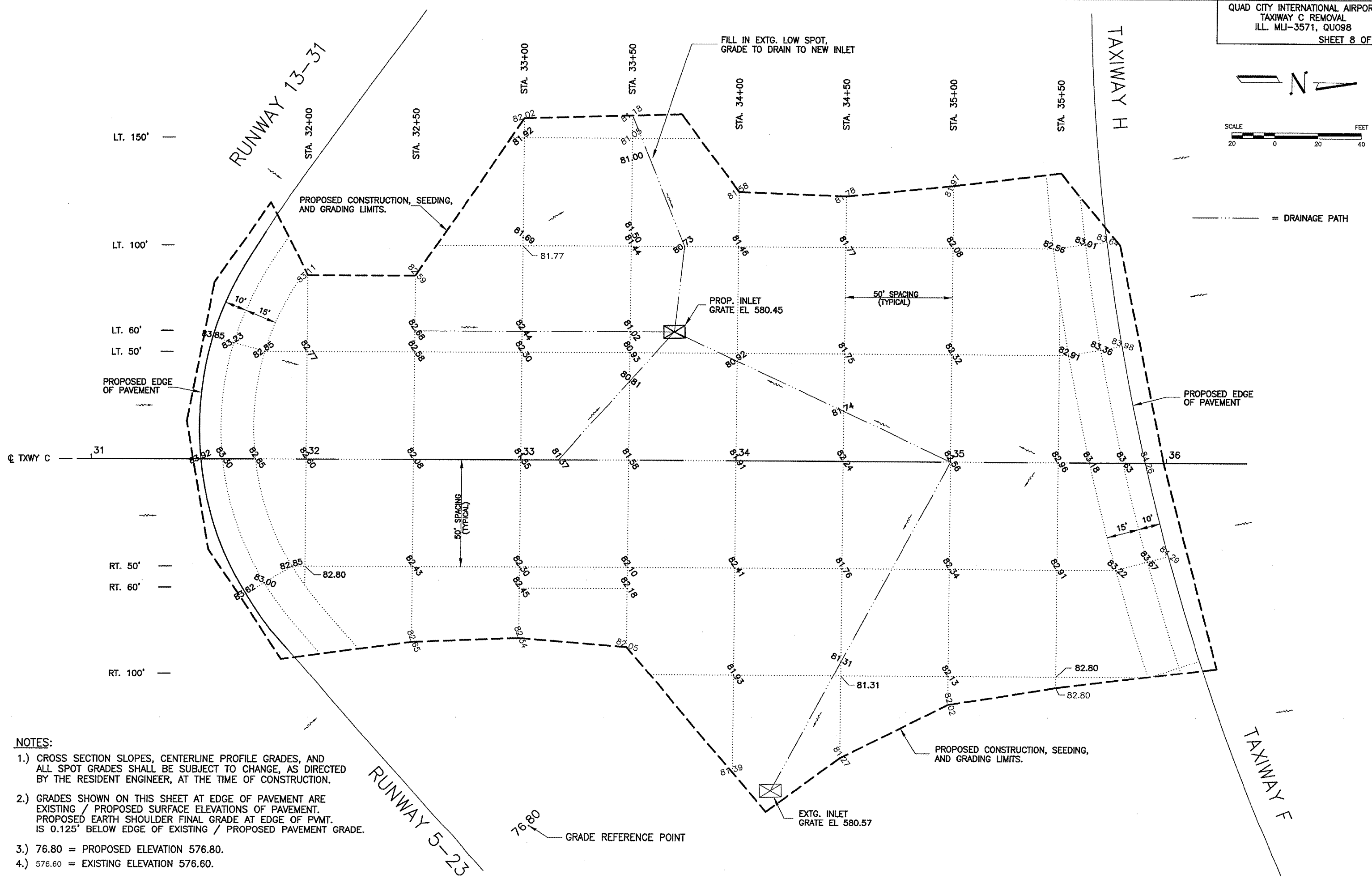

**NOTES:**

- 1.) CROSS SECTION SLOPES, CENTERLINE PROFILE GRADES, AND ALL SPOT GRADES SHALL BE SUBJECT TO CHANGE, AS DIRECTED BY THE RESIDENT ENGINEER, AT THE TIME OF CONSTRUCTION.
- 2.) GRADES SHOWN ON THIS SHEET AT EDGE OF PAVEMENT ARE EXISTING / PROPOSED SURFACE ELEVATIONS OF PAVEMENT. PROPOSED EARTH SHOULDER FINAL GRADE AT EDGE OF PAVMT. IS 0.125' BELOW EDGE OF EXISTING / PROPOSED PAVEMENT GRADE.
- 3.) 76.80 = PROPOSED ELEVATION 576.80.
- 4.) 576.60 = EXISTING ELEVATION 576.60.

G:\AIRPORT\A05T034CHARLIE\STAKING.DWG, 6/27/2006 10:33:56 AM, jefrm