

JUN 29, 2006 8:31 AM CAH
 I:\AIRPORTS\ROBINSON\838-04RWY\AIRPORT\ SHEETS\R-121CON.DWG - 127+00 TO 143+00

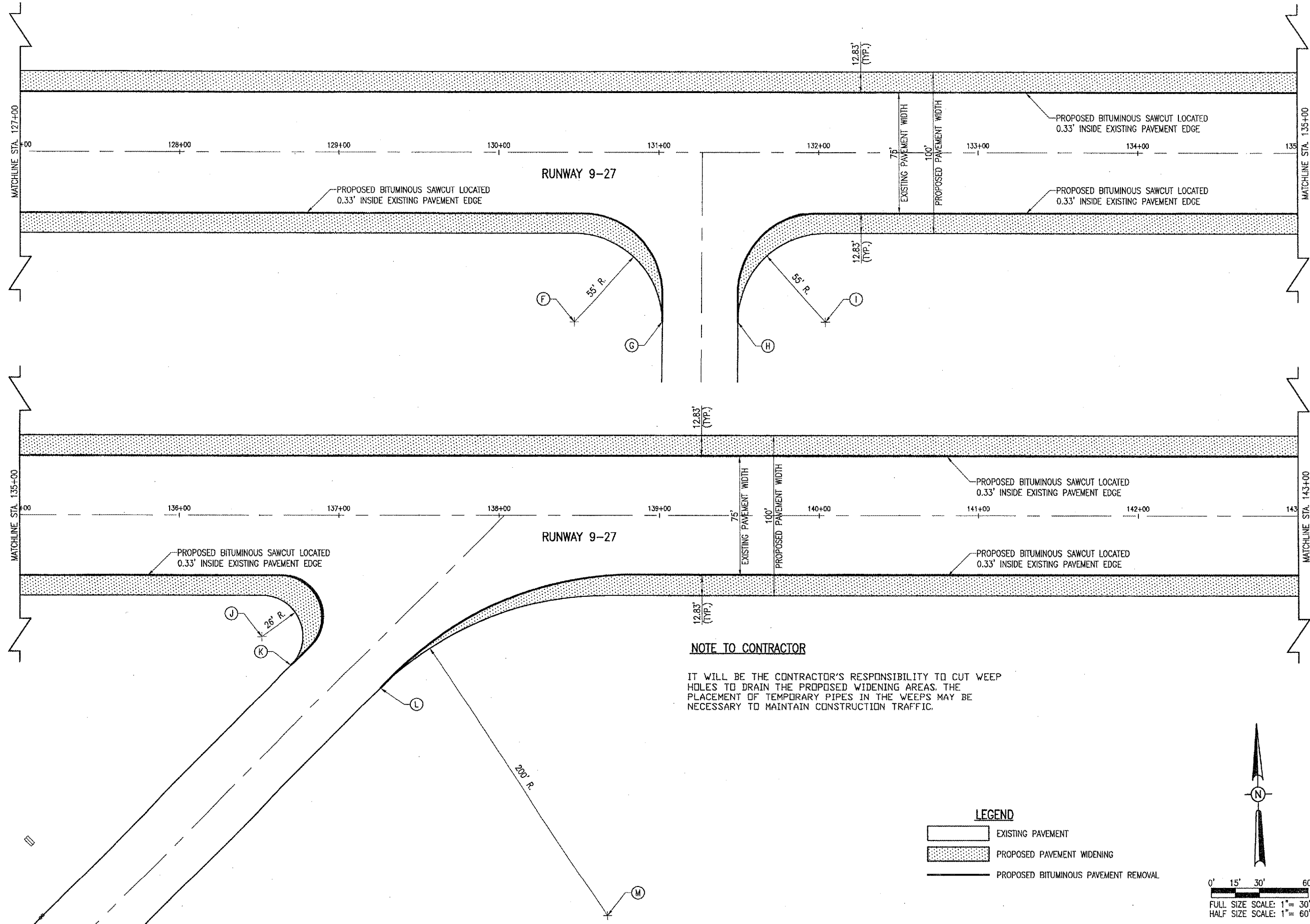

RB014



NOTE TO CONTRACTOR

IT WILL BE THE CONTRACTOR'S RESPONSIBILITY TO CUT WEEP HOLES TO DRAIN THE PROPOSED WIDENING AREAS. THE PLACEMENT OF TEMPORARY PIPES IN THE WEEPS MAY BE NECESSARY TO MAINTAIN CONSTRUCTION TRAFFIC.

LEGEND

-  EXISTING PAVEMENT
-  PROPOSED PAVEMENT WIDENING
-  PROPOSED BITUMINOUS PAVEMENT REMOVAL

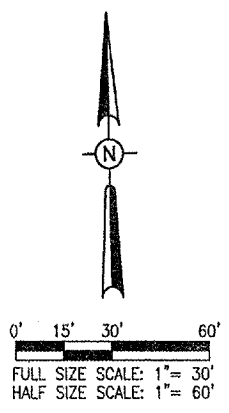

DATE	REVISION	BY

ROBINSON MUNICIPAL AIRPORT
 ROBINSON
 CRAWFORD COUNTY, ILLINOIS

IL. PROJ.: RSY-3490 A.I.P. PROJ.: 3-17-0086-B10

Proj. No. 838-04RWY	
Drawn R-121CON.DWG	
Scale 1"=30'	
Date 01/13/04	
LAYOUT CCC	01/13/04
DRAWN CCC	01/13/04
REVIEWED CAH	03/05/04



Hanson Professional Services Inc.
 1525 South Sixth Street
 Springfield, Illinois 62705-2486
 Offices Nationwide

**RUNWAY 9-27
 WIDENING**

PROPOSED
 CONSTRUCTION PLAN

STA. 127+00 TO STA. 143+00