

TAXIWAY A

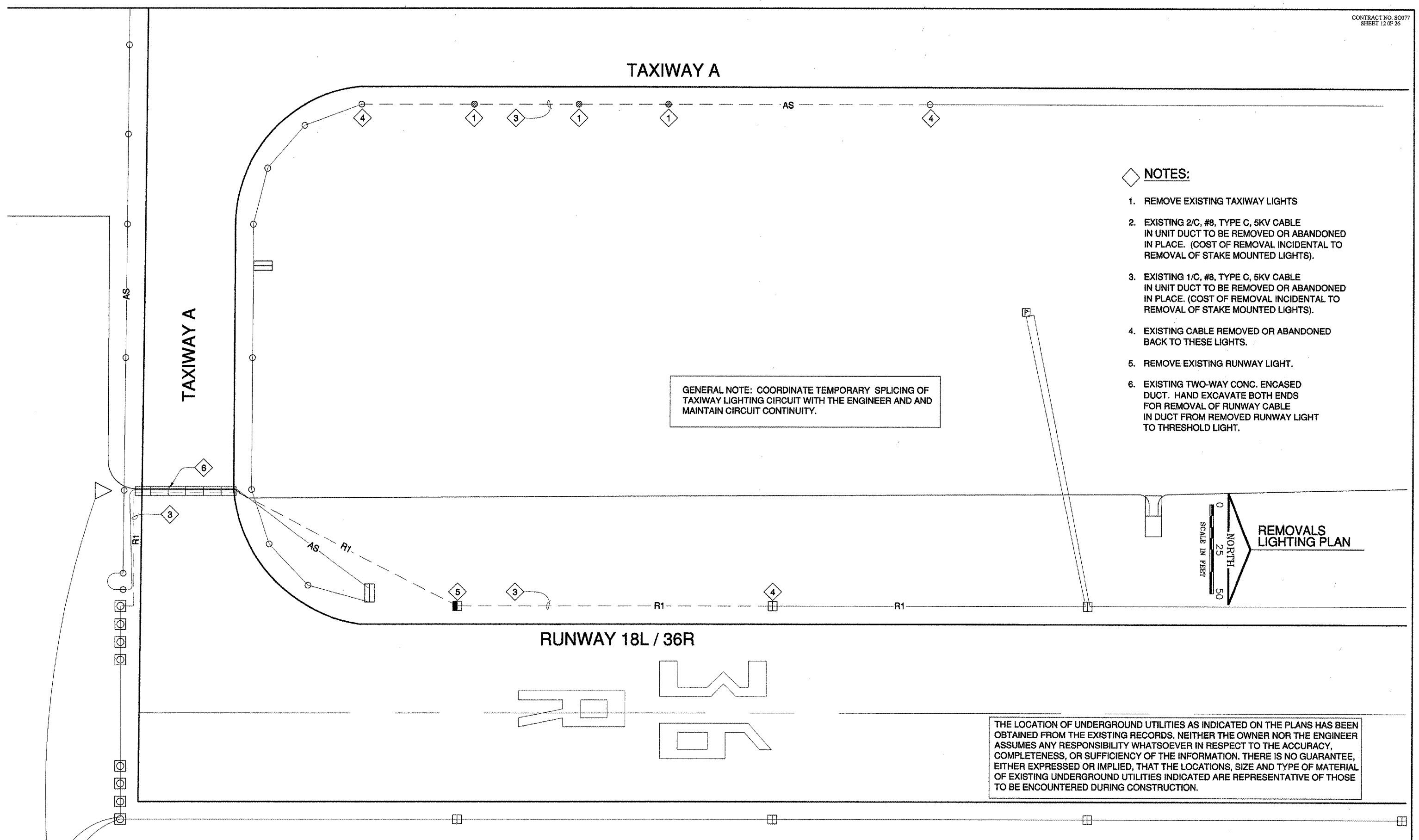

GENERAL NOTE: COORDINATE TEMPORARY SPLICING OF TAXIWAY LIGHTING CIRCUIT WITH THE ENGINEER AND AND MAINTAIN CIRCUIT CONTINUITY.

- ◆ NOTES:
1. REMOVE EXISTING TAXIWAY LIGHTS
  2. EXISTING 2/C, #8, TYPE C, 5KV CABLE IN UNIT DUCT TO BE REMOVED OR ABANDONED IN PLACE. (COST OF REMOVAL INCIDENTAL TO REMOVAL OF STAKE MOUNTED LIGHTS).
  3. EXISTING 1/C, #8, TYPE C, 5KV CABLE IN UNIT DUCT TO BE REMOVED OR ABANDONED IN PLACE. (COST OF REMOVAL INCIDENTAL TO REMOVAL OF STAKE MOUNTED LIGHTS).
  4. EXISTING CABLE REMOVED OR ABANDONED BACK TO THESE LIGHTS.
  5. REMOVE EXISTING RUNWAY LIGHT.
  6. EXISTING TWO-WAY CONC. ENCASED DUCT. HAND EXCAVATE BOTH ENDS FOR REMOVAL OF RUNWAY CABLE IN DUCT FROM REMOVED RUNWAY LIGHT TO THRESHOLD LIGHT.

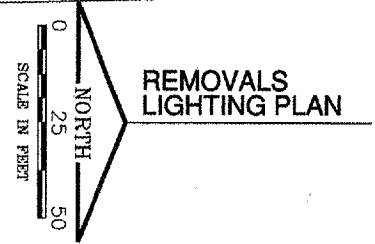

THE LOCATION OF UNDERGROUND UTILITIES AS INDICATED ON THE PLANS HAS BEEN OBTAINED FROM THE EXISTING RECORDS. NEITHER THE OWNER NOR THE ENGINEER ASSUMES ANY RESPONSIBILITY WHATSOEVER IN RESPECT TO THE ACCURACY, COMPLETENESS, OR SUFFICIENCY OF THE INFORMATION. THERE IS NO GUARANTEE, EITHER EXPRESSED OR IMPLIED, THAT THE LOCATIONS, SIZE AND TYPE OF MATERIAL OF EXISTING UNDERGROUND UTILITIES INDICATED ARE REPRESENTATIVE OF THOSE TO BE ENCOUNTERED DURING CONSTRUCTION.