

CODE NO.	ITEM	UNIT	TOTAL QUANTITY	CONSTRUCTION CODE	
				80% FED 20% STATE	
				ROADWAY	WALL
				URBAN	
				0004	0004
				RURAL	S. N. 022-2035
20100110	TREE REMOVAL (6 TO 15 UNITS DIAMETER)	UNIT	12	12	
20101400	NITROGEN FERTILIZER NUTRIENT	POUND	13	13	
20101500	PHOSPHORUS FERTILIZER NUTRIENT	POUND	13	13	
20101600	POTASSIUM FERTILIZER NUTRIENT	POUND	13	13	
20200100	EARTH EXCAVATION	CU YD	150	150	
20400800	FURNISHED EXCAVATION	CU YD	13	13	
20800150	TRENCH BACKFILL	CU YD	53	53	
21101615	TOPSOIL FURNISH AND PLACE, 4"	SQ YD	668	668	
25000210	SEEDING, CLASS 2A	ACRE	0.14	0.14	
25100630	EROSION CONTROL BLANKET	SQ YD	647	647	
25200200	SUPPLEMENTAL WATERING	UNIT	5	5	
28000400	PERIMETER EROSION BARRIER	FOOT	737	737	
28000500	INLET AND PIPE PROTECTION	EACH	6	6	
40600290	BITUMINOUS MATERIALS (TACK COAT)	POUND	10	10	

CODE NO.	ITEM	UNIT	TOTAL QUANTITY	CONSTRUCTION CODE	
				80% FED 20% STATE	
				ROADWAY	WALL
				URBAN	
				0004	0004
				RURAL	S. N. 022-2035
44004000	PAVED DITCH REMOVAL	FOOT	592	592	
44201835	CLASS D PATCHES, TYPE I, 16 INCH	SQ YD	12	12	
44201843	CLASS D PATCHES, TYPE III, 16 INCH	SQ YD	19	19	
44201845	CLASS D PATCHES, TYPE IV, 16 INCH	SQ YD	90	90	2
50102400	CONCRETE REMOVAL	CU YD	52		52
50200100	STRUCTURE EXCAVATION	CU YD	125		125
50300225	CONCRETE STRUCTURES	CU YD	131		131
50300300	PROTECTIVE COAT	SQ YD	534	172	362
50500505	STUD SHEAR CONNECTORS	EACH	763		763
50800205	REINFORCEMENT BARS, EPOXY COATED	POUND	14910		14910
51500100	NAME PLATES	EACH	1		1
52200105	FURNISHING SOLDIER PILES (W SECTION)	FOOT	2052		2052
52200200	DRILLING AND SETTING SOLDIER PILES (IN SOIL)	CU FT	9120		9120
52200250	UNTREATED TIMBER LAGGING	SQ FT	2394		2394
550A0050	STORM SEWERS, CLASS A, TYPE 1 12"	FOOT	42	42	

**HBM**  
ENGINEERING GROUP, LLC  
CONSTRUCTION & DESIGN  
INSPECTION & TESTING  
RESEARCH & TESTING

4415 WEST HARRISON ST.  
SUITE 231  
HILLSIDE, IL 60162  
PHONE: (708) 236-0900  
FAX: (708) 236-0901

USER NAME = Kenndobant  
DESIGNED - KJD  
DRAWN - KJD  
CHECKED - JMG  
DATE - 06/01/2017  
REVISED -  
REVISED -  
REVISED -  
REVISED -

STATE OF ILLINOIS  
DEPARTMENT OF TRANSPORTATION

SUMMARY OF QUANTITIES  
IL 53 (LINCOLN AVE)

SCALE: SHEET 1 OF 3 SHEETS STA. TO STA.

F.A.P. RTE. 870	SECTION 543R-1	COUNTY	TOTAL SHEETS 47	SHEET NO. 03
DU PAGE			CONTRACT NO. 62C18	
[ILLINOIS] FED. AID PROJECT				

REV 7-26-17

CODE NO.	ITEM	UNIT	TOTAL QUANTITY	CONSTRUCTION CODE	
				80% FED 20% STATE	
				ROADWAY	WALL
				URBAN	
				0004	0004
				RURAL	S.N. 022-2035
550A0340	STORM SEWERS, CLASS A, TYPE 2 12"	FOOT	4	4	
550A0380	STORM SEWERS, CLASS A, TYPE 2 18"	FOOT	31	31	
55100500	STORM SEWER REMOVAL 12"	FOOT	32	32	
59100100	GEOCOMPOSITE WALL DRAIN	SQ YD	266		266
60201340	CATCH BASINS, TYPE A, 4'-DIAMETER, TYPE 24 FRAME AND GRATE	EACH	1	1	
60205040	CATCH BASINS, TYPE A, 5'-DIAMETER, TYPE 24 FRAME AND GRATE	EACH	1	1	
60206905	CATCH BASINS, TYPE C, TYPE 1 FRAME, OPEN LID	EACH	3	3	
60234200	INLETS, TYPE A, TYPE 1 FRAME, OPEN LID	EACH	2	2	
60250200	CATCH BASINS TO BE ADJUSTED	EACH	2	2	
60500060	REMOVING INLETS	EACH	3.0	3	
60615400	PAVED DITCH, TYPE A-15	FOOT	603	603	
60618300	CONCRETE MEDIAN SURFACE, 4 INCH	SQ FT	270	270	
64300750	IMPACT ATTENUATORS (SEVERE USE, NARROW), TEST LEVEL 2	EACH	1	1	
67000400	ENGINEER'S FIELD OFFICE, TYPE A	CAL MO	3	3	

CODE NO.	ITEM	UNIT	TOTAL QUANTITY	CONSTRUCTION CODE	
				80% FED 20% STATE	
				ROADWAY	WALL
				URBAN	
				0004	0004
				RURAL	S.N. 022-2035
67100100	MOBILIZATION	LSUM	1	1	
70300904	PAVEMENT MARKING TAPE, TYPE IV 4"	FOOT	1306	1306	▲
78000200	THERMOPLASTIC PAVEMENT MARKING -LINE 4"	FOOT	540	540	
X0322906	WEEP HOLES CORED	EACH	21		21
X0327980	PAVEMENT MARKING REMOVAL -WATER BLASTING	SO FT	179	179	
X5537800	STORM SEWERS TO BE CLEANED 12"	FOOT	66	66	
X5860110	GRANULAR BACKFILL FOR STRUCTURES	CU YD	218		218
X7010216	TRAFFIC CONTROL AND PROTECTION. (SPECIAL)	LSUM	1	1	
X7030005	TEMPORARY PAVEMENT MARKING REMOVAL	SO FT	431	431	▲
X7040010	TEMPORARY CONCRETE BARRIER (SPECIAL)	FOOT	113	113	
Z0004562	COMBINATION CURB AND GUTTER REMOVAL AND REPLACEMENT	FOOT	1054	1054	▲
Z0013798	CONSTRUCTION LAYOUT	LSUM	1	1	
Z0018500	DRAINAGE STRUCTURES TO BE CLEANED	EACH	2	2	
Z0030850	TEMPORARY INFORMATION SIGNING	SO FT	51	51	

14

14

**HBM**  
ENGINEERING GROUP, LLC  
CONSULTING & DESIGN  
INSPECTION & TESTING  
RESEARCH & TESTING

4415 WEST HARRISON ST.  
SUITE 229  
MILLSIDE, IL 60162  
PHONE: (708) 238-0900  
FAX: (708) 238-0901

USER NAME = Ken.drabons  
DESIGNED - KJD  
DRAWN - KJD  
CHECKED - JMC  
DATE - 06/01/2017

REVISED -  
REVISED -  
REVISED -  
REVISED -

STATE OF ILLINOIS  
DEPARTMENT OF TRANSPORTATION

SUMMARY OF QUANTITIES  
IL 53 (LINCOLN AVE)  
SCALE: SHEET 2 OF 3 SHEETS STA. TO STA.

F.A.P. RTE. SECTION COUNTY TOTAL SHEETS SHEET NO.  
870 543R-1 DU PAGE 47 04  
CONTRACT NO. 62C18  
ILLINOIS FED. AID PROJECT

NON-PARTICIPATING

▲ REV 7-19-17 ▲ REV 7-26-17 REV

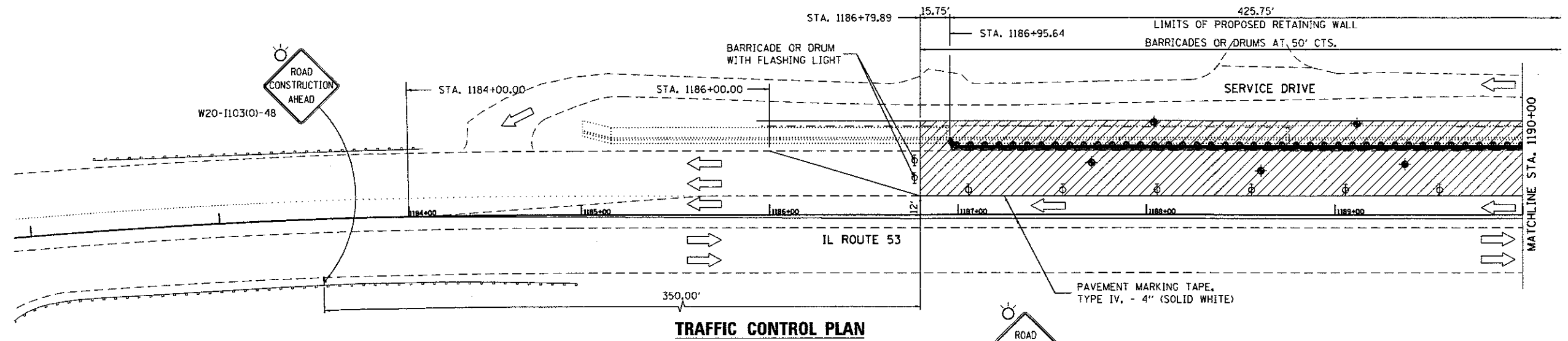
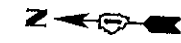

**TRAFFIC CONTROL PLAN**

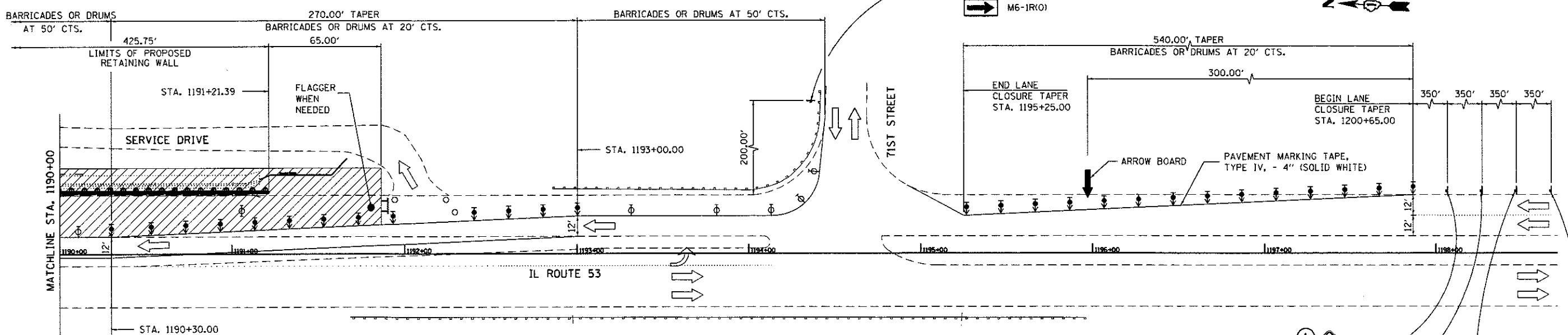

**TRAFFIC CONTROL PLAN**

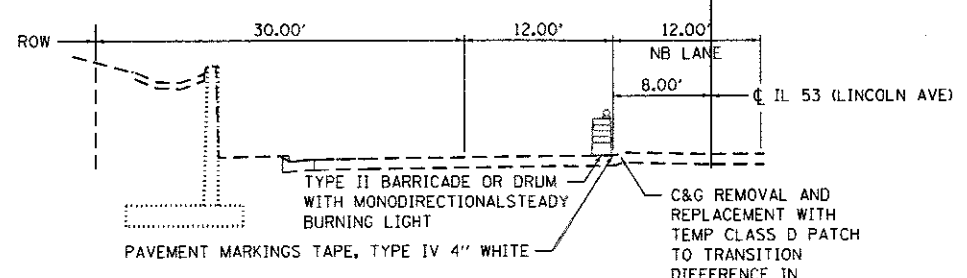

**TYPICAL STAGING SECTION**  
(STA. 1186+79.89 TO STA. 1190+30.00)

**STAGING NOTES:**  
 PRE-STAGE DRAINAGE STRUCTURES NO 8 AND 9, STORM SEWER NO. 8 IN MEDIAN AND UNDER NB LANE TO BE INSTALLED USING STANDARD 701602 DURING ALLOWABLE HOURS AS SPECIFIED IN THE SP 'KEEPING ARTERIAL ROADWAYS OPEN TO TRAFFIC' PRIOR TO STAGING SHOWN ON THIS SHEET.

① THIS SIGN SHALL BE TAKEN DOWN WHEN WORKER/FLAGGER IS NOT PRESENT

**SYMBOLS**

- ➡ ARROW BOARD
- ➡ TRAFFIC DIRECTION
- ⊕ TYPE II BARRICADE OR DRUM WITH MONODIRECTIONAL STEADY BURNING LIGHT
- ⊔ SIGN ON PORTABLE OR PERMANENT SUPPORT
- FLAGGER WITH TRAFFIC CONTROL SIGN.
- ▨ WORK AREA
- ⊕ DIRECTION INDICATOR BARRICADE WITH STEADY BURN MONODIRECTIONAL LIGHT @ 20' CENTERS
- ⊔ BARRICADE TYPE III
- DRUMS

ENTIRE SHEET REVISED

<b>HBM</b> ENGINEERING GROUP, LLC. CONSULTING & DESIGN INSPECTION & TESTING RESEARCH & TESTING 4415 WEST HARRISON ST. SUITE 231 HILLSDALE, IL 62162 PHONE: (708) 236-0900 FAX: (708) 236-0901	USER NAME = Ken-drabant	DESIGNED - KJD	REVISED - 6/28/2017
	PLOT SCALE = 60,0000' / 1"	DRAWN - KJD	REVISED - 7/25/2017
	PLOT DATE = 7/25/2017	CHECKED - JMG	REVISED -
		DATE - 06/01/2017	REVISED -

STATE OF ILLINOIS  
 DEPARTMENT OF TRANSPORTATION

MAINTENANCE OF TRAFFIC  
 IL 53 (LINCOLN AVE)  
 SCALE: SHEET 1 OF 1 SHEETS STA. TO STA.

F.A.P. RTE.	SECTION	COUNTY	TOTAL SHEETS	SHEET NO.
870	543R-1	DU PAGE	47	13
ILLINOIS FED. AID PROJECT			CONTRACT NO. 62C18	

REVISD SHEET 7-26-17