

STATE OF ILLINOIS DEPARTMENT OF TRANSPORTATION DIVISION OF HIGHWAYS

F.A.U. ROUTE	SECTION	COUNTY	TOTAL SHEETS	SHEET NO.
7991	14-00477-00-BR	SANGAMON	403	1
ILLINOIS CONTRACT NO. 93704				

# PROPOSED HIGHWAY PLANS USABLE SEGMENT II

## F.A.U. ROUTE 7991 (LAUREL STREET) & F.A.U. ROUTE 7992 (ASH STREET) AT 10TH ST. CORRIDOR / RR UNDERPASS

### SECTION 14-00477-00-BR PROJECT TIG-5146(098) RECONSTRUCTION

### CITY OF SPRINGFIELD, SANGAMON COUNTY C-96-203-17

INDEX OF SHEETS  
SEE SHEET NO. 2

FOR LIST OF STANDARDS  
SEE SHEET NO. 2

**ALL BALLAST & TRACKWORK  
BY NSRR**

#### LAUREL STREET

FUNCTIONAL CLASSIFICATION MAJOR COLLECTOR  
2012 ADT = 5000  
2030 DHV = 710  
FAU ROUTE 7991 LAUREL STREET RECONSTRUCTION  
DESIGN SPEED: LAUREL ST. - 30 M.P.H.  
LAUREL STREET GROSS ROADWAY LENGTH  
= 976.0 FT. = 0.185 MILE  
NET PROJECT LENGTH = 976.0 FT. = 0.185 MILE

#### ASH STREET

FUNCTIONAL CLASSIFICATION MINOR ARTERIAL  
2012 ADT = 6800  
2030 DHV = 970  
FAU ROUTE 7992 ASH STREET RECONSTRUCTION  
DESIGN SPEED: ASH ST. - 30 M.P.H.  
ASH STREET GROSS ROADWAY LENGTH  
= 1114 FT. = .211 MILE  
NET PROJECT LENGTH = 1114 FT. = 0.211 MILE

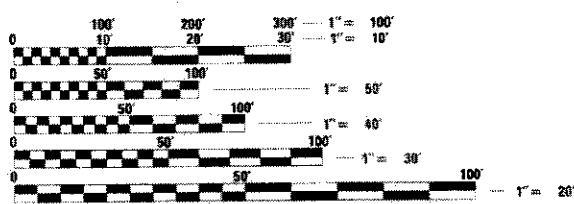

FULL SIZE PLANS HAVE BEEN PREPARED USING STANDARD ENGINEERING SCALES. REDUCED SIZED PLANS WILL NOT CONFORM TO STANDARD SCALES. IN MAKING MEASUREMENTS ON REDUCED PLANS, THE ABOVE SCALES MAY BE USED.

J.U.L.I.E.  
JOINT UTILITY LOCATION INFORMATION FOR EXCAVATION  
1-800-892-0123  
OR 811



PROJECT ENGINEER: MICHAEL MENDENHALL (217)788-2450  
PROJECT MANAGER: JIM MOLL (217)788-2450

CONTRACT NO. 93704

Revised 7/27/17

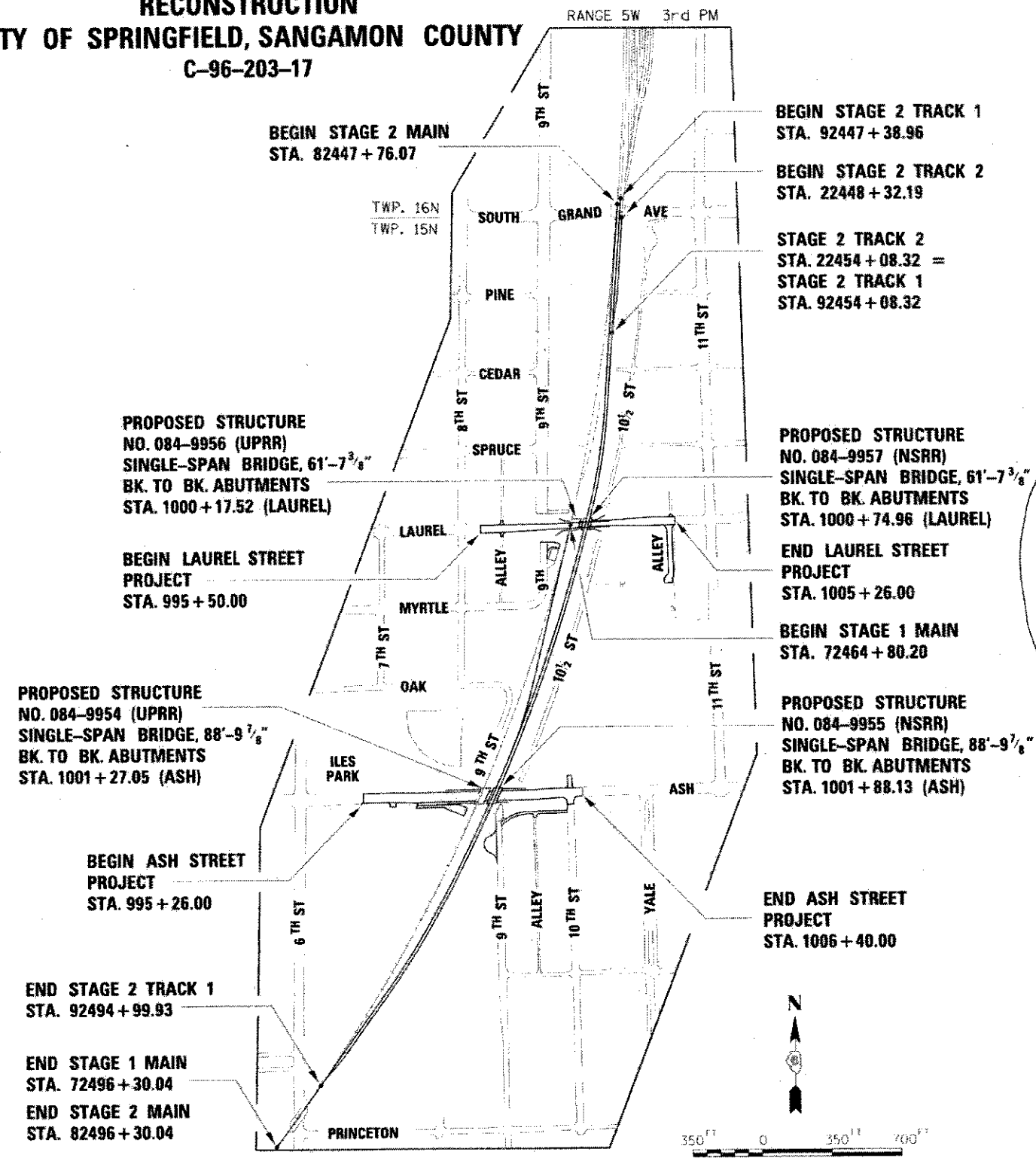

BEGIN STAGE 2 TRACK 1  
STA. 92447 + 38.96

BEGIN STAGE 2 TRACK 2  
STA. 22448 + 32.19

STAGE 2 TRACK 2  
STA. 22454 + 08.32 =  
STAGE 2 TRACK 1  
STA. 92454 + 08.32

PROPOSED STRUCTURE  
NO. 084-9957 (NSRR)  
SINGLE-SPAN BRIDGE, 61'-7 3/8"  
BK. TO BK. ABUTMENTS  
STA. 1000 + 74.96 (LAUREL)

END LAUREL STREET  
PROJECT  
STA. 1005 + 26.00

BEGIN STAGE 1 MAIN  
STA. 72464 + 80.20

PROPOSED STRUCTURE  
NO. 084-9955 (NSRR)  
SINGLE-SPAN BRIDGE, 88'-9 1/8"  
BK. TO BK. ABUTMENTS  
STA. 1001 + 88.13 (ASH)

END ASH STREET  
PROJECT  
STA. 1006 + 40.00

END STAGE 2 TRACK 1  
STA. 92494 + 99.93

END STAGE 1 MAIN  
STA. 72496 + 30.04  
END STAGE 2 MAIN  
STA. 82496 + 30.04

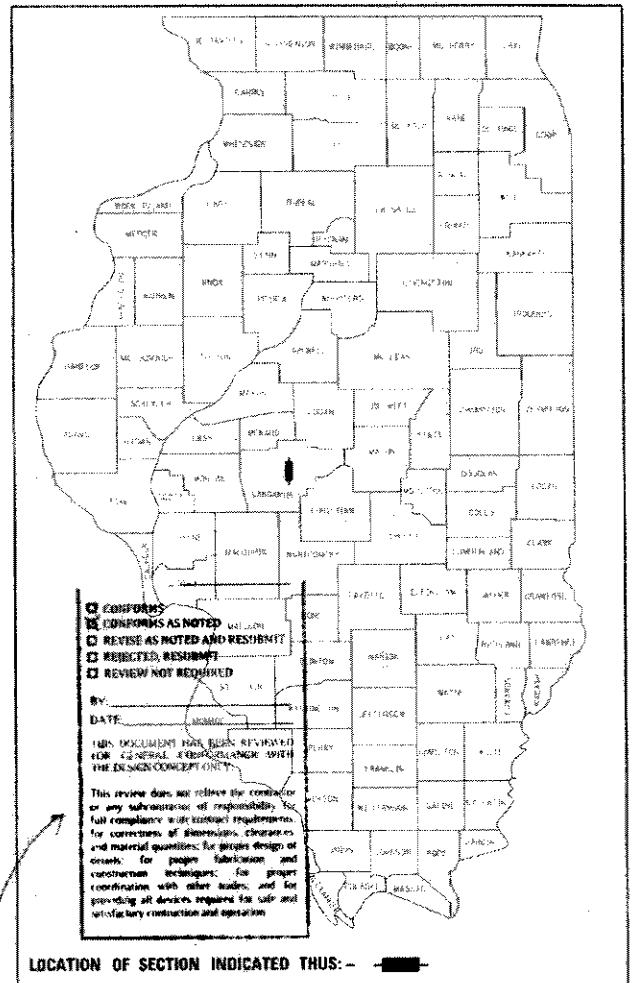
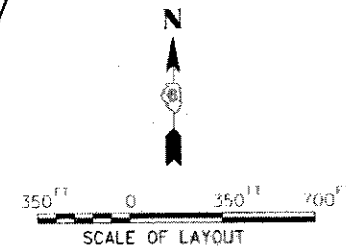

APPROVED *July 26 2017*  
*Richard R. Green*  
FEDERAL RAILROAD ADMINISTRATION

APPROVED *June 6 2017*  
*Conforms as Noted*  
NORFOLK SOUTHERN RAILWAY COMPANY

APPROVED *April 14 2017*  
*Nath. Bottom*  
CITY ENGINEER

APPROVED *April 20 2017*  
*Jim Moll*  
DISTRICT LOCAL ROADS AND STREETS ENGINEER

APPROVED *April 20 2017*  
*Ron Schwaninger*  
DISTRICT CONSTRUCTION ENGINEER

APPROVED *April 20 2017*  
*John M. Smith*  
DEPUTY DIRECTOR OF HIGHWAYS, REGION FOUR ENGINEER

© Copyright Hanson Professional Services Inc. 2017





© Copyright Hanson Professional Services Inc. 2017

CODE NO.	ITEM	UNIT	TOTAL QUANTITY	ASH UPRR BRIDGE 084-9954	LAUREL UPRR BRIDGE 084-9956	ASH NSRR BRIDGE 084-9955	LAUREL NSRR BRIDGE 084-9957	ASH	LAUREL	MISC.
				0% GCPF ELIGIBLE	0% GCPF ELIGIBLE	60.5% GCPF ELIGIBLE	60.5% GCPF ELIGIBLE	100% GCPF ELIGIBLE	100% GCPF ELIGIBLE	0% GCPF ELIGIBLE
△ *	Z0057100	SANITARY SEWER 12"	FOOT	345					345	
△ *	Z0057300	SANITARY SEWER 18"	FOOT	457					457	
△ *	Z0057700	SANITARY SEWER 30"	FOOT	65				65		
△ *	Z0057900	SANITARY SEWER 36"	FOOT	122				122		
△ *	Z0058000	SANITARY SEWER, SPECIAL	FOOT	282				282		
△ *	Z0067900	STEEL CASINGS 24"	FOOT	137					137	
△ *	Z0069700	SUB-BALLAST	CU YD	15614						15614
△ *	Z0076100	TRACK REMOVAL	FOOT	7643						7643
# *	Z0076600	TRAINEES	HOUR	5000						
# *	Z0076604	TRAINEES TRAINING PROGRAM GRADUATE	HOUR	5000						
△ *	XX009197	SEWER IN METAL LINER, 12"	FOOT	190					190	
△ *	XX009202	SEWER IN METAL LINER, 72"	FOOT	54				54		

\* PAY ITEM REQUIRES A SPECIAL PROVISION △ SPECIALTY ITEM #0042

FINAL  
DESIGNED: JWM 7/20/2015  
DRAWN: DJP 7/20/2015  
REVIEWED: MNM 10/11/2015

FILE NAME: D:\09L0179B-sh1-S00-US11-001.dgn	USER NAME: Johns00944	DESIGNED - JWM	REVISED - 7/27/17
		DRAWN - DJP	REVISED -
		CHECKED - JWM/MNM	REVISED -
		DATE - 5/26/2017	REVISED -

STATE OF ILLINOIS  
DEPARTMENT OF TRANSPORTATION

SPRINGFIELD RAIL IMPROVEMENTS PROJECT  
SPRINGFIELD, SANGAMON COUNTY, ILLINOIS  
SUMMARY OF QUANTITIES - 18

F.A.U. RTE.	SECTION	COUNTY	TOTAL SHEETS	SHEET NO.
	14-00477-00-BR	SANGAMON	403	22
09L0179B		CONTRACT NO. 93704		
ILLINOIS FED. AID PROJECT				

SCALE: SHEET 18 OF 20 SHEETS STA. TO STA.