

CODE NO.	ITEM	UNIT	TOTAL QUANTITY	CONSTRUCTION CODE				
				LAKE COUNTY		MCHENRY COUNTY		
				80% FED 20% STATE		80% FED 20% STATE		
				URBAN		URBAN		
				SPECIAL BRIDGE				
				LOCATION 5	LOCATION 4	LOCATION 1	LOCATION 3	LOCATION 2
				0044	0004	0004	0004	0004
				URBAN ✓	S.N. 056-0251	S.N. 056-0280	S.N. 056-0283	S.N. 056-0284
20100110	TREE REMOVAL (6 TO 15 UNITS DIAMETER)	UNIT	60				60	
20200100	EARTH EXCAVATION	CU YD	351.7		200.7			151
20201200	REMOVAL AND DISPOSAL OF UNSUITABLE MATERIAL	CU YD	20		11			9
20800150	TRENCH BACKFILL	CU YD	7.7	7.7				
21101615	TOPSOIL FURNISH AND PLACE, 4"	SQ YD	280		142			138
25000210	SEEDING, CLASS 2A	ACRE	0.11		0.03	0.03	0.02	0.03
25000400	NITROGEN FERTILIZER NUTRIENT	POUND	11		3	3	2	3
25000600	POTASSIUM FERTILIZER NUTRIENT	POUND	11		3	3	2	3
25100630	EROSION CONTROL BLANKET	SQ YD	280		142			138
28000400	PERIMETER EROSION BARRIER	FOOT	880		222	236	174	248
30300001	AGGREGATE SUBGRADE IMPROVEMENT	CU YD	37		22			15
42001300	PROTECTIVE COAT	SQ YD	168	168				
42300400	PORTLAND CEMENT CONCRETE DRIVEWAY PAVEMENT, 8 INCH	SQ YD	112	112				
44000200	DRIVEWAY PAVEMENT REMOVAL	SQ YD	112	112				

14



USER NAME = Ken.dobant	DESIGNED - KJD	REVISED -
	DRAWN - KJD	REVISED -
PLOT SCALE = 40:0.0000 1" = 16'	CHECKED - RTB	REVISED -
PLOT DATE = 3/28/2017	DATE - 03/24/2017	REVISED -

STATE OF ILLINOIS  
DEPARTMENT OF TRANSPORTATION

SUMMARY OF QUANTITIES  
US ROUTE 12

SCALE: SHEET 1 OF 5 SHEETS STA. TO STA.

F.A.P. RTE. 334	SECTION 2015-087B	COUNTY MCHENRY/LAKE	TOTAL SHEETS 64	SHEET NO. 3
CONTRACT NO. 62B92			ILLINOIS FED. AID PROJECT	

△ REV 7-20-17

CODE NO.	ITEM	UNIT	TOTAL QUANTITY	CONSTRUCTION CODE					
				LAKE COUNTY		MCHENRY COUNTY			
				80% FED 20% STATE		80% FED 20% STATE URBAN			
				DRAINAGE		SPECIAL BRIDGE			
LOCATION 5		LOCATION 4	LOCATION 1	LOCATION 3	LOCATION 2				
0044		0004	0004	0004	0004				
URBAN		S.N. 056-0251	S.N. 056-0280	S.N. 056-0283	S.N. 056-0284				
550A0050	STORM SEWERS, CLASS A, TYPE 1 12"	FOOT	50	50					
60218300	MANHOLES, TYPE A, 4'-DIAMETER, TYPE 1 FRAME, OPEN LID	EACH	2	2					
60237470	INLETS, TYPE A, TYPE 24 FRAME AND GRATE	EACH	3	3					
60240328	INLETS, TYPE B, TYPE 24 FRAME AND GRATE	EACH	2	2					
60255700	MANHOLES TO BE ADJUSTED WITH NEW TYPE 1 FRAME, OPEN LID	EACH	1	1					
60264140	INLETS TO BE RECONSTRUCTED WITH NEW TYPE 24 FRAME AND GRATE	EACH	1	1					
60500060	REMOVING INLETS	EACH	1	1					
* 63000009	STEEL PLATE BEAM GUARDRAIL, TYPE B, 9 FOOT POSTS	FOOT	350		175				175
* 63000350	LONG-SPAN GUARDRAIL OVER CULVERT, 12 FT 6 IN SPAN	FOOT	75		37.5				37.5
* 63100167	TRAFFIC BARRIER TERMINAL, TYPE 1 (SPECIAL) TANGENT	EACH	1		1				
* W900200	NON-SPECIAL WASTE DISPOSAL	CU YD	638	638					
63200310	GUARDRAIL REMOVAL	FOOT	483		241.5				241.5
* W900450	SPECIAL WASTE PLANS AND REPORTS	L SUM	1	1					
67000400	ENGINEER'S FIELD OFFICE, TYPE A	CAL MO	6	1.2	1.2	1.2	1.2	1.2	1.2
* W900530	SOIL DISPOSAL ANALYSIS	EACH	2	2					
67100100	MOBILIZATION	LSUM	1	0.2	0.2	0.2	0.2	0.2	0.2
70300904	PAVEMENT MARKING TAPE, TYPE IV 4"	FOOT	6745		1511	2034	1689		1511
	* Specialty Item								



USER NAME = Ken.drabant  
DESIGNED - KJD  
DRAWN - KJD  
CHECKED - RTB  
DATE - 03/24/2017  
PLOT SCALE = 400.0000 1" = 100'  
PLOT DATE = 3/28/2017

REVISED -  
REVISED -  
REVISED -  
REVISED -

STATE OF ILLINOIS  
DEPARTMENT OF TRANSPORTATION

SUMMARY OF QUANTITIES  
US ROUTE 12

SCALE: SHEET 3 OF 5 SHEETS STA. TO STA.

F.A.P. RTE.	SECTION	COUNTY	TOTAL SHEETS	SHEET NO.
334	2015-087B	MCHENRY/LAKE	64	5
CONTRACT NO. 62B92				
ILLINOIS FED. AIG PROJECT				

REV 7-20-17

Rev

**BENCHMARK**

TOP OF RIM OF STRUCTURE NO. 1  
ELEVATION 747.38

**HORIZONTAL CONTROL**

STATIONING SHOWN IS WITH RESPECT TO CP#1 WHICH IS EAST CORNER OF SOUTH END OF WING WALL STATION 12+03.86 7.45' RIGHT. STATIONING INCREASES GOING SOUTH, DISTANCE IS MEASURED ALONG THE EDGE OF PAVEMENT. OFFSETS MEASURED FROM EDGE OF PAVEMENT.

DATE	
BY	
REVISIONS	
NO.	
DESCRIPTION	
DATE	
BY	

DATE	
BY	
REVISIONS	
NO.	
DESCRIPTION	
DATE	
BY	

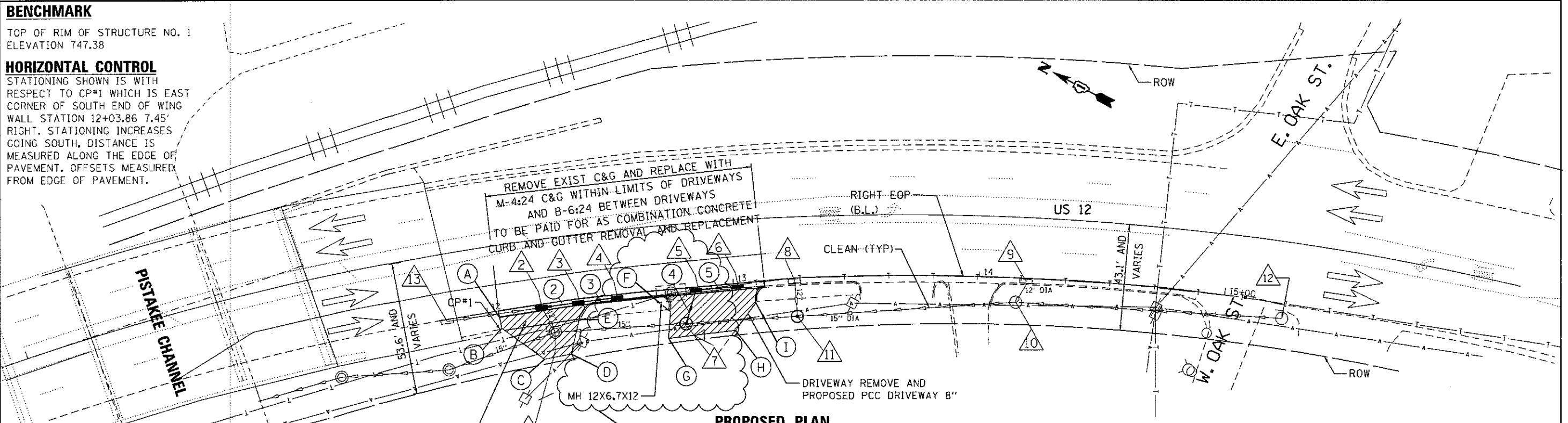

**PROPOSED PLAN**

- 1 EXIST MANHOLE CLOSED LID TO BE ADJUSTED WITH NEW T-1 FRAME OPEN LID (CLEAN)  
STA. 12+25.8 12.16 RT  
T.G. 747.38  
INV. 740.18 (SE)  
INV. 740.08 (NW)
- 2 EXISTING STORM INLET TO BE REMOVED AND REPLACED WITH INLET T-B 4.0 FT DIA W/T-24 F&G  
STA. 12+22, 0.0 (O/S)  
T.G. 747.8  
INV. 745.1 (W) MATCH EXIST VIF  
INV. 745.1 (NW) MATCH EXIST VIF  
INV. 745.1 (S)
- 3 INLET T-A 2.0 FT DIA. W/T-24 F&G  
STA. 12+37, 0.0 FT (O/S)  
T.G. 747.96  
INV. 745.16 (S)  
INV. 745.16 (N)
- 4 INLET, T-A 2.0 FT DIA. W/T-24 F&G  
STA. 12+53.0, 0.0 FT (O/S)  
T.G. 747.88  
INV. 745.23 (N)
- 5 INLET, T-B 4.0 FT DIA. W/T-24 F&G  
STA. 12+85, 0.0 FT (RT)  
T.G. 748.19  
INV. 745.05 (S)  
INV. 745.05 (W)
- 6 INLET, T-A 2.0 FT DIA. W/T-24 F&G  
STA. 13+01.0, 0.0 FT (O/S)  
T.G. 748.27  
INV. 745.24 (N)
- 7 MH, T-A 4.0 FT DIA. W/T-1 OPEN LID  
STA. 12+79.6, 14.47 FT (RT) MEET EXIST SS VIF  
T.G. +/- 748.4 MEET EXIST GRND  
INV. 741.56 (N&S) NOTE 1  
INV. 744.88 (E)
- 8 EXISTING STORM INLET  
STA. 13+24.9, 0.0 FT (O/S)  
T.G. 748.6  
CLEAN
- 9 EXISTING STORM INLET  
STA. 14+19.2, 0.0 FT (O/S)  
T.G. 750.62  
CLEAN
- 10 EXISTING CB OR MH, W/BEE HIVE LID  
STA. 14+15.90, 9.9 FT (RT)  
T.G. 750.35  
INV. 745.05 (N&S) CLEAN
- 11 MH, T-A 4.0 FT DIA. W/T-1 OPEN LID  
STA 13+24.91, 15.60 FT (RT)  
T.G. (VERIFY MATCH EXISTING)  
INV. 742.72 (N&S) NOTE 1
- 12 EXISTING CATCH BASIN  
STA. 15+24.45, 5.64 FT (RT)  
CLEAN
- 13 EXISTING INLET TO BE RECONSTRUCTED W/T-24 F&G  
STA 11+83.21, 0.0 FT (RT)  
T.G. (VERIFY MATCH EXISTING)  
CLEAN
- 2 12" DIA STORM SEWER TYPE 1 @ 0.005 FT/FT - 12 FT 1.584 CY TB
- 3 12" DIA STORM SEWER TYPE 1 @ 0.005 FT/FT - 14 FT 1.806 CY TB
- 4 12" DIA STORM SEWER TYPE 1 @ 0.015 FT/FT - 11 FT 2.063 CY TB
- 5 12" DIA STORM SEWER TYPE 1 @ 0.015 FT/FT - 13 FT 2.158 CY TB

POINT	STATION	OFFSET
A	12+04.51	2.58 RT.
B	12+04.62	7.17 RT.
C	12+19.51	22.32 RT.
D	12+30.93	21.84 RT.
E	12+37.14	6.27 RT.
F	12+73.14	8.64 RT.
G	12+71.86	19.79 RT.
H	12+99.11	18.87 RT.
I	13+08.41	8.53 RT.

**NOTES**

- LOCATIONS SHOWN FOR STRUCTURES NO. 7 & 11 ARE APPROXIMATE. CONTRACTOR SHALL MAKE THEIR OWN DETERMINATION OF THE EXISTING SEWER HORIZONTAL AND VERTICAL LOCATION PRIOR TO FABRICATING STRUCTURE NO. 7 & 11.
- FOR MAINTENANCE OF TRAFFIC DURING CONSTRUCTION, CLOSE RIGHT LANE OF SB US 12 PER HIGHWAY STANDARD 701602
- FOR INLETS, THE OFFSET AND RIM ELEVATIONS ARE GIVEN TO EDGE OF PAVEMENT NOT CENTERLINE OF STRUCTURE. FIELD VERIFY ELEVATION.
- PAVEMENT DISTURBED WITH THE INSTALLATION OF DRAINAGE STRUCTURES SHALL BE REPLACED WITH CLASS D PATCH TYPE 1 15" OR APPROACH SLAB REPAIR (FULL DEPTH).
- PAVED SURFACE BEHIND CURB DISTURBED BY CONSTRUCTION OF NEW C&G SHALL BE REPAIRED WITH MINIMUM OF 2" HMA SURFACE COURSE. COST SHALL BE INCLUDED IN CLASS D PATCH, TYPE 1.

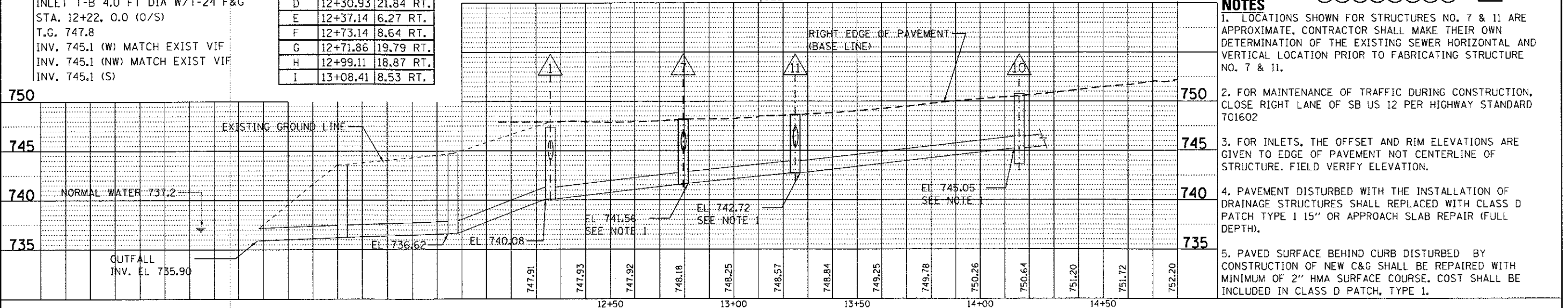

	USER NAME: marionagemy	DESIGNED: JMG	REVISED: 7/17/2017 MAA	STATE OF ILLINOIS DEPARTMENT OF TRANSPORTATION	LOCATION 5 - PROPOSED DRAINAGE PLAN WITH MAINTENANCE OF TRAFFIC			F.A.P. RTE. 334	SECTION 2015-087B	COUNTY MCHENRY/LAKE	TOTAL SHEETS 64	SHEET NO. 13
	PLOT SCALE: 40,0000 1" = 100'	CHECKED: RTB	REVISIONS:		SCALE: SHEET 4 OF 4 SHEETS	STA. TO STA.	ILLINOIS FED. AID PROJECT	CONTRACT NO. 62B92				
	PLOT DATE: 7/17/2017	DATE: 03/24/2017	REVISIONS:									

REV 7-20-17