

STATE OF ILLINOIS
DEPARTMENT OF TRANSPORTATION

F.A.P. RTE.	SECTION	COUNTY	TOTAL SHEETS	SHEET NO.
0341	FAP 0341 22CJ2	KANE	13	1
		ILLINOIS	CONTRACT NO. 62T78	

FOR INDEX OF SHEETS, SEE SHEET NO. 2

THIS PROJECT IS LOCATED IN THE VILLAGES OF WEST DUNDEE AND SLEEPY HOLLOW

PROPOSED
HIGHWAY PLANS

FAP ROUTE 341: IL 72 /MAIN STREET
0.1 MI W. OF RICHMOND ROAD TO 0.1 MI W. OF IL 31 (8th ST)
SECTION: FAP 0341 22CJ2

CRACK AND JOINT SEALING
KANE COUNTY

C-91-295-22

TRAFFIC DATA:

IL 72 (MAIN ST.):

RICHMOND ROAD TO IL 31(8TH ST.):
ADT (2021) = 20,100
SPEED LIMIT = 35 - 45 MPH

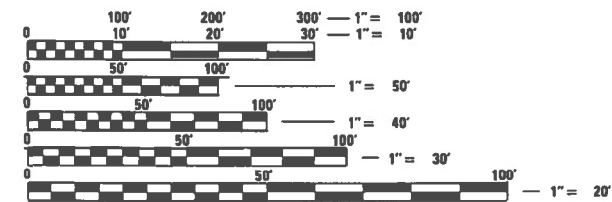

FULL SIZE PLANS HAVE BEEN PREPARED USING STANDARD ENGINEERING SCALES. REDUCED SIZED PLANS WILL NOT CONFORM TO STANDARD SCALES. IN MAKING MEASUREMENTS ON REDUCED PLANS, THE ABOVE SCALES MAY BE USED.

J.U.L.I.E.
JOINT UTILITY LOCATION INFORMATION FOR EXCAVATORS
1-800-892-0123
OR 811

PROJECT ENGINEER: VESELIN VELICHKOV (847) 705-4432
PROJECT MANAGER: FAWAD AQUEEL

CONTRACT NO. 62T78

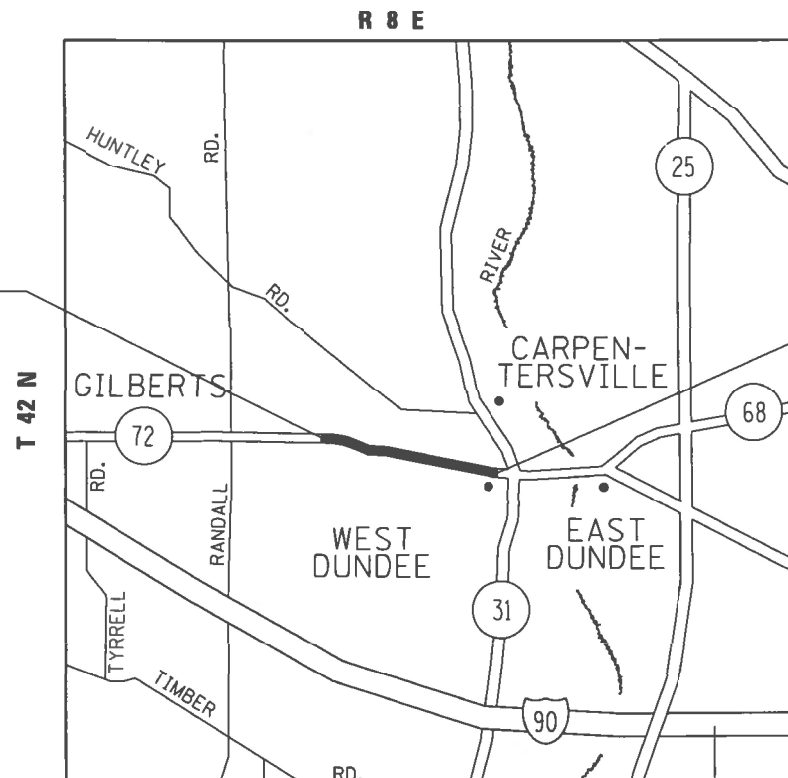

IMPROVEMENT BEGINS
STA. 18 + 20

IMPROVEMENT ENDS
STA. 131 + 34

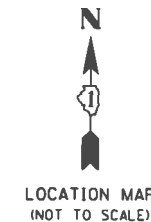

DUNDEE TOWNSHIP
GROSS AND NET LENGTH = 11,314 FT. = 2.14 MILES
NET LENGTH = 11,314 FT. = 2.14 MILES

D-91-242-22

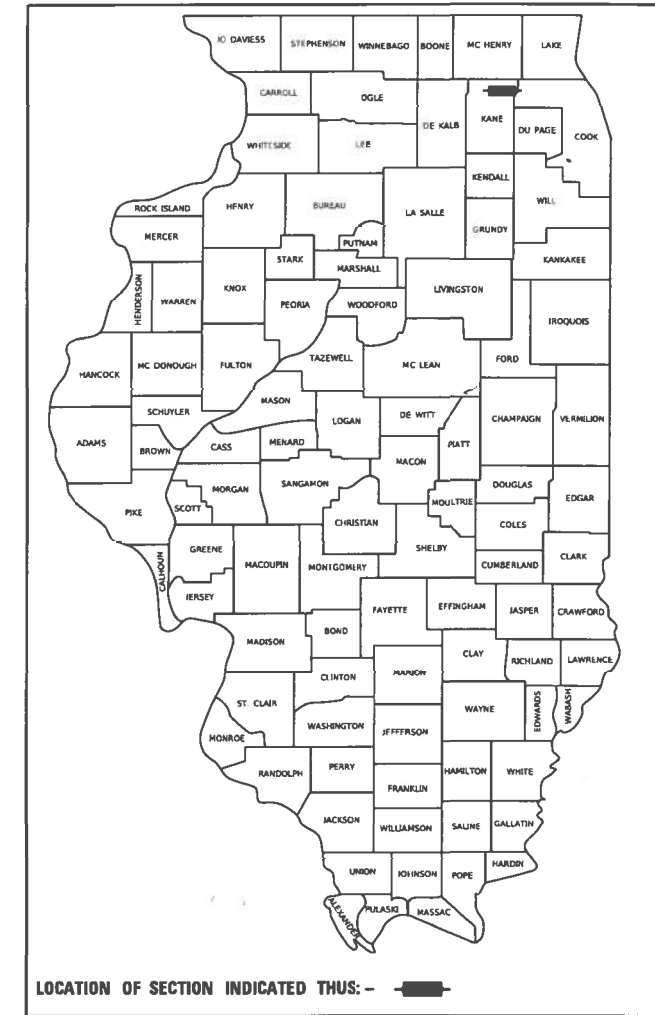

STATE OF ILLINOIS
DEPARTMENT OF TRANSPORTATION
SUBMITTED May 8 2023
Open Book LOP3
REGIONAL ENGINEER
June 30, 2023 SEA. ETK
ENGINEER OF DESIGN AND ENVIRONMENT
June 30, 2023 Stephen M. Smith
DIRECTOR OF HIGHWAYS PROJECT IMPLEMENTATION

PRINTED BY THE AUTHORITY
OF THE STATE OF ILLINOIS

INDEX OF SHEETS

STATE STANDARDS

GENERAL NOTES

SHEET NO.	DESCRIPTION	STANDARD NO.	DESCRIPTION
1	COVER SHEET	000001-08	STANDARD SYMBOLS, ABBREVIATIONS AND PATTERNS
2	INDEX OF SHEETS, STATE STANDARDS & GENERAL NOTES	701006-05	OFF-RD OPERATIONS, 2L, 2W, 15' (4.5m) TO 24" (600mm) FROM PAVEMENT EDGE
3	SUMMARY OF QUANTITIES	701011-04	OFF-RD MOVING OPERATIONS, 2L, 2W, DAY ONLY
4-8	ROADWAY AND PAVEMENT MARKING PLANS	701101-05	OFF-RD OPERATIONS, MULTILANE, 15' (4.5 m) TO 24" (600 mm) FROM PAVEMENT EDGE
9	PD-11: CRACK AND JOINT SEALING DETAIL	701301-04	LANE CLOSURE, 2L, 2W, SHORT TIME OPERATIONS
10	TC-10: TRAFFIC CONTROL AND PROTECTION FOR SIDE ROADS, INTERSECTIONS AND DRIVEWAYS	701306-04	LANE CLOSURE, 2L, 2W, SLOW MOVING OPERATIONS DAY ONLY, FOR SPEEDS \geq 45 MPH
11	TC-13: DISTRICT ONE TYPICAL PAVEMENT MARKINGS	701311-03	LANE CLOSURE, 2L, 2W MOVING OPERATIONS - DAY ONLY
12	TC-14: CONTROL AND PROTECTION AT TURN BAYS (TO REMAIN OPEN TO TRAFFIC)	701421-08	LANE CLOSURE, MULTILANE, DAY OPERATIONS ONLY, FOR SPEEDS \geq 45 MPH TO 55_MPH
13	TC-22: ARTERIAL ROAD INFORMATION SIGN	701426-09	LANE CLOSURE, MULTILANE, INTERMITTENT OR MOVING OPERATIONS, FOR SPEEDS > 40 MPH
		701427-05	LANE CLOSURE, MULTILANE, INTERMITTENT OR MOVING OPERATIONS, FOR SPEEDS \leq 40 MPH
		701501-06	URBAN LANE CLOSURE, 2L, 2W, UNDIVIDED
		701701-10	URBAN LANE CLOSURE, MULTILANE INTERSECTION
		701901-08	TRAFFIC CONTROL DEVICES

1. THE CONTRACTOR SHALL COORDINATE CONSTRUCTION ACTIVITIES WITH UTILITY COMPANIES, VILLAGE OF WEST DUNDEE, AND VILLAGE OF SLEEPY HOLLOW
2. THE CONTRACTOR SHALL CONTACT KALPANA KANNAN-HOSADURGA, THE DISTRICT ONE TRAFFIC CONTROL SUPERVISOR, AT KALPANA.KANNAN-HOSADURGA@ILLINOIS.GOV A MINIMUM OF 72 HOURS IN ADVANCE OF BEGINNING WORK.
3. THE CONTRACTOR WILL NOT BE ALLOWED TO SET UP A YARD OR FIELD OFFICE ON STATE PROPERTY WITHOUT THE WRITTEN PERMISSION OF THE DEPARTMENT.
4. BEFORE BEGINNING ANY WORK, THE CONTRACTOR SHALL RETAIN AND RECORD FOR FUTURE REFERENCE, ALL EXISTING PAVEMENT MARKING LINES (AND RAISED REFLECTIVE PAVEMENT MARKERS) IN ORDER THAT THESE LOCATIONS CAN BE RE-ESTABLISHED FOR STRIPING. EXACT LOCATIONS OF ALL PAVEMENT MARKINGS SHALL BE ASSHOWN ON THE PLANS OR DIRECTED BY THE RESIDENT ENGINEER.
5. THE RESIDENT ENGINEER SHALL CONTACT WALTER CZARNY, AREA TRAFFIC FIELD ENGINEER, VIA E-MAIL AT WALTER.CZARNY@ILLINOIS.GOV, A MINIMUM OF 2 WEEKS PRIOR TO PLACEMENT OF PERMANENT PAVEMENT MARKINGS.
6. IT SHALL BE THE CONTRACTOR'S RESPONSIBILITY TO VERIFY ALL DIMENSIONS AND CONDITIONS EXISTING IN THE FIELD PRIOR TO CONSTRUCTION AND ORDERING OF MATERIALS.
7. THE CONTRACTOR SHALL BE REQUIRED TO PROVIDE ACCESS TO ABUTTING PROPERTY AT ALL TIMES DURING THE CONSTRUCTION OF THIS PROJECT.
8. THE CONTRACTOR SHALL MAINTAIN PEDESTRIAN ACCESS AT ALL TIME DURING CONSTRUCTION.
9. MATERIALS RESULTING FROM THE ROUTING OF CRACKS IN THE EXISTING PAVEMENT MAY BE PLACED, SHAPED AND COMPACTED TO THE SATISFACTION OF THE ENGINEER ALONG EXISTING AGGREGATE SHOULDERS ADJACENT TO THE PAVEMENT. ALL MATERIALS RESULTING FROM THE ROUTING OF CRACKS IN PAVEMENTS WITHOUT AGGREGATE SHOULDERS AND SURPLUS MATERIALS RESULTING FROM THE ROUTING OF CRACKS IN PAVEMENTS WITH AGGREGATE SHOULDERS, WHERE ALL MATERIALS ARE NOT PLACED ALONG EXISTING AGGREGATE SHOULDERS, SHALL BE DISPOSED OF AS SPECIFIED IN ARTICLE 202.03 OF THE STANDARD SPECIFICATIONS. OLD SEALANTS REMOVED PRIOR TO ROUTING SHALL BE DISPOSED OF AS SPECIFIED IN ARTICLE 202.03. THIS WORK WILL NOT BE PAID FOR SEPARATELY, BUT THE COST SHALL BE CONSIDERED AS INCLUDED IN THE CONTRACT UNIT PRICE FOR THE CONSTRUCTION ITEMS INVOLVED, AND NO ADDITIONAL COMPENSATION WILL BE ALLOWED."

MODEL: Default
FILE: Main: P:\ulidect-zw-bentley.com\PI\DOT\Documents\DOT Offices\District 1\Projects\124222\CADD\data\Design\124222-sht-genecete.dgn

USER NAME = aaron.greifzu	DESIGNED -	REVISED -
	DRAWN -	REVISED -
PLOT SCALE = 100.0000 ' / in.	CHECKED -	REVISED -
PLOT DATE = 5/4/2023	DATE -	REVISED -

**STATE OF ILLINOIS
DEPARTMENT OF TRANSPORTATION**

**IL 72 (MAIN ST): RICHMOND RD TO IL 31
INDEX OF SHEETS, STATE STANDARDS & GENERAL NOTES**

SCALE: SHEET OF SHEETS STA. TO STA.

F.A.P. RTE.	SECTION	COUNTY	TOTAL SHEETS	SHEET NO.
0341	FAP 0341 22CJ2	KANE	13	2
ILLINOIS			CONTRACT NO. 62T78	

SUMMARY OF QUANTITIES				CONSTRUCTION TYPE CODE					SUMMARY OF QUANTITIES				CONSTRUCTION TYPE CODE				
CODE NO	ITEM	UNIT	TOTAL QUANTITIES URBAN	100% STATE ROADWAY 0005					CODE NO	ITEM	UNIT	TOTAL QUANTITIES URBAN	100% STATE ROADWAY 0005				
45100100	CRACK ROUTING (PAVEMENT)	FOOT	44825	44825					• 78009008	MODIFIED URETHANE PAVEMENT MARKING - LINE 8"	FOOT	1005	1005				
45100200	CRACK FILLING	POUND	12810	12810					• 78009012	MODIFIED URETHANE PAVEMENT MARKING - LINE 12"	FOOT	1560	1560				
67100100	MOBILIZATION	L SUM	1	1					• 78009024	MODIFIED URETHANE PAVEMENT MARKING - LINE 24"	FOOT	600	600				
70100310	TRAFFIC CONTROL AND PROTECTION, STANDARD 701421	L SUM	1	1					* 78100100	RAISED REFLECTIVE PAVEMENT MARKER	EACH	25	25				
70100460	TRAFFIC CONTROL AND PROTECTION, STANDARD 701306	L SUM	1	1					78300200	RAISED REFLECTIVE PAVEMENT MARKER REMOVAL	EACH	25	25				
70102620	TRAFFIC CONTROL AND PROTECTION, STANDARD 701501	L SUM	1	1					X6700407	ENGINEER'S FIELD OFFICE, TYPE A (D1)	CAL MO	6	6				
70102632	TRAFFIC CONTROL AND PROTECTION, STANDARD 701602	L SUM	1	1					Z0030850	TEMPORARY INFORMATION SIGNING	SO FT	102	102				
70102635	TRAFFIC CONTROL AND PROTECTION, STANDARD 701701	L SUM	1	1													
• 78009000	MODIFIED URETHANE PAVEMENT MARKING - LETTERS AND SYMBOLS	SO FT	1466	1466													
• 78009004	MODIFIED URETHANE PAVEMENT MARKING - LINE 4"	FOOT	36152	36152													
• 78009006	MODIFIED URETHANE PAVEMENT MARKING - LINE 6"	FOOT	4620	4620													
	• SPECIALTY ITEMS																

FILE NAME =	USER NAME = aaron@raifzu	DESIGNED -	REVISED -
pw\N1dot-pw.bentley.com\PI\DOT\Documents\1\DOT - Offices\District 1\Projects\024222\CADD\Design\024222-str-300		DRAWN -	REVISED -
	PLOT SCALE = 100.0000' / 1in.	CHECKED -	REVISED -
	PLOT DATE = 5/4/2023	DATE -	REVISED -

**STATE OF ILLINOIS
DEPARTMENT OF TRANSPORTATION**

**IL 72 (MAIN ST): RICHMOND RD TO IL 31
SUMMARY OF QUANTITIES**

SCALE: SHEET NO. OF SHEETS STA. TO STA.

F.A.P. RTE.	SECTION	COUNTY	TOTAL SHEETS	SHEET NO.
0341	FAP 0341 22 CJ2	KANE	13	3
ILLINOIS			CONTRACT NO. 62T78	

EXIST. CURVE IL72_EX_19
 PI STA. = 74+00.95
 $\Delta = 13^\circ 42' 45''$ (RT)
 $D = 2^\circ 12' 13''$
 $R = 2,600.00'$
 $T = 312.62'$
 $L = 622.25'$
 $E = 18.73'$
 $e =$
 $T.R. =$
 $S.E. RUN =$
 $P.C. STA. = 70+88.33$
 $P.T. STA. = 77+10.58$

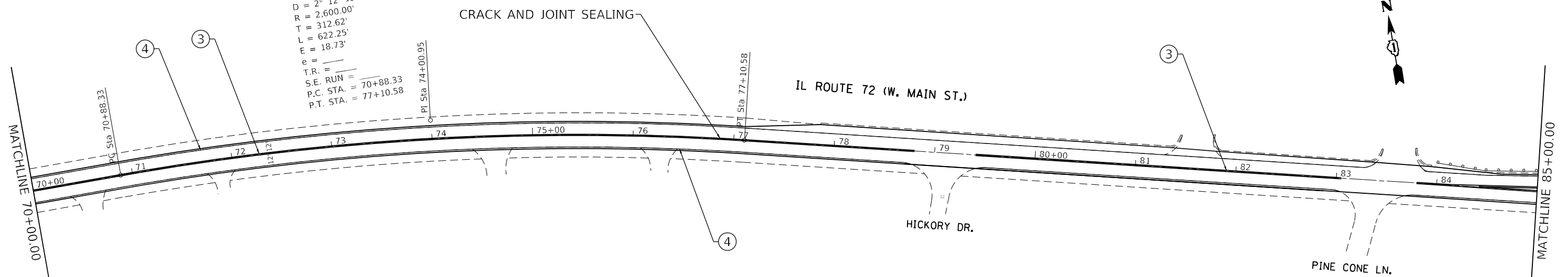

PAVEMENT MARKING LEGEND

- ① PROP. MODIFIED URETHANE PAVEMENT MARKING LINE, 4" SKIP DASH, YELLOW LANE LINE @ 30' SKIP & 10' DASH (TYP.)
- ② PROP. MODIFIED URETHANE PAVEMENT MARKING LINE, 4" SOLID, YELLOW LINE (TYP.)
- ③ PROP. MODIFIED URETHANE PAVEMENT MARKING LINE, 4" DOUBLE SOLID YELLOW LINE, 2 @ 11" C-C (TYP.)
- ④ PROP. MODIFIED URETHANE PAVEMENT MARKING LINE, 4" SOLID LINE, WHITE (TYP.)
- ⑤ PROP. MODIFIED URETHANE PAVEMENT MARKING LINE, 4" SKIP DASH, WHITE LANE LINE @ 30' SKIP & 10' DASH (TYP.)
- ⑥ PROP. MODIFIED URETHANE PAVEMENT MARKING LINE, 6" SKIP DASH, WHITE TURN LANE @ 6' SKIP & 2' DASH (TYP.)
- ⑦ PROP. MODIFIED URETHANE PAVEMENT MARKING LINE, 6" SOLID, WHITE TURN LANE (TYP.)
- ⑧ PROP. MODIFIED URETHANE PAVEMENT MARKING LINE, 6" SOLID, WHITE CROSSWALK LINE, 2 @ 6' C-C (TYP.)
- ⑨ PROP. MODIFIED URETHANE PAVEMENT MARKING LINE, 8" SOLID, WHITE, (SEE DISTRICT DETAIL TC-13 FOR SPACING)
- ⑩ PROP. MODIFIED URETHANE PAVEMENT MARKING LINE, 12" SOLID, YELLOW, DIAGONAL LINE, (SEE DISTRICT DETAIL TC-13 FOR SPACING)
- ⑪ PROP. MODIFIED URETHANE PAVEMENT MARKING LINE, 12" SOLID, WHITE, (SEE DISTRICT DETAIL TC-13 FOR SPACING)
- ⑫ PROP. MODIFIED URETHANE PAVEMENT MARKING LINE, 24" SOLID, WHITE STOP BAR (TYP.)
- ⑬ PROP. MODIFIED URETHANE PAVEMENT MARKING LETTERS & SYMBOLS, SOLID, WHITE (TYP.)

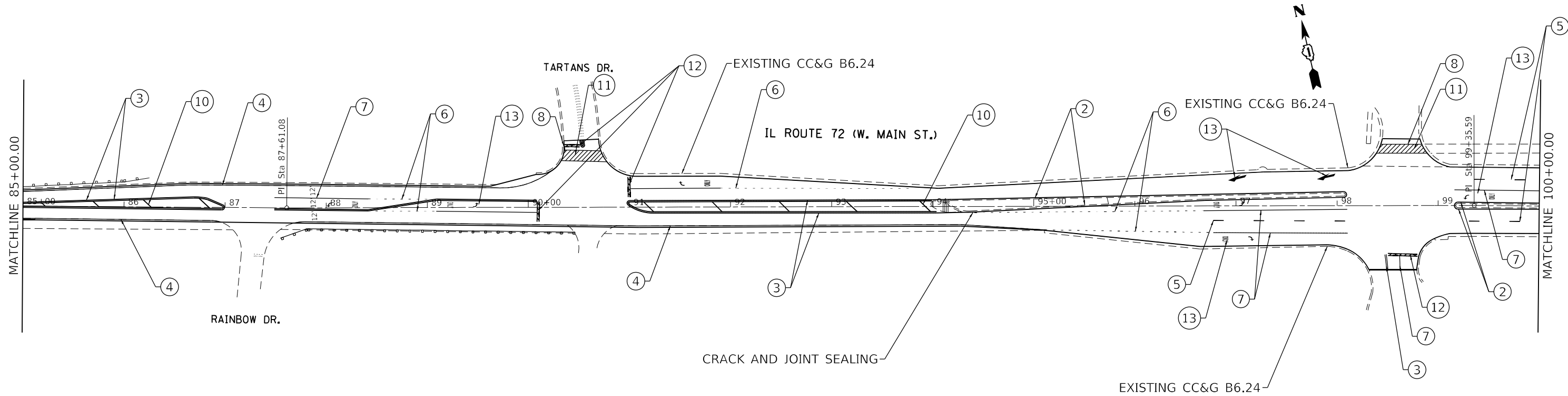

MODEL: Default
 FILE: \\bluemc-pw-bentley.com\FW\DOT\Documents\DOT Office\Drawings\11\Project\1124222\CADD\Drawings\1124222-Sub-A-Plan.dwg
 PLOT DATE = 5/4/2023

USER NAME = aaron.greifzu	DESIGNED -	REVISED -
DRAWN -	REVISOR -	REVISOR -
PLOT SCALE = 100,0000' / in.	CHECKED -	REVISOR -
PLOT DATE = 5/4/2023	DATE -	REVISOR -

STATE OF ILLINOIS
DEPARTMENT OF TRANSPORTATION

ROADWAY PLAN			
IL. ROUTE 72(RICHMOND RD TO IL. ROUTE 31)			
SCALE: 1"=50'	SHEET	OF SHEETS	STA. TO STA.

F.A.P. RTE.	SECTION	COUNTY	TOTAL SHEETS	SHEET NO.
0341	FAP 0341 22 CJ2	KANE	13	6
ILLINOIS				
CONTRACT NO. 62T78				

EXIST. CURVE IL72_EX_26
 PI STA. = 105+89.85
 $\Delta = 5^{\circ} 31' 54''$ (LT)
 $D = 0^{\circ} 36' 43''$
 $R = 9,364.79'$
 $T = 452.41'$
 $L = 904.12'$
 $E = 10.92'$
 $e =$
 $T.R. =$
 $S.E. RUN =$
 $P.C. STA. = 101+37.43$
 $P.T. STA. = 110+41.55$

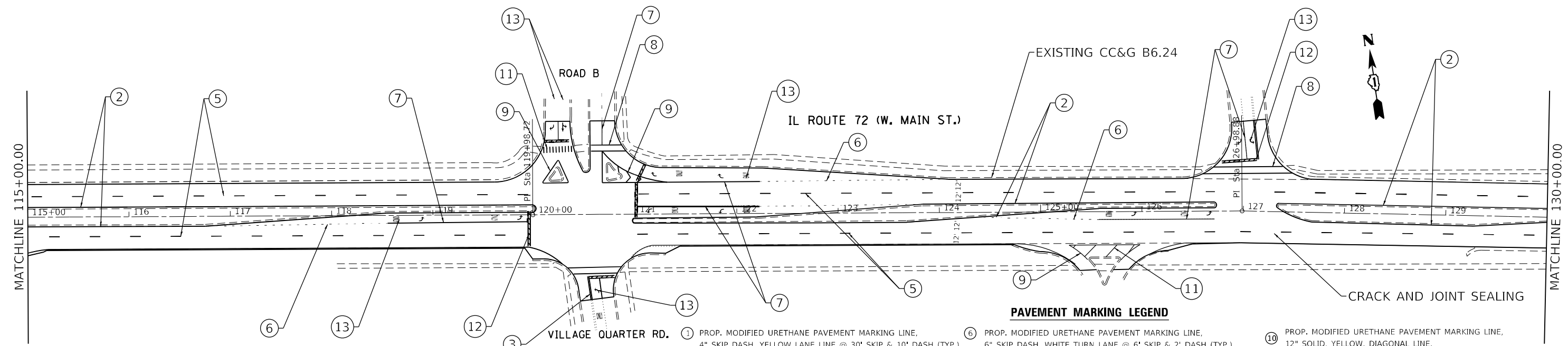
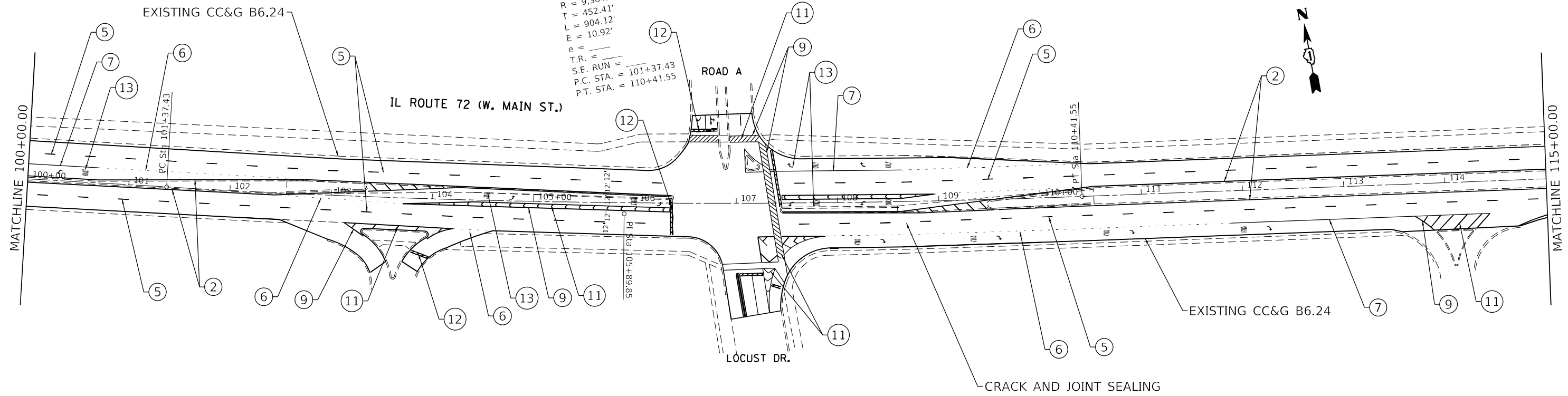

- PAVEMENT MARKING LEGEND**
- ① PROP. MODIFIED URETHANE PAVEMENT MARKING LINE, 4" SKIP DASH, YELLOW LANE LINE @ 30' SKIP & 10' DASH (TYP.)
 - ② PROP. MODIFIED URETHANE PAVEMENT MARKING LINE, 4" SOLID, YELLOW LINE (TYP.)
 - ③ PROP. MODIFIED URETHANE PAVEMENT MARKING LINE, 4" DOUBLE SOLID YELLOW LINE, 2 @ 11" C-C (TYP.)
 - ④ PROP. MODIFIED URETHANE PAVEMENT MARKING LINE, 4" SOLID LINE, WHITE (TYP.)
 - ⑤ PROP. MODIFIED URETHANE PAVEMENT MARKING LINE, 4" SKIP DASH, WHITE LANE LINE @ 30' SKIP & 10' DASH (TYP.)
 - ⑥ PROP. MODIFIED URETHANE PAVEMENT MARKING LINE, 6" SKIP DASH, WHITE TURN LANE @ 6' SKIP & 2' DASH (TYP.)
 - ⑦ PROP. MODIFIED URETHANE PAVEMENT MARKING LINE, 6" SOLID, WHITE TURN LANE (TYP.)
 - ⑧ PROP. MODIFIED URETHANE PAVEMENT MARKING LINE, 6" SOLID, WHITE CROSSWALK LINE, 2 @ 6' C-C (TYP.)
 - ⑨ PROP. MODIFIED URETHANE PAVEMENT MARKING LINE, 8" SOLID, WHITE, (SEE DISTRICT DETAIL TC-13 FOR SPACING)
 - ⑩ PROP. MODIFIED URETHANE PAVEMENT MARKING LINE, 12" SOLID, YELLOW, DIAGONAL LINE, (SEE DISTRICT DETAIL TC-13 FOR SPACING)
 - ⑪ PROP. MODIFIED URETHANE PAVEMENT MARKING LINE, 12" SOLID, WHITE, (SEE DISTRICT DETAIL TC-13 FOR SPACING)
 - ⑫ PROP. MODIFIED URETHANE PAVEMENT MARKING LINE, 24" SOLID, WHITE STOP BAR (TYP.)
 - ⑬ PROP. MODIFIED URETHANE PAVEMENT MARKING LETTERS & SYMBOLS, SOLID, WHITE (TYP.)

MODEL: Default
 FILE: Mainfile.pwd
 PROJECT: D:\Projects\115+00.00\115+00.00\115+00.00\115+00.00.dwg
 USER: aaron.greifzu
 DATE: 5/4/2023

USER NAME = aaron.greifzu	DESIGNED -	REVISED -
PLOT SCALE = 100,0000' / in.	DRAWN -	REVISED -
PLOT DATE = 5/4/2023	CHECKED -	REVISED -
	DATE -	REVISED -

**STATE OF ILLINOIS
 DEPARTMENT OF TRANSPORTATION**

ROADWAY PLAN			
IL. ROUTE 72(RICHMOND RD TO IL. ROUTE 31)			
SCALE: 1"=50'	SHEET	OF SHEETS	STA. TO STA.

F.A.P. RTE.	SECTION	COUNTY	TOTAL SHEETS	SHEET NO.
0341	FAP 0341 22 CJ2	KANE	13	7
ILLINOIS			CONTRACT NO. 62T78	

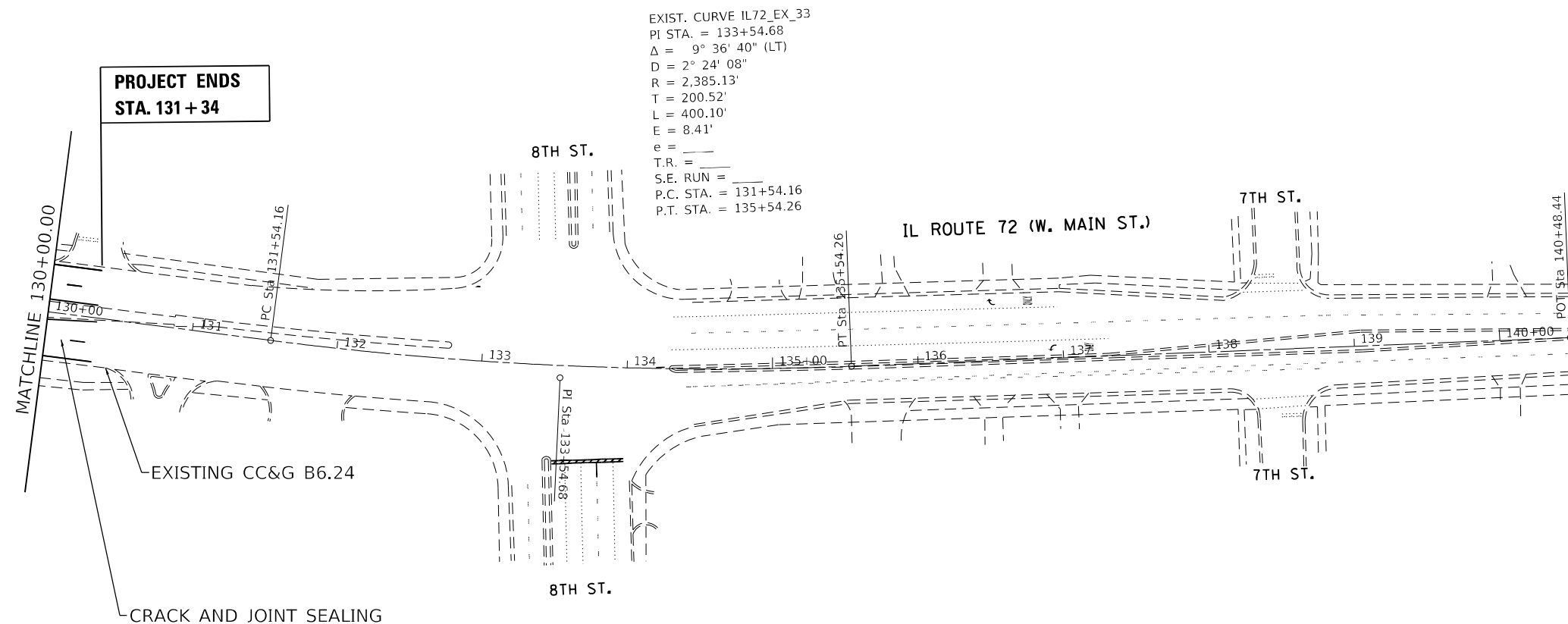

PAVEMENT MARKING LEGEND

- ① PROP. MODIFIED URETHANE PAVEMENT MARKING LINE, 4" SKIP DASH, YELLOW LANE LINE @ 30' SKIP & 10' DASH (TYP.)
- ② PROP. MODIFIED URETHANE PAVEMENT MARKING LINE, 4" SOLID, YELLOW LINE (TYP.)
- ③ PROP. MODIFIED URETHANE PAVEMENT MARKING LINE, 4" DOUBLE SOLID YELLOW LINE, 2 @ 11" C-C (TYP.)
- ④ PROP. MODIFIED URETHANE PAVEMENT MARKING LINE, 4" SOLID LINE, WHITE (TYP.)
- ⑤ PROP. MODIFIED URETHANE PAVEMENT MARKING LINE, 4" SKIP DASH, WHITE LANE LINE @ 30' SKIP & 10' DASH (TYP.)
- ⑥ PROP. MODIFIED URETHANE PAVEMENT MARKING LINE, 6" SKIP DASH, WHITE TURN LANE @ 6' SKIP & 2' DASH (TYP.)
- ⑦ PROP. MODIFIED URETHANE PAVEMENT MARKING LINE, 6" SOLID, WHITE TURN LANE (TYP.)
- ⑧ PROP. MODIFIED URETHANE PAVEMENT MARKING LINE, 6" SOLID, WHITE CROSSWALK LINE, 2 @ 6' C-C (TYP.)
- ⑨ PROP. MODIFIED URETHANE PAVEMENT MARKING LINE, 8" SOLID, WHITE, (SEE DISTRICT DETAIL TC-13 FOR SPACING)
- ⑩ PROP. MODIFIED URETHANE PAVEMENT MARKING LINE, 12" SOLID, YELLOW, DIAGONAL LINE, (SEE DISTRICT DETAIL TC-13 FOR SPACING)
- ⑪ PROP. MODIFIED URETHANE PAVEMENT MARKING LINE, 12" SOLID, WHITE, (SEE DISTRICT DETAIL TC-13 FOR SPACING)
- ⑫ PROP. MODIFIED URETHANE PAVEMENT MARKING LINE, 24" SOLID, WHITE STOP BAR (TYP.)
- ⑬ PROP. MODIFIED URETHANE PAVEMENT MARKING LETTERS & SYMBOLS, SOLID, WHITE (TYP.)

MODEL Default
 FILE NAME: p:\project\paw_bentley.com\pww\DOT\Documents\DOT Office\District 11\Project\1124222\CaddData\Design\1124222-shr-ban.dgn

USER NAME = aaron.greifzu	DESIGNED -	REVISED -
	DRAWN -	REVISED -
PLOT SCALE = 100,0000' / in.	CHECKED -	REVISED -
PLOT DATE = 5/4/2023	DATE -	REVISED -

**STATE OF ILLINOIS
 DEPARTMENT OF TRANSPORTATION**

ROADWAY PLAN			
IL. ROUTE 72(RICHMOND RD TO IL. ROUTE 31)			
SCALE: 1"=50'	SHEET	OF SHEETS	STA. TO STA.

F.A.P. RTE.	SECTION	COUNTY	TOTAL SHEETS	SHEET NO.
0341	FAP 0341 22 CJ2	KANE	13	8
ILLINOIS			CONTRACT NO. 62T78	

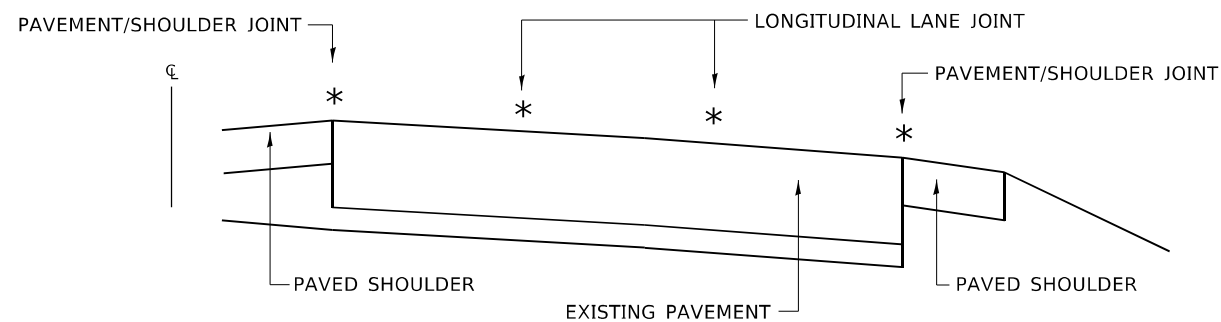

MULTI-LANE DIVIDED PAVEMENT

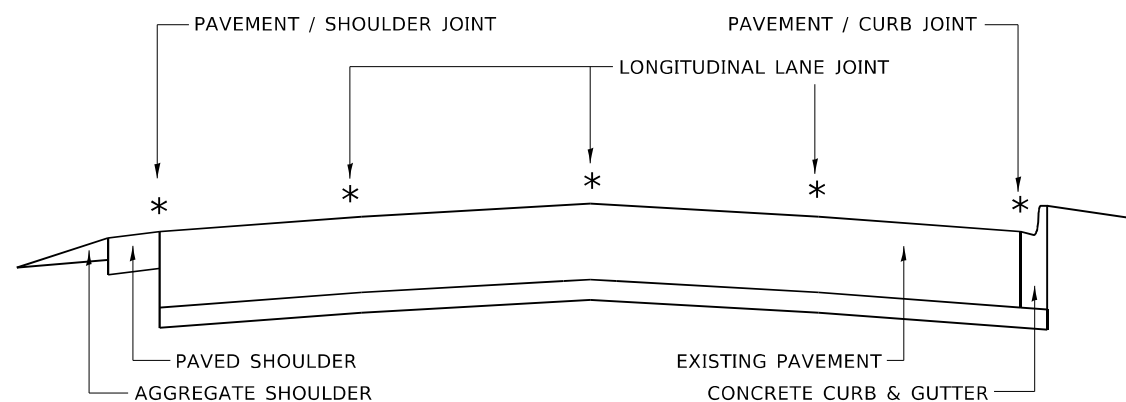

MULTI-LANE UNDIVIDED PAVEMENT

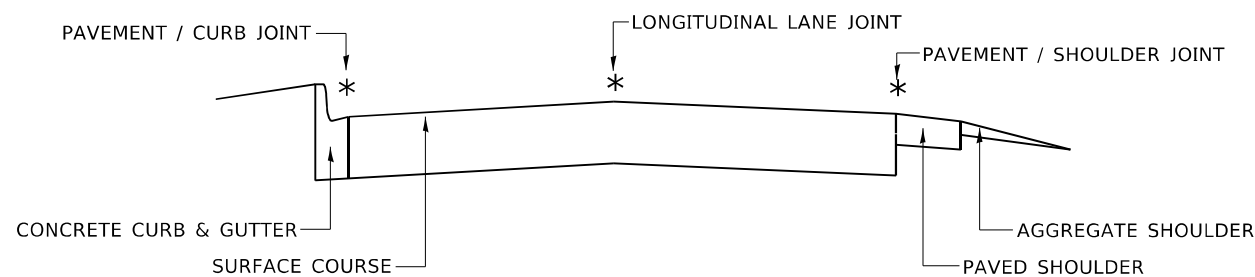

TWO-LANE PAVEMENT

* PROPOSED LONGITUDINAL CRACK ROUTING (PAVEMENT) & CRACK FILLING LOCATIONS

**GENERAL EXISTING TYPICAL SECTIONS
(APPLIES TO HMA AND PCC PAVEMENTS)**

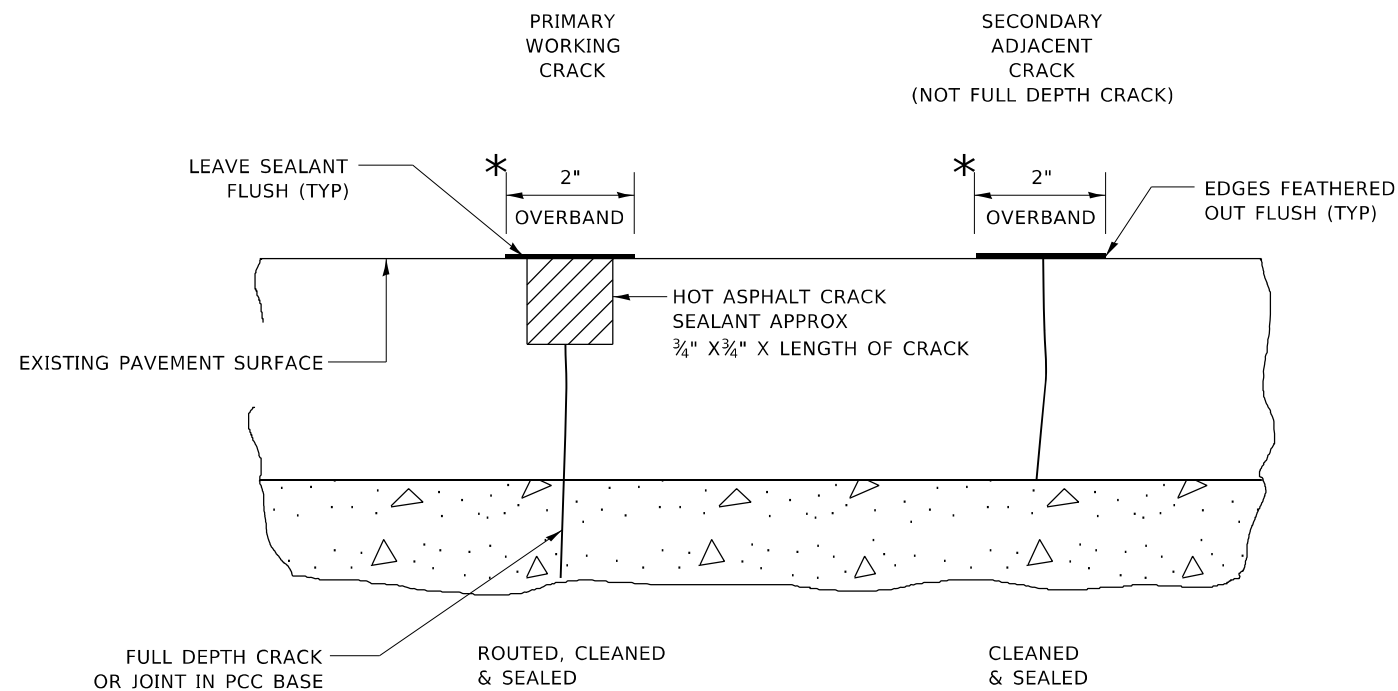

* IN ALL LOCATIONS WHERE THE LONGITUDINAL CRACK CONFLICTS WITH EXISTING PAVEMENT MARKINGS (EITHER EDGE LINE OR LANE LINE) THE CRACK SHALL BE ROUTED & THE RESULTING RESERVOIR FILLED WITH SEALANT. ALL DAMAGES TO EXISTING RAISED REFLECTIVE PAVEMENT MARKERS SHALL BE REPLACED AT THE EXPENSE OF THE CONTRACTOR. ALL EXISTING PAVEMENT MARKINGS WITHIN THE PROJECT LIMITS SHALL BE RESTORED WITH MODIFIED URETHANE PAVEMENT MARKINGS.

LONGITUDINAL JOINT

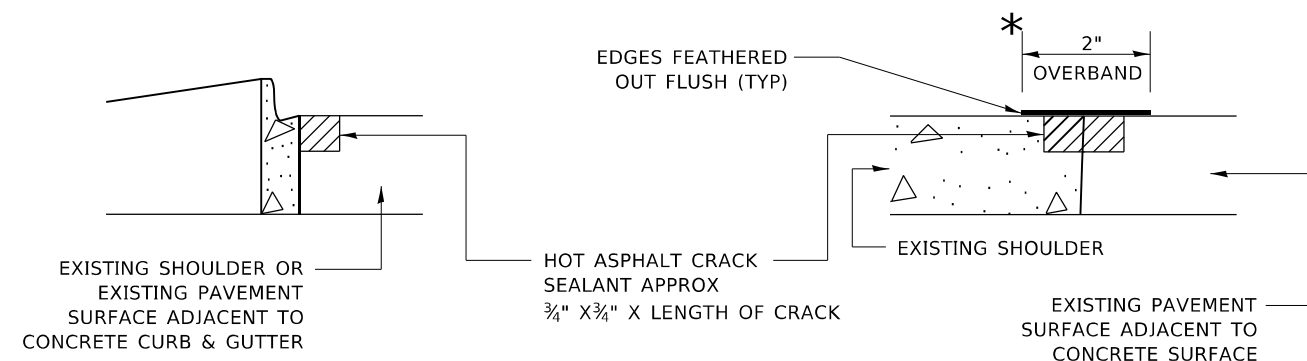

CRACK & JOINT SEALING DETAIL

MODEL: Default
FILE NAME: p:\ultrafast\aw\bea\paw.com\p\w\DOT\Documents\DOT Office\Drawings\11\Project\1124222\CADD\Drawings\Drawings\BtSt.dgn

USER NAME = aaron.greifzu	DESIGNED - F. Aqueel / A. Midy	REVISED -
PLOT SCALE = 100,0000' / in.	CHECKED -	REVISED -
PLOT DATE = 5/4/2023	DATE - 10/08/2020	REVISED -

**STATE OF ILLINOIS
DEPARTMENT OF TRANSPORTATION**

CRACK & JOINT SEALING DETAIL (PD-11)

SCALE: SHEET OF SHEETS STA. TO STA.

F.A.P. RTE.	SECTION	COUNTY	TOTAL SHEETS	SHEET NO.
0341	FAP 0341 22 CJ2	KANE	13	9
CONTRACT NO. 62T78				
ILLINOIS FED. AID PROJECT				

TURN BAY ENTRANCE AT START OF LANE CLOSURE TAPER

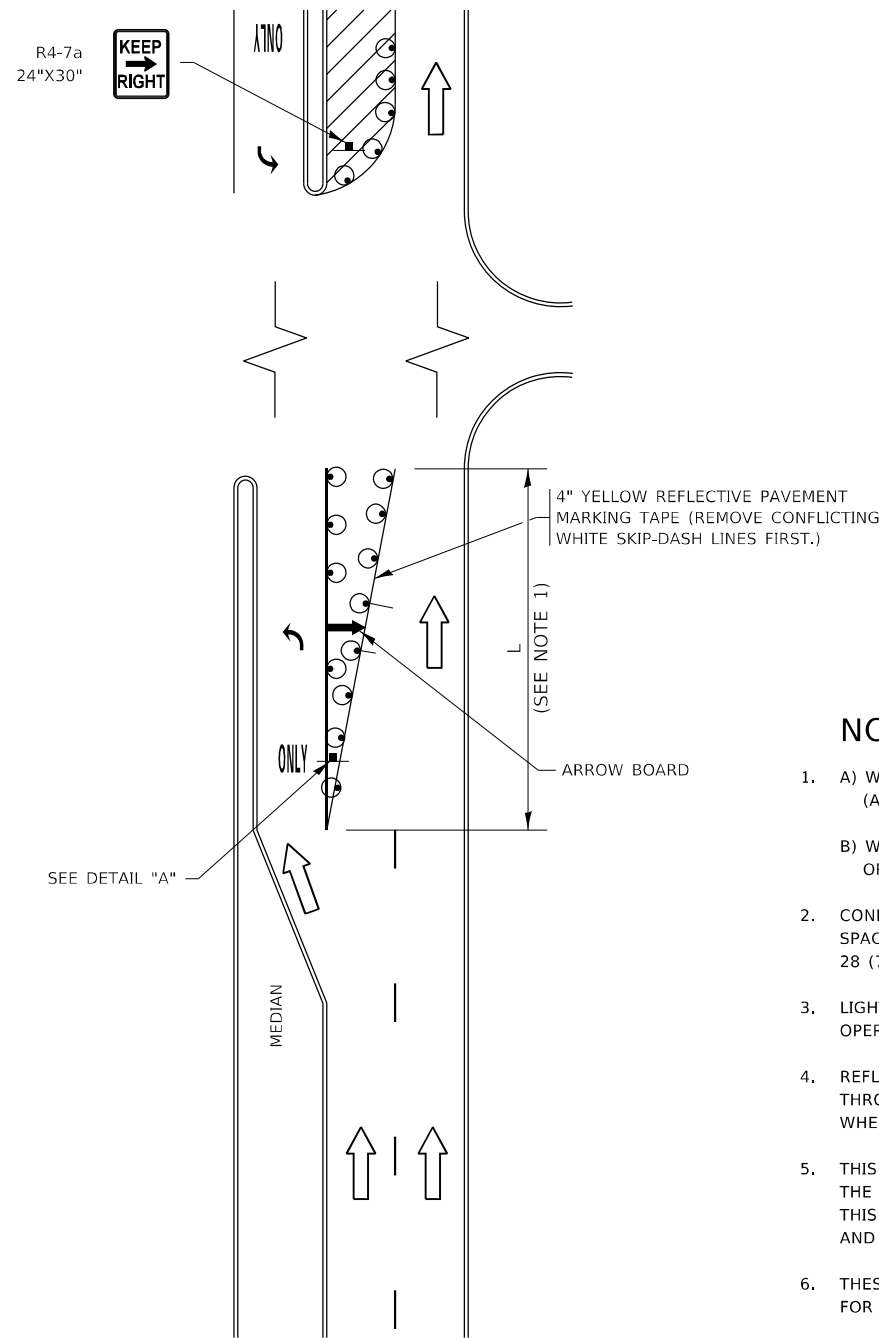

FIGURE 1

TURN BAY ENTRANCE WITHIN A LANE CLOSURE

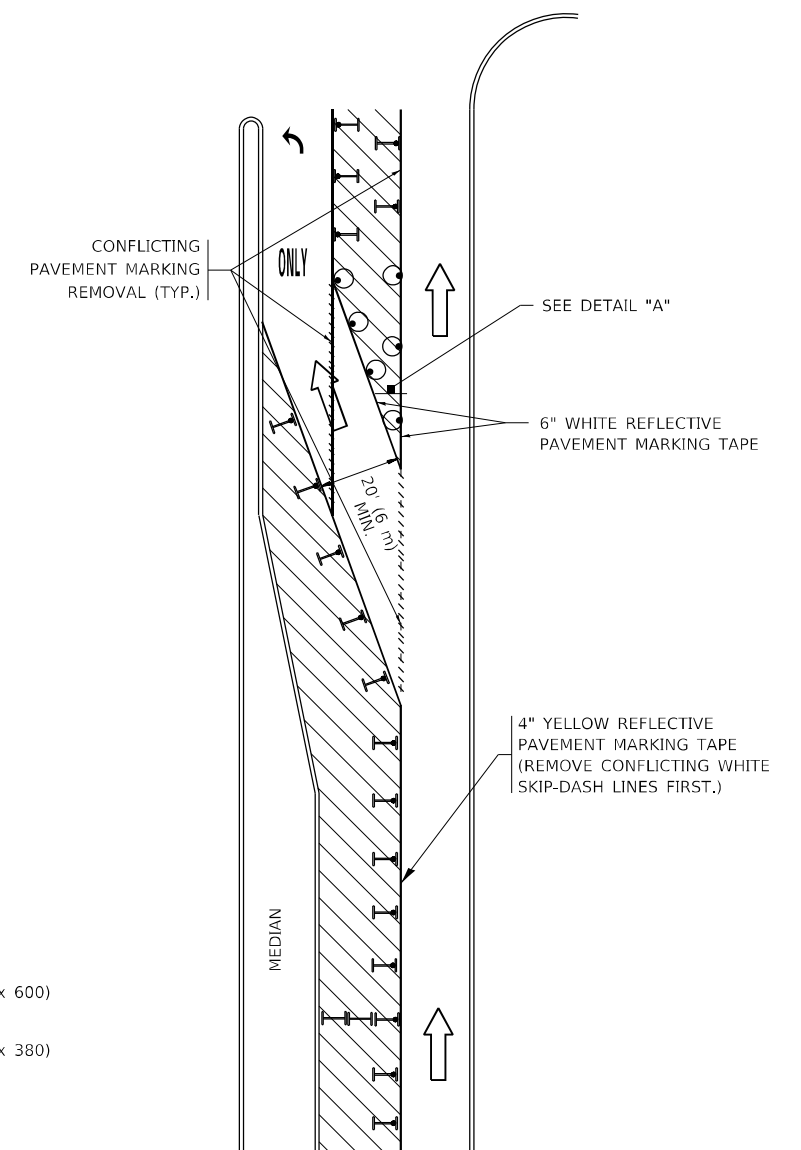
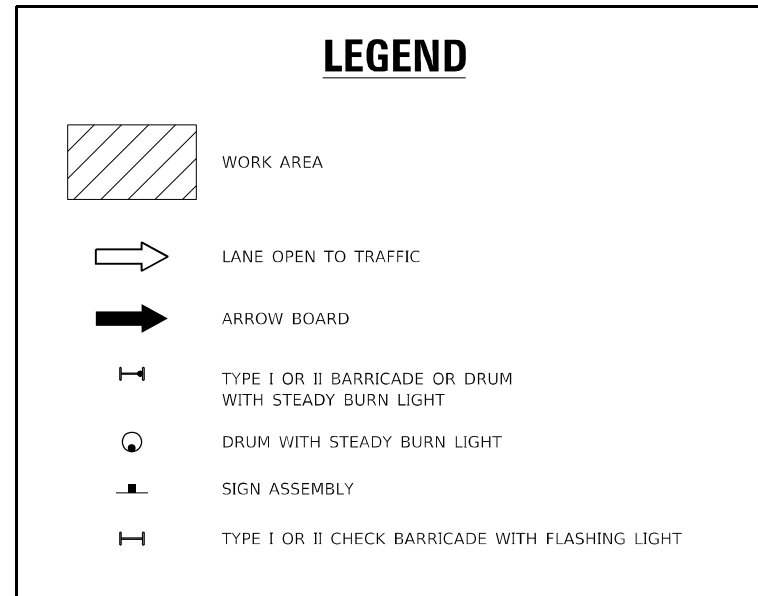
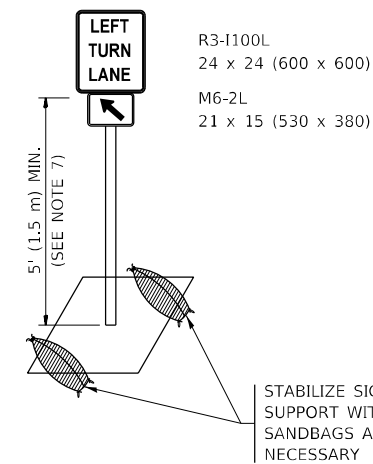

FIGURE 2



NOTES:

1. A) WHEN "L" IS \leq THE STORAGE LENGTH OF THE TURN LANE (AS SHOWN IN FIG. 1), USE FIGURE 1.
B) WHEN "L" IS $>$ THE STORAGE LENGTH OF THE TURN LANE OR THE TURN LANE IS WITHIN THE LANE CLOSURE, USE FIGURE 2.
2. CONES MAY BE SUBSTITUTED FOR BARRICADES OR DRUMS AT HALF THE SPACING DURING DAY OPERATIONS. CONES SHALL BE A MINIMUM OF 28 (710) IN HEIGHT.
3. LIGHTS WILL NOT BE REQUIRED ON BARRICADES OR DRUMS FOR DAY OPERATIONS. ALL LIGHTS SHALL BE MONODIRECTIONAL.
4. REFLECTIVE TEMPORARY PAVEMENT MARKINGS SHALL BE PLACED THROUGHOUT THE BARRICADED AREAS OF EACH TURN BAY AS SHOWN WHERE THE CLOSURE TIME IS GREATER THAN FOURTEEN (14) DAYS.
5. THIS APPLICATION ALSO APPLIES WHEN WORK IS BEING PERFORMED IN THE RIGHT LANE(S) AND THE RIGHT TURN BAY IS TO REMAIN OPEN. UNDER THIS CONDITION, "RIGHT TURN LANE" R3-1100R 24 x 24 (600 x 600) AND M6-2R 21 x 15 (530 x 380) SHALL BE USED.
6. THESE CONTROLS SHALL SUPPLEMENT MAINLINE TRAFFIC CONTROL FOR LANE CLOSURES.
7. THE SIGNS SHALL BE MOUNTED ABOVE THE BARRICADES/DRUMS ON SEPARATE SIGN SUPPORTS THAT MEET NCHRP 350 OR MASH REQUIREMENTS.
8. TRAFFIC CONTROL AND PROTECTION AT TURN BAYS (TO REMAIN OPEN TO TRAFFIC) SHALL BE INCLUDED IN THE COST OF SPECIFIED TRAFFIC CONTROL STANDARDS OR ITEMS.



DETAIL A

All dimensions are in inches (millimeters) unless otherwise shown.

MODEL: Default
FILE NAME: p:\project\paw_bentley.com\paw\dot\Documents\DOT Office\Dir\rdt_1\project\124222\CADD\data\Design\BartSt.dgn

USER NAME = aaron.greifzu	DESIGNED - T. RAMMACHER 09-08-94	REVISED - R. BORO 09-14-09
	DRAWN - A. HOUSEH 11-07-95	REVISED - A. SCHUETZE 07-01-13
PLOT SCALE = 100,0000' / in.	CHECKED - A. HOUSEH 10-12-96	REVISED - A. SCHUETZE 09-15-16
PLOT DATE = 5/4/2023	DATE - T. RAMMACHER 01-06-00	REVISED -

STATE OF ILLINOIS
DEPARTMENT OF TRANSPORTATION

TRAFFIC CONTROL AND PROTECTION AT TURN BAYS
(TO REMAIN OPEN TO TRAFFIC)

SCALE: NONE SHEET 1 OF 1 SHEETS STA. TO STA.

F.A.P. RTE.	SECTION	COUNTY	TOTAL SHEETS	SHEET NO.
0341	FAP 0341 22 CJ2	KANE	13	12
TC-14		CONTRACT NO. 62T78		
ILLINOIS FED. AID PROJECT				

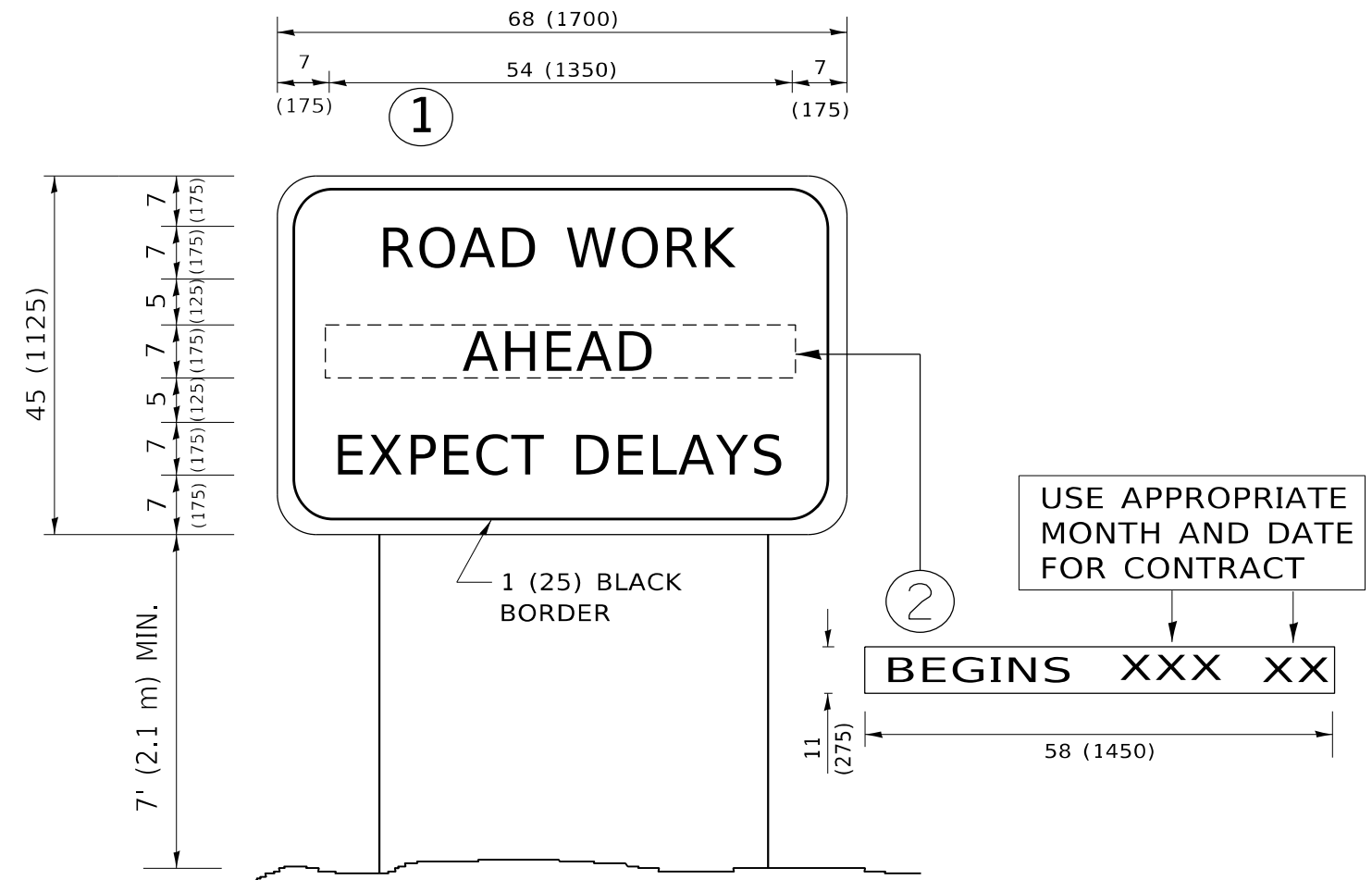

NOTES:

1. USE BLACK LETTERING ON ORANGE BACKGROUND.
2. ERECT SIGNS IN ADVANCE OF THE LOCATION FOR THE "ROAD CONSTRUCTION AHEAD" SIGN AT LOCATIONS AS DIRECTED BY THE ENGINEER.
3. ERECT SIGN ① WITH INSTALLED PANEL ② ONE WEEK PRIOR TO THE START OF CONSTRUCTION.
4. REMOVE PANEL ② SOON AFTER THE START OF CONSTRUCTION.
5. SEE SPECIAL PROVISION FOR "TEMPORARY INFORMATION SIGNING" FOR ADDITIONAL INFORMATION.
6. ONE SIGN ASSEMBLY EQUALS 25.70 SQ. FT. (2.3 SQ. M.)
7. SHALL BE PAID FOR AS TEMPORARY INFORMATION SIGNING.

ALL DIMENSIONS ARE IN INCHES (MILLIMETERS) UNLESS OTHERWISE SHOWN.

MODEL: Default
 FILE: \\na11e-pw\uldract-pw-beadefy.com\P\W\DOT\Documents\1\DOT\Office\Dir\rdet_1\Project\1\24222\CADD\data\Design\BdFStu.dgn

USER NAME = aaron.greifzu	DESIGNED -	REVISED - R. MIRS 09-15-97
	DRAWN -	REVISED - R. MIRS 12-11-97
PLOT SCALE = 100,0000 ' / in.	CHECKED -	REVISED - T. RAMMACHER 02-02-99
PLOT DATE = 5/4/2023	DATE -	REVISED - C. JUCIUS 01-31-07

**STATE OF ILLINOIS
DEPARTMENT OF TRANSPORTATION**

**ARTERIAL ROAD
INFORMATION SIGN**

SCALE: NONE SHEET 1 OF 1 SHEETS STA. TO STA.

F.A.P. RTE.	SECTION	COUNTY	TOTAL SHEETS	SHEET NO.
0341	FAP 0341 22 CJ2	KANE	13	13
TC-22			CONTRACT NO. 62T78	
ILLINOIS FED. AID PROJECT				