

F.A.P. RTE.	SECTION	COUNTY	TOTAL SHEETS	SHEET NO.
575	(B&I4) R-3	WILL	390	34
STA.		TO STA.		
FED. ROAD DIST. NO.		ILLINOIS FED. AID PROJECT		
CONTRACT NO. 60961				

BENCHMARKS

- BM4 R.R. SPIKE IN POWER POLE 80' RIGHT (EXISTING) STATION 202+20, 1815 PLAINFIELD ROAD "WRECKS" AUTO REBUILDER ELEV=588.71'
- BM17 CHISELED SQUARE CUT IN CENTER OF EAST HEADWALL IN S.E. CORNER US ROUTE 30 AND I-55 FRONTAGE ROAD (WEST OF I-55 AT TRUCK STOP ENTRANCE) ELEV=601.639'
- BM113 CHISELED SQUARE CUT IN N.W. WING WALL US ROUTE 30 BRIDGE OVER LILY CACHE CREEK ELEV=597.39'
- CP2 CHISELED "X", STA 818+84.12, 58.64' LEFT ELEV=605.390'
- CP4 PK NAIL, STA 808+55.66, 12.65' LEFT ELEV=609.900'
- CP5 PK NAIL, STA 802+81.96, 22.86' RIGHT ELEV=613.325'
- CP6 PK NAIL, STA 793+29.18, 17.21' LEFT ELEV=620.545'
- CP7 PK NAIL, STA 788+59.30, 21.86' RIGHT ELEV=620.855'
- CP8 PK NAIL, STA 779+65.94, 24.33' LEFT ELEV=627.905'
- CP9 CHISELED "X", STA 769+42.80, 33.74' RIGHT ELEV=627.975'
- CP10 PK NAIL, STA 760+92.93, 27.32' LEFT ELEV=627.615'
- CP11 PK NAIL, STA 754+42.02, 24.70' RIGHT ELEV=624.935'
- CP12 PK NAIL, STA 746+31.89, 24.16' LEFT ELEV=621.100'
- CP13 PK NAIL, STA 738+99.04, 22.05' RIGHT ELEV=628.325'
- CP14 PK NAIL, STA 734+77.39, 36.88' LEFT ELEV=631.745'
- CP15 PK NAIL, STA 725+05.18, 33.33' RIGHT ELEV=593.415'
- CP20 CHISELED "X", STA 824+77.89, 20.16' RIGHT ELEV=606.785'
- CP21 PK NAIL, STA 832+05.36, 59.10' LEFT ELEV=613.510'
- CP22 PK NAIL, STA 839+00.08, 62.72' LEFT ELEV=610.400'
- CP23 PK NAIL, STA 845+89.14, 58.01' LEFT ELEV=609.600'

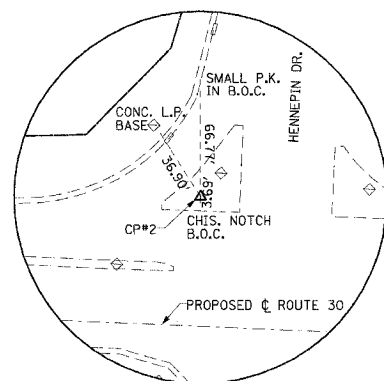

C.P. #2

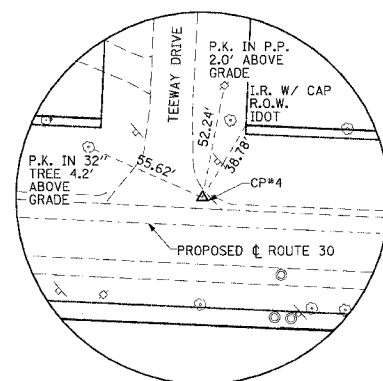

C.P. #4

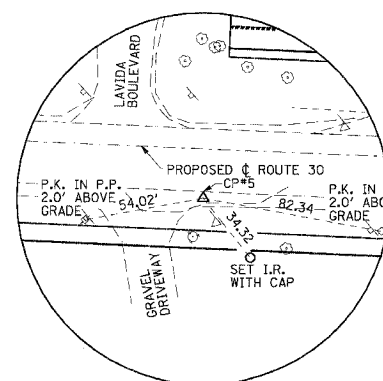

C.P. #5

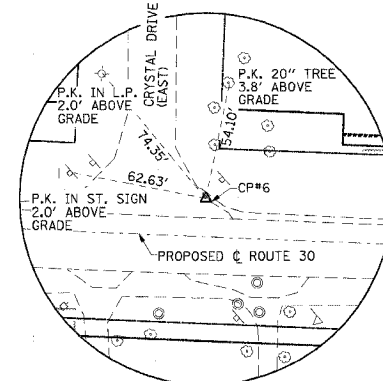

C.P. #6

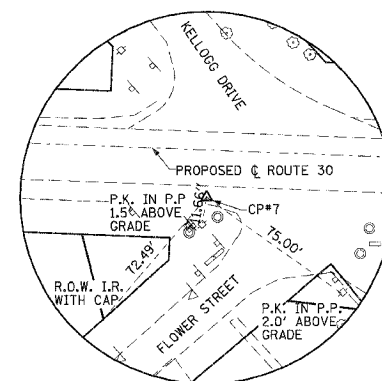

C.P. #7

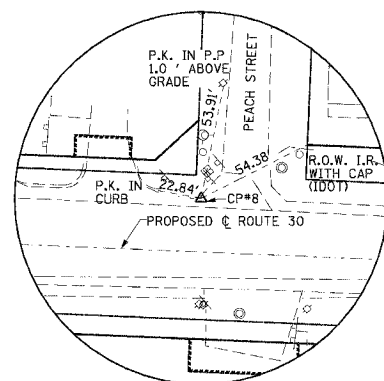

C.P. #8

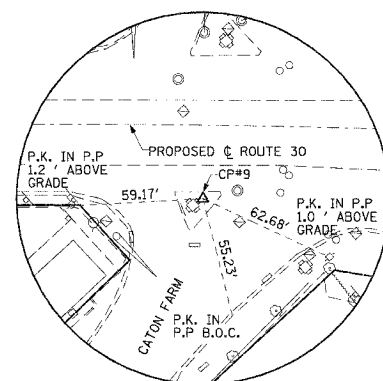

C.P. #9

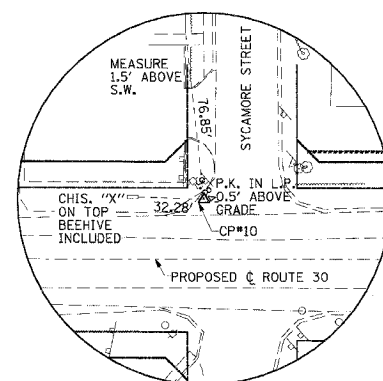

C.P. #10

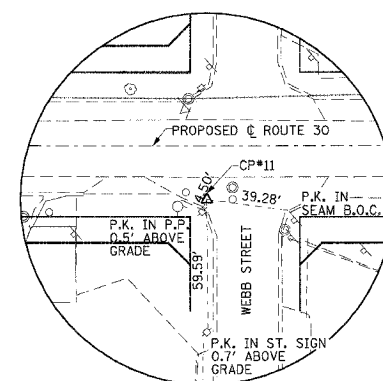

C.P. #11

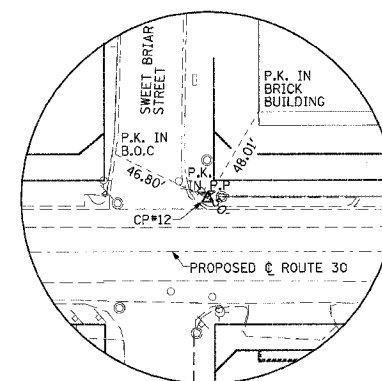

C.P. #12

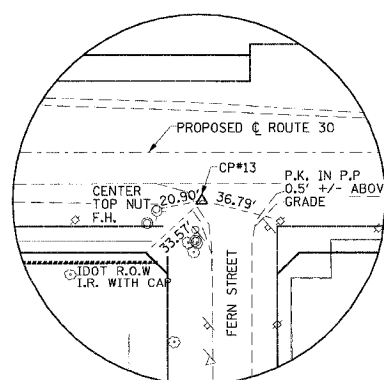

C.P. #13

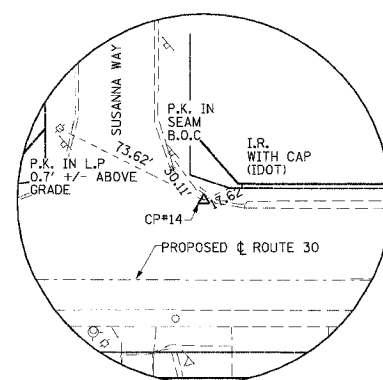

C.P. #14

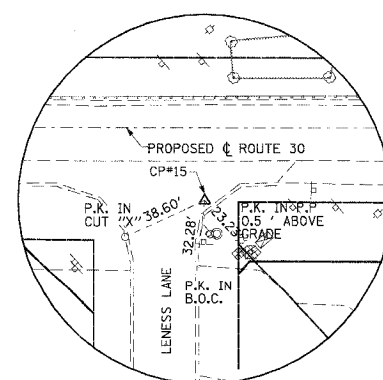

C.P. #15

I:\dot\006602\draw\bid\sheet\atb02.dgn



REVISIONS	
NAME	DATE

ILLINOIS DEPARTMENT OF TRANSPORTATION
ALIGNMENT, TIES & BENCHMARKS
US ROUTE 30
 SHEET 2 OF 2

SCALE: VERT. NONE
 HORIZ. NONE
 DATE: 3/1/05

DRAWN BY: SNH
 CHECKED BY: KDF