

NOTES:
 1. FOR CURVE DATA AND BENCHMARKS SEE ALIGNMENT, TIES & BENCHMARKS SHEETS.
 2. RIGHT OF WAY FROM STA. 816+66.78 TO 846+13.54 WAS RECREATED GRAPHICALLY & SHOULD BE VERIFIED.

MUNICIPALITY: JOLIET

F.A.P. RTE.	SECTION	COUNTY	TOTAL SHEETS	SHEET NO.
575	(B&I4) R-3	WILL.	390	93
STA. 828+00 TO STA. 834+00				
FED. ROAD DIST. NO.		ILLINOIS FED. AID PROJECT		
CONTRACT NO. 60961				

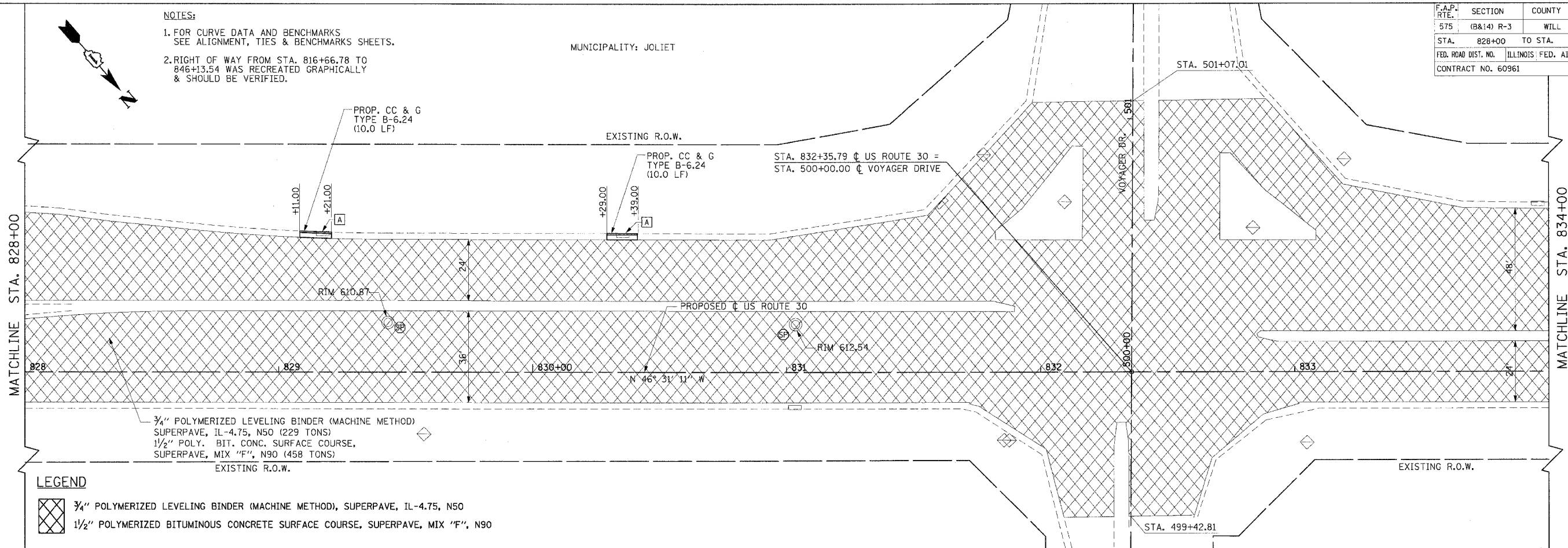

LEGEND

- 3/4\"/>
- 1/2\"/>

PLAN	DESIGNED	BY	DATE
NOTE BOOK	ALIGNED		
	CHECKED		
	DATE		

PROFILE	DESIGNED	BY	DATE
NOTE BOOK	CHECKED		
	DATE		

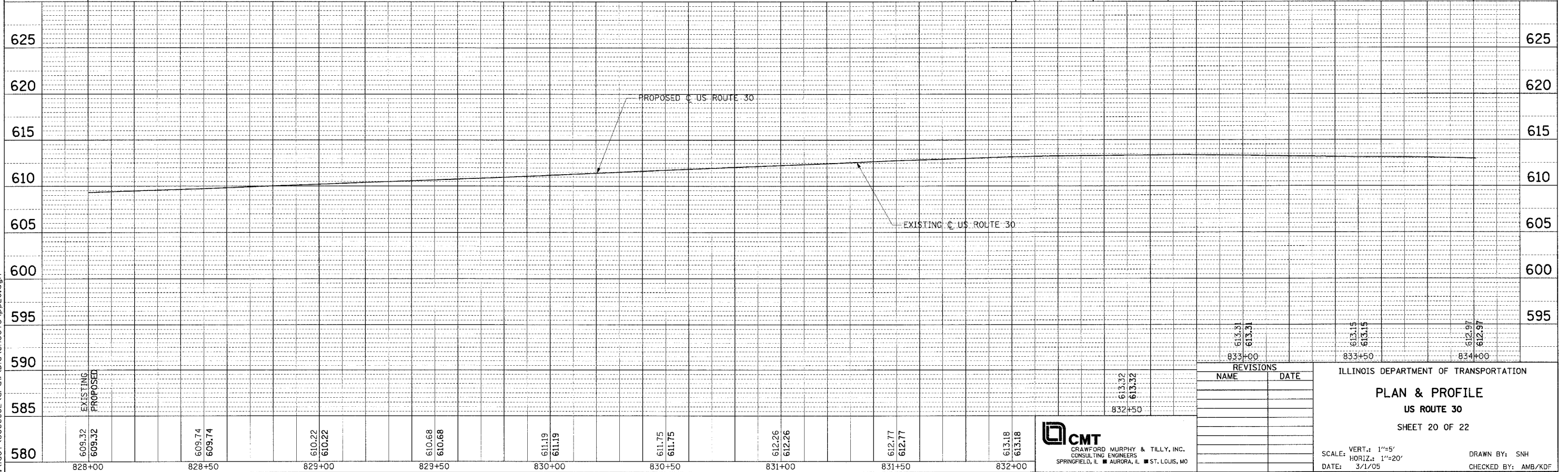

REVISIONS	
NAME	DATE

ILLINOIS DEPARTMENT OF TRANSPORTATION

PLAN & PROFILE

US ROUTE 30

SHEET 20 OF 22

SCALE: VERT.: 1"=5'
 HORIZ.: 1"=20'

DATE: 3/1/05

DRAWN BY: SNH
 CHECKED BY: AMB/KDF

CMT
 CRAWFORD MURPHY & TILLY, INC.
 CONSULTING ENGINEERS
 SPRINGFIELD, IL ■ AURORA, IL ■ ST. LOUIS, MO

I:\dot\0006602\araw\bid\sheet\p20.dgn