

MUNICIPALITY: CREST HILL

F.A. RTE.	SECTION	COUNTY	TOTAL SHEETS	SHEET NO.
575	(B&I4) R-3	WILL	365	105
STA. 768+00 TO STA. 774+00				
FED. ROAD DIST. NO.		ILLINOIS FED. AID PROJECT		
		CONTRACT NO. 60961		

PLAN	BY	DATE
REVISIONS	NOTED	DATE
NOTE: ALL DIMENSIONS SHOWN ARE UNLESS OTHERWISE NOTED.		
DRAWN BY: [Name]		
CHECKED BY: [Name]		
DATE: [Date]		

PROFILE	BY	DATE
REVISIONS	NOTED	DATE
NOTE: ALL DIMENSIONS SHOWN ARE UNLESS OTHERWISE NOTED.		
DRAWN BY: [Name]		
CHECKED BY: [Name]		
DATE: [Date]		

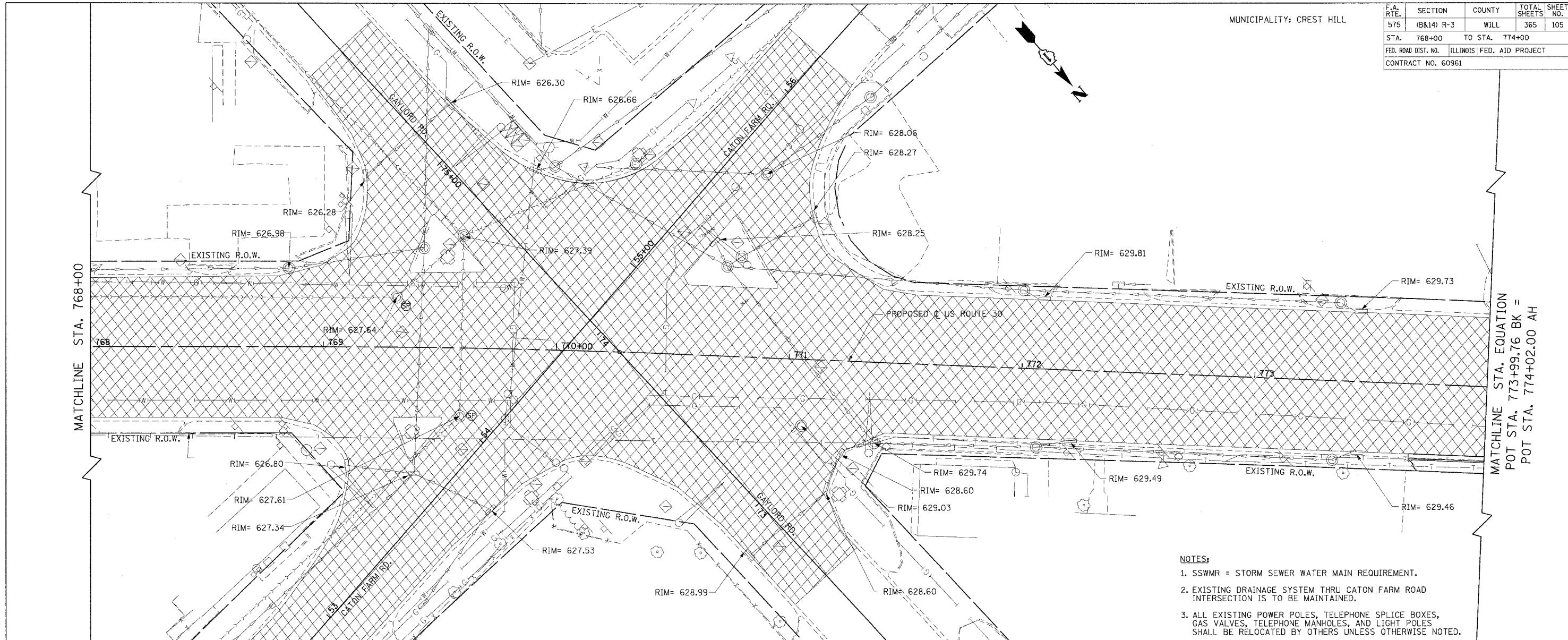

- NOTES:
1. SSWM = STORM SEWER WATER MAIN REQUIREMENT.
 2. EXISTING DRAINAGE SYSTEM THRU CATON FARM ROAD INTERSECTION IS TO BE MAINTAINED.
 3. ALL EXISTING POWER POLES, TELEPHONE SPLICE BOXES, GAS VALVES, TELEPHONE MANHOLES, AND LIGHT POLES SHALL BE RELOCATED BY OTHERS UNLESS OTHERWISE NOTED.

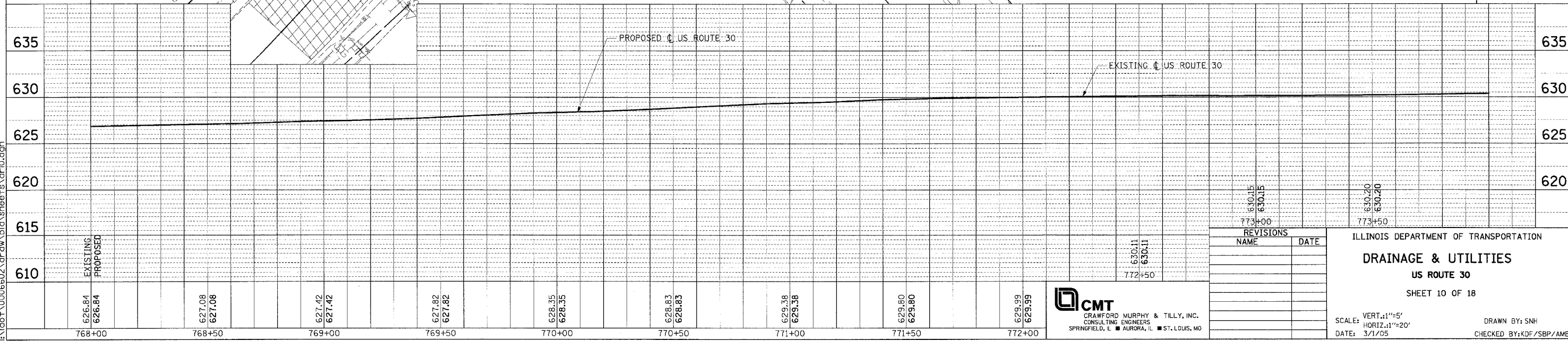

REVISIONS	
NAME	DATE
630.15	
630.15	
630.20	
630.20	
773+00	
773+50	

ILLINOIS DEPARTMENT OF TRANSPORTATION
DRAINAGE & UTILITIES
US ROUTE 30
 SHEET 10 OF 18

SCALE: VERT. 1"=5'
 HORIZ. 1"=20'
 DATE: 3/1/05

DRAWN BY: SNH
 CHECKED BY: KDF/SBP/AMB

CMT
 CRAWFORD MURPHY & TILLY, INC.
 CONSULTING ENGINEERS
 SPRINGFIELD, IL ■ AURORA, IL ■ ST. LOUIS, MO

I:\dot\0006602\draw\bid\sheet\dr10.dgn