

| | | | | |
|---------------------|-----------|----------------|--------------|------------------|
| F.A. R.T.E. | SECTION | COUNTY | TOTAL SHEETS | SHEET NO. |
| 575 | (B&I) R-3 | WILL | 390 | 174 |
| STA. 760+00 | | TO STA. 805+00 | | |
| FED. ROAD DIST. NO. | | ILLINOIS | | FED. AID PROJECT |
| CONTRACT NO. 60961 | | | | |

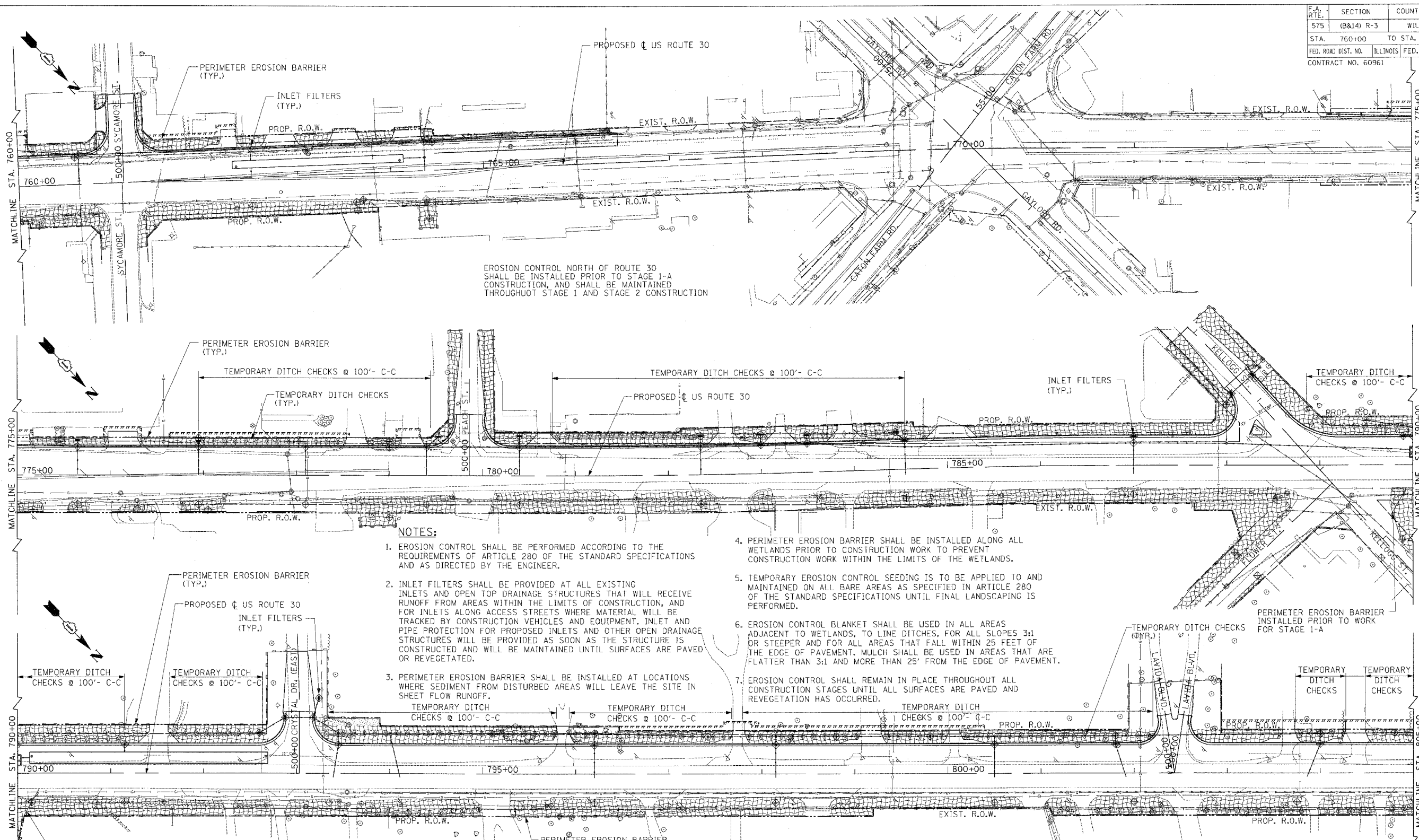

EROSION CONTROL NORTH OF ROUTE 30 SHALL BE INSTALLED PRIOR TO STAGE 1-A CONSTRUCTION, AND SHALL BE MAINTAINED THROUGHOUT STAGE 1 AND STAGE 2 CONSTRUCTION

NOTES:

1. EROSION CONTROL SHALL BE PERFORMED ACCORDING TO THE REQUIREMENTS OF ARTICLE 280 OF THE STANDARD SPECIFICATIONS AND AS DIRECTED BY THE ENGINEER.
2. INLET FILTERS SHALL BE PROVIDED AT ALL EXISTING INLETS AND OPEN TOP DRAINAGE STRUCTURES THAT WILL RECEIVE RUNOFF FROM AREAS WITHIN THE LIMITS OF CONSTRUCTION, AND FOR INLETS ALONG ACCESS STREETS WHERE MATERIAL WILL BE TRACKED BY CONSTRUCTION VEHICLES AND EQUIPMENT. INLET AND PIPE PROTECTION FOR PROPOSED INLETS AND OTHER OPEN DRAINAGE STRUCTURES WILL BE PROVIDED AS SOON AS THE STRUCTURE IS CONSTRUCTED AND WILL BE MAINTAINED UNTIL SURFACES ARE PAVED OR REVEGETATED.
3. PERIMETER EROSION BARRIER SHALL BE INSTALLED AT LOCATIONS WHERE SEDIMENT FROM DISTURBED AREAS WILL LEAVE THE SITE IN SHEET FLOW RUNOFF.
TEMPORARY DITCH CHECKS @ 100'- C-C
4. PERIMETER EROSION BARRIER SHALL BE INSTALLED ALONG ALL WETLANDS PRIOR TO CONSTRUCTION WORK TO PREVENT CONSTRUCTION WORK WITHIN THE LIMITS OF THE WETLANDS.
5. TEMPORARY EROSION CONTROL SEEDING IS TO BE APPLIED TO AND MAINTAINED ON ALL BARE AREAS AS SPECIFIED IN ARTICLE 280 OF THE STANDARD SPECIFICATIONS UNTIL FINAL LANDSCAPING IS PERFORMED.
6. EROSION CONTROL BLANKET SHALL BE USED IN ALL AREAS ADJACENT TO WETLANDS, TO LINE DITCHES, FOR ALL SLOPES 3:1 OR STEEPER AND FOR ALL AREAS THAT FALL WITHIN 25 FEET OF THE EDGE OF PAVEMENT. MULCH SHALL BE USED IN AREAS THAT ARE FLATTER THAN 3:1 AND MORE THAN 25' FROM THE EDGE OF PAVEMENT.
7. EROSION CONTROL SHALL REMAIN IN PLACE THROUGHOUT ALL CONSTRUCTION STAGES UNTIL ALL SURFACES ARE PAVED AND REVEGETATION HAS OCCURRED.

NOTE:

EROSION CONTROL PLANS ARE BASED ON THE WORK BEING PERFORMED IN TWO PRE CONSTRUCTION STAGES AND TWO CONSTRUCTION STAGES.

EROSION CONTROL METHODS SHALL BE INSTALLED AS SHOWN ON THE PLANS OR AS DIRECTED BY THE ENGINEER.

LEGEND

- EROSION CONTROL SEEDING AND MULCH
- EROSION CONTROL BLANKET AND EROSION CONTROL SEEDING
- STONE RIP-RAP, CLASS A4
- FIBERMAT WITH SEEDING
- TEMPORARY DITCH CHECK
- PERIMETER EROSION BARRIER
- SILTY FILTER FENCE
- INLET FILTERS

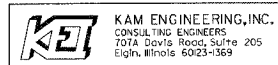
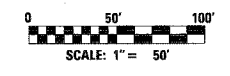

| REVISIONS | |
|-----------|------|
| NAME | DATE |
| | |
| | |
| | |
| | |
| | |

ILLINOIS DEPARTMENT OF TRANSPORTATION

EROSION CONTROL PLAN FOR STAGE 1 CONSTRUCTION
US ROUTE 30
SHEET 2 OF 6

SCALE: 1" = 50'
DATE: MARCH 2005
DRAWN BY: MD
CHECKED BY: AC/MSA

FILES
DATES