

F.A. RTE.	SECTION	COUNTY	TOTAL SHEETS	SHEET NO.
575	(B+14) R-3	WILL	390	285
STA. 743+75.13		TO STA. 744+00.00		
FED. ROAD DIST. NO. ILLINOIS FED. AID PROJECT				
CONTRACT NO. 60961				

DATE	
BY	
DESIGNED	
CHECKED	
APPROVED	
REVISIONS	
NO.	

DATE	
BY	
DESIGNED	
CHECKED	
APPROVED	
REVISIONS	
NO.	

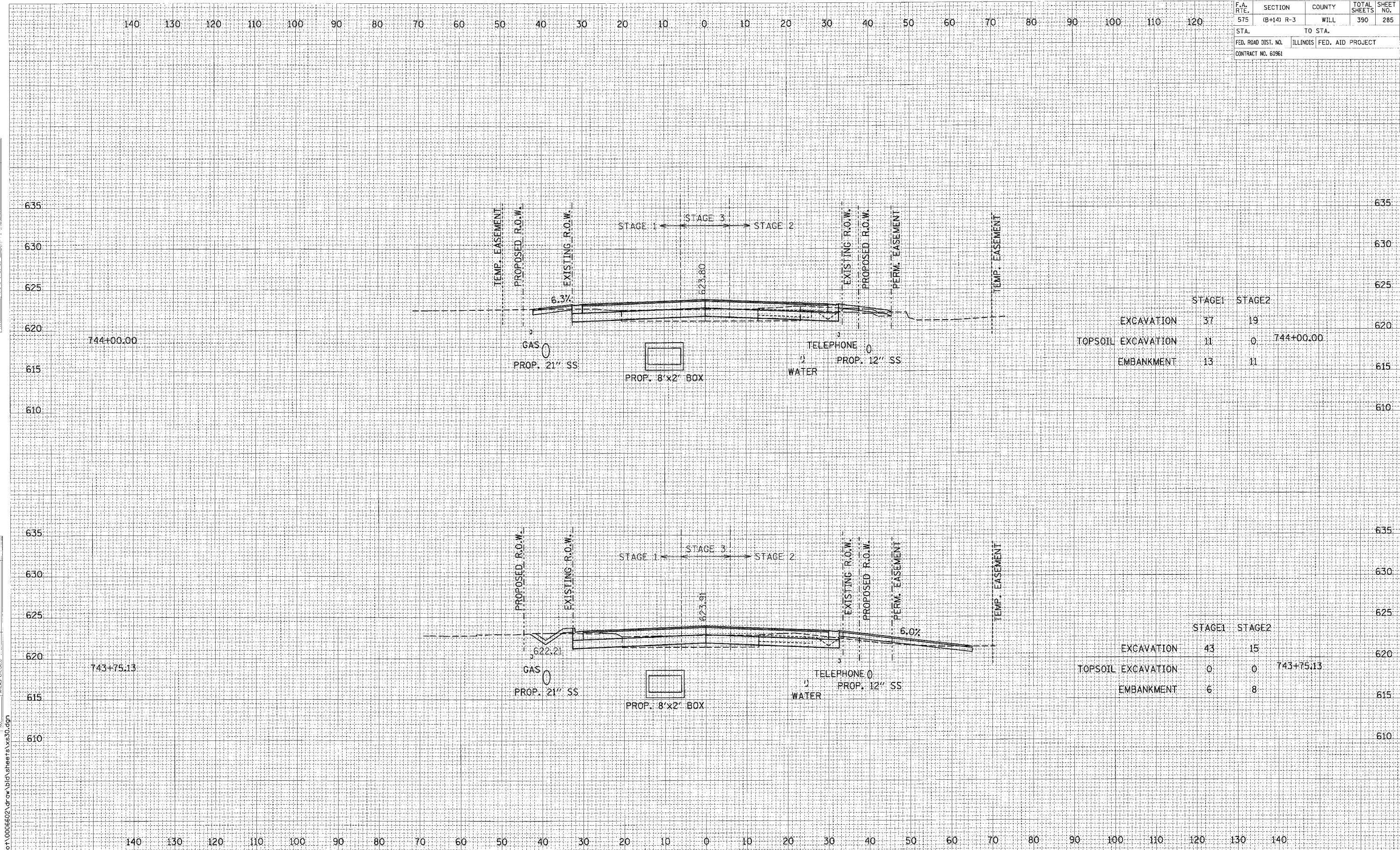

	STAGE1	STAGE2	
EXCAVATION	37	19	620
TOPSOIL EXCAVATION	11	0	615
EMBANKMENT	13	11	610

	STAGE1	STAGE2	
EXCAVATION	43	15	620
TOPSOIL EXCAVATION	0	0	615
EMBANKMENT	6	8	610

CROSS SECTIONS: U.S. ROUTE 30 - STA. 743+75.13 TO STA. 744+00.00

SCALE: 1" = 10' HORIZ.
1" = 5' VERT.