

F.A. RTE.	SECTION	COUNTY	TOTAL SHEETS	SHEET NO.
575	(B+14) R-3	WILL	390	292
STA.		TO STA.		
FED. ROAD DIST. NO.		ILLINOIS FED. AID PROJECT		
CONTRACT NO. 60961				

DATE	BY
FINAL SURVEY	
NOTE BOOK	
NO.	

DATE	BY
ORIGINAL SURVEY	
NOTE BOOK	
NO.	

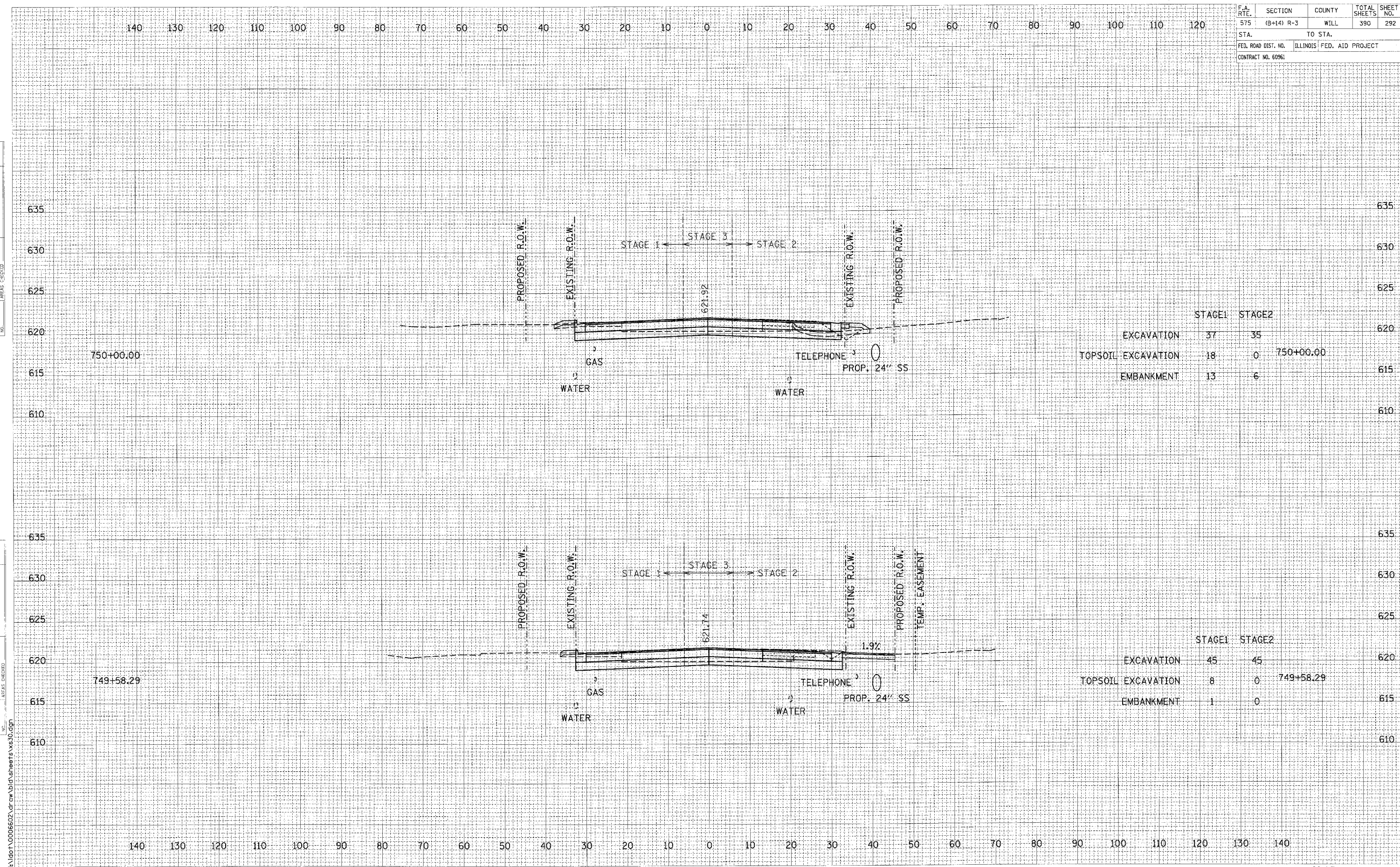

	STAGE1	STAGE2	
EXCAVATION	37	35	
TOPSOIL EXCAVATION	18	0	750+00.00
EMBANKMENT	13	6	

	STAGE1	STAGE2	
EXCAVATION	45	45	
TOPSOIL EXCAVATION	8	0	749+58.29
EMBANKMENT	1	0	

CROSS SECTIONS: U.S. ROUTE 30 - STA. 749+58.29 TO STA. 750+00.00

SCALE: 1" = 10' HORIZ.
1" = 5' VERT.

I:\dot\0006602\dr\dw\bl\sheet\vs30.dgn