

F.A. RTE.	SECTION	COUNTY	TOTAL SHEETS	SHEET NO.
575	(B+14) R-3	WILL	390	299
STA.	TO STA.			
FED. ROAD DIST. NO.		ILLINOIS	FED. AID PROJECT	
CONTRACT NO. 60961				

DATE	BY

DATE	BY

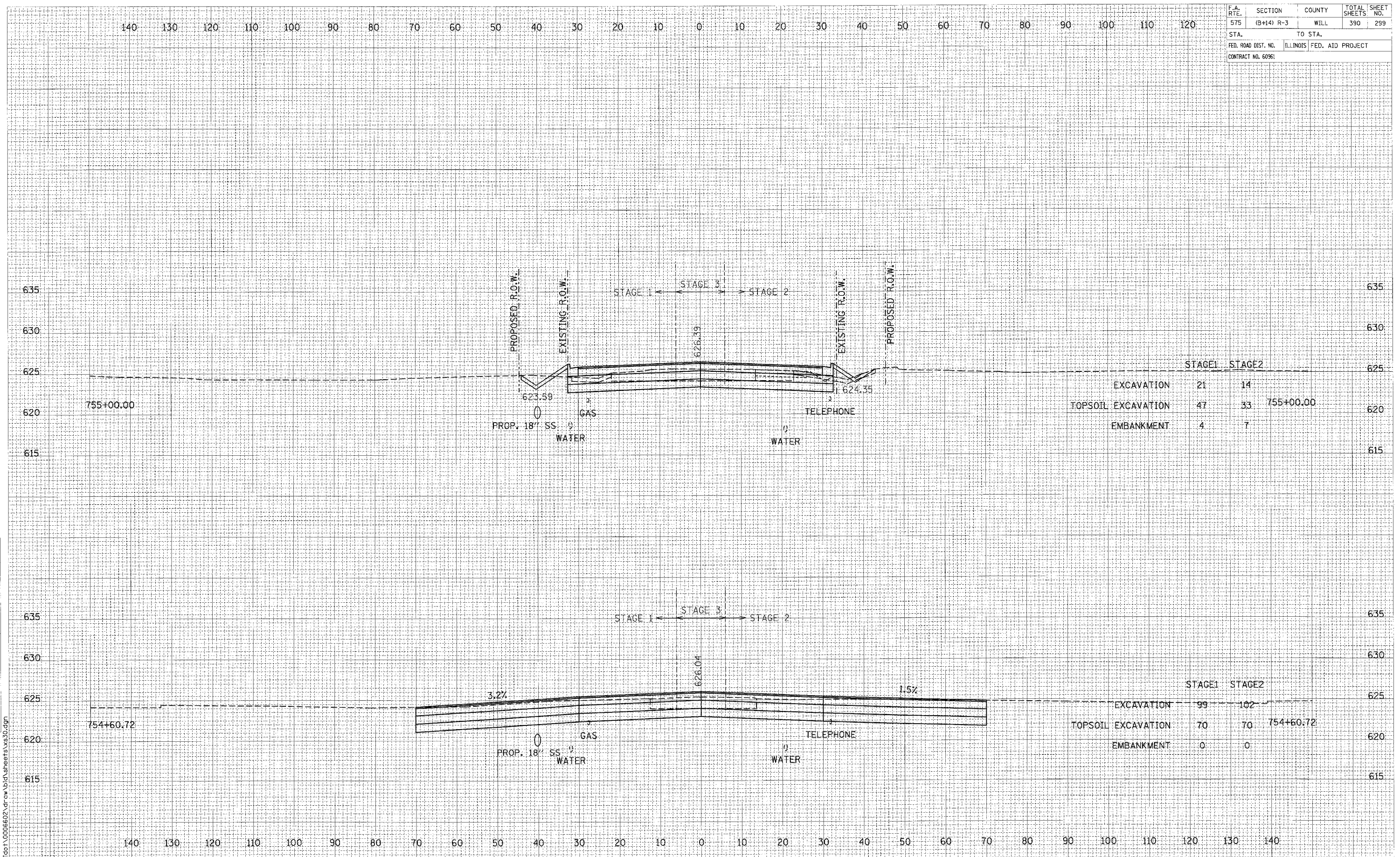

	STAGE1	STAGE2	
EXCAVATION	21	14	755+00.00
TOPSOIL EXCAVATION	47	33	
EMBANKMENT	4	7	

	STAGE1	STAGE2	
EXCAVATION	99	102	754+60.72
TOPSOIL EXCAVATION	70	70	
EMBANKMENT	0	0	

CROSS SECTIONS: U.S. ROUTE 30 - STA. 754+60.72 TO STA. 755+00.00

SCALE: 1" = 10' HORIZ.  
1" = 5' VERT.

I:\a\1\000602.dwg on 10/18/06 sheets vs30.dgn