

F.A. RTE.	SECTION	COUNTY	TOTAL SHEETS	SHEET NO.
575	(B+14) R-3	WILL	390	315
STA.		TO STA.		
FED. ROAD DIST. NO.		ILLINOIS	FED. AID PROJECT	
CONTRACT NO. 609E1				

DATE	BY

DATE	BY

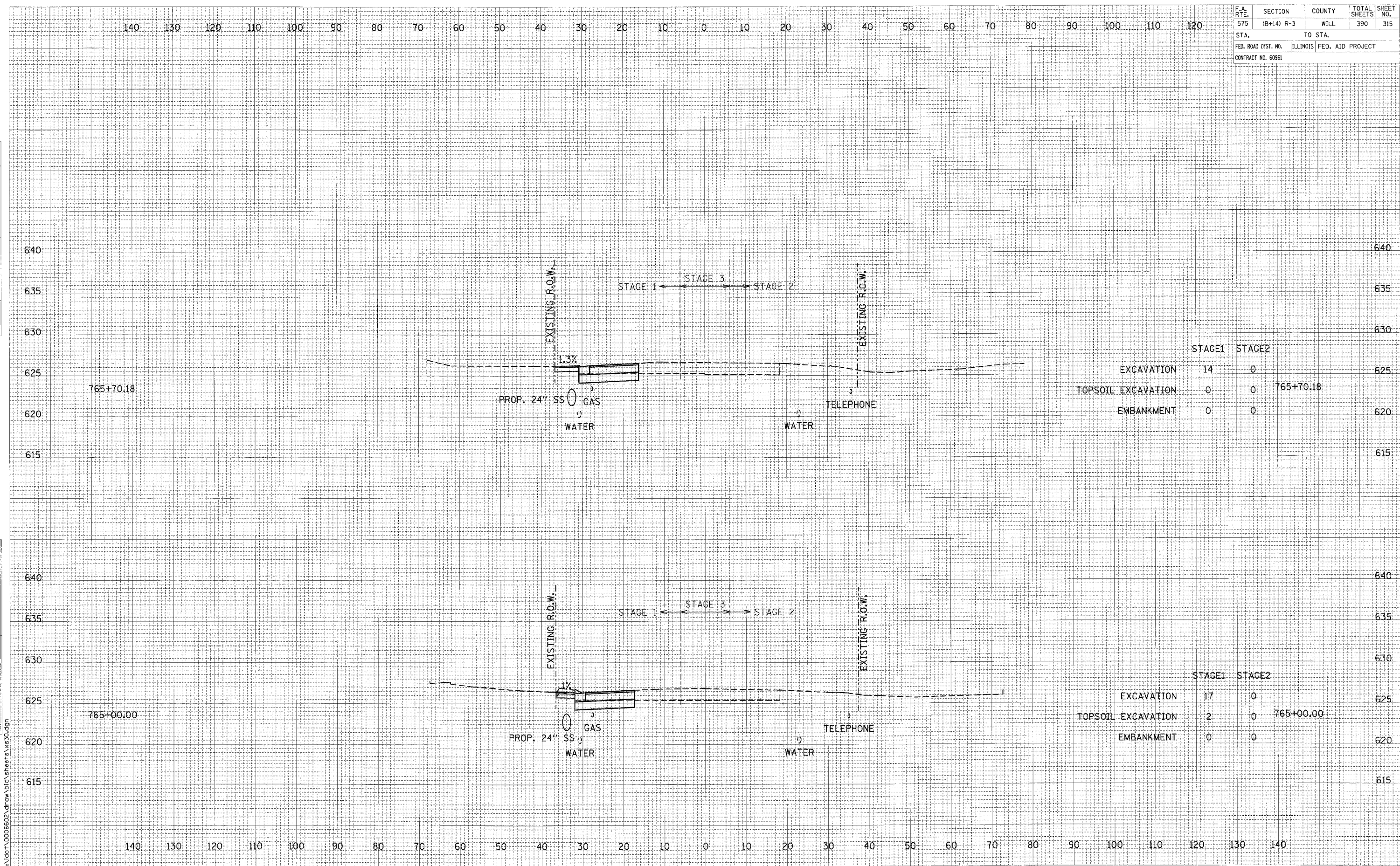

	STAGE1	STAGE2	
EXCAVATION	14	0	
TOPSOIL EXCAVATION	0	0	765+70.18
EMBANKMENT	0	0	

	STAGE1	STAGE2	
EXCAVATION	17	0	
TOPSOIL EXCAVATION	2	0	765+00.00
EMBANKMENT	0	0	

CROSS SECTIONS: U.S. ROUTE 30 - STA. 765+00.00 TO STA. 765+70.18

SCALE: 1" = 10' HORIZ.  
1" = 5' VERT.

I:\dot\0006602\draw\ld\sheet3 vs30.dgn