

F.A. RTE.	SECTION	COUNTY	TOTAL SHEET NO.
575	(B+14) R-3	WILL	390
STA.		TO STA.	
FED. ROAD DIST. NO.		ILLINOIS FED. AID PROJECT	
CONTRACT NO. 60961			

DATE	
NO.	
AREAS CHECKED	
TEMP. EASEMENT	
PROPOSED R.O.W.	
EXISTING R.O.W.	
TELEPHONE	
GAS	
WATER	
PROP. 18" SS	
0.7%	
6.8%	
779+86.10	
625	
620	
615	
630	
635	
640	

DATE	
NO.	
AREAS CHECKED	
TEMP. EASEMENT	
PROPOSED R.O.W.	
EXISTING R.O.W.	
TELEPHONE	
GAS	
WATER	
PROP. 18" SS	
2.5%	
779+23.78	
625	
620	
615	
630	
635	
640	

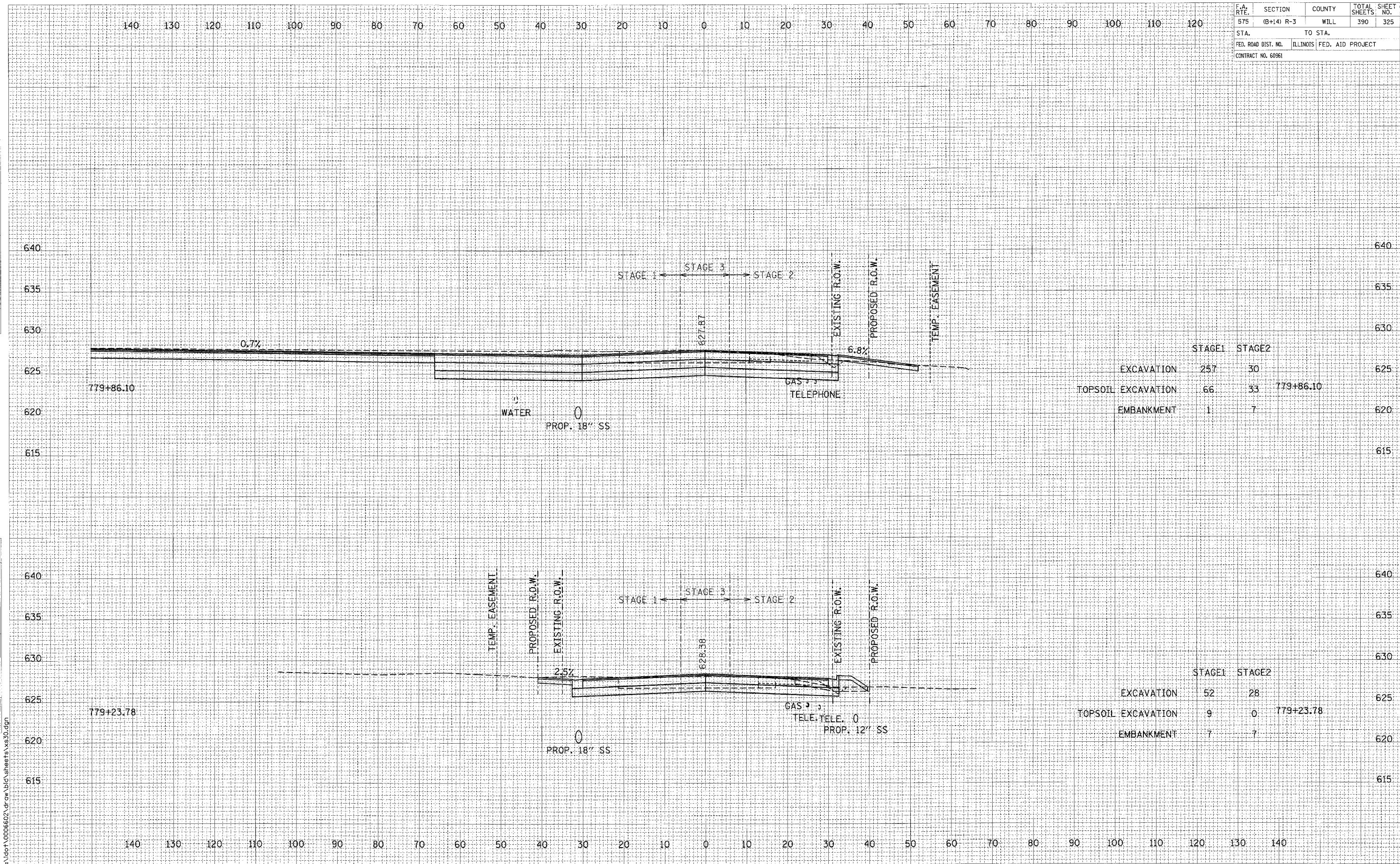

	STAGE1	STAGE2	
EXCAVATION	257	30	
TOPSOIL EXCAVATION	66	33	779+86.10
EMBANKMENT	1	7	

	STAGE1	STAGE2	
EXCAVATION	52	28	
TOPSOIL EXCAVATION	9	0	779+23.78
EMBANKMENT	7	7	

CROSS SECTIONS: U.S. ROUTE 30 - STA. 779+23.78 TO STA. 779+86.10

SCALE: 1" = 10' HORIZ.  
1" = 5' VERT.