

F.A. RTE.	SECTION	COUNTY	TOTAL SHEETS	SHEET NO.
575	(B+14) R-3	WILL	390	327
STA.		TO STA.		
FED. ROAD DIST. NO.		ILLINOIS FED. AID PROJECT		
CONTRACT NO. 60961				

DATE	
BY	
1. ORIGINAL SURVEY	2. CHECKED
3. PLOTTED	4. DATE
5. NOTE BOOK	6. TEMPLATE
7. NO.	8. AREAS CHECKED

DATE	
BY	
1. ORIGINAL SURVEY	2. CHECKED
3. PLOTTED	4. DATE
5. NOTE BOOK	6. TEMPLATE
7. NO.	8. AREAS CHECKED

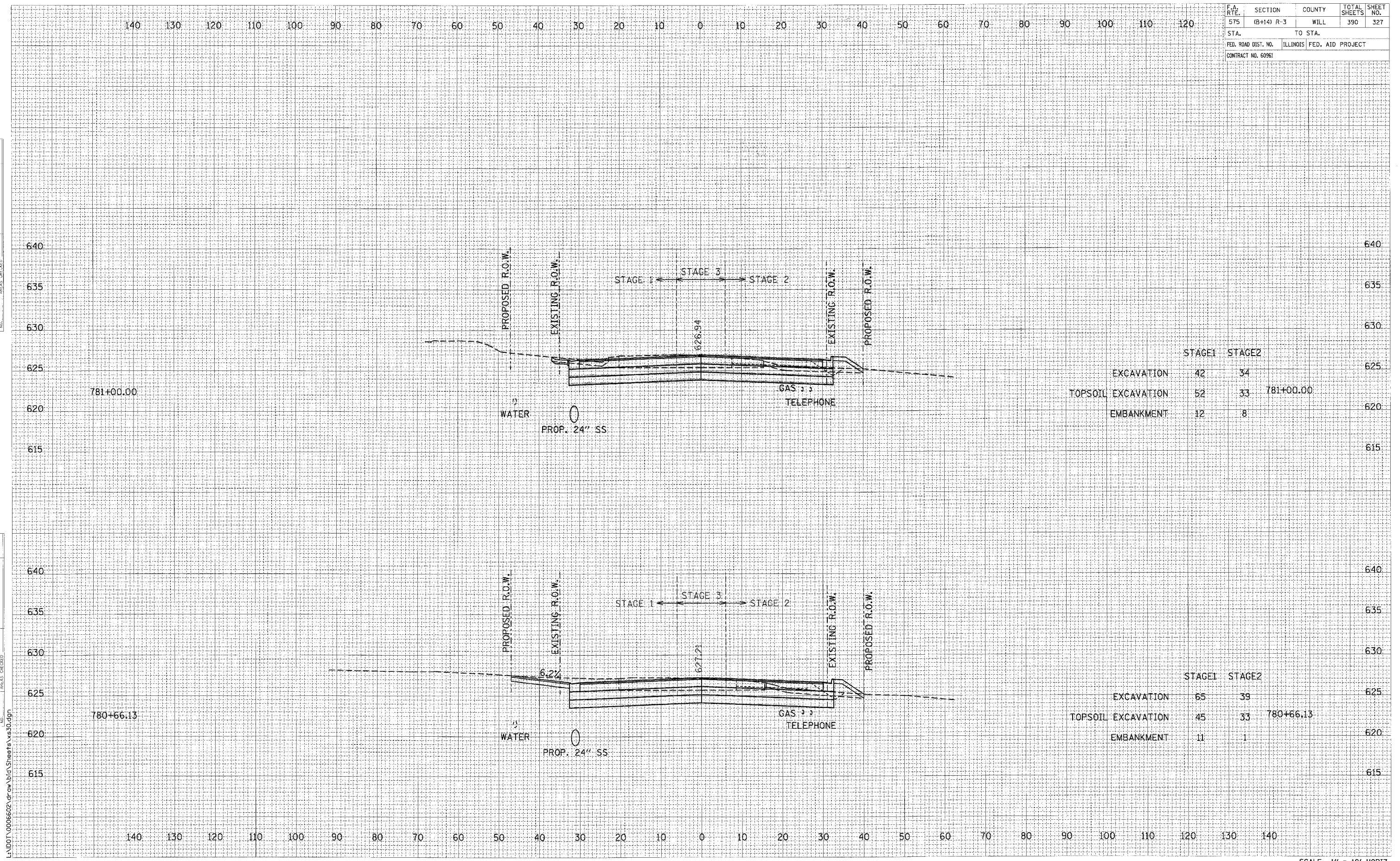

	STAGE1	STAGE2	
EXCAVATION	42	34	
TOPSOIL EXCAVATION	52	33	781+00.00
EMBANKMENT	12	8	

	STAGE1	STAGE2	
EXCAVATION	65	39	
TOPSOIL EXCAVATION	45	33	780+66.13
EMBANKMENT	11	1	

CROSS SECTIONS: U.S. ROUTE 30 - STA. 780+66.13 TO STA. 781+00.00

SCALE: 1" = 10' HORIZ.
1" = 5' VERT.

L:\DOT\0006602\Draw\Bid\ASheets\vs30.dgn