

PLAN
 DRAWN BY: []
 CHECKED BY: []
 DATE: []

PLANNING
 DRAWN BY: []
 CHECKED BY: []
 DATE: []

I:\dot\0006602\draw\bid\sheet\sp\sp18.dgn

F.A. RTE.	SECTION	COUNTY	TOTAL SHEETS	SHEET NO.
575	(B&I) R-3	WILL.	390	382
STA. 816+00		TO STA. 822+00		
FED. ROAD DIST. NO.		ILLINOIS FED. AID PROJECT		
CONTRACT NO. 60661				

- NOTES:
- FOR CURVE DATA AND BENCHMARKS SEE ALIGNMENT, TIES & BENCHMARKS SHEETS.
 - FOR REMOVAL INFORMATION SEE REMOVAL SHEETS.
 - FOR DRAINAGE AND UTILITY INFORMATION SEE DRAINAGE/UTILITY SHEETS.
 - FOR DRIVEWAY PAVEMENT MATERIAL AND THICKNESS SEE SCHEDULE OF DRIVEWAY QUANTITIES.
 - REFER TO DISTRICT ONE STANDARD DETAIL FOR DRIVEWAY DESIGN.
 - ALL RADII ARE TO EDGE OF PAVEMENT UNLESS OTHERWISE NOTED.

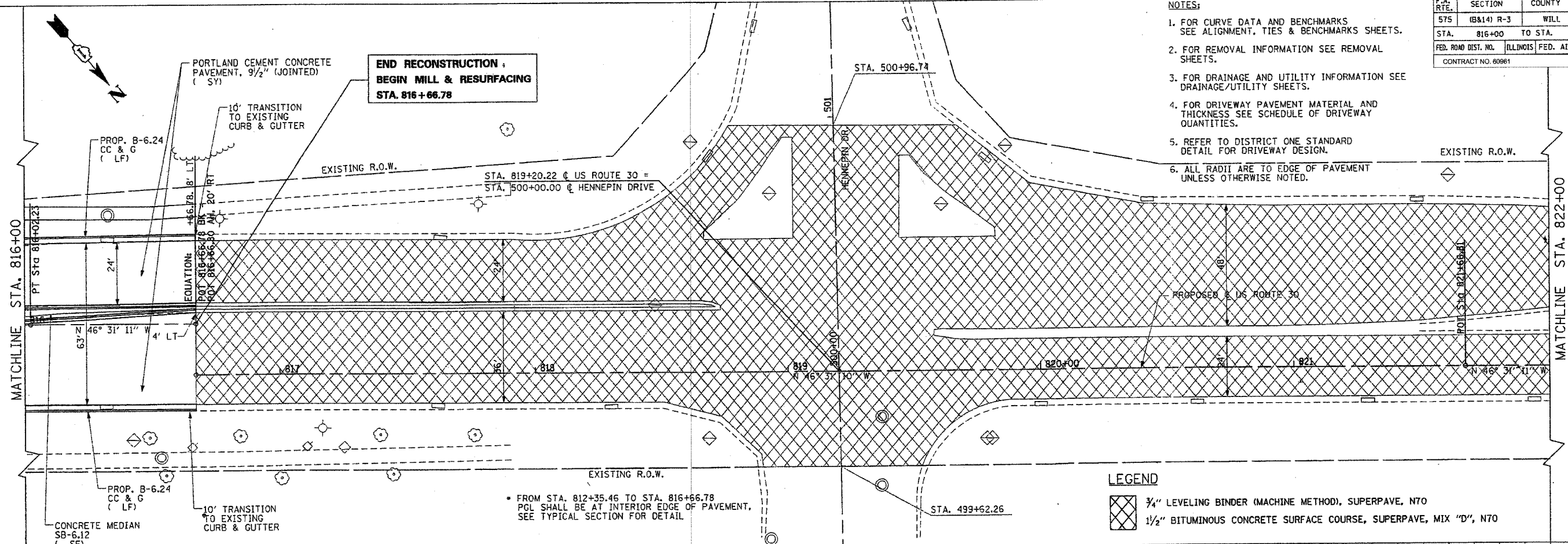

LEGEND
 [Cross-hatch symbol] 3/4" LEVELING BINDER (MACHINE METHOD), SUPERPAVE, N70
 [Diagonal lines symbol] 1 1/2" BITUMINOUS CONCRETE SURFACE COURSE, SUPERPAVE, MIX "D", N70

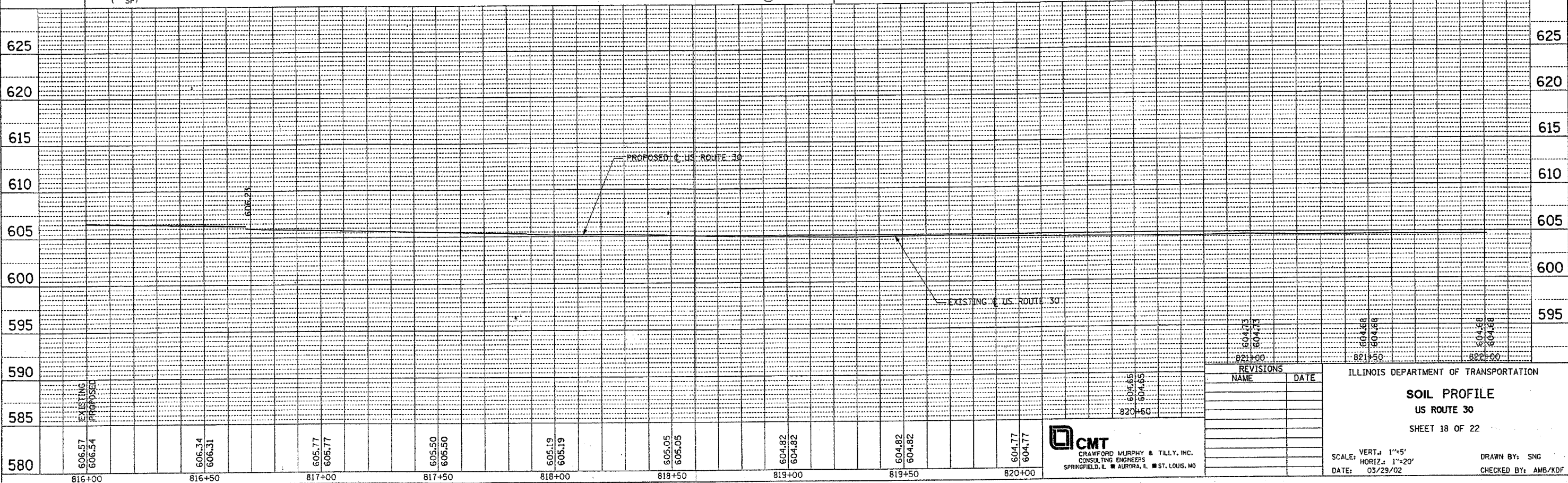

REVISIONS		DATE	
NO.	NAME		

CMT
 CRAWFORD MURPHY & TILLY, INC.
 CONSULTING ENGINEERS
 SPRINGFIELD, IL ■ AURORA, IL ■ ST. LOUIS, MO

ILLINOIS DEPARTMENT OF TRANSPORTATION
SOIL PROFILE
 US ROUTE 30
 SHEET 18 OF 22
 SCALE: VERT.: 1"=5'
 HORIZ.: 1"=20'
 DATE: 03/29/02
 DRAWN BY: SNG
 CHECKED BY: AMB/KDF