

F.A.P. RTE.	SECTION	COUNTY	TOTAL SHEETS	SHEET NO.
575	14-B-R-1&15N-3	WILL	143	29
STA.		TO STA.		
FED. ROAD DIST. NO. 1		ILLINOIS FED. AID PROJECT		
CONTRACT NO. 62098				

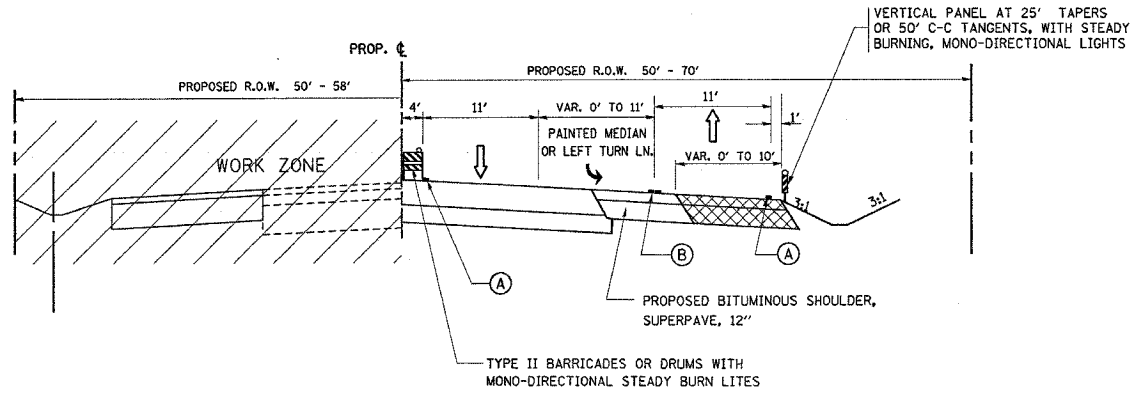
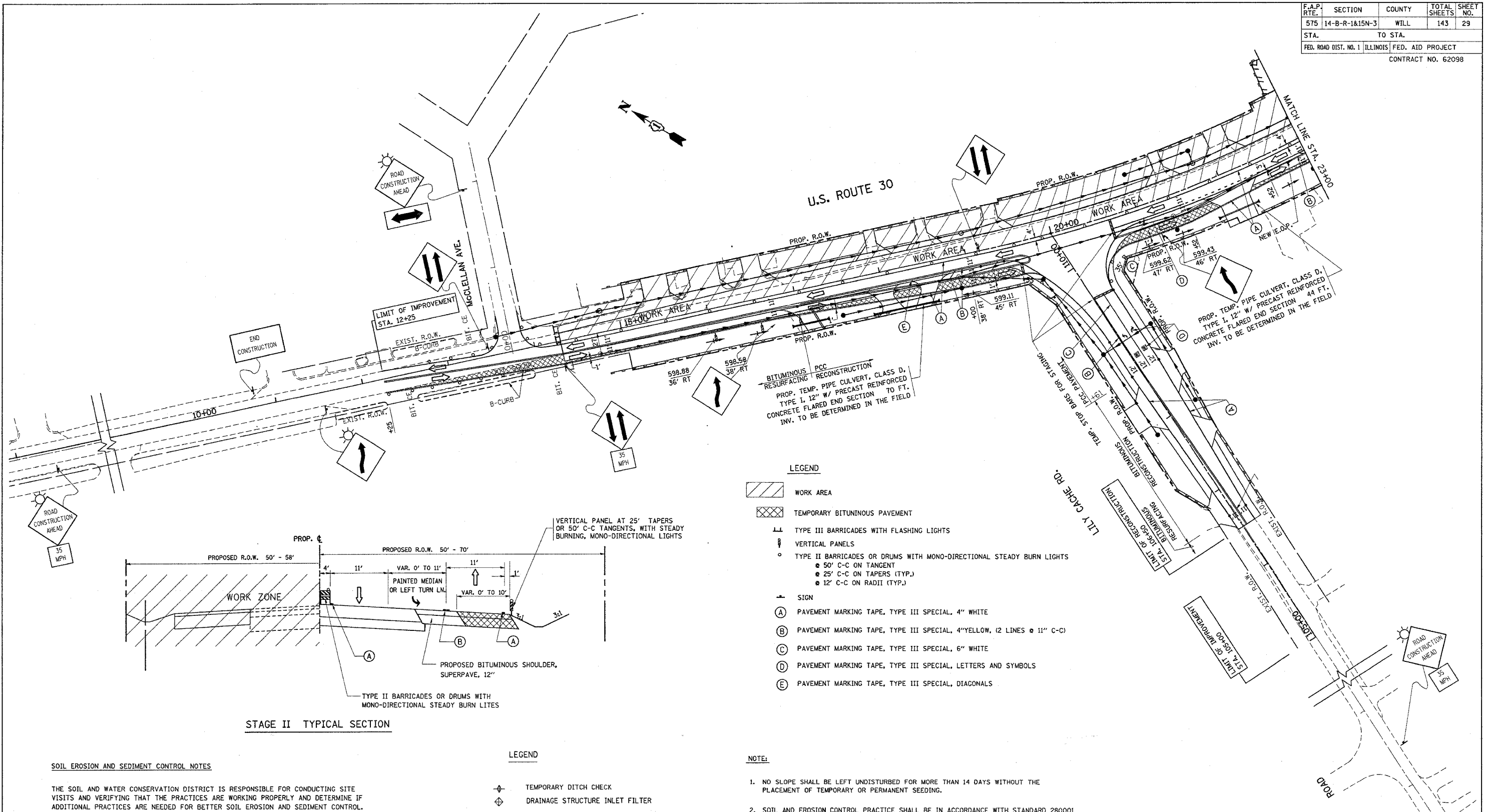

STAGE II TYPICAL SECTION

- LEGEND**
- WORK AREA
 - TEMPORARY BITUMINOUS PAVEMENT
 - TYPE III BARRICADES WITH FLASHING LIGHTS
 - VERTICAL PANELS
 - TYPE II BARRICADES OR DRUMS WITH MONO-DIRECTIONAL STEADY BURN LIGHTS
 - 50' C-C ON TANGENT
 - 25' C-C ON TAPERS (TYP.)
 - 12' C-C ON RADII (TYP.)
 - SIGN
 - (A) PAVEMENT MARKING TAPE, TYPE III SPECIAL, 4" WHITE
 - (B) PAVEMENT MARKING TAPE, TYPE III SPECIAL, 4" YELLOW, (2 LINES @ 11" C-C)
 - (C) PAVEMENT MARKING TAPE, TYPE III SPECIAL, 6" WHITE
 - (D) PAVEMENT MARKING TAPE, TYPE III SPECIAL, LETTERS AND SYMBOLS
 - (E) PAVEMENT MARKING TAPE, TYPE III SPECIAL, DIAGONALS

SOIL EROSION AND SEDIMENT CONTROL NOTES

THE SOIL AND WATER CONSERVATION DISTRICT IS RESPONSIBLE FOR CONDUCTING SITE VISITS AND VERIFYING THAT THE PRACTICES ARE WORKING PROPERLY AND DETERMINE IF ADDITIONAL PRACTICES ARE NEEDED FOR BETTER SOIL EROSION AND SEDIMENT CONTROL. IF ADDITIONAL PRACTICES ARE DEEMED NECESSARY BY THE SWCD THE CONTRACTOR WILL IMPLEMENT THE PRACTICES IN A TIMELY MANNER.

THE WILL/SOUTH COOK SOIL AND WATER CONSERVATION DISTRICT MUST BE NOTIFIED ONE WEEK PRIOR TO THE PRE-CONSTRUCTION CONFERENCE, ONE WEEK PRIOR TO THE COMMENCEMENT OF THE LAND DISTURBING ACTIVITIES, AND ONE WEEK PRIOR TO FINAL INSPECTION.

ALL SOIL EROSION AND SEDIMENT CONTROL PRACTICES ARE REFERENCED FROM THE ILLINOIS URBAN MANUAL.

- LEGEND**
- TEMPORARY DITCH CHECK
 - DRAINAGE STRUCTURE INLET FILTER
 - PERIMETER EROSION BARRIER
 - TEMPORARY SWALE
 - TEMPORARY DITCH
 - SODDING, SALT TOLERANT

- NOTE:**
- NO SLOPE SHALL BE LEFT UNDISTURBED FOR MORE THAN 14 DAYS WITHOUT THE PLACEMENT OF TEMPORARY OR PERMANENT SEEDING.
 - SOIL AND EROSION CONTROL PRACTICE SHALL BE IN ACCORDANCE WITH STANDARD 280001 "TEMPORARY EROSION CONTROL SYSTEM".
 - ANY AREA WHERE THERE IS NO PROPOSED GRADING, THE EXISTING GROUND COVER SHALL REMAIN.

REVISIONS		ILLINOIS DEPARTMENT OF TRANSPORTATION	
NAME	DATE	US RTE 30 @ LILY CACHE RD. SUGGESTED STAGING AND EROSION CONTROL PLAN STAGE II	
		SCALE: VERT.	DRAWN BY
		HORIZ.	CHECKED BY
		DATE 5/20/2005	