

EXISTING CONDITIONS & REMOVALS

F.A.I.	SECTION	COUNTY	TOTAL SHEETS	SHEET NO.
94/90		COOK	598	200
STA.	TO STA.			
FED. ROAD DIST. NO.	ILLINOIS	FED. AID PROJECT		
		• (1815, ETC, 2324.6-1P)R-9		

62302

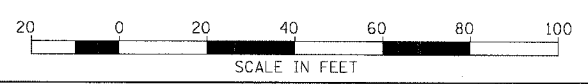
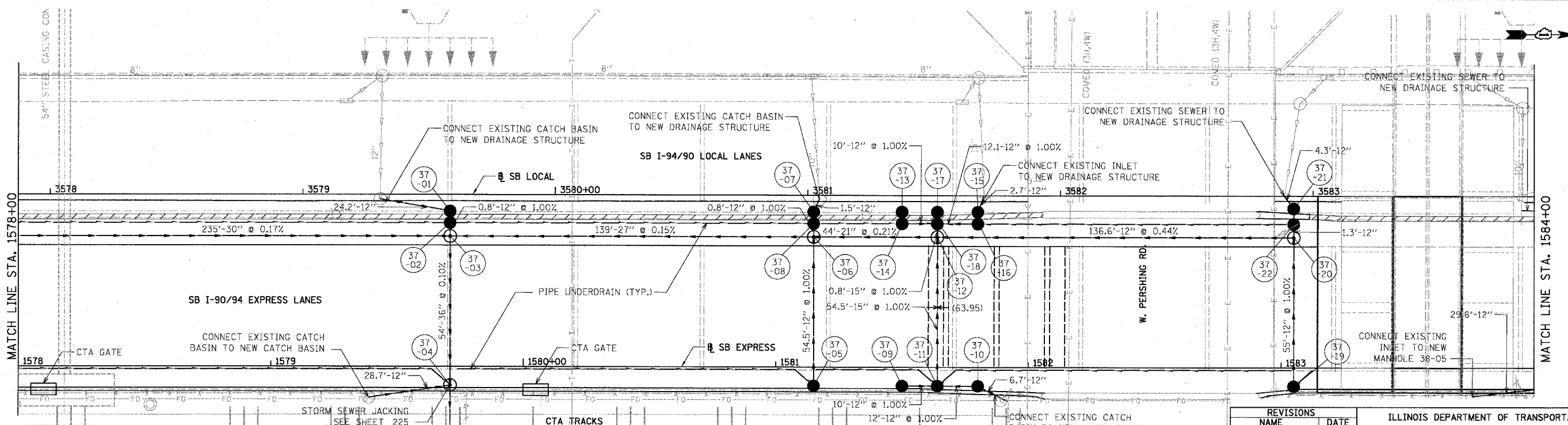
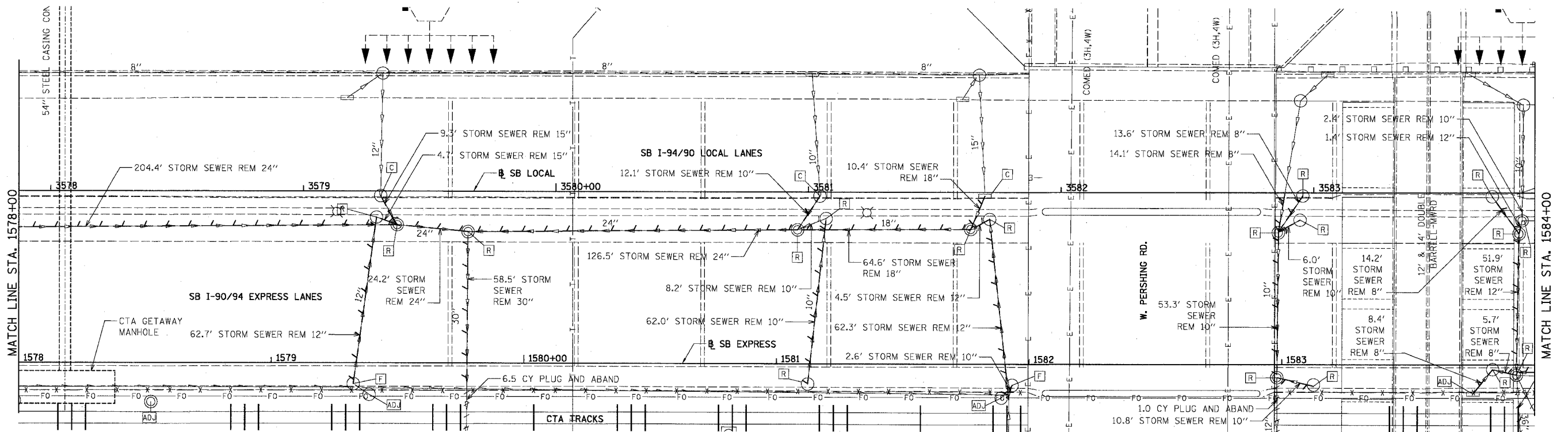

PROPOSED CONDITIONS

REVISIONS	NAME	DATE

ILLINOIS DEPARTMENT OF TRANSPORTATION
 F.A.I. 94/90 (DAN RYAN EXPRESSWAY)
 31ST STREET TO 71ST STREET
 SB EXPRESS LANE RECONSTRUCTION
 DRAINAGE AND UTILITIES PLAN
 SOUTHBOUND STA. 1578+00 TO STA. 1584+00
 SCALE: 1"=20'
 DATE: 07/07/05
 DRAWN BY: OC
 CHECKED BY: DDM

BOWMAN, BARRETT & ASSOCIATES INC.
 CONSULTING ENGINEERS
 Chicago, Illinois
 312.228.0100
 www.bbandainc.com

DU-37
 12/5/10 PM