

| | | | | |
|---------------------|-----------------------------|------------------|--------------|-----------|
| F.A.I. RTE. | SECTION | COUNTY | TOTAL SHEETS | SHEET NO. |
| 94/90 | | COOK | 598 | 266 |
| STA. | TO STA. | | | |
| FED. ROAD DIST. NO. | ILLINOIS | FED. AID PROJECT | | |
| 62302 | • (1818, ETC, 2324.6-1)PR-9 | | | |

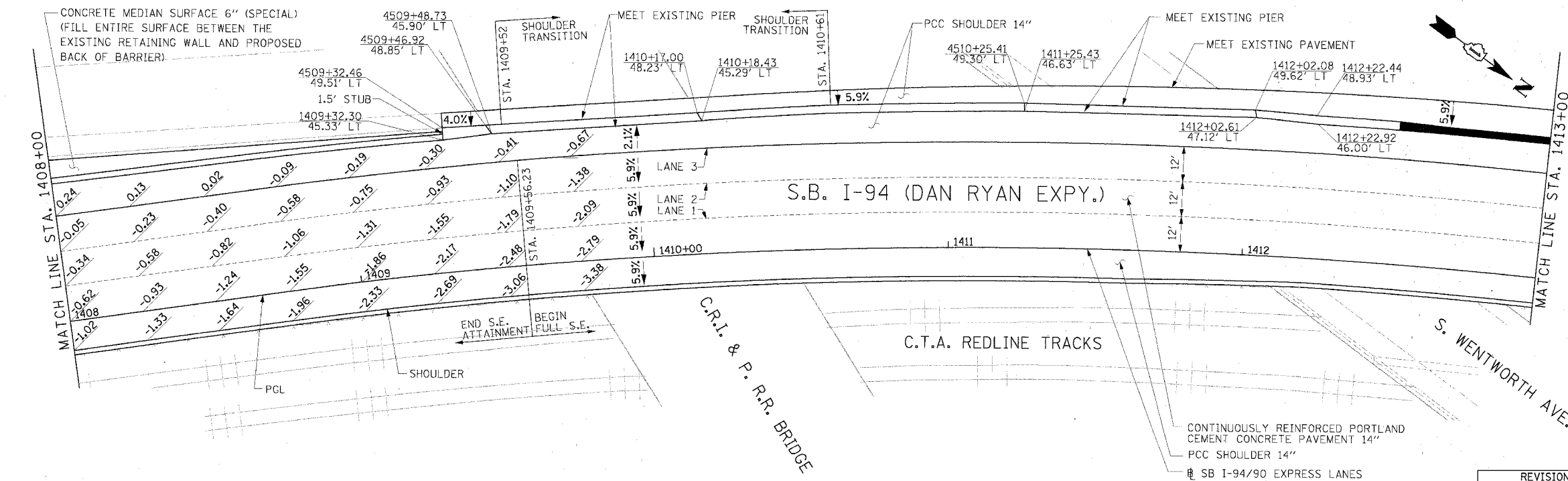
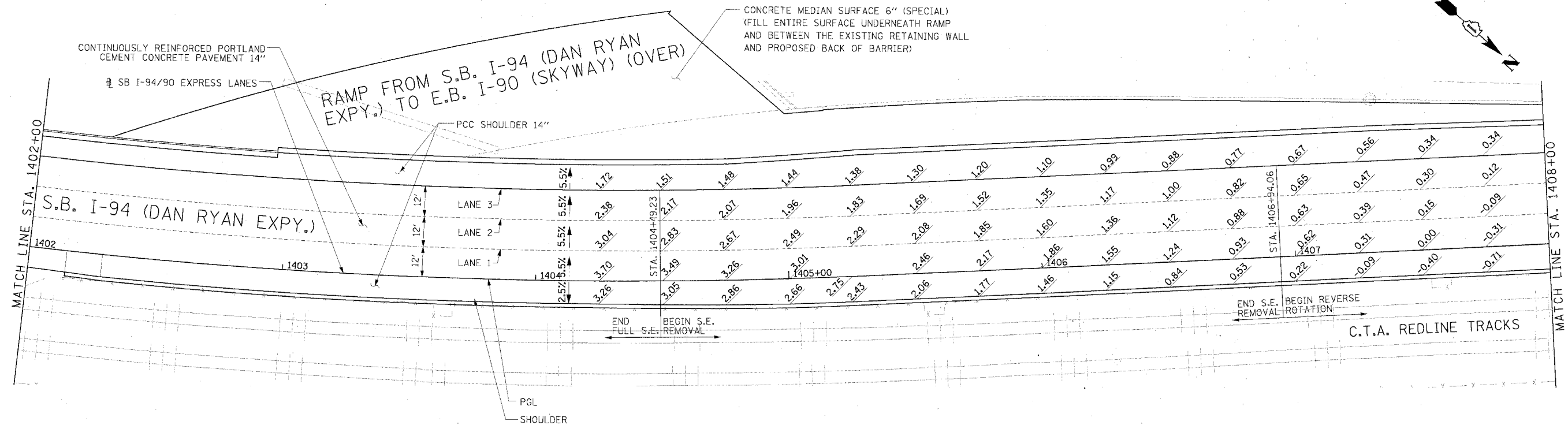

Edwards AND Kelcey
 ONE NORTH FRANKLIN
 CHICAGO, IL 60606
 PHONE: (312) 251-3000
 FAX: (312) 251-3015
 WEB: WWW.EKCORP.COM

LEGEND

| | |
|--------|---|
| #,## | ELEVATION STATIONED OFF OF SB I-94/90 EXPRESS LANES |
| [#,##] | ELEVATION STATIONED OFF OF SB I-94/90 LOCAL LANES |
| [*,##] | ELEVATION STATIONED OFF OF SLIP RAMP ALIGNMENT |

NOTE:
 1. PAVEMENT ELEVATIONS ALONG RAMPS, GORES AND IN AREAS OF SUPERELEVATION TRANSITION ARE PROVIDED AT 25' INTERVALS. FOR ALL OTHER ELEVATIONS, REFER TO PROFILE AND TYPICAL SECTIONS.

| REVISIONS | NAME | DATE |
|-----------|------|------|
| | | |
| | | |
| | | |
| | | |
| | | |
| | | |
| | | |
| | | |
| | | |
| | | |

ILLINOIS DEPARTMENT OF TRANSPORTATION
 F.A.I. 94/90 (DAN RYAN EXPRESSWAY)
 31ST STREET TO 71ST STREET
 SB EXPRESS LANE RECONSTRUCTION
 PAVEMENT JOINTING AND ELEVATION PLAN
 SOUTHBOUND STA. 1402+00 TO STA. 1413+00

SCALE: 1"=20'
 0' 10' 20' 30' 40'

DATE: 7/7/05 DRAWN BY: TAI
 CHECKED BY: PJM

JT-4