

STATE OF ILLINOIS  
DEPARTMENT OF TRANSPORTATION

F.A.I. RTE.	SECTION	COUNTY	TOTAL SHEETS	SHEET NO.
90/94		COOK	598	423
STA.		TO STA.		
FED. ROAD DIST. NO. 1		ILLINOIS	FED. AID PROJECT	
• (1818, ETC, 2324.6-1PIR-9				62302

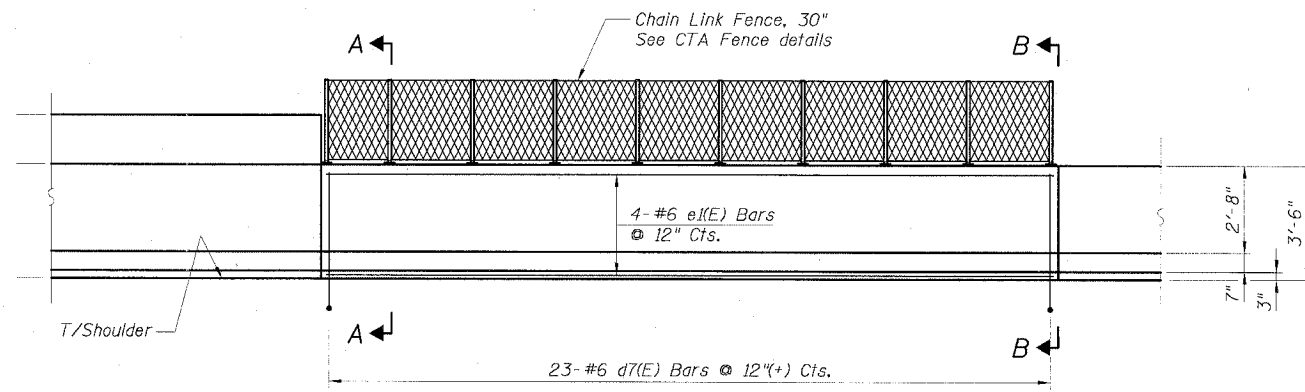
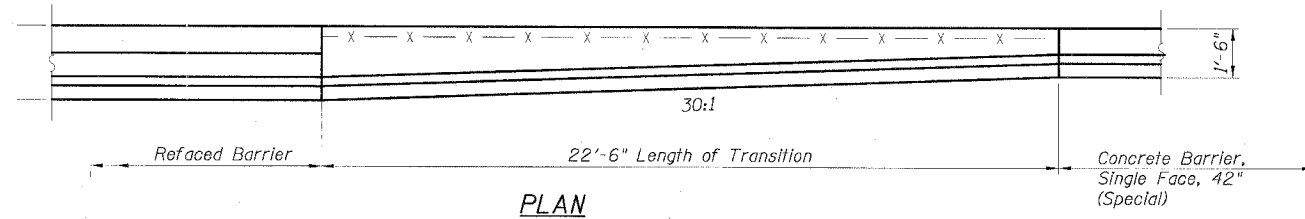

**BILL OF MATERIAL**

Bar	No.	Size	Length	Shape
a1(E)	3	#5	22'-2"	—
d7(E)	23	#6	6'-9"	—
e1(E)	4	#6	22'-2"	—
Item		Unit	Quantity	
Reinforcement Bars, Epoxy Coated		Lbs.	470	
Concrete Structures		Cu. Yd.	4.2	
Protective Coat		Sq. Yd.	12.2	

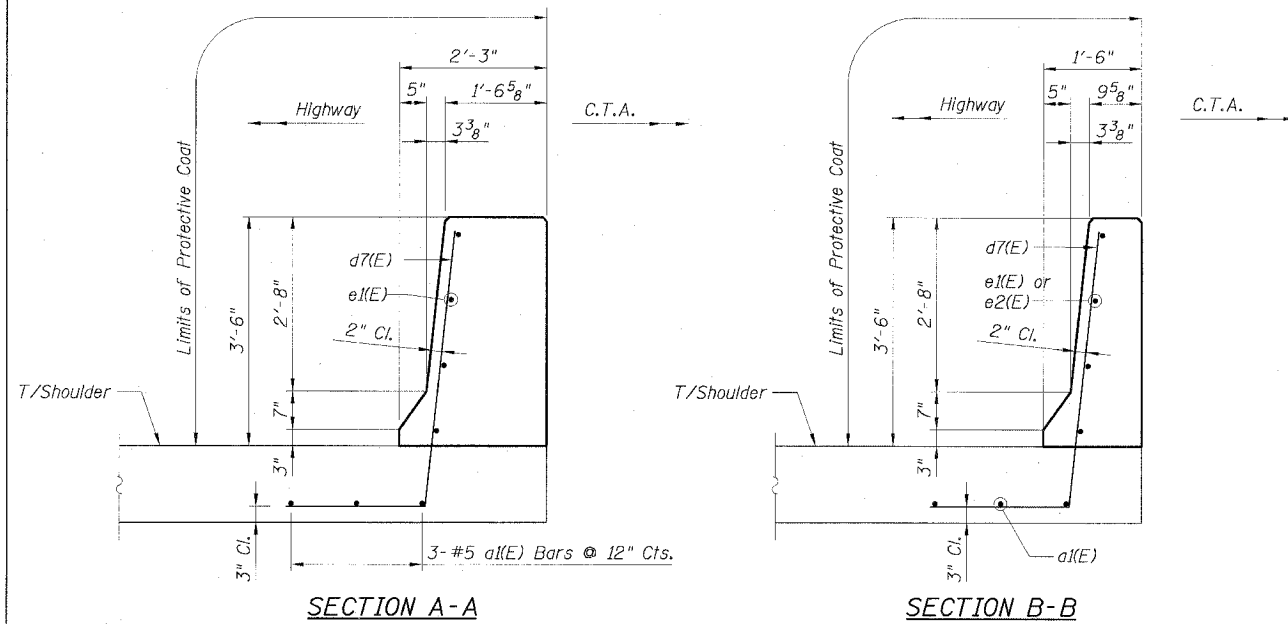

**NOTES:**

1. Provide joints in facing to match those in the Existing Barrier.
2. For d7(E) bar details, see Sheet B14.
3. For Refaced Barrier details, see Sheets B4 and B5.
4. For Concrete Barrier, Single Face, 42" (Special), see Civil details.
5. For locations of Transition, see Roadway Plans.

Sheet B15 of 18

REVISIONS	
NAME	DATE

ILLINOIS DEPARTMENT OF TRANSPORTATION  
F.A.I. 90/94 (DAN RYAN EXPRESSWAY)  
**EXISTING BARRIER WALL MODIFICATIONS AT CTA STATIONS**  
**PROPOSED T/S SHOULDER AT OR ABOVE EXISTING REFACED BARRIER TO NEW 42" BARRIER TRANSITION DETAILS**  
SCALE: None DRAWN BY: CHD  
DATE: JULY 7, 2005 CHECKED BY: RDP

**CTE | AECOM**  
CIC  
307 East Wacker Drive, Suite 600, Chicago, Illinois 60601-2016  
T: 312.251.0100 F: 312.251.0102 www.cteaecom.com

05/24/2005 02:20:54 PM