

F.A. RTE.	SECTION	COUNTY	TOTAL SHEETS	SHEET NO.
55	2004-I18 ORR	WILL	14	9
STA. 1347+00 TO		STA. 1352+19		
FED. ROAD DIST. NO.	ILLINOIS	FED. AID PROJECT		

D-91-074-05

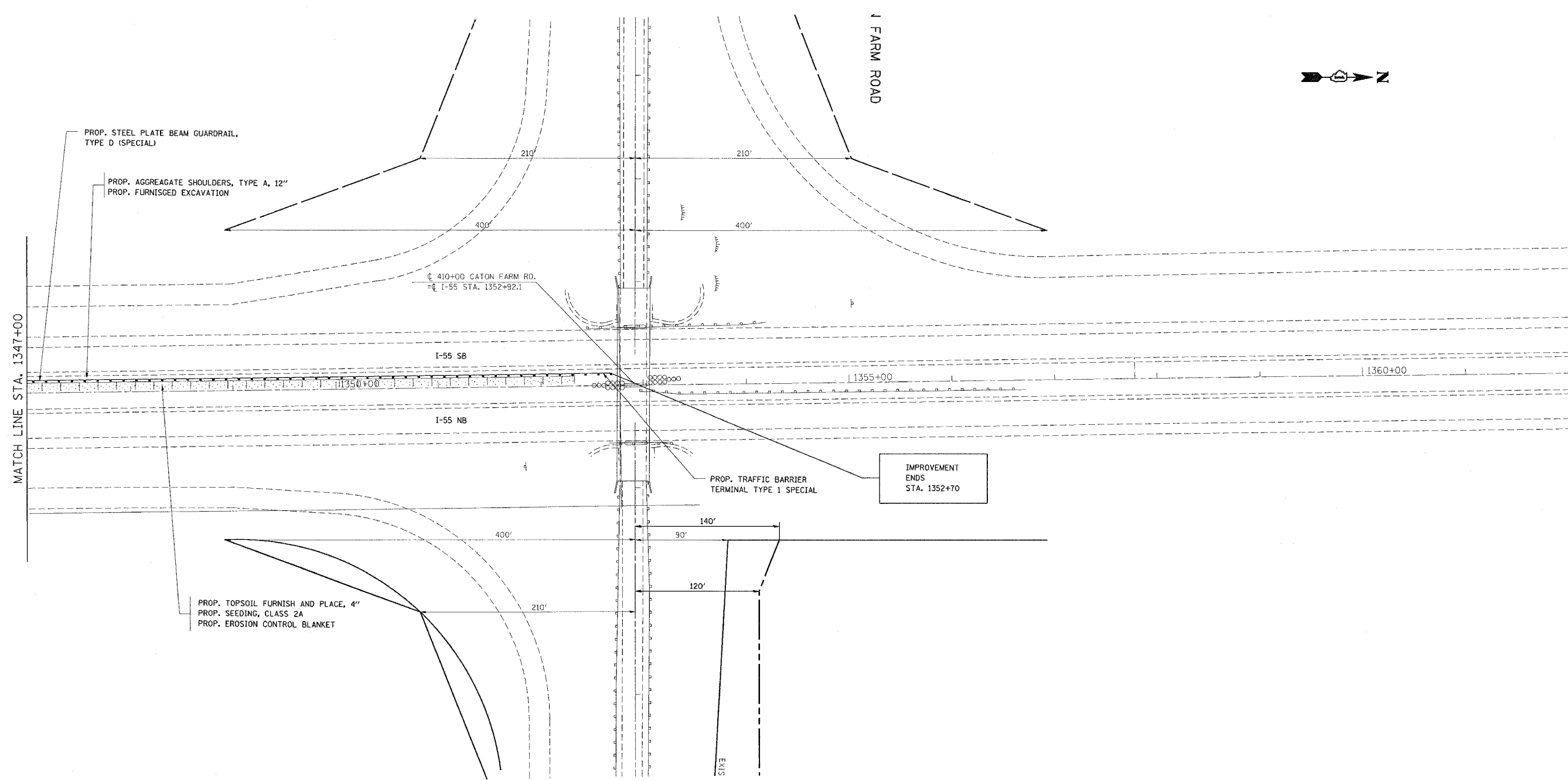

REVISIONS	
NAME	DATE

ILLINOIS DEPARTMENT OF TRANSPORTATION

FAI 55/ I-55

CATON FARM ROAD TO N/O BLACK ROAD

EXISTING / PROPOSED ROADWAY PLAN

SCALE: VERT. HORIZ.

DATE

DRAWN BY: HMO

CHECKED BY:

PLOT DATE = 6/14/2005
 FILE NAME = c:\p\projects\1187485\h\h.dwg
 PLOT SCALE = 50.0000 / IN.
 REFERENCE = REF#