

62884

F. & S. NO.	SECTION	COUNTY	TOTAL SHEETS	SHEET NO.
55	2004-118 GRR	WILL	14	13
STA.	TO STA.			
FED. AID DIST. NO. 1	ILLINOIS	FED. AID PROJECT		

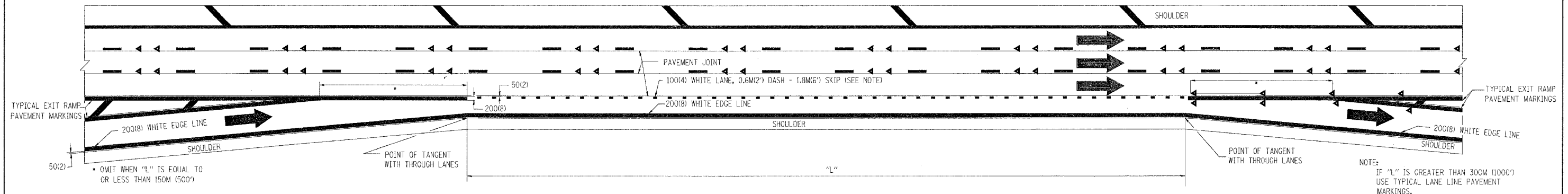

TYPICAL ENTRANCE/EXIT RAMP COMBINATION PAVEMENT MARKINGS

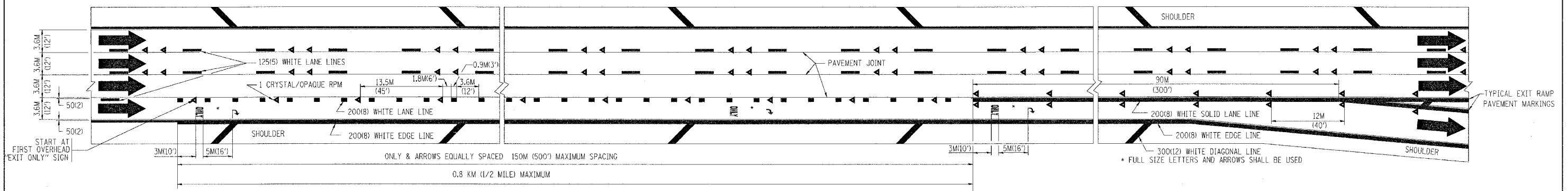

TYPICAL EXIT ONLY LANE PAVEMENT MARKINGS

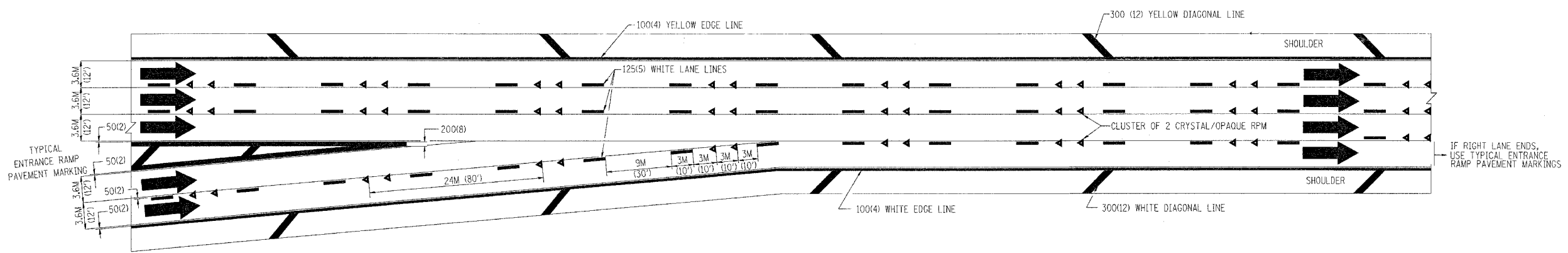

TYPICAL TWO LANE ENTRANCE RAMP PAVEMENT MARKINGS

REVISIONS	
NAME	DATE
DWS	1/90
DWS	5/91

ILLINOIS DEPARTMENT OF TRANSPORTATION

**MULTI-LANE FREEWAY
PAVEMENT MARKING
DETAILS**

SCALE: NONE
DATE: 6/14/2005

DRAWN BY C.A.D.D.
CHECKED BY
TC12 SHEET 2 OF 2
REVISION DATE: 01/01/96

CONTRACT NO. 2004-118

6/14/2005
w:\d\st\st\402.dgn
VH-TC12
osmanfm