

F.A.U. RTE.	SECTION	COUNTY	TOTAL SHEETS
1238	2004-125 TS	LAKE	18
STA.	TO STA.		
FED. ROAD DIST. NO.	ILLINOIS	FED. AID PROJECT	
CONTRACT NO. 62890			

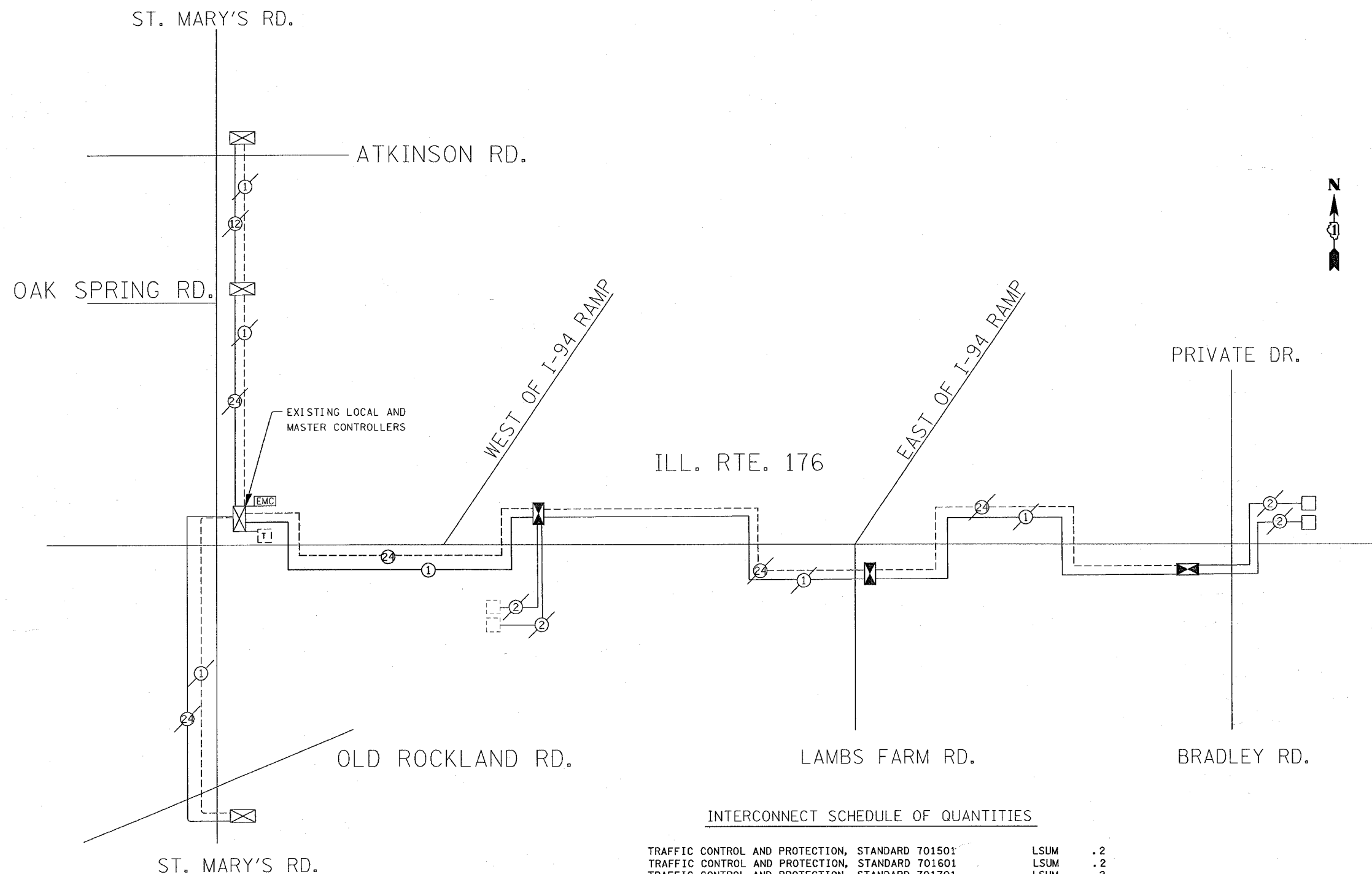

INTERCONNECT SCHEMATIC LEGEND

EXISTING INTERSECTION CONTROLLER	
PROPOSED INTERSECTION CONTROLLER	
EXISTING MASTER CONTROLLER	
PROPOSED MASTER CONTROLLER	
MASTER MASTER CONTROLLER	
EXISTING INTERSECTION & SAMPLING (SYSTEM) DETECTORS	
PROPOSED INTERSECTION & SAMPLING (SYSTEM) DETECTORS	
EXISTING INTERSECTION LOOP DETECTORS	
PROPOSED SAMPLING (SYSTEM) DETECTORS	
EXISTING SAMPLING (SYSTEM) DETECTORS	
PROPOSED SAMPLING (SYSTEM) DETECTORS	
EXISTING SAMPLING (SYSTEM) DETECTORS, PROPOSED INTERSECTION AND SAMPLING (SYSTEM) DETECTORS.	
EXISTING SAMPLING (SYSTEM) DETECTORS, PROPOSED SAMPLING (SYSTEM) DETECTORS.	
EXISTING PREFORMED INTERSECTION & SAMPLING (SYSTEM) DETECTORS	
PROPOSED PREFORMED INTERSECTION & SAMPLING (SYSTEM) DETECTORS	
EXISTING SAMPLING (SYSTEM) PREFORMED DETECTORS	
PROPOSED SAMPLING (SYSTEM) PREFORMED DETECTORS	
EXISTING FIBER OPTIC CABLE IN CONDUIT, NO. 62.5/125, MM12F SM12F	
PROPOSED FIBER OPTIC CABLE IN CONDUIT, NO. 62.5/125, MM12F SM12F	
EXISTING INTERCONNECT CABLE - NO. 62.5/125 12F FIBER OPTIC CABLE	
PROPOSED INTERCONNECT CABLE - NO. 62.5/125 12F FIBER OPTIC CABLE	
EXISTING INTERCONNECT CABLE - NO. 18 3 PAIR TWISTED, SHIELDED	
PROPOSED INTERCONNECT CABLE - NO. 18 3 PAIR TWISTED, SHIELDED	
EXISTING LOOP DETECTOR CABLE 2/C TWISTED, SHIELDED	
PROPOSED LOOP DETECTOR CABLE 2/C TWISTED, SHIELDED	
EXISTING ELECTRIC CABLE, 1/C (AS SPECIFIED)	
PROPOSED ELECTRIC CABLE, 1/C (AS SPECIFIED)	
EXISTING TELEPHONE CONNECTION	
PROPOSED TELEPHONE CONNECTION	

INTERCONNECT SCHEDULE OF QUANTITIES

TRAFFIC CONTROL AND PROTECTION, STANDARD 701501	LSUM	.2
TRAFFIC CONTROL AND PROTECTION, STANDARD 701601	LSUM	.2
TRAFFIC CONTROL AND PROTECTION, STANDARD 701701	LSUM	.2
TRAFFIC CONTROL AND PROTECTION, STANDARD 701801	LSUM	.2
CONDUIT IN TRENCH, 2" DIA. GALVANIZED STEEL	FOOT	2380
CONDUIT IN PUSHED, 2" DIA. GALVANIZED STEEL	FOOT	120
HEAVY-HANDHOLE	EACH	4
TRENCH AND BACK FILL FOR ELECTRICAL WORK	FOOT	2380
DRILL EXISTING HANDHOLES	EACH	2
FIBER OPTIC CABLE IN CONDUIT, NO. 62.5/125, MM12F SM12F	FOOT	3230
ELECTRIC CABLE IN CONDUIT TRACER NO. 14 1C	FOOT	3230

REVISIONS		ILLINOIS DEPARTMENT OF TRANSPORTATION
NAME	DATE	
		<p>ILL. RTE. 176 ST. MARY'S RD TO BRADLEY RD. INTERCONNECT SCHEMATIC</p> <p>SCALE: NONE DATE: 01-05-2005</p> <p>DRAWN BY: SM DESIGNED BY: SM CHECKED BY: DAD</p>

13:07:34 02/04/2005