

F.A.I. RTE.	SECTION	COUNTY	TOTAL SHEETS	SHEET NO.
94	2005-011	COOK	40	14
STA.		TO STA.		
FED. ROAD DIST. NO.		ILLINOIS	FED. AID PROJECT	

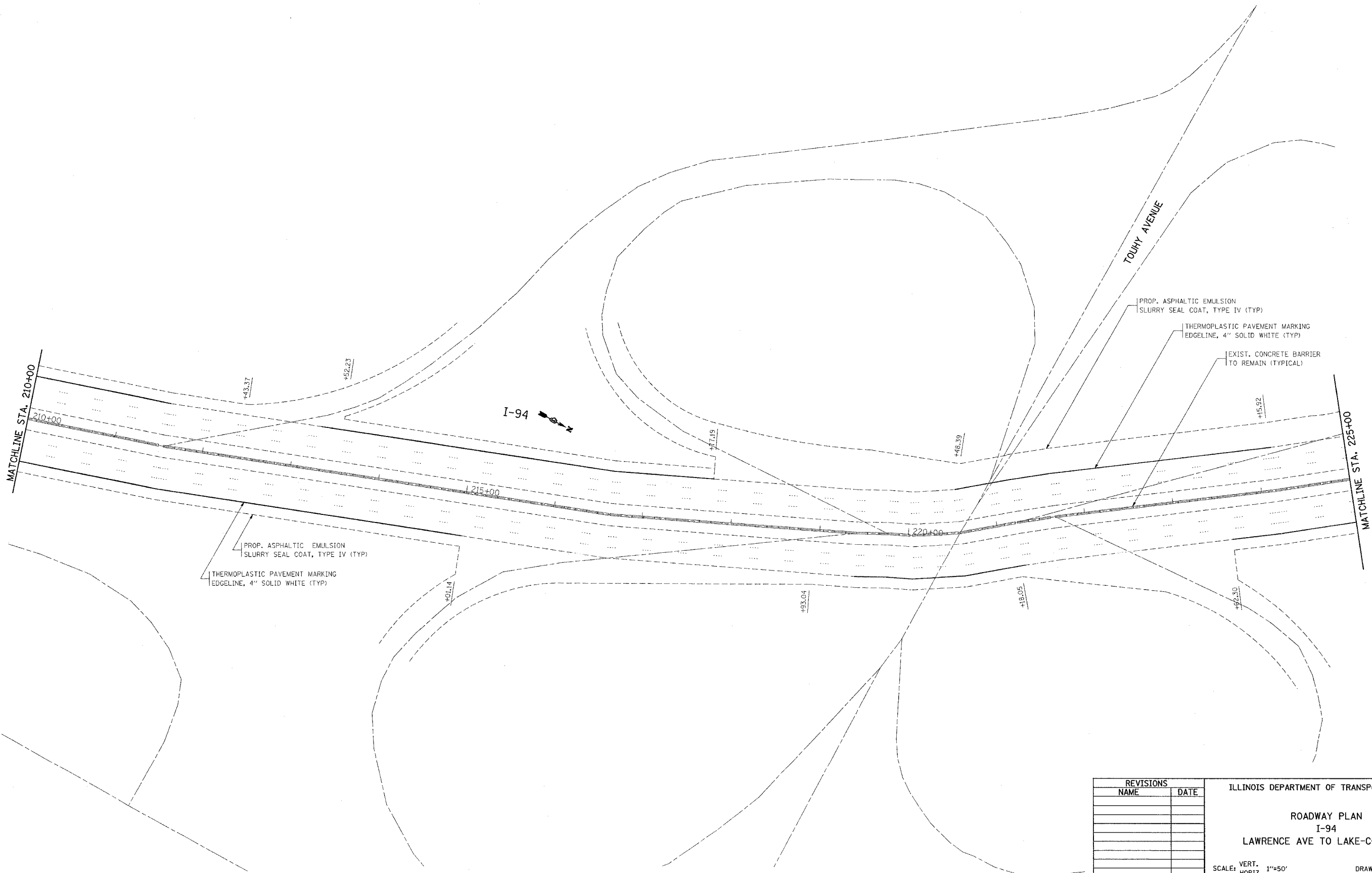

MATCHLINE STA. 210+00

MATCHLINE STA. 225+00

I-94

TOUHY AVENUE

PROP. ASPHALTIC EMULSION
SLURRY SEAL COAT, TYPE IV (TYP)
THERMOPLASTIC PAVEMENT MARKING
EDGELINE, 4" SOLID WHITE (TYP)

PROP. ASPHALTIC EMULSION
SLURRY SEAL COAT, TYPE IV (TYP)

THERMOPLASTIC PAVEMENT MARKING
EDGELINE, 4" SOLID WHITE (TYP)

EXIST. CONCRETE BARRIER
TO REMAIN (TYPICAL)

REVISIONS	
NAME	DATE

ILLINOIS DEPARTMENT OF TRANSPORTATION

ROADWAY PLAN
I-94
LAWRENCE AVE TO LAKE-COOK RD.

SCALE: VERT. 1"=50'
HORIZ. 1"=50'

DRAWN BY
CHECKED BY

PLOT DATE = 6/8/2005
FILE NAME = c:\projects\i16168\ah_design\p14.dwg
USER NAME = golbom

1 10/23/2005 10:58:38 AM