

F.A. RTE. VAR.	SECTION	COUNTY	TOTAL SHEETS	SHEET NO.
	2005-0191	COOK	9	1

STATE OF ILLINOIS
DEPARTMENT OF TRANSPORTATION
DIVISION OF HIGHWAYS

**PROPOSED
HIGHWAY PLANS**

VARIOUS ROUTES
SECTION 2005-0191
BRIDGE REPAIR
PERMANENT PROTECTIVE SHIELDING
COOK COUNTY
C-91-183-05

FOR INDEX OF SHEETS, SEE SHEET NO. 3

THESE IMPROVEMENTS ARE LOCATED IN THE VILLAGES OF SKOKIE, MORTON GROVE, STICKNEY, TINLEY PARK AND THE CITY OF CHICAGO

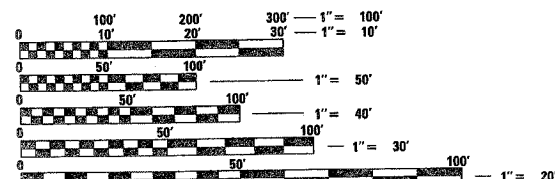

FULL SIZE PLANS HAVE BEEN PREPARED USING STANDARD ENGINEERING SCALES. REDUCED SIZED PLANS WILL NOT CONFORM TO STANDARD SCALES. IN MAKING MEASUREMENTS ON REDUCED PLANS, THE ABOVE SCALES MAY BE USED.

J.U.L.I.E.
JOINT UTILITY LOCATION INFORMATION FOR EXCAVATION
1-800-892-0123

STATE OF ILLINOIS
DEPARTMENT OF TRANSPORTATION
DIVISION OF HIGHWAYS

SUBMITTED May 27, 20 05
Diane O'Keefe
DEPUTY DIRECTOR OF HIGHWAYS, REGION ENGINEER

July 1, 20 05
Mike Hine
ENGINEER OF DESIGN AND ENVIRONMENT

July 1, 20 05
Victor Mader
DIRECTOR OF HIGHWAYS, CHIEF ENGINEER

PRINTED BY THE AUTHORITY
OF THE STATE OF ILLINOIS

DISTRICT ONE DESIGN PLAN PREPARATION ENGINEER:
KEN ENGROBERT BORO (847) 705-4718

F.A. RTE.	SECTION	COUNTY	TOTAL SHEETS	SHEET NO.
VAR.	2005-0191	COOK	9	2
STA. _____		TO STA. _____		
FED. ROAD DIST. NO. _____		ILLINOIS FED. AID PROJECT		

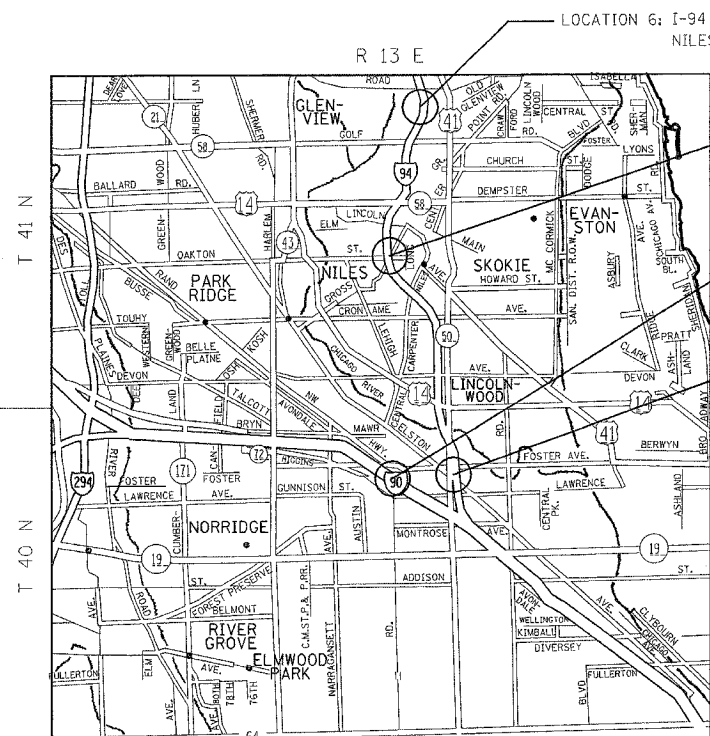

- LOCATION 6: I-94 (FAI 94) UNDER OLD ORCHARD ROAD (FAU 1310)
NILES TOWNSHIP, VILLAGE OF SKOKIE
- LOCATION 7: I-94 (FAI 94) UNDER OAKTON ST. (FAU 1332)
NILES TOWNSHIP, VILLAGE OF MORTON GROVE
- LOCATION 1: I-90 (FAI 90) & CTA R.R. UNDER CENTRAL AVE. (FAU 2798)
JEFFERSON TOWNSHIP, CITY OF CHICAGO
- LOCATION 5: I-94 (FAI 94) UNDER ELSTON AVE. (FAU 3528)
JEFFERSON TOWNSHIP, CITY OF CHICAGO

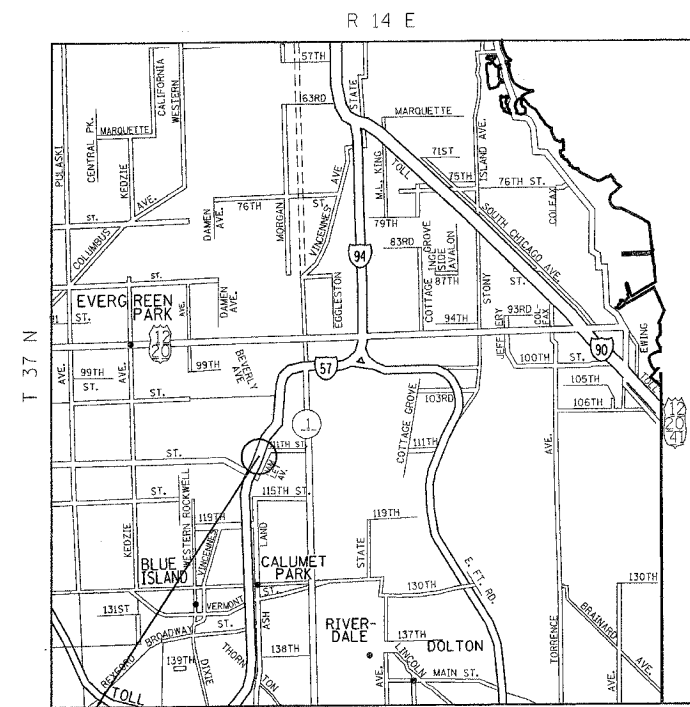

- LOCATION 8: I-57 (FAI 57) UNDER 112TH PL. (FAU 1581)
CALUMET TOWNSHIP, CITY OF CHICAGO
- LOCATION 9: I-57 (FAI 57) UNDER 111TH ST. (FAU 1582)
CALUMET TOWNSHIP, CITY OF CHICAGO

AVERAGE DAILY TRAFFIC

- LOCATION 1: 170,800 (2003) - I-90
- LOCATION 2: 89,800 (2004) - I-80
- LOCATION 3: 13,209 (2000) - MLK
- LOCATION 4: 13,209 (2000) - MLK
- LOCATION 5: 161,600 (2003) - I-94
- LOCATION 6: 144,100 (2003) - I-94
- LOCATION 7: 174,600 (2003) - I-94
- LOCATION 8: 107,600 (2003) - I-57
- LOCATION 9: 107,600 (2003) - I-57
- LOCATION 10: 137,200 (2003) - I-55
- LOCATION 11: 313,600 (2003) - I-90/94

STRUCTURE NUMBER

- LOCATION 1: 016-0659
- LOCATION 2: 016-2458
- LOCATION 3: 016-0036
- LOCATION 4: 016-1055
- LOCATION 5: 016-0610
- LOCATION 6: 016-0827
- LOCATION 7: 016-0823
- LOCATION 8: 016-0988
- LOCATION 9: 016-0989
- LOCATION 10: 016-0724
- LOCATION 11: 016-1154

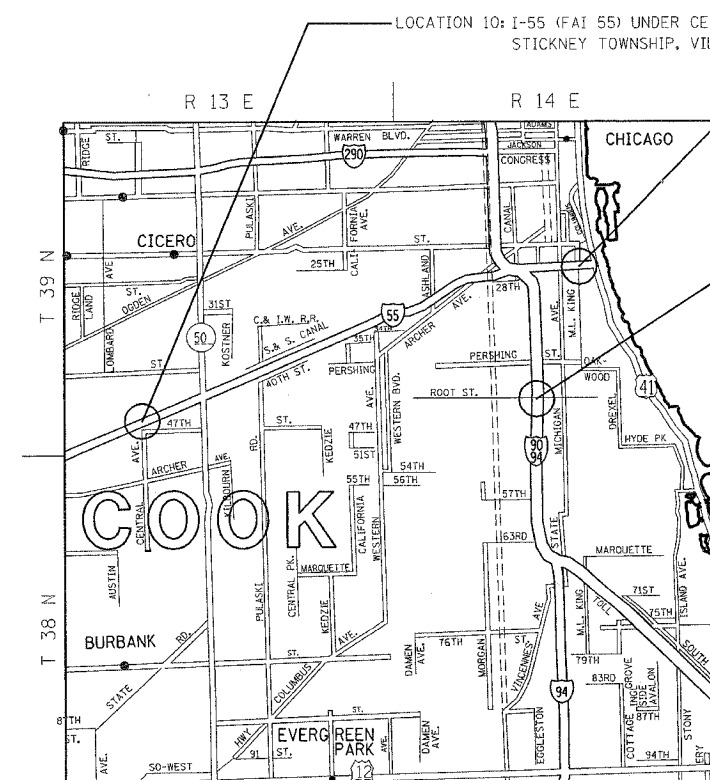

- LOCATION 10: I-55 (FAI 55) UNDER CENTRAL AVE. (FAU 2797)
STICKNEY TOWNSHIP, VILLAGE OF STICKNEY
- LOCATION 3: I-55 (FAI 55) EB OVER MLK. DRIVE (FAU 2915)
SOUTH CHICAGO TOWNSHIP, CITY OF CHICAGO
- LOCATION 4: I-55 (FAI 55) WB OVER MLK. DRIVE (FAU 2915)
SOUTH CHICAGO TOWNSHIP, CITY OF CHICAGO
- LOCATION 11: I-90/94 (FAI 94) & CTA R.R. UNDER ROOT ST. (MS 5981)
WEST CHICAGO TOWNSHIP, CITY OF CHICAGO

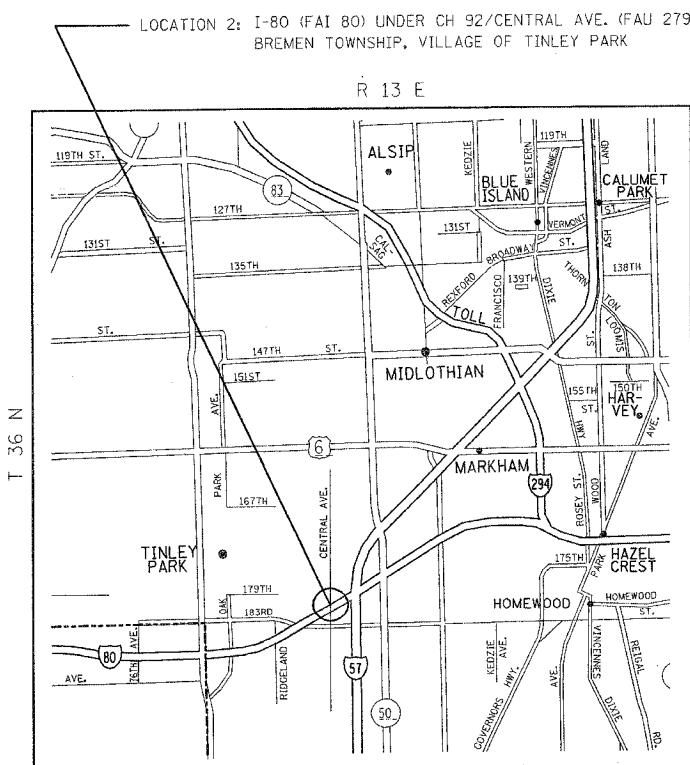

- LOCATION 2: I-80 (FAI 80) UNDER CH 92/CENTRAL AVE. (FAU 2795)
BREMEN TOWNSHIP, VILLAGE OF TINLEY PARK

PLOT DATE = 5/26/2005
 FILE NAME = c:\p\proj\62944\119305.dwg
 PLOT SCALE = 50:0000 / IN.
 USER NAME = schaniger



REVISIONS		ILLINOIS DEPARTMENT OF TRANSPORTATION
NAME	DATE	
		LOCATION MAP

SCALE: VERT. _____
 HORIZ. _____
 DATE _____ DRAWN BY _____
 CHECKED BY _____

F.A. RTE.	SECTION	COUNTY	TOTAL SHEETS	SHEET NO.
VAR.	2005-019I	COOK	9	3
STA. _____		TO STA. _____		
FED. ROAD DIST. NO. _____		ILLINOIS	FED. AID PROJECT	

INDEX OF SHEETS

1. TITLE SHEET
2. LOCATION MAP
3. INDEX OF SHEETS, STATE STANDARDS AND GENERAL NOTES
4. SUMMARY OF QUANTITIES
- 5.-7. LOCATION DETAILS
8. PERMANENT PROTECTIVE SHIELD DETAILS
9. TRAFFIC CONTROL FOR PARTIAL RAMP AND SHOULDER CLOSURES

LIST OF STATE STANDARDS

- 701400-02 APPROACH TO LANE CLOSURE, FREEWAY/EXPRESSWAY
 701401-03 LANE CLOSURE, FREEWAY/EXPRESSWAY
 701446 TWO LANE CLOSURE, EXPRESSWAY
 702001-05 TRAFFIC CONTROL DEVICES

GENERAL NOTES

BEFORE STARTING ANY EXCAVATION, THE CONTRACTOR SHALL CALL "J.U.L.I.E." AT (800) 892-0123 OR "C.U.A.N." AT (312) 744-7000 FOR FIELD LOCATIONS OF BURIED ELECTRIC, TELEPHONE AND GAS UTILITIES.
 48 HOUR NOTIFICATION PRIOR TO START OF WORK IS REQUIRED.

DO NOT SCALE PLANS FOR CONSTRUCTION DIMENSIONS

THE CONTRACTOR SHALL CONTACT THE DISTRICT ONE TRAFFIC CONTROL SUPERVISOR AT (847) 705-4151 A MINIMUM OF 72 HOURS IN ADVANCE OF BEGINNING WORK.

THE CONTRACTOR SHALL BE AWARE THAT SOME LOCATIONS HAVE UTILITY CONDUITS. ANY DAMAGE TO THE CONDUITS CAUSED BY THE CONTRACTOR'S OPERATIONS SHALL BE REPLACED OR REPAIRED BY THE CONTRACTOR AT THEIR EXPENSE. THE CONTRACTOR SHALL ADJUST THE PROTECTIVE SHIELDING TO FIT AROUND THE CONDUITS. DETAILS SHALL BE APPROVED BY THE ENGINEER BEFORE INSTALLATION. THE CONTRACTOR SHALL COORDINATE CONSTRUCTION ACTIVITIES WITH UTILITY COMPANIES.

PLAN DIMENSIONS AND DETAILS RELATIVE TO EXISTING STRUCTURES HAVE BEEN TAKEN FROM

EXISTING PLANS AND ARE SUBJECT TO NOMINAL VARIATIONS FROM WHAT IS ACTUALLY EXISTING. IT SHALL BE THE CONTRACTORS RESPONSIBILITY TO VERIFY SUCH DIMENSIONS AND DETAILS IN THE FIELD AND MAKE NECESSARY APPROVED ADJUSTMENTS PRIOR TO CONSTRUCTION OR ORDERING OF MATERIALS. SUCH VARIATIONS SHALL NOT CAUSE FOR ADDITIONAL COMPENSATION FOR A CHANGE IN THE SCOPE OF THE WORK. HOWEVER, THE CONTRACTOR WILL BE PAID FOR THE QUANTITY ACTUALLY FURNISHED AT THE UNIT PRICE BID FOR THE WORK.

WHEN ARTIFICIAL LIGHTING IS UTILIZED IN NIGHT OPERATIONS, THE CONTRACTOR SHALL EXERCISE THE UTMOST PRECAUTIONS IN PREVENTING ADVERSE VISIBILITY TO THE MOTORING PUBLIC AND ADJOINING RESIDENTIAL AREAS.

THE CONTRACTOR SHALL ADJUST THE PROTECTIVE SHIELDING TO RIDE ABOVE THE EXISTING LIGHTING FIXTURES IN ORDER TO MAINTAIN THE EXISTING LEVEL OF LIGHTING OF THE ROADWAY UNDERNEATH. DETAILS SHALL BE APPROVED BY THE ENGINEER BEFORE INSTALLATION.

THESE PLANS HAVE BEEN PREPARED FROM NOTES RECEIVED FROM BRIDGE INSPECTORS

REVISIONS	
NAME	DATE

ILLINOIS DEPARTMENT OF TRANSPORTATION

INDEX OF SHEETS, GENERAL NOTES,
STATE STANDARDS

SCALE: VERT.
HORIZ.
DATE

DRAWN BY
CHECKED BY

62944

F.A. RTE.	SECTION	COUNTY	TOTAL SHEETS	SHEET NO.
VAR. 2005-0191		COOK	9	4
FED. ROAD DIST. NO. 1		ILLINOIS	HIGHWAY PROJECT	

SUMMARY OF QUANTITIES			CONSTRUCTION TYPE CODE SFTY-2A																		
CODE NO	ITEM	UNIT	URBAN TOTAL QUANTITIES	LOC. 1 016-0659	LOC. 2 016-2458	LOC. 3 016-0036	LOC. 4 016-1055	LOC. 5 016-0610	LOC. 6 016-0827	LOC. 7 016-0823	LOC. 8 016-0988	LOC. 9 016-0989	LOC. 10 019-0724	LOC. 11 016-1154							
67100100	MOBILIZATION	L SUM	1	0.1	0.09	0.09	0.09	0.09	0.09	0.09	0.09	0.09	0.09	0.09							
70101700	TRAFFIC CONTROL AND PROTECTION	L SUM	1			0.5	0.5														
X0322066	PROTECTIVE SHIELD (PERMANENT)	SQ YD	12,038	1281	456	1750	1750	986	700	358	995	938	1230	1594							
X7011015	TRAFFIC CONTROL AND PROTECTION (EXPRESSWAYS)	L SUM	1	0.11	0.11			0.11	0.11	0.11	0.11	0.11	0.11	0.12							
Z0048665	RAILROAD PROTECTIVE LIABILITY INSURANCE	L SUM	1	0.5										0.5							

REVISIONS	
NAME	DATE

ILLINOIS DEPARTMENT OF TRANSPORTATION
SUMMARY OF QUANTITIES

5/26/2005 5:00 PM

F.A. RTE.	SECTION	COUNTY	TOTAL SHEETS	SHEET NO.
VAR.	2005-0191	COOK	9	5
STA.		TO STA.		
FED. ROAD DIST. NO.		ILLINOIS FED. AID PROJECT		

LOCATION 1
CENTRAL AVE/I-90
SN 016-0659

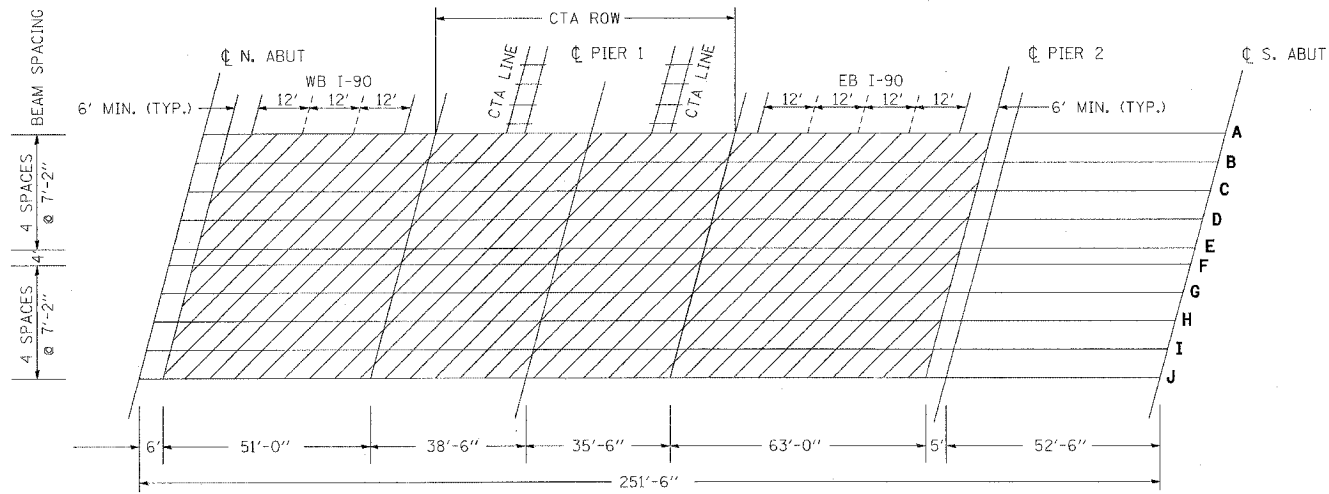
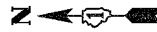

LOCATION 2
CENTRAL AVE./I-80
SN 016-2458

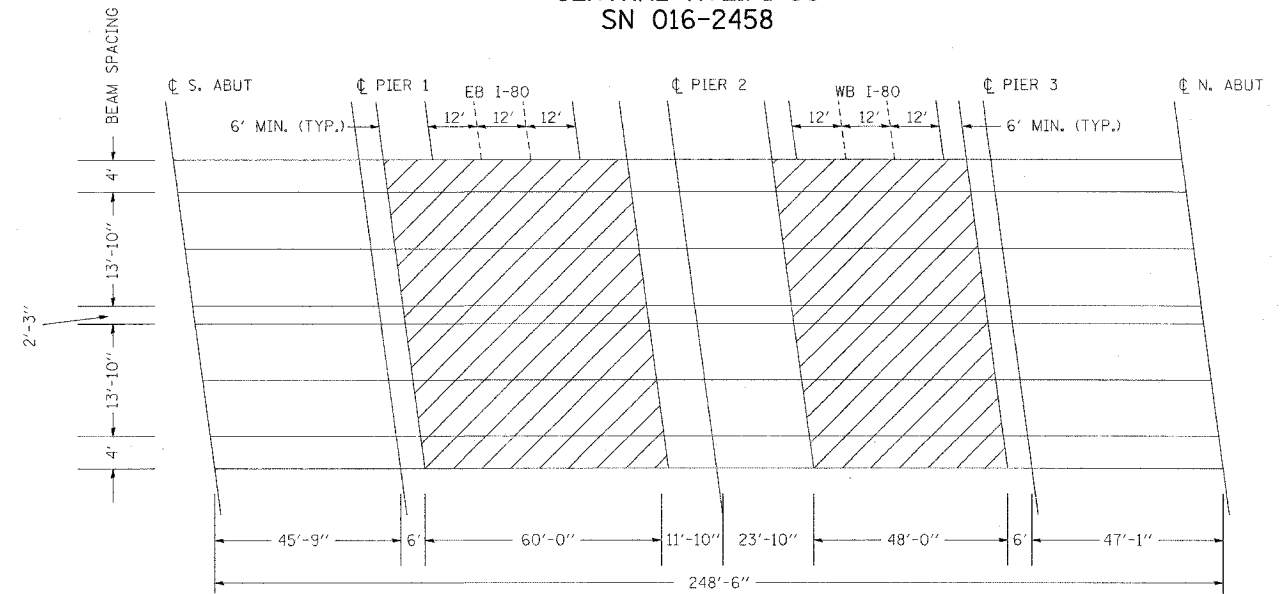

LOCATION 3
I-55 EB/MARTIN LUTHER KING DR.
SN 016-0036

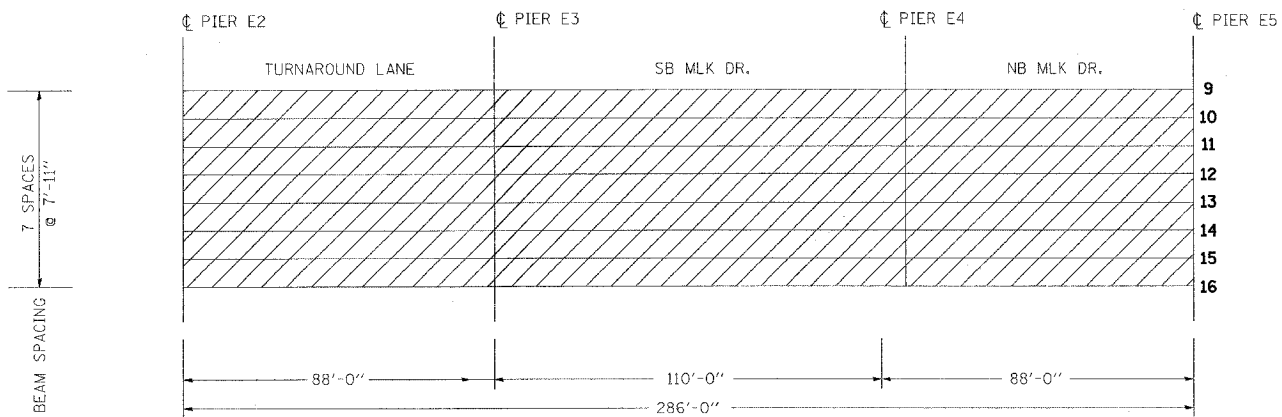

LOCATION 4
I-55 WB/MARTIN LUTHER KING DR.
SN 016-1055

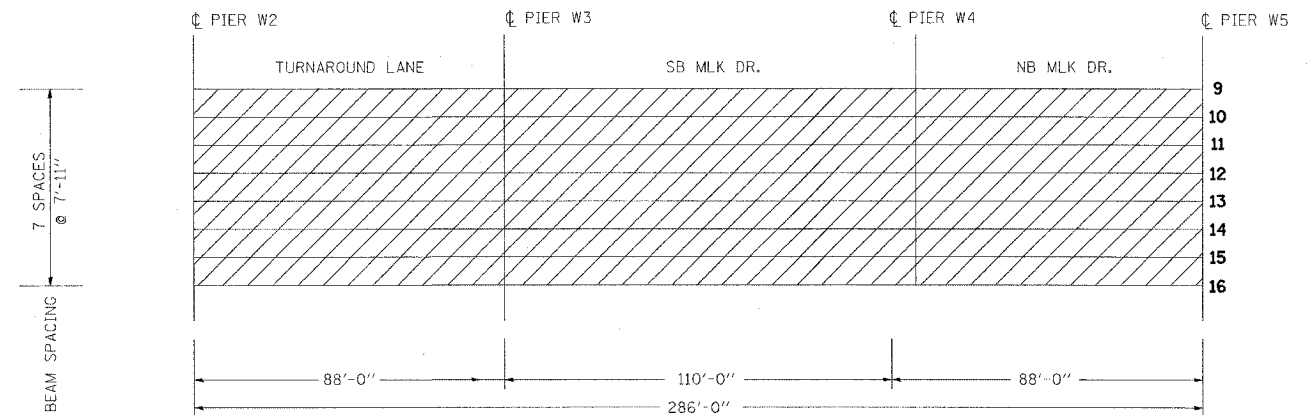

REVISIONS	
NAME	DATE

ILLINOIS DEPARTMENT OF TRANSPORTATION

LOCATIONS 1, 2, 3 AND 4

SCALE: VERT. _____
HORIZ. _____

DATE _____ DRAWN BY _____
CHECKED BY _____

PLOT DATE = 5/27/2005
FILE NAME = c:\pwork\jerry\dl18395\dl18395.dgn
USER NAME = jerry

CONTRACT NO. 62944				
F.A. RTE.	SECTION	COUNTY	TOTAL SHEETS	SHEET NO.
VAR.	2005-0191	COOK	9	6
STA.	TO STA.			
FED. ROAD DIST. NO.	ILLINOIS FED. AID PROJECT			

LOCATION 5
ELSTON/I-94
SN 016-0610

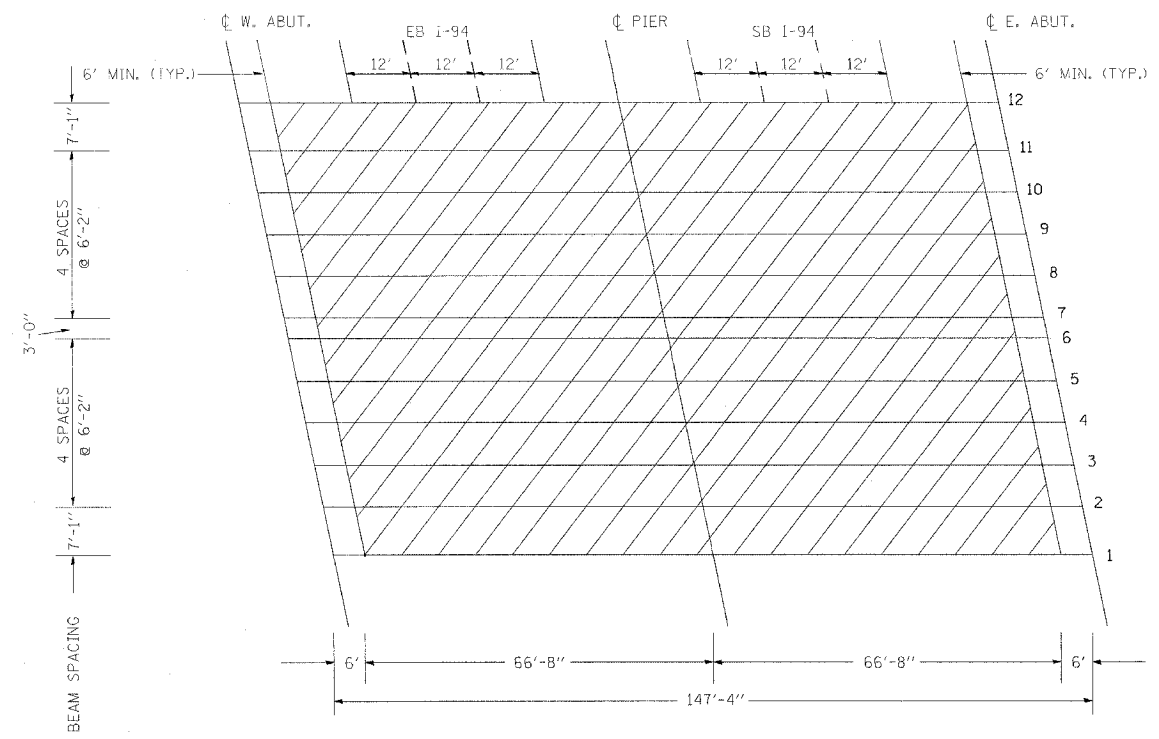

LOCATION 6
OAKTON ST. /I-94
SN 016-0827

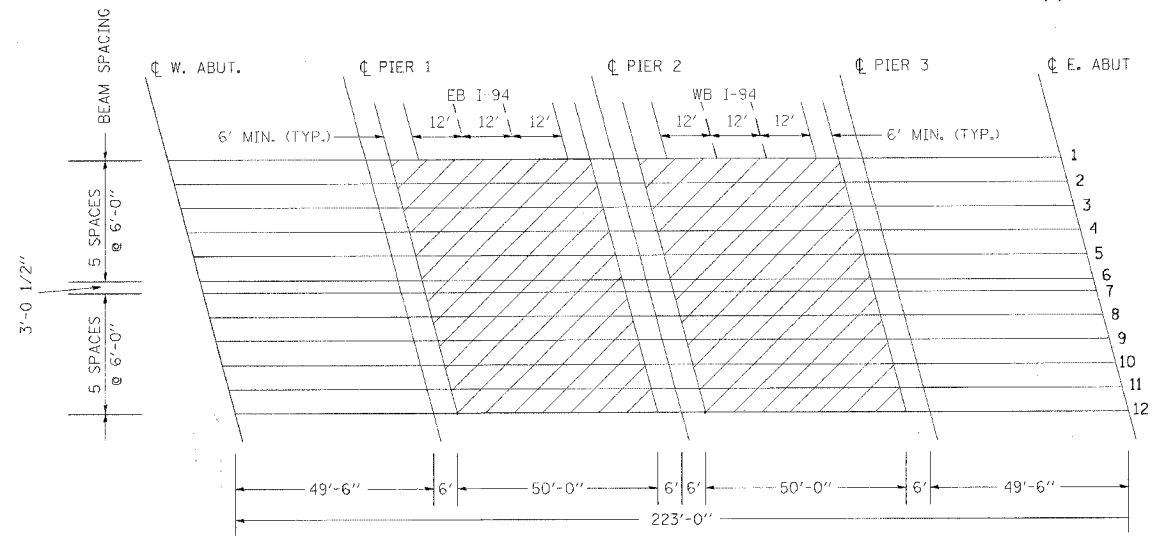

LOCATION 7
OLD ORCHARD RD. /I-94
SN 016-0823

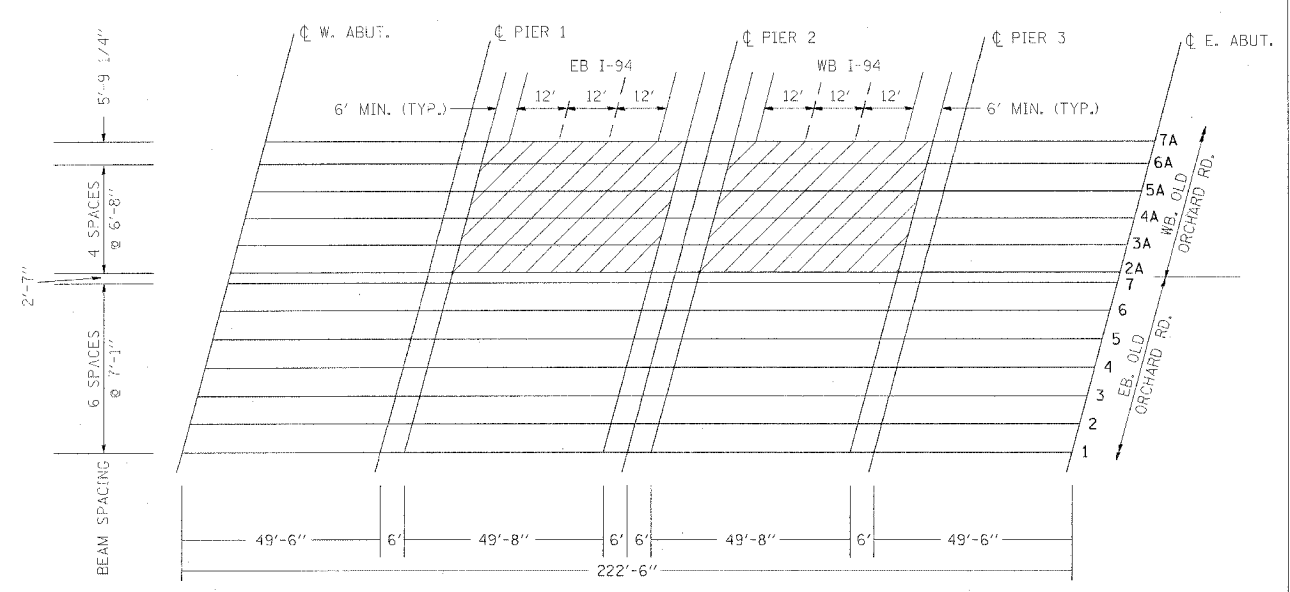

LOCATION 8
112TH PL/I-57
SN 016-0988

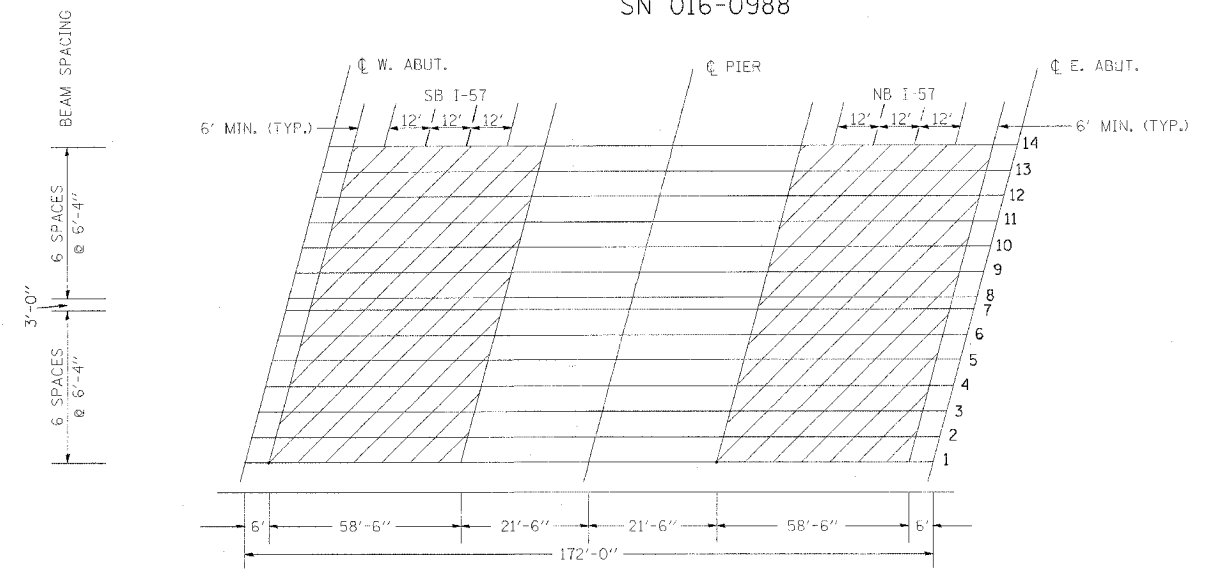

REVISIONS	
NAME	DATE

ILLINOIS DEPARTMENT OF TRANSPORTATION

LOCATIONS 5, 6, 7 AND 8

SCALE: VERT. HORIZ.
DATE

DRAWN BY
CHECKED BY

PLOT DATE = 6/9/2005
PLOT SCALE = 1" = 10'-0"
USER NAME = 11010101

IF-A- RTE.	SECTION	COUNTY	TOTAL SHEETS	SHEET NO.
VAR.	2005-0191	COOK	9	7
STA.	TO STA.			
FED. ROAD DIST. NO.	ILLINOIS	FED. AID PROJECT		

LOCATION 9
111TH ST/I-57
SN 016-0989

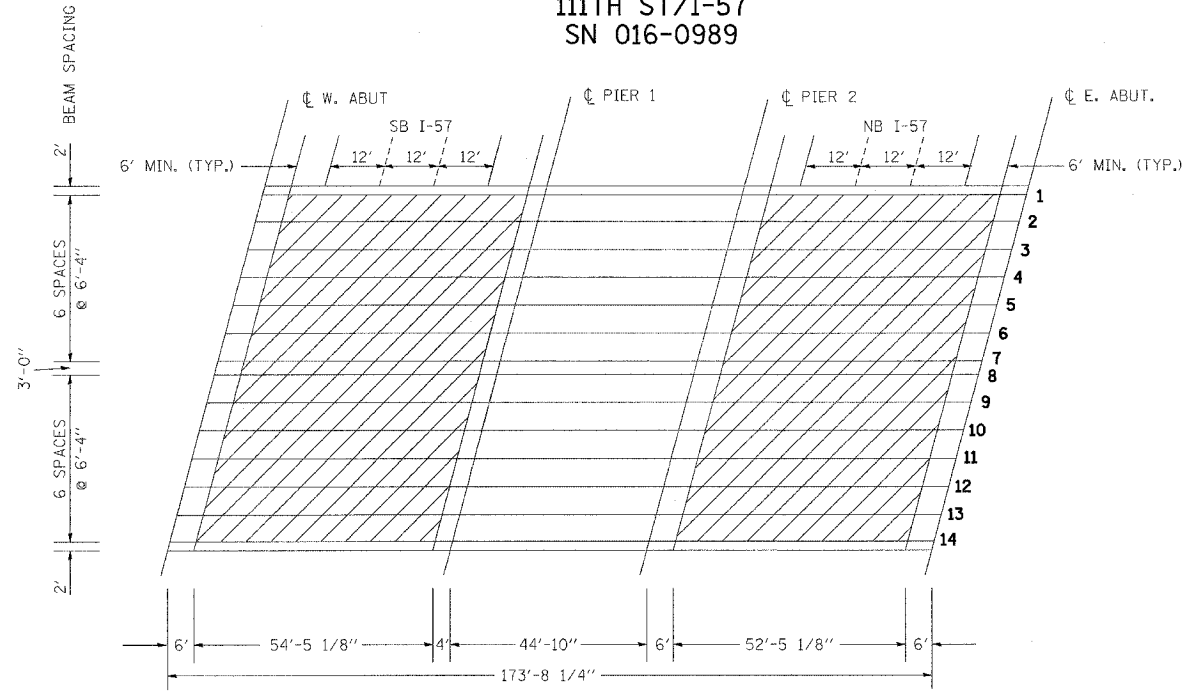

LOCATION 10
CENTRAL/I-55
SN 016-0724

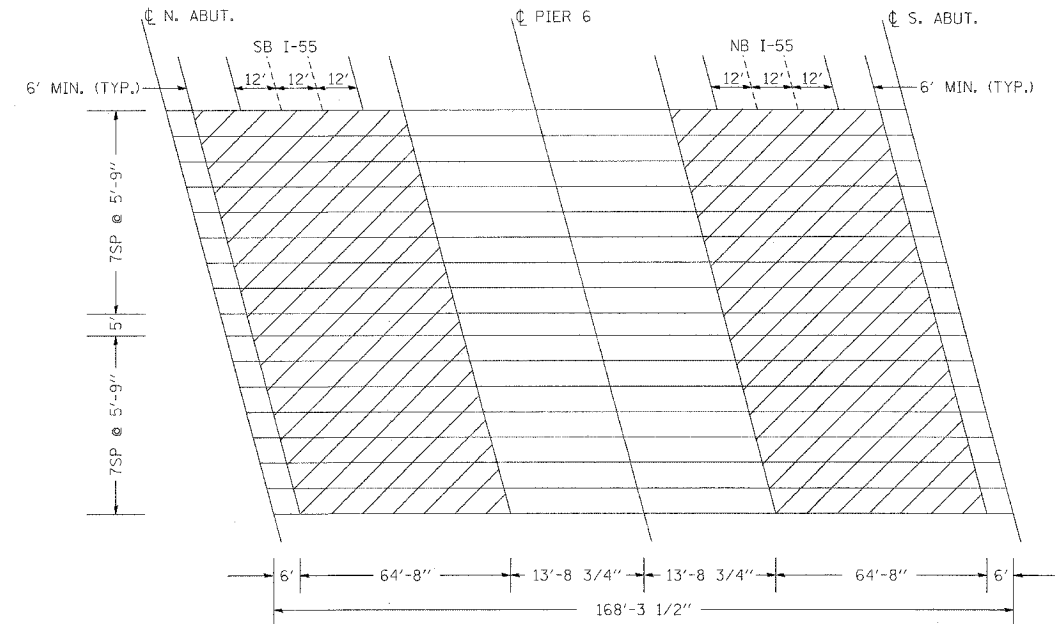

LOCATION 11
ROOT ST/I-90/94
SN 016-1154

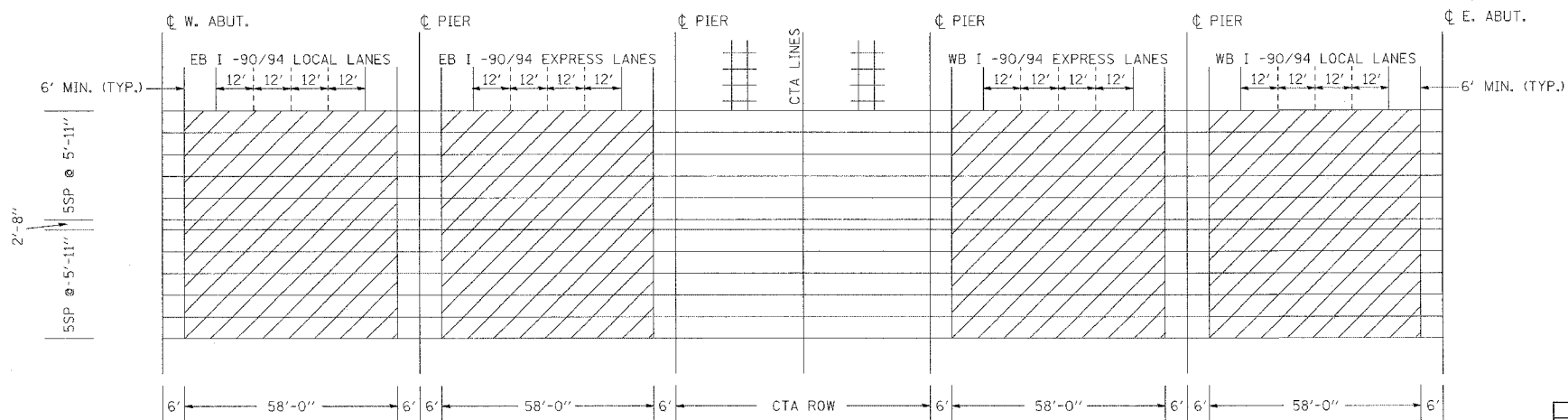

REVISIONS	
NAME	DATE

ILLINOIS DEPARTMENT OF TRANSPORTATION

LOCATIONS 9, 10 AND 11

SCALE: VERT. _____
HORIZ. _____

DATE _____ DRAWN BY _____
CHECKED BY _____

PLOT DATE = 5/26/2005
PLOT SCALE = 50,000 / IN.
USER NAME = stanlay

SECTION	COUNTY	TOTAL SHEETS	SHEET NO.
2005-0191	COOK	9	8
STA. _____ TO STA. _____			
FED. ROAD DIST. NO. _____ ILLINOIS FED. AID PROJECT			

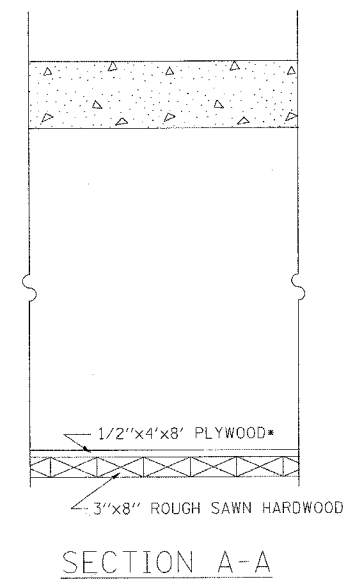
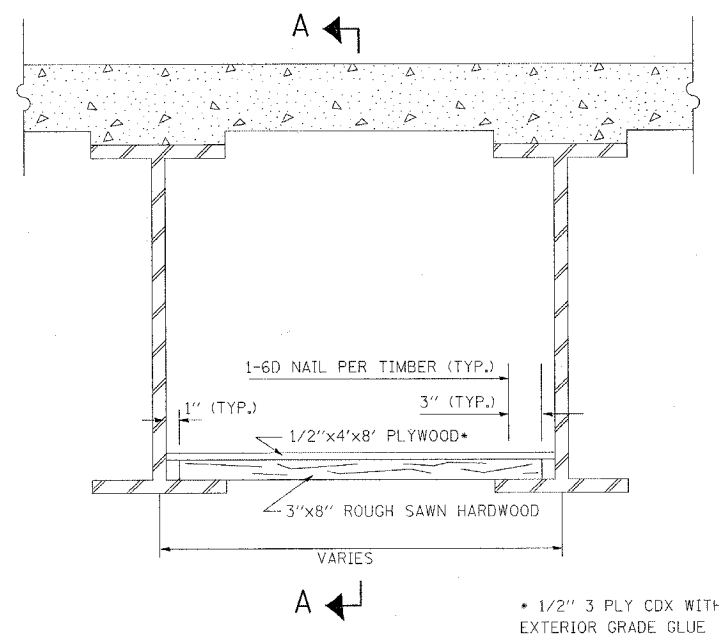

REVISIONS	
NAME	DATE

ILLINOIS DEPARTMENT OF TRANSPORTATION

PERMANENT PROTECTIVE SHIELD
DETAILS

SCALE: VERT. _____
HORIZ. _____

DATE _____ DRAWN BY _____
CHECKED BY _____

PLOT DATE = 5/26/2005
 PLOT SCALE = 1/8"=1'-0"
 USER NAME = atc/leg

PARTIAL RAMP CLOSURE DETAILS

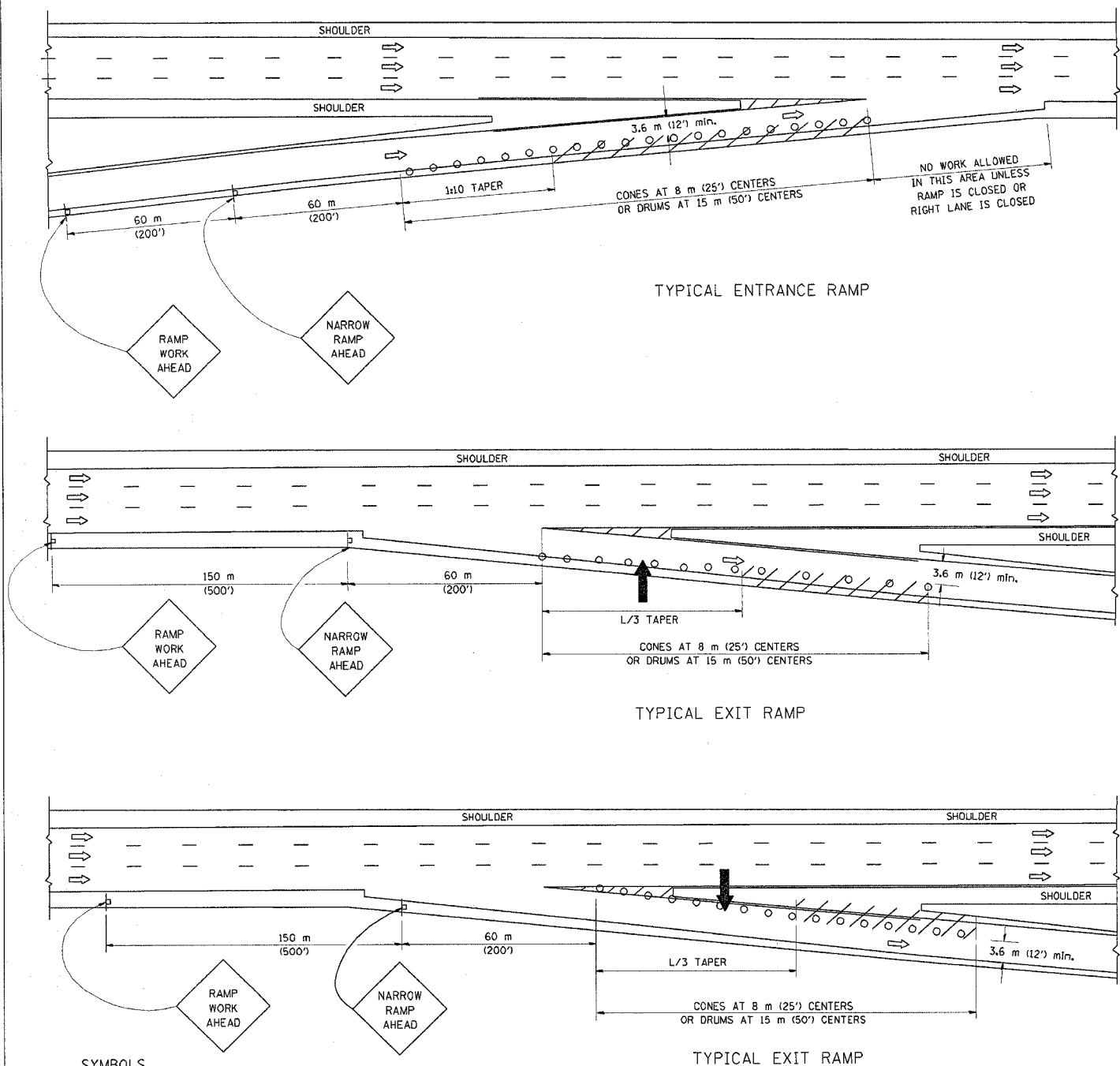

TYPICAL ENTRANCE RAMP

TYPICAL EXIT RAMP

TYPICAL EXIT RAMP

SYMBOLS

- ARROWBOARD
- WORK AREA
- SIGN ON PORTABLE OR PERMANENT SUPPORT
- FLAGGER WITH CONTROL SIGN
- DRUM WITH MONO-DIRECTIONAL STEADY BURNING LIGHT
- CONES - 700 (28) IN HEIGHT

GENERAL NOTES

1. THE "L" DISTANCE EQUALS:

SPEED LIMIT	FORMULAS
80 km/h (45 mph)	METRIC ENGLISH
OR GREATER:	L=0.65(W)(S) L=(W)(S)

W = WIDTH OF OFFSET IN METERS (FEET)
S = NORMAL POSTED SPEED KM/H (MPH)
2. PLASTIC DRUMS WITH HIGH PERFORMANCE REFLECTIVE SHEETING AND STEADY BURNING LIGHTS ARE REQUIRED FOR ALL NIGHTTIME CLOSURES.
3. ALL SIGNS SHALL BE POST MOUNTED IF THE CLOSURE TIME EXCEEDS FOUR DAYS.
4. FLASHING LIGHTS SHALL BE USED DURING THE HOURS OF DARKNESS AND SHALL BE INSTALLED ABOVE THE FIRST TWO SETS OF SIGNS.

SHOULDER CLOSURE DETAILS

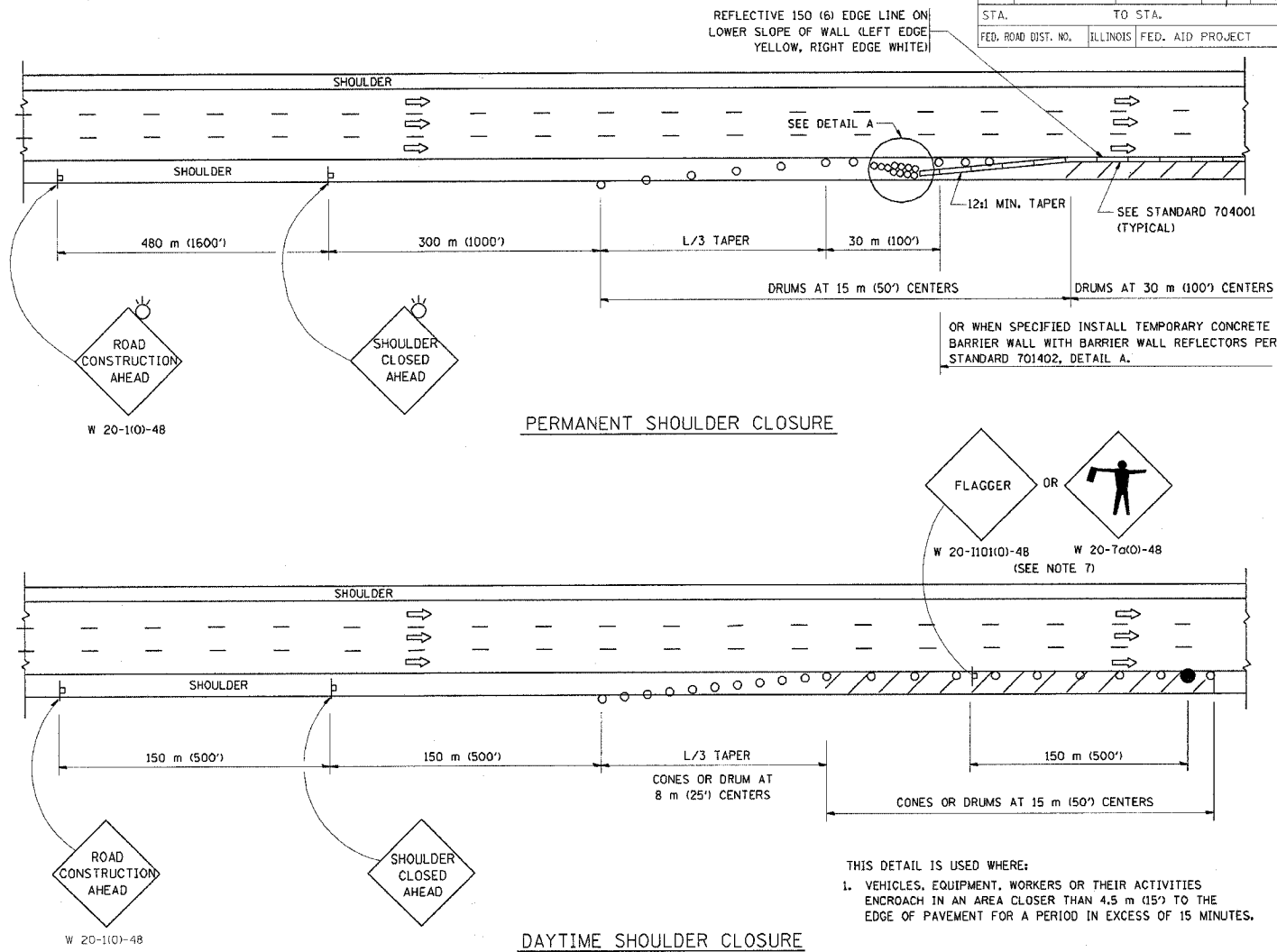

PERMANENT SHOULDER CLOSURE

DAYTIME SHOULDER CLOSURE

THIS DETAIL IS USED WHERE:
1. VEHICLES, EQUIPMENT, WORKERS OR THEIR ACTIVITIES ENCRDACH IN AN AREA CLOSER THAN 4.5 m (15') TO THE EDGE OF PAVEMENT FOR A PERIOD IN EXCESS OF 15 MINUTES.

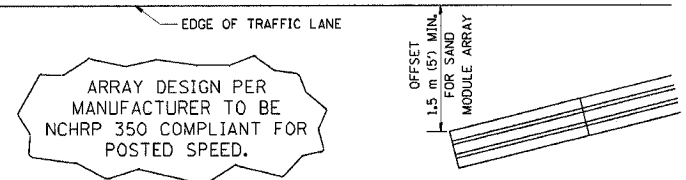

DETAIL "A"
IMPACT ATTENUATOR, TEMPORARY
(SEE NOTE 5)

5. THE IMPACT ATTENUATOR, TEMPORARY IS NOT REQUIRED WHEN THE TEMPORARY CONCRETE BARRIER WALL IS OUTSIDE THE CLEAR ZONE OR IS TIED INTO THE EXISTING GUARDRAIL. IF OFFSET IS LESS THAN 5 FEET USE "TRAFFIC BARRIER TERMINAL, TYPE III, TEMPORARY" DEVICE TO MEET NCHRP350 FOR POSTED SPEED.
6. AUTHORIZATION FROM THE DISTRICT'S BUREAU OF TRAFFIC IS REQUIRED FOR ALL FREEWAY CLOSURES.
7. THE FLAGGER AND FLAGGER SIGN ARE REQUIRED AT THE ABOVE WORK SITES WHEN:
 - a. FOUR OR MORE WORK VEHICLES ENTER THE TRAFFIC LANES IN A ONE HOUR PERIOD.
 - b. THE WORK AVTIVITY REQUIRES FREQUENT ENCRDACHMENT INTO THE LANE OPEN TO TRAFFIC.
 THE FLAGGER SHALL BE STATIONED APPROXIMATELY 30 m (100') TO 60 m (200') IN ADVANCE OF THE WORKERS.

F.A. RTE.	SECTION	COUNTY	TOTAL SHEETS	SHEET NO.
			9	9
STA.	TO STA.			
FED. ROAD DIST. NO.	ILLINOIS	FED. AID PROJECT		

REVISIONS	
NAME	DATE
DWS	11/96
JAF	12/02
NCHRP 350	04/03

ALL DIMENSIONS ARE IN MILLIMETERS (INCHES) UNLESS OTHERWISE SHOWN.
ILLINOIS DEPARTMENT OF TRANSPORTATION

TRAFFIC CONTROL DETAILS
FOR FREEWAY
SHOULDER CLOSURES
PARTIAL RAMP CLOSURES

SCALE: NONE
DATE: 05/06/2003
DRAWN BY: DWS
DESIGNED BY:
CHECKED BY:
TC-17