

F.A.P. RTE.	SECTION	COUNTY	TOTAL SHEETS	SHEET NO.
307	541X-I	COOK	7	1

STATE OF ILLINOIS
DEPARTMENT OF TRANSPORTATION
DIVISION OF HIGHWAYS

**PROPOSED
HIGHWAY PLANS**

F.A.P. 307: IL 64 (NORTH AVENUE)

73RD AVENUE TO 73RD COURT

SECTION: 541X-I

CURB AND MEDIAN REPAIR (MAINTENANCE)

COOK COUNTY

C-91-184-05

FOR INDEX OF SHEETS, SEE SHEET NO. 2

IMPROVEMENT LOCATED IN THE VILLAGE OF ELMWOOD PARK

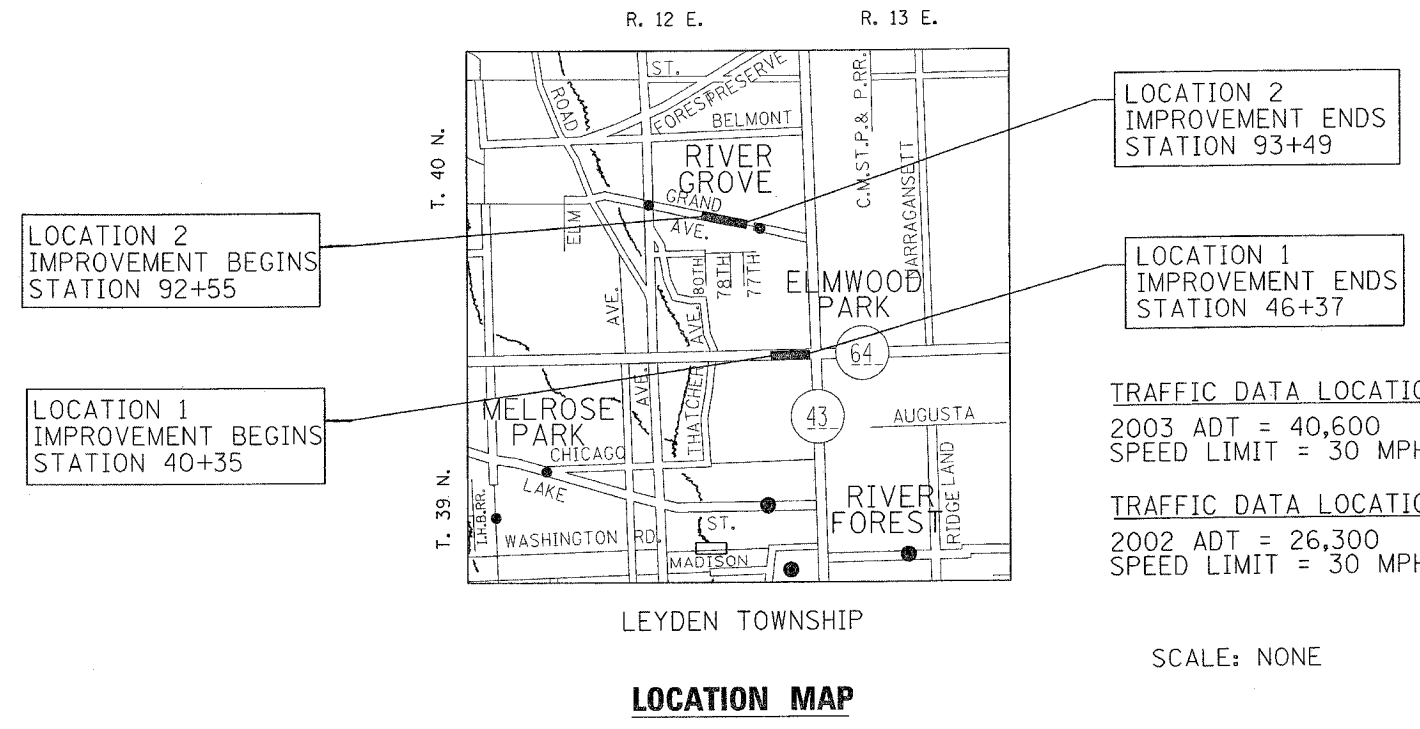
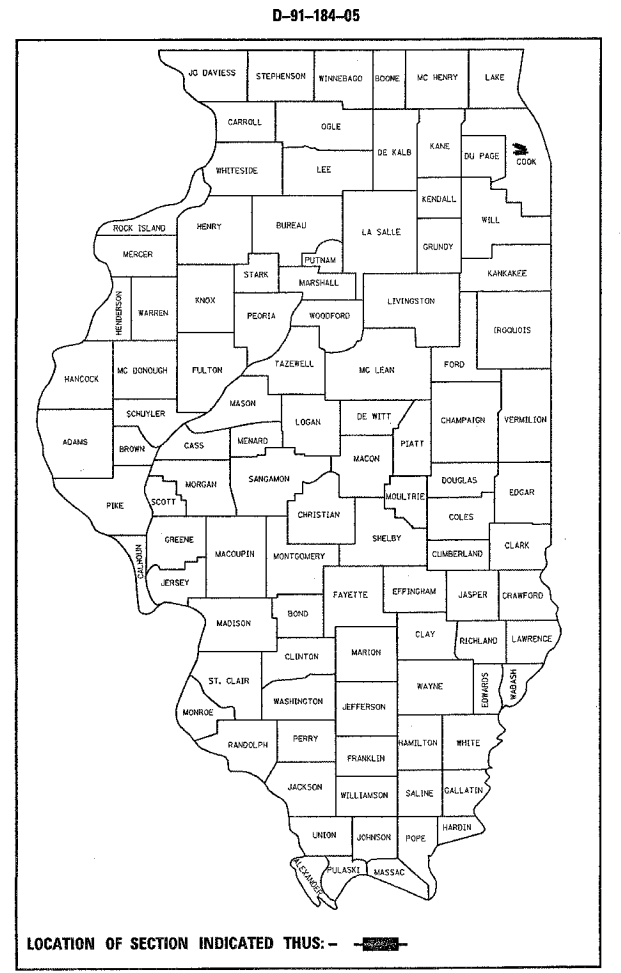

LOC. 1 - GROSS LENGTH = 602 FEET = .11 MILE
LOC. 2 - GROSS LENGTH = 94 FEET = .02 MILE
NET LENGTH = 696 FEET = .13 MILE

STATE OF ILLINOIS
DEPARTMENT OF TRANSPORTATION
DIVISION OF HIGHWAYS

SUBMITTED June 6, 20 05

Dina O'Keefe
DEPUTY DIRECTOR OF HIGHWAYS, REGION ENGINEER

July 1, 20 05
Mike Nune
ENGINEER OF DESIGN AND ENVIRONMENT

July 1, 20 05
Victor Mader
DIRECTOR OF HIGHWAYS, CHIEF ENGINEER

**PRINTED BY THE AUTHORITY
OF THE STATE OF ILLINOIS**

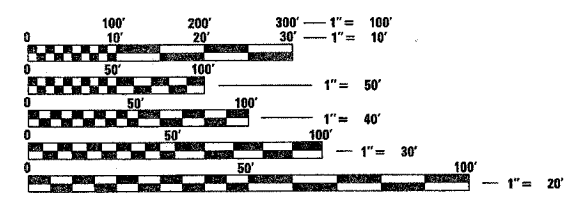

FULL SIZE PLANS HAVE BEEN PREPARED USING STANDARD ENGINEERING SCALES. REDUCED SIZED PLANS WILL NOT CONFORM TO STANDARD SCALES. IN MAKING MEASUREMENTS ON REDUCED PLANS, THE ABOVE SCALES MAY BE USED.

J.U.L.I.E.
JOINT UTILITY LOCATION INFORMATION FOR EXCAVATION
1-800-892-0123

CONTRACT NO. 62945

DISTRICT 1 DESIGN - PLAN PREP ENGINEER: KEN ENG / J.P. CHANG (847) 705-4432

F.A.P. RTE.	SECTION	COUNTY	TOTAL SHEETS	SHEET NO.
307	541X-I	COOK	7	2
STA.		TO STA.		
FED. ROAD DIST. NO.		ILLINOIS FED. AID PROJECT		

SHEET NO.	DESCRIPTION
1.	TITLE SHEET
2.	INDEX OF SHEETS, STATE STANDARDS, AND GENERAL NOTES
3.	SUMMARY OF QUANTITIES
4.	TYPICAL SECTIONS
5.	ROADWAY PLAN
6.	TRAFFIC CONTROL AND PROTECTION FOR SIDE ROADS, INTERSECTIONS, AND DRIVEWAYS
7.	TEMPORARY INFORMATION SIGNING

STANDARDS	
000001-04	STANDARD SYMBOLS, ABBREVIATIONS AND PATTERNS
606301-02	PC CONCRETE ISLANDS AND MEDIANS
606306-01	CORRUGATED PC CONCRETE MEDIANS
701206-01	LANE CLOSURE, 2L, 2W, NIGHT ONLY, FOR SPEEDS ≥ 45 MPH
701301-02	LANE CLOSURE, 2L, 2W SHORT TIME OPERATIONS
701601-04	URBAN LANE CLOSURE, MULTILANE 1W OR 2W WITH NONTRAVERSABLE MEDIAN
701606-04	URBAN LANE CLOSURE, MULTILANE 2W WITH MOUNTABLE MEDIAN
701701-04	URBAN LANE CLOSURE, MULTILANE INTERSECTION
702001-05	TRAFFIC CONTROL DEVICES

GENERAL NOTES

BEFORE STARTING ANY EXCAVATION, THE CONTRACTOR SHALL CALL "JULIE" AT 1-800-892-0123 FOR FIELD LOCATIONS OF BURIED ELECTRIC, TELEPHONE AND GAS FACILITIES. (48 HOURS NOTIFICATION IS REQUIRED)

THE CONTRACTOR SHALL COORDINATE CONSTRUCTION ACTIVITIES WITH UTILITY COMPANIES AND THE VILLAGE OF ELMWOOD PARK.

THE CONTRACTOR WILL NOT BE ALLOWED TO SET UP A YARD OR FIELD OFFICE ON STATE PROPERTY WITHOUT WRITTEN PERMISSION FROM THE DEPARTMENT.

3 METER (10') TRANSITIONS SHALL BE USED TO MATCH PROPOSED CURB AND GUTTER AND MEDIAN ITEMS OF WORK TO EXISTING CURB & GUTTER AND MEDIANS IN THE FIELD, UNLESS OTHERWISE SHOWN. THE TRANSITION SHALL BE PAID FOR AT THE CONTRACT UNIT PRICE FOR THE PROPOSED ITEMS OF WORK SPECIFIED.

THE RESIDENT ENGINEER SHALL CONTACT MR. SCOTT KUZNICKI, AREA TRAFFIC FIELD ENGINEER AT (773)685-8386 A MINIMUM OF 72 HOURS PRIOR TO PLACEMENT OF PERMANENT PAVEMENT MARKINGS.

THE RESIDENT ENGINEER SHALL VERIFY THE LOCATIONS OF ALL EXISTING PAVEMENT MARKINGS PRIOR TO START OF CONSTRUCTION.

REVISIONS	
NAME	DATE

ILLINOIS DEPARTMENT OF TRANSPORTATION

INDEX OF SHEETS,
STATE STANDARDS,
AND GENERAL NOTES

SCALE: VERT.
DATE: HORIZ.

DRAWN BY
CHECKED BY

PLOT DATE = 6/13/2005
FILE NAME = c:\p\projects\118405\118405.dwg
PLOT SCALE = 80.14% / IN.
REFERENCE = #REF#

62945

F.A.P. RTE.	SECTION	COUNTY	TOTAL SHEETS	SHEET NO.
307	541X-1	COOK	7	3
FED. ROAD DIST. NO. 1		ILLINOIS	HIGHWAY PROJECT	

62945

SUMMARY OF QUANTITIES			URBAN TOTAL QUANTITIES	CONSTRUCTION TYPE CODE						
CODE NO	ITEM	UNIT		LOCATION 1		LOCATION 2				
				SFTY-2A 100% STATE	SFTY-2A 100% VILLAGE	SFTY-2A 100% STATE				
42101300	PROTECTIVE COAT	SQ YD	535	490	45					
44000300	CURB REMOVAL	FOOT	1150	1150						
44002020	CONCRETE MEDIAN SURFACE REMOVAL	SQ FT	3500	3500						
44003100	MEDIAN REMOVAL	SQ FT	340		340					
60600605	CONCRETE CURB, TYPE B	FOOT	1040	1040						
60618300	CONCRETE MEDIAN SURFACE, 4 INCH	SQ FT	3300	3300						
60624600	CORRUGATED MEDIAN	SQ FT	630	290	340					
67100100	MOBILIZATION	L SUM	1	0.6	0.4					
70100455	TRAFFIC CONTROL AND PROTECTION, STANDARD 701206	L SUM	1	0.6	0.4					
70102625	TRAFFIC CONTROL AND PROTECTION, STANDARD 701606	L SUM	1		1					
70102630	TRAFFIC CONTROL AND PROTECTION, STANDARD 701601	L SUM	1	1						
70102635	TRAFFIC CONTROL AND PROTECTION, STANDARD 701701	L SUM	1	0.5	0.5					
* 72400710	RELOCATE SIGN PANEL - TYPE 1	SQ FT	7.5	7.5						
* 78000200	THERMOPLASTIC PAVEMENT MARKING - LINE 4"	FOOT	1350	1350						
X0322256	TEMPORARY INFORMATION SIGNING	SQ FT	102.8	51.4	51.4					
X0322903	SAW CUTTING, (FULL DEPTH)	FOOT	1391	1187	204					
60617100	DOWEL BARS 1"	EACH	330	330	330					
X0325055	CONCRETE MEDIAN SURFACE, (STAMPING)	SQ FT	3300		3300					

SUMMARY OF QUANTITIES				CONSTRUCTION TYPE CODE							
CODE NO	ITEM	UNIT	TOTAL QUANTITIES								

* SPECIALTY ITEMS

REVISIONS	
NAME	DATE

ILLINOIS DEPARTMENT OF TRANSPORTATION
SUMMARY OF QUANTITIES

PLOT DATE: 6/13/2005

F.A.P. RTE.	SECTION	COUNTY	TOTAL SHEETS	SHEET NO.
307	541X-I	COOK	7	4

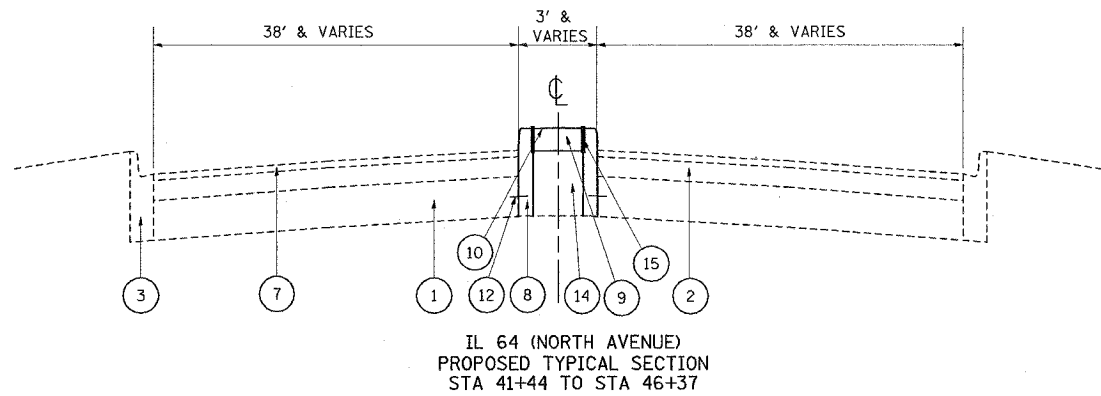
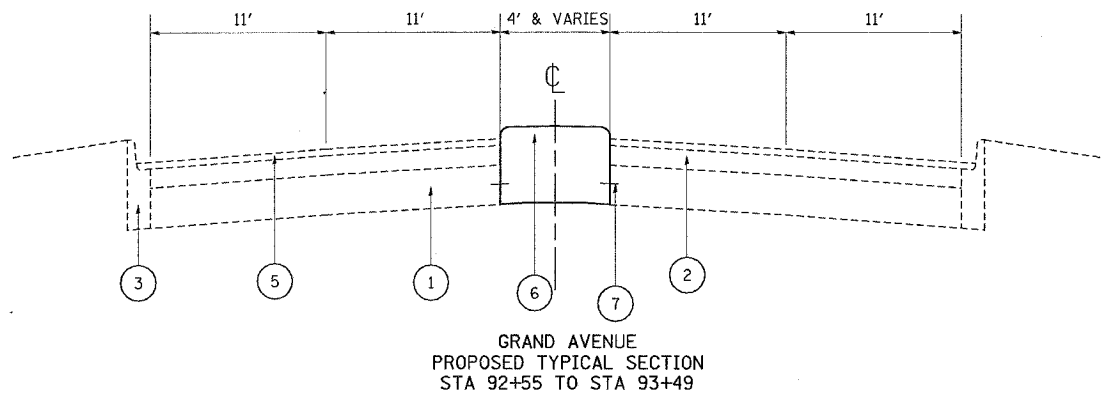
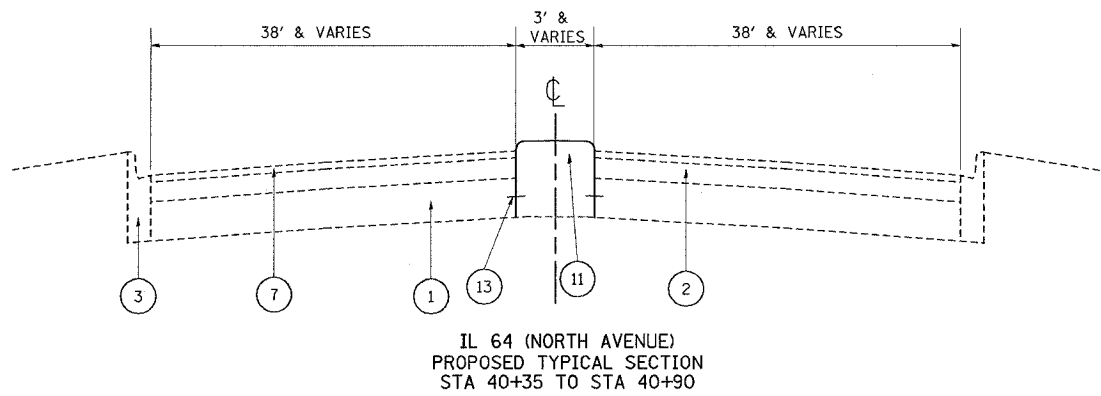
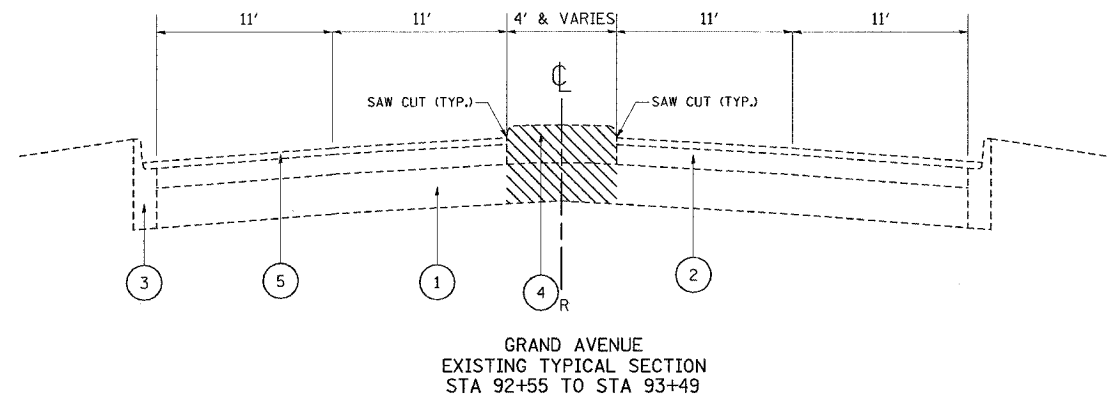
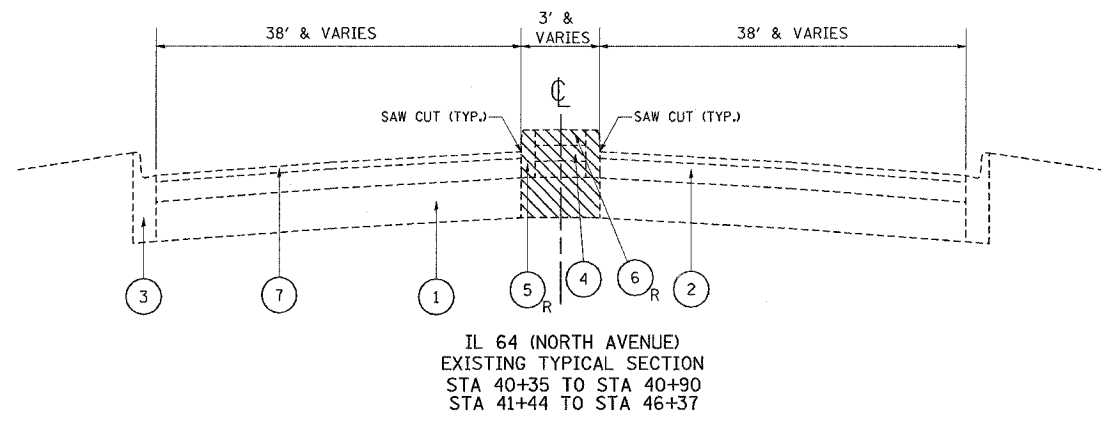

LEGEND

- ① EXIST. PCC PAVEMENT
 - ② EXIST. RESURFACING
 - ③ EXIST. COMB. CONCRETE CURB AND GUTTER, TYPE B-6.J2
 - ④ EXIST. CORRUGATED MEDIAN
 - ⑤ EXIST. BITUMINOUS SURFACE COURSE, MIX "D", CLASS 1, TYPE 2, 1 1/2"
 - ⑥ PROP. CORRUGATED MEDIAN
 - ⑦ PROP. DRILL AND GROUT #6 TIE BAR (24" C-C), COST INCLUDED IN CORRUGATED MEDIAN PAY ITEM
- R - DESIGNATED FOR REMOVAL

LEGEND

- ① EXIST. PCC PAVEMENT
 - ② EXIST. RESURFACING
 - ③ EXIST. COMB. CONCRETE CURB AND GUTTER, TYPE B-6.J2
 - ④ EXIST. CRUSHED STONE
 - ⑤ EXIST. PC CONCRETE CURB
 - ⑥ EXIST. PC CONCRETE MEDIAN SURFACE, 2 1/2"
 - ⑦ EXIST. BITUMINOUS SURFACE COURSE, MIX "E", CLASS 1, TYPE 2, 2 1/4"
 - ⑧ PROP. CONCRETE CURB, TYPE B
 - ⑨ PROP. CONCRETE MEDIAN SURFACE, 4"
 - ⑩ PROP. CONCRETE MEDIAN SURF. (STAMPING)
 - ⑪ PROP. CORRUGATED MEDIAN
 - ⑫ PROP. DRILL AND GROUT #4 TIE BAR, 90° SHAPE (24" C-C), COST INCLUDED IN CONCRETE CURB, TYPE B PAY ITEM
 - ⑬ PROP. DRILL AND GROUT #6 TIE BAR (24" C-C), COST INCLUDED IN CORRUGATED MEDIAN PAY ITEM
 - ⑭ PROP. COARSE AGGREGATE - FILL TO SUBGRADE (TYP.) COST INCLUDED IN CONC. MEDIAN SURFACE, 4 INCH PAY ITEM
 - ⑮ PROP. 5/8" PREFORMED EXPANSION JOINT FILLER - COST INCLUDED IN CONCRETE CURB, TYPE B PAY ITEM
- R - DESIGNATED FOR REMOVAL

REVISIONS	
NAME	DATE

ILLINOIS DEPARTMENT OF TRANSPORTATION

IL 64/GRAND AVE.
EXISTING AND PROPOSED
TYPICAL SECTIONS

SCALE: VERT. NONE
DATE: HORIZ.

DRAWN BY
CHECKED BY **R2**

F.A.P. RTE.	SECTION	COUNTY	TOTAL SHEETS	SHEET NO.
307	541X-I	COOK	7	5
STA. _____		TO STA. _____		
FED. ROAD DIST. NO. _____		ILLINOIS FED. AID PROJECT		

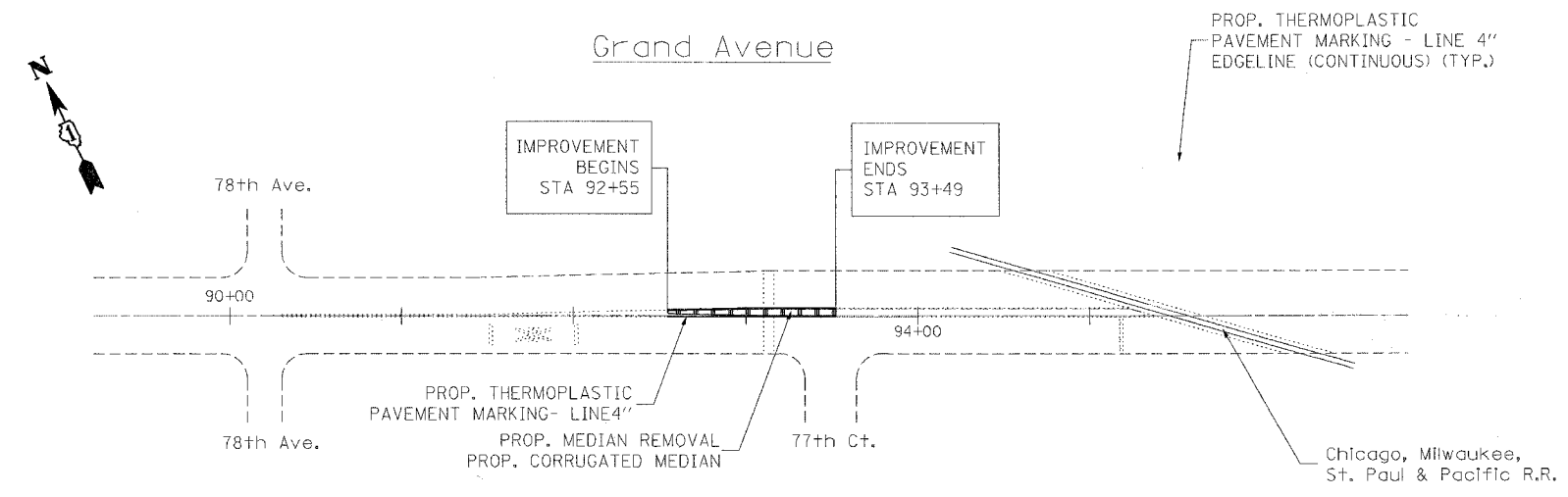
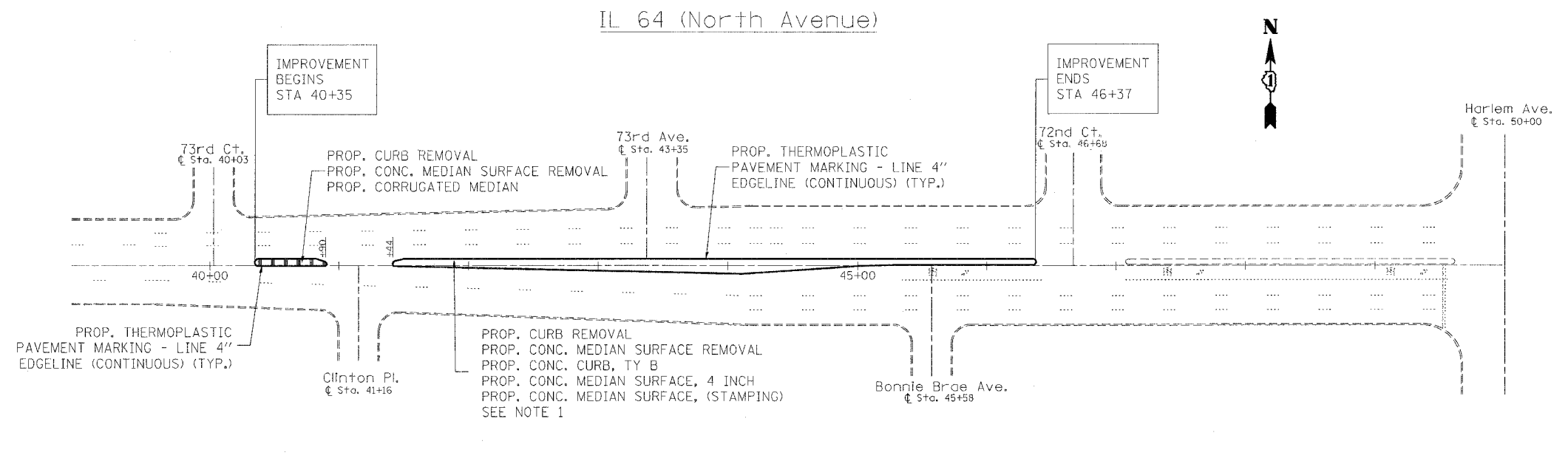

NOTE 1: MEDIAN NOSES SHALL BE RAMPED ACCORDING TO STANDARD 606301

REVISIONS	
NAME	DATE

ILLINOIS DEPARTMENT OF TRANSPORTATION

IL 64/GRAND AVENUE
PLAN DETAILS

SCALE: 1" = 50'

DATE _____ DRAWN BY _____ CHECKED BY _____

PLOT DATE = 06/15/2005
 FILE NAME = I:\11845\11845.dwg
 PLOT SCALE = 50.0000' / IN.
 USER NAME = smthk1

F.A.P. RTE.	SECTION	COUNTY	TOTAL SHEETS	SHEET NO.
307	541X-1	COOK	7	6
STA.		TO STA.		
FED. ROAD DIST. NO. 1		ILLINOIS	FED. AID PROJECT	

62945

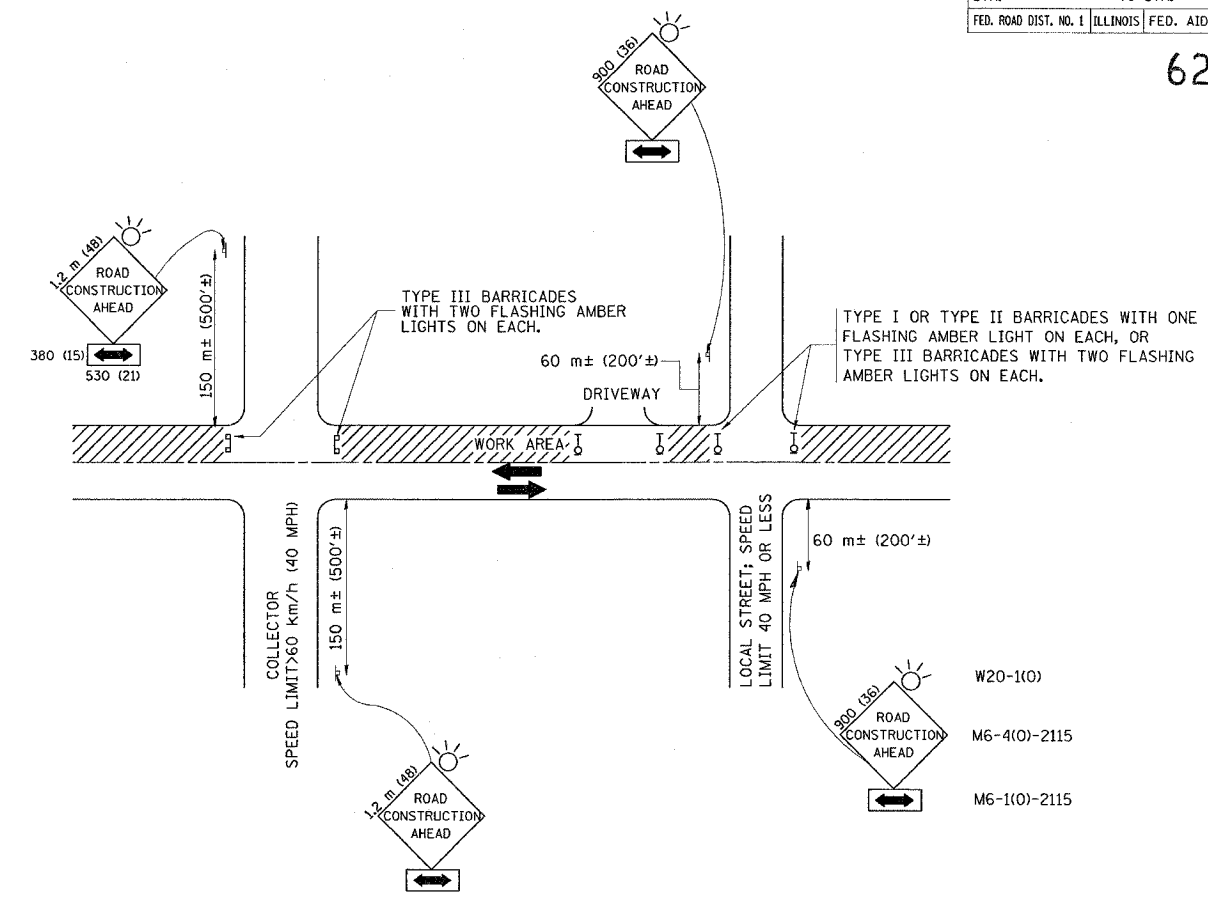

TRAFFIC CONTROL AND PROTECTION FOR SIDE ROADS, INTERSECTIONS, AND DRIVEWAYS

NOTES:

- A. FOR NO LANE RESTRICTION ON THE SIDE ROAD OR DRIVEWAYS
- SIDE ROAD WITH A SPEED LIMIT OF 60 km/h (40 MPH) OR LESS AS SHOWN ON THE DRAWING AND AS DIRECTED BY THE ENGINEER:
 - ONE **ROAD CONSTRUCTION AHEAD** SIGN 900x900 (36x36) WITH A FLASHER AND FLAG MOUNTED ON IT APPROXIMATELY 60 m (200') IN ADVANCE OF THE MAIN ROUTE.
 - THE CLOSED PORTION OF THE MAIN ROUTE SHALL BE PROTECTED BY BLOCKING WITH TYPE I, TYPE II OR TYPE III BARRICADES, 1/3 OF THE CROSS SECTION OF THE CLOSED PORTION.
 - SIDE ROAD WITH A SPEED LIMIT GREATER THAN 60 km/h (40 MPH) AS SHOWN ON THE DRAWING AND AS DIRECTED BY THE ENGINEER:
 - ONE **ROAD CONSTRUCTION AHEAD** SIGN 1.2 m x 1.2 m (48x48) WITH A FLASHER MOUNTED ON IT APPROXIMATELY 150 m (500') IN ADVANCE OF THE MAIN ROUTE.
 - THE CLOSED PORTION OF THE MAIN ROUTE SHALL BE PROTECTED BY BLOCKING WITH TYPE III BARRICADES, 1/2 OF THE CROSS SECTION OF THE CLOSED PORTION.
 - WHEN THE SIDE ROAD LIES BETWEEN THE BEGINNING OF THE MAINLINE SIGNING AND THE WORK ZONE, A SINGLE HEADED ARROW (M6-1) SHALL BE USED IN LIEU OF THE DOUBLE HEADED ARROW (M6-4).
- B. FOR A LANE CLOSURE ON A SIDE ROAD OR DRIVEWAY:
- USE APPLICABLE PORTIONS OF THE TYPICAL APPLICATION OF TRAFFIC CONTROL DEVICES (STD. 701501, STD. 701606 OR THE APPROPRIATE STANDARD). THE SPACING OF SIGNS AND BARRICADES SHALL BE ADJUSTED FOR FIELD CONDITIONS AS DIRECTED BY THE ENGINEER. THE DIRECTIONAL ARROW SHALL BE COVERED OR REMOVED WHEN NO LONGER CONSISTENT WITH THE SIDE ROAD LANE CLOSURE.
- C. ADVANCE WARNING SIGNS ARE TO BE OMITTED ON DRIVEWAY UNLESS OTHERWISE NOTED.
- D. THE TRAFFIC CONTROL AND PROTECTION FOR SIDE ROADS, INTERSECTIONS, AND DRIVEWAYS SHALL BE INCIDENTAL TO THE COST OF SPECIFIED TRAFFIC CONTROL STANDARDS OR ITEMS.

REVISIONS	
NAME	DATE
LHA	6/89
T. RAMMACHER	09/08/94
J. OBERLE	10/18/95
A. HOUSEH	03/06/96
A. HOUSEH	10/15/96
T. RAMMACHER	01/06/00

ILLINOIS DEPARTMENT OF TRANSPORTATION
 TRAFFIC CONTROL AND PROTECTION
 FOR
 SIDE ROADS, INTERSECTIONS, AND
 DRIVEWAYS

SCALE: VERT.
 HORIZ.
 DATE 5/20/2005

DRAWN BY
 CHECKED BY
 TC-10

REVISION DATE: 01/06/00

F.A.P. RTE.	SECTION	COUNTY	TOTAL SHEETS	SHEET NO.
307	541X-1	COOK	7	7
STA.		TO STA.		
FED. ROAD DIST. NO. 1		ILLINOIS	FED. AID PROJECT	

62945

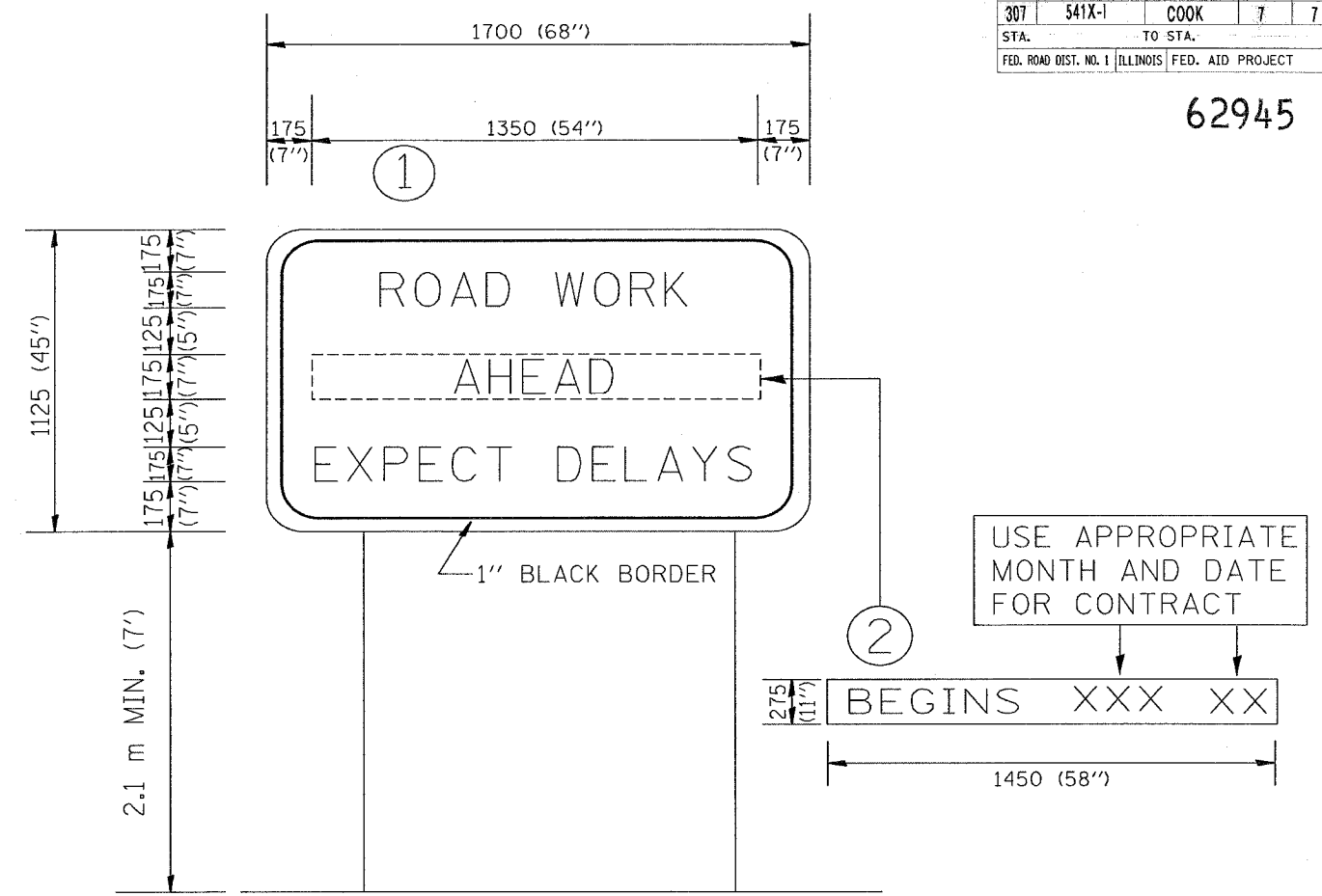

NOTES:

1. USE BLACK LETTERING ON ORANGE BACKGROUND.
2. ERECT SIGNS IN ADVANCE OF THE LOCATION FOR THE "ROAD CONSTRUCTION AHEAD" SIGN AT LOCATIONS AS DIRECTED BY THE ENGINEER.
3. ERECT SIGN ① WITH INSTALLED PANEL ② ONE WEEK PRIOR TO THE START OF CONSTRUCTION.
4. REMOVE PANEL ② SOON AFTER THE START OF CONSTRUCTION.
5. SEE SPECIAL PROVISION FOR "TEMPORARY INFORMATION SIGNING" FOR ADDITIONAL INFORMATION.
6. ONE SIGN ASSEMBLY EQUALS 2.3 SQ. M. (25.70 SQ. FT.)

ALL DIMENSIONS ARE IN MILLIMETERS (INCHES) UNLESS OTHERWISE SHOWN.

REVISIONS	
NAME	DATE
R. MIRS	9-15-97
R. MIRS	2-11-97
T. RAMMACHER	2-2-99

ILLINOIS DEPARTMENT OF TRANSPORTATION
TEMPORARY INFORMATION SIGNING

SCALE: DATE 5/20/2005
DRAWN BY: BUR. OF DESIGN
CHECKED BY:

TC22
REVISION DATE: 02/02/99