

F.A.U. RTE.	SECTION	COUNTY	TOTAL SHEETS	SHEET NO.
1362	3200 RS-2	COOK	22	1

STATE OF ILLINOIS
DEPARTMENT OF TRANSPORTATION
DIVISION OF HIGHWAYS

PROPOSED HIGHWAY PLANS

FAU ROUTE 1362: LAWRENCE AVENUE
SECTION: 3200 RS-2
EAST RIVER ROAD TO CUMBERLAND AVENUE
RESURFACING (MAINTENANCE)
COOK COUNTY
C-91-185-05

FOR INDEX OF SHEETS, SEE SHEET NO. 2

IMPROVEMENT IS LOCATED IN THE VILLAGE OF NORRIDGE AND THE CITY OF CHICAGO

D-91-185-05

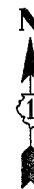
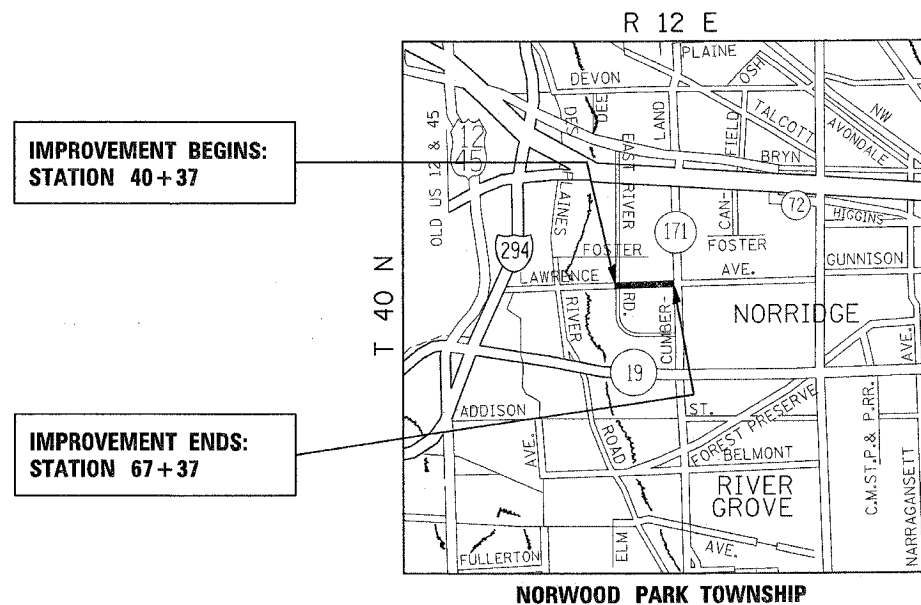

TRAFFIC DATA

2002 ADT = 20,100
POSTED SPEED LIMIT = 35 MPH

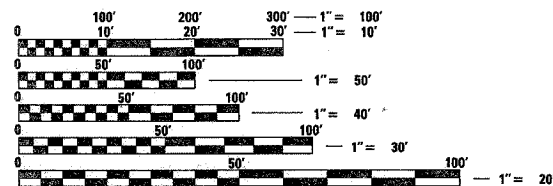

FULL SIZE PLANS HAVE BEEN PREPARED USING STANDARD ENGINEERING SCALES. REDUCED SIZED PLANS WILL NOT CONFORM TO STANDARD SCALES. IN MAKING MEASUREMENTS ON REDUCED PLANS, THE ABOVE SCALES MAY BE USED.

J.U.L.I.E.
JOINT UTILITY LOCATION INFORMATION FOR EXCAVATION
1-800-392-0123

MAP SCALE : [Symbol] 1.0 MILE

GROSS & NET LENGTH OF IMPROVEMENT = 2700 FEET = 0.51 MILE

STATE OF ILLINOIS
DEPARTMENT OF TRANSPORTATION
DIVISION OF HIGHWAYS

SUBMITTED June 6, 20 05
Dina O'Keefe, IAP
DEPUTY DIRECTOR OF HIGHWAYS, REGION ENGINEER

July 1, 20 05
Mike Hine
ENGINEER OF DESIGN AND ENVIRONMENT

July 1, 20 05
Victor Maden
DIRECTOR OF HIGHWAYS, CHIEF ENGINEER

PRINTED BY THE AUTHORITY OF THE STATE OF ILLINOIS

DISTRICT ONE DESIGN PLAN PREPARATION ENGINEER: KEN ENG / JENPAI CHANG (847) 705-4432

CONTRACT NO. 62946