

F.A.U. RTE.	SECTION	COUNTY	TOTAL SHEETS	SHEET NO.
1362	3200 RS-2	COOK	22	5
STA.	TO STA.			
FED. ROAD DIST. NO. 1	ILLINOIS	HIGHWAY PROJECT		
CONTRACT #62946				

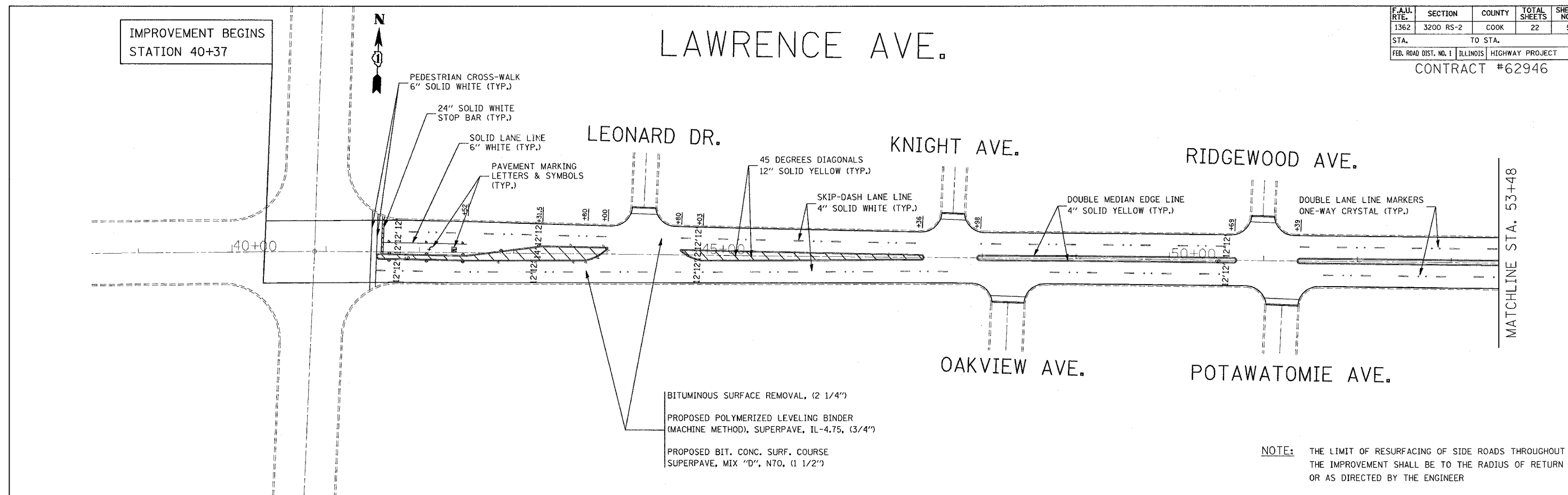

BITUMINOUS SURFACE REMOVAL, (2 1/4")
 PROPOSED POLYMERIZED LEVELING BINDER
 (MACHINE METHOD), SUPERPAVE, IL-4.75, (3/4")
 PROPOSED BIT. CONC. SURF. COURSE
 SUPERPAVE, MIX "D", N70, (1 1/2")

NOTE: THE LIMIT OF RESURFACING OF SIDE ROADS THROUGHOUT THE IMPROVEMENT SHALL BE TO THE RADIUS OF RETURN OR AS DIRECTED BY THE ENGINEER

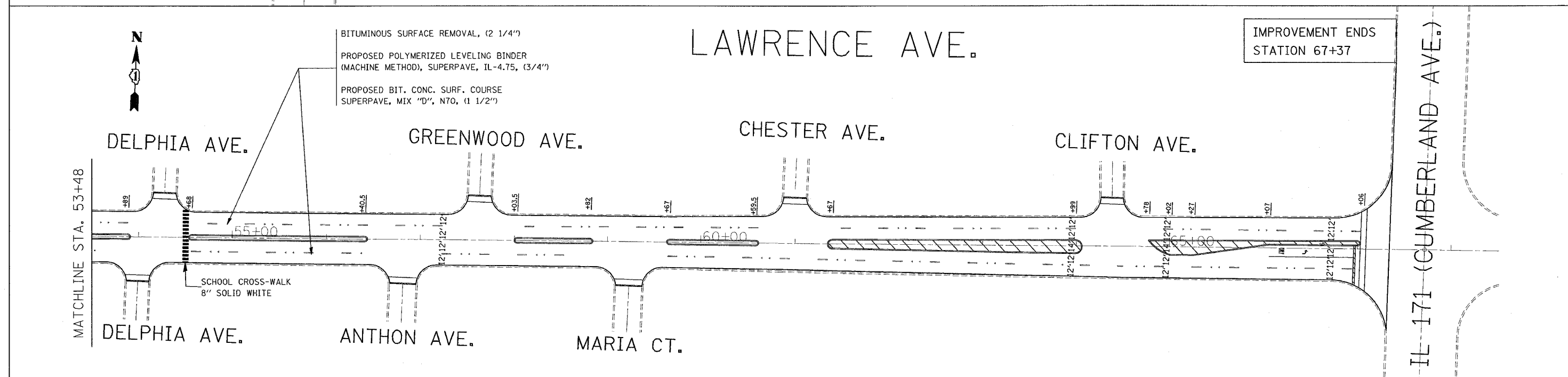

BITUMINOUS SURFACE REMOVAL, (2 1/4")
 PROPOSED POLYMERIZED LEVELING BINDER
 (MACHINE METHOD), SUPERPAVE, IL-4.75, (3/4")
 PROPOSED BIT. CONC. SURF. COURSE
 SUPERPAVE, MIX "D", N70, (1 1/2")

NOTES: ALL FINAL PAVEMENT MARKINGS SHALL BE THERMOPLASTIC (OF THE EXTRUDED TYPE) AND SHOULD BE PLACED IN ACCORDANCE WITH "DISTRICT ONE TYPICAL PAVEMENT MARKINGS" DETAIL, (TC-13)

ALL RAISED REFLECTIVE PAVEMENT MARKERS SHALL BE PLACED IN ACCORDANCE WITH THE DISTRICT ONE "TYPICAL APPLICATIONS RAISED REFLECTIVE PAVEMENT MARKER DETAIL," (TC-11)

REVISIONS	
NAME	DATE

ILLINOIS DEPARTMENT OF TRANSPORTATION
 LAWRENCE AVENUE
 ROADWAY AND PAVEMENT
 MARKING PLAN

SCALE: VERT. 1"=50'
 HORIZ. 1"=50'
 DATE 6/8/2005

DRAWN BY
 CHECKED BY

6/8/2005
 cd\proj\lect\dl18505\dl18505.dgn
 *REF-
 *REF-

08:27:17 06/08/2005